

STATE OF ILLINOIS
DEPARTMENT OF TRANSPORTATION
DIVISION OF HIGHWAYS

**PLANS FOR PROPOSED
FEDERAL AID HIGHWAY**

F.A.U. 1359 WHITEHALL AVENUE
WOLF ROAD (F.A.U. 2690) TO ROBERTA AVENUE (F.A.U. 1006)
ROADWAY RESURFACING
Section No.: 15-00088-00-RS
Project No. M-4003(608)
CITY OF NORTHLAKE
COOK COUNTY
JOB NO.: C-91-105-16

F.A. RTE.	SECTION	COUNTY	TOTAL SHEETS	SHEET NO.
1359	15-00088-00-RS	COOK	17	1
ILLINOIS		CONTRACT NO. 61C80		

FOR INDEX OF SHEETS, SEE SHEET NO. 2



DESIGN DESIGNATION ROUTE : MAJOR COLLECTOR
DESIGN SPEED = 25 M.P.H.
POSTED SPEED = 25 M.P.H.

TRAFFIC DATA: 2009
ADT = 1,070

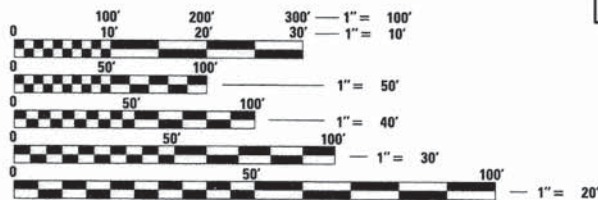

FULL SIZE PLANS HAVE BEEN PREPARED USING STANDARD ENGINEERING SCALES. REDUCED SIZED PLANS WILL NOT CONFORM TO STANDARD SCALES. IN MAKING MEASUREMENTS ON REDUCED PLANS, THE ABOVE SCALES MAY BE USED.

J.U.L.I.E.
JOINT UTILITY LOCATION INFORMATION FOR EXCAVATION
1-800-892-0123
OR 811

CB CHRISTOPHER B. BURKE ENGINEERING, LTD.
9575 W. Higgins Road, Suite 600
Rosemont, Illinois 60018
(847) 823-0500

PROFESSIONAL DESIGN FIRM NO.: 184-001175
EXPIRATION DATE: APRIL 30, 2017

CONTRACT NO. 61C80

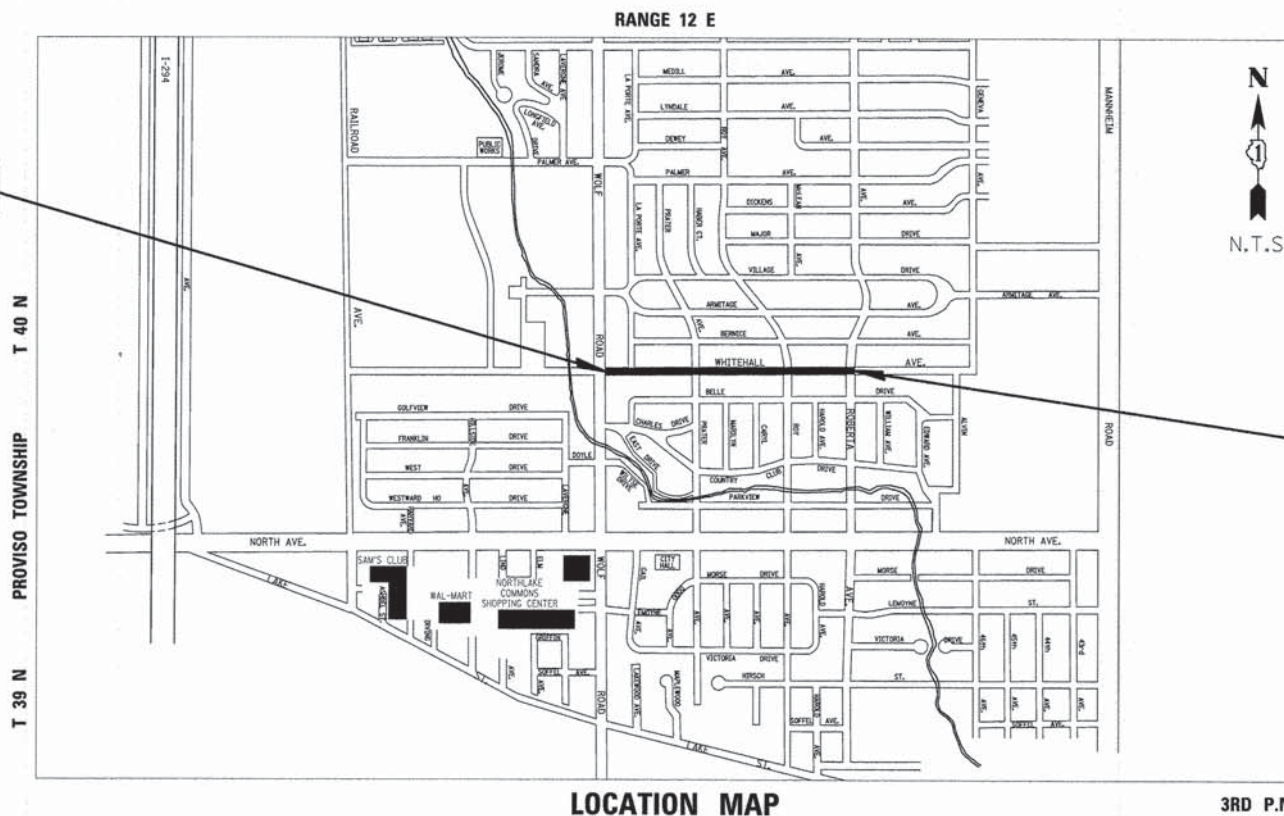

LOCATION MAP

3RD P.M.

BEGIN PROJECT
STA. 00 + 40.13

END PROJECT
STA. 26 + 97.37



March 3, 2016
Andrew Pufundt
ANDREW M. PUFUNDT
ILLINOIS REGISTRATION No. 062-061729 ENGINEER
EXPIRATION DATE: 11/30/17

STATE OF ILLINOIS DEPARTMENT OF TRANSPORTATION DIVISION OF HIGHWAYS	
APPROVED	<i>[Signature]</i> CITY OF NORTHLAKE, MAYOR
PASSED	MARCH 31 2016 <i>[Signature]</i> DISTRICT 1 ENGINEER OF LOCAL ROADS AND STREETS
RELEASED FOR BID BASED ON LIMITED REVIEW	April 1 2016 <i>[Signature]</i> REGION ONE ENGINEER

PRINTED BY THE AUTHORITY
OF THE STATE OF ILLINOIS

GROSS LENGTH OF PROJECT = 2,657 LINEAL FEET (0.50 MI.)
NET LENGTH OF PROJECT = 2,657 LINEAL FEET (0.50 MI.)

FEDERAL AID PROGRAM ENGINEER: FAWAD AQUEEL, PE, PTOE, (847) 705-4021 SCHAUMBURG, IL

SUMMARY OF QUANTITIES

FUNDING SOURCE				STP - LAFO 80% FED. 20% LOCAL
LOCATION OF WORK				WHITEHALL AVE
SUMMARY OF QUANTITIES				CONSTRUCTION TYPE CODE
ITEM #	ITEM	UNIT		0005
20101200	TREE ROOT PRUNING	EACH	5	
20201200	REMOVAL AND DISPOSAL OF UNSUITABLE MATERIAL	CU YD	25	
21001000	GEOTECHNICAL FABRIC FOR GROUND STABILIZATION	SQ YD	135	
28000510	INLET FILTERS	EACH	29	
30300001	AGGREGATE SUBGRADE IMPROVEMENT	CU YD	25	
31101180	SUBBASE GRANULAR MATERIAL, TYPE B 2"	SQ YD	100	
31101400	SUBBASE GRANULAR MATERIAL, TYPE B 6"	SQ YD	575	
40201000	AGGREGATE FOR TEMPORARY ACCESS	TON	100	
40600290	BITUMINOUS MATERIALS (TACK COAT)	POUNDS	6255	
40600400	MIXTURE FOR CRACKS, JOINTS, AND FLANGEWAYS	TON	13.5	
40600625	LEVELING BINDER (MACHINE METHOD), N50	TON	950	
40600982	HOT-MIX ASPHALT SURFACE REMOVAL - BUTT JOINT	SQ YD	200	
40603335	HOT-MIX ASPHALT SURFACE COURSE, MIX "D", N50	TON	880	
42300300	PORTLAND CEMENT CONCRETE DRIVEWAY PAVEMENT, 7 INCH	SQ YD	100	
42400200	PORTLAND CEMENT CONCRETE SIDEWALK 5 INCH	SQ FT	9000	
42400400	PORTLAND CEMENT CONCRETE SIDEWALK 7 INCH	SQ FT	2075	
42400800	DETECTABLE WARNINGS	SQ FT	300	
44000100	PAVEMENT REMOVAL	SQ YD	10	
44000162	HOT-MIX ASPHALT SURFACE REMOVAL, 3 1/4"	SQ YD	9000	
44000200	DRIVEWAY PAVEMENT REMOVAL	SQ YD	675	
44000600	SIDEWALK REMOVAL	SQ FT	11075	
44201713	CLASS D PATCHES, TYPE I, 6 INCH	SQ YD	220	
44201717	CLASS D PATCHES, TYPE II, 6 INCH	SQ YD	220	
44201721	CLASS D PATCHES, TYPE III, 6 INCH	SQ YD	220	
44201723	CLASS D PATCHES, TYPE IV, 6 INCH	SQ YD	220	
44300100	AREA REFLECTIVE CRACK CONTROL TREATMENT	SQ YD	9000	

FUNDING SOURCE				STP - LAFO 80% FED. 20% LOCAL
LOCATION OF WORK				WHITEHALL AVE
SUMMARY OF QUANTITIES				CONSTRUCTION TYPE CODE
ITEM #	ITEM	UNIT		0005
~ 56500600	DOMESTIC WATER SERVICE BOXES TO BE ADJUSTED	EACH	2	
60206905	CATCH BASINS, TYPE C, TYPE 1 FRAME, OPEN LID	EACH	1	
60234200	INLETS, TYPE A, TYPE 1 FRAME, OPEN LID	EACH	1	
60266600	VALVE BOXES TO BE ADJUSTED	EACH	2	
60406000	FRAMES AND LIDS, TYPE 1, OPEN LID	EACH	1	
60406100	FRAMES AND LIDS, TYPE 1, CLOSED LID	EACH	2	
60500050	REMOVING CATCH BASINS	EACH	3	
67100100	MOBILIZATION	L SUM	1	
70102620	TRAFFIC CONTROL AND PROTECTION, STANDARD 701501	L SUM	1	
70102635	TRAFFIC CONTROL AND PROTECTION, STANDARD 701701	L SUM	1	
70102640	TRAFFIC CONTROL AND PROTECTION, STANDARD 701801	L SUM	1	
* 78000100	THERMOPLASTIC PAVEMENT MARKING - LETTERS AND SYMBOLS	SQ FT	62.4	
* 78000200	THERMOPLASTIC PAVEMENT MARKING - LINE 4"	FOOT	315	
* 78000400	THERMOPLASTIC PAVEMENT MARKING - LINE 6"	FOOT	880	
* 78000600	THERMOPLASTIC PAVEMENT MARKING - LINE 12"	FOOT	120	
* 78000650	THERMOPLASTIC PAVEMENT MARKING - LINE 24"	FOOT	215	
~ * 85000200	MAINTENANCE OF EXISTING TRAFFIC SIGNAL INSTALLATION	EACH	1	
* 87900200	DRILL EXISTING HANDHOLE	EACH	6	
~ * 88600600	DETECTOR LOOP REPLACEMENT	FOOT	300	
~ * 89502376	REBUILD EXISTING HANDHOLE	EACH	1	
~ X0326862	STRUCTURES TO BE ADJUSTED	EACH	18	
~ Z0004562	COMBINATION CONCRETE CURB AND GUTTER REMOVAL AND REPLACEMENT	FOOT	900	
~ Z0013798	CONSTRUCTION LAYOUT	L SUM	1	
~ Z0017500	DRAINAGE & UTILITY STRUCTURE ADJUSTMENT (SPECIAL)	EACH	8	
~ Z0017800	DRAINAGE & UTILITY STRUCTURES TO BE RECONSTRUCTED (SPECIAL)	EACH	2	
~ Z0030850	TEMPORARY INFORMATION SIGNING	SQ FT	52	

~ INDICATES SPECIAL PROVISION
* INDICATES SPECIALTY ITEM

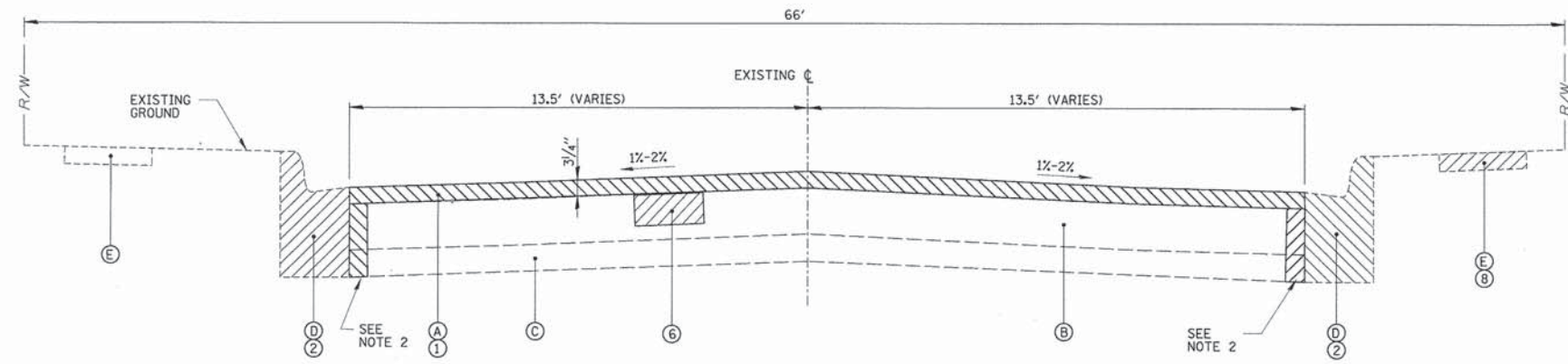

EXISTING TYPICAL SECTION
 STA. 00+40.13 TO STA. 26+97.37
 NOT TO SCALE

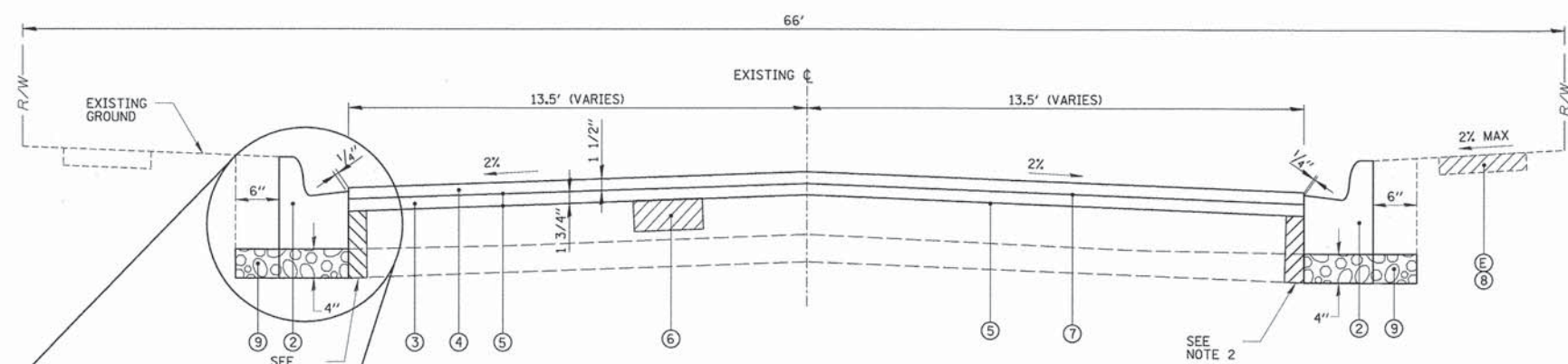

PROPOSED TYPICAL SECTION
 STA. 00+40.13 TO STA. 26+97.37
 NOT TO SCALE

- LEGEND**
- (A) EXISTING ASPHALT PAVEMENT (+/- 3")
 - (B) EXISTING HMA OR P.C.C. BASE (+/- 0" TO 9")
 - (C) EXISTING AGGREGATE BASE (+/- 0" TO 7")
 - (D) EXISTING COMBINATION CURB AND GUTTER (TYPE M-3.12 & VARIES)
 - (E) EXISTING SIDEWALK
 - (1) HOT-MIX ASPHALT SURFACE REMOVAL, 3 1/4"
 - (2) COMBINATION CONCRETE CURB AND GUTTER REMOVAL AND REPLACEMENT (AS DIRECTED BY ENGINEER) (SEE DETAIL SHEET 10)
 - (3) LEVELING BINDER (MACHINE METHOD), N50 - 1 3/4" MIN.
 - (4) HOT-MIX ASPHALT SURFACE COURSE, MIX "D", N50 - 1 1/2"
 - (5) BITUMINOUS MATERIALS (TACK COAT)
 - (6) CLASS D PATCHES, TYPE VARIES, 6"
 - (7) AREA REFLECTIVE CRACK CONTROL TREATMENT
 - (8) PORTLAND CEMENT CONCRETE SIDEWALK, 5" (AS DIRECTED BY THE ENGINEER)
 - (9) SUBBASE GRANULAR MATERIAL, TYPE B (INCLUDED IN COST OF COMBINATION CONCRETE CURB AND GUTTER REMOVAL AND REPLACEMENT (SEE DETAIL SHEET 10))

- NOTES**
1. CONTRACTOR SHALL MILL PAVEMENT BEFORE PATCHING.
 2. ANY PAVEMENT REMOVAL REQUIRED FOR CONSTRUCTION OF COMBINATION CONCRETE CURB AND GUTTER SHALL BE REPLACED WITH P.C.C. (CLASS S1) AND SHALL BE VIBRATED IN PLACE. COST FOR PAVEMENT REMOVAL AND P.C.C (CLASS S1) SHALL BE INCLUDED IN UNIT PRICE FOR COMBINATION CONCRETE CURB AND GUTTER REMOVAL AND REPLACEMENT.
 3. SEE CURB AND GUTTER REMOVAL AND REPLACEMENT DETAIL REGARDING PAYMENT FOR LANDSCAPE RESTORATION (SHEET 10).
 4. THE EXISTING PAVEMENT CROSS SLOPE IS APPROXIMATELY 1%. ADDITIONAL QUANTITY OF LEVELING BINDER HAS BEEN INCLUDED IN THE CONTRACT TO RAISE THE ROADWAY CROWN TO ESTABLISH A 2% CROSS SLOPE. GRINDING AND PAVING OPERATIONS SHALL BE ADJUSTED ACCORDINGLY.
 5. CONTRACTOR SHALL SAWCUT PAVEMENT PRIOR TO REMOVING CURB.
 6. NO ADDITIONAL COMPENSATION SHALL BE CONSIDERED FOR PETROMAT (FABRIC) ENCOUNTERED DURING GRINDING OPERATIONS.
 7. ANY NECESSARY CONCRETE GRINDING TO INSTALL THE PROPOSED PAVEMENT LIFT THICKNESSES IS INCLUDED IN COST FOR HMA SURFACE REMOVAL.

HOT-MIX ASPHALT MIXTURE REQUIREMENTS	
MIXTURE ITEM	AIR VOIDS @ Ndes
PAVEMENT RESURFACING	
HOT-MIX ASPHALT SURFACE COURSE, MIX "D", N50 (1L-9.5 MM), 1 1/2"	4% @ 50 GYR
LEVELING BINDER (MACHINE METHOD), N50, 1 3/4"	4% @ 50 GYR
DRIVEWAYS	
HOT-MIX ASPHALT SURFACE COURSE, MIX "D", N50 (1L-9.5 MM), 3" (2 LIFTS)	4% @ 50 GYR
PATCHING	
CLASS D PATCHES, 6" (SPECIAL) (HMA BINDER 1L-19 MM) NOTE: SAW CUT PATCHES PRIOR TO REMOVAL	4% @ 70 GYR

- NOTES:**
1. THE UNIT WEIGHT USED TO CALCULATE ALL HMA SURFACE MIXTURE QUANTITIES IS 112 LBS/SQ YD/IN.
 2. THE "AC TYPE" FOR POLYMERIZED HMA MIXES SHALL BE "SBS/SBR PG 76-22" AND FOR NON-POLYMERIZED HMA THE "AC TYPE" SHALL BE "PG 64-22" UNLESS MODIFIED BY DISTRICT ONE SPECIAL PROVISIONS. FOR "PERCENT OF RAP AND RAS" SEE DISTRICT ONE SPECIAL PROVISIONS.

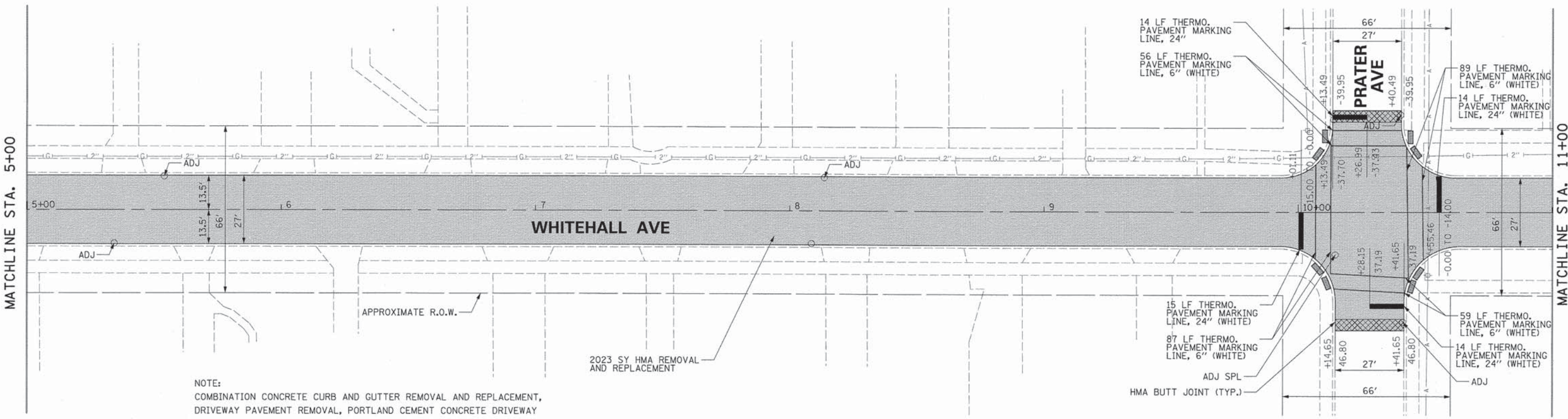
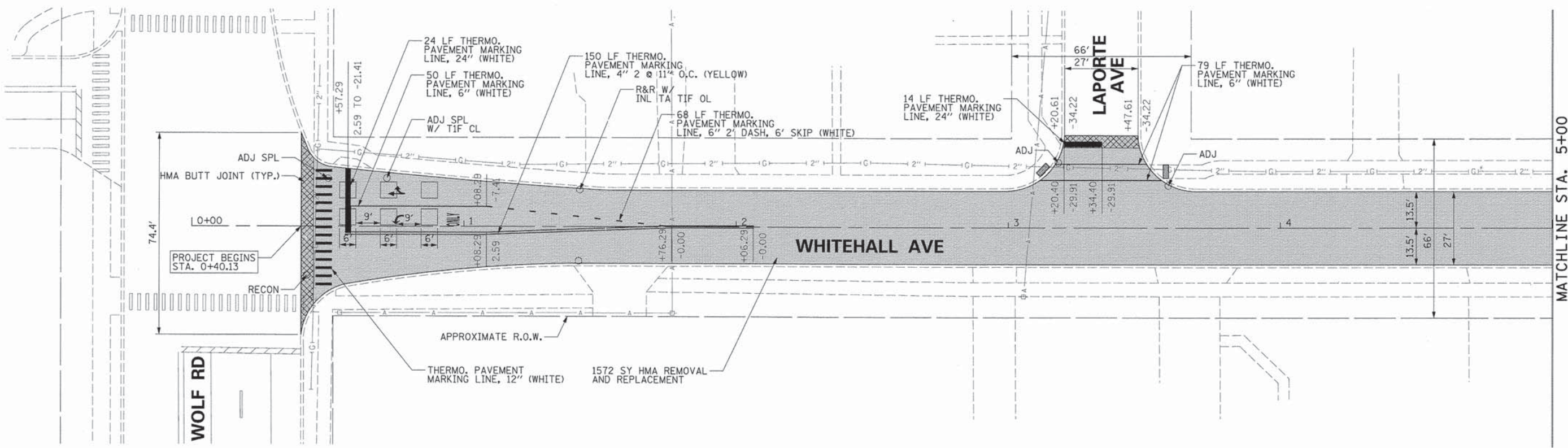

NOTE:
 COMBINATION CONCRETE CURB AND GUTTER REMOVAL AND REPLACEMENT,
 DRIVEWAY PAVEMENT REMOVAL, PORTLAND CEMENT CONCRETE DRIVEWAY
 PAVEMENT, 7 INCH, PORTLAND CEMENT CONCRETE SIDEWALK, 5 INCH AND
 7 INCH, AND CLASS D PATCHES, 6 INCH ARE NOT SHOWN ON THE PLANS
 BUT WILL BE DETERMINED BY THE ENGINEER IN THE FIELD AND WILL
 NOT EXCEED THE PLAN QUANTITY.

FILE NAME =	USER NAME = apu\undt	DESIGNED - AJS	REVISED -
N:\NORTHLAKE\140232DC146\Civil\1\05_PLN.D	148.sht	DRAWN - AJS	REVISED -
	PLOT SCALE = 20'	CHECKED - AMP	REVISED -
	PLOT DATE = 3/11/2016	DATE - 8/27/15	REVISED -

STATE OF ILLINOIS
 DEPARTMENT OF TRANSPORTATION

ROADWAY PLANS WHITEHALL AVENUE			
SCALE:	SHEET NO.	OF SHEETS	STA. TO STA.

F.A.U. RTE.	SECTION	COUNTY	TOTAL SHEETS	SHEET NO.
1359	15-00088-00-RS	COOK	17	5
CONTRACT NO. 61C80				
ILLINOIS FED. AID PROJECT				



MATCHLINE STA. 11+00

MATCHLINE STA. 17+00

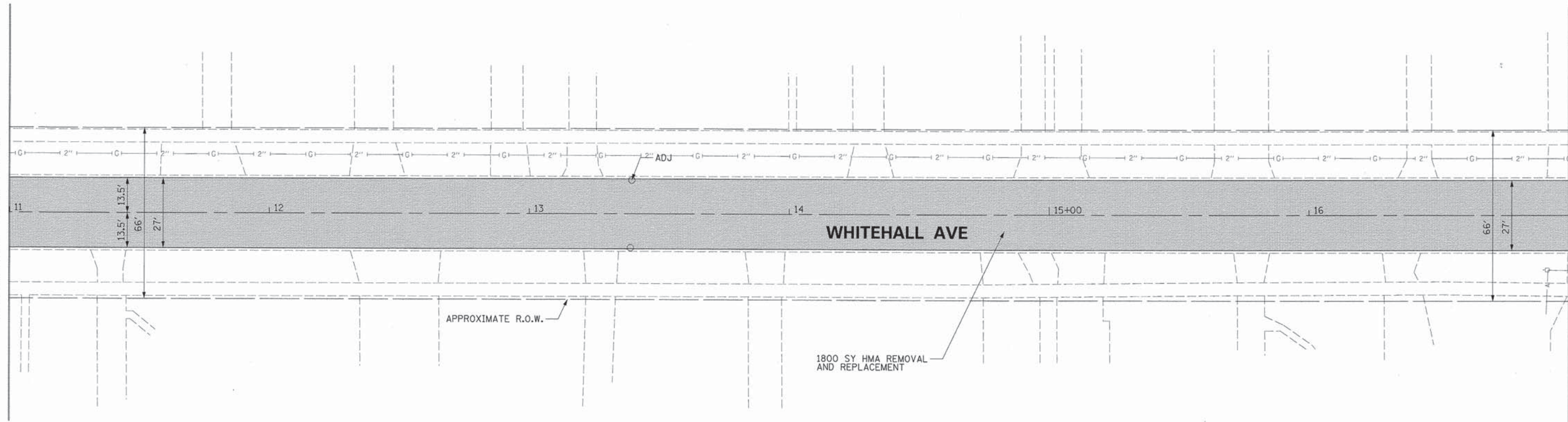

MATCHLINE STA. 17+00

MATCHLINE STA. 23+00

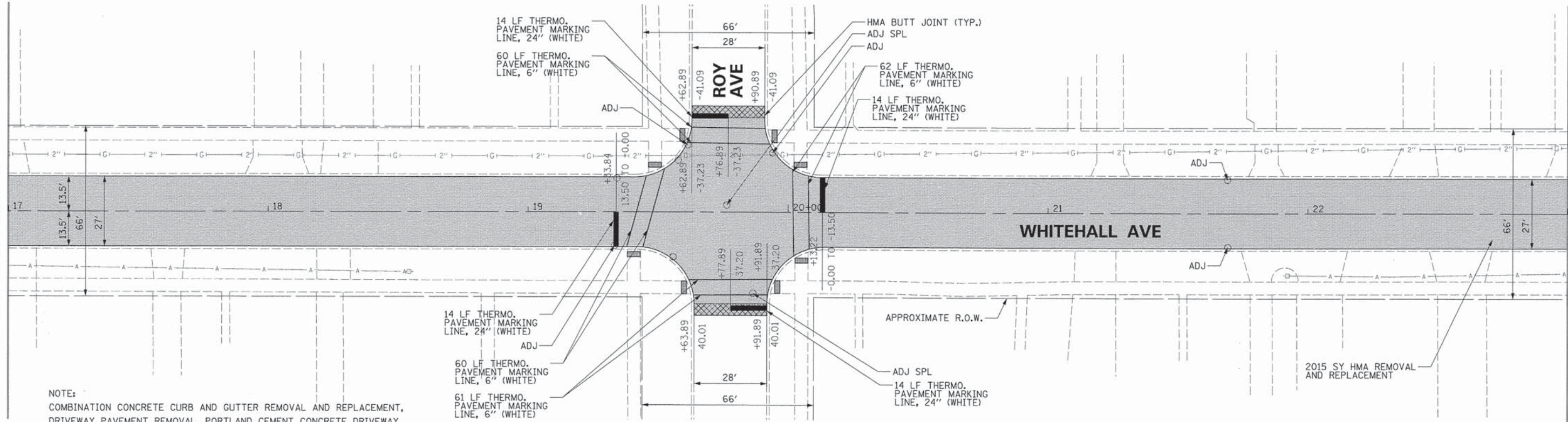

NOTE:
COMBINATION CONCRETE CURB AND GUTTER REMOVAL AND REPLACEMENT, DRIVEWAY PAVEMENT REMOVAL, PORTLAND CEMENT CONCRETE DRIVEWAY PAVEMENT, 7 INCH, PORTLAND CEMENT CONCRETE SIDEWALK, 5 INCH AND 7 INCH, AND CLASS D PATCHES, 6 INCH ARE NOT SHOWN ON THE PLANS BUT WILL BE DETERMINED BY THE ENGINEER IN THE FIELD AND WILL NOT EXCEED THE PLAN QUANTITY.

FILE NAME =	USER NAME = apufundt	DESIGNED - AJS	REVISED -
N:\NORTHLAKE\94002320C148\1\1\06_PLN.D	148.sht	DRAWN - AJS	REVISED -
PLOT SCALE = 20'		CHECKED - AMP	REVISED -
PLOT DATE = 3/11/2016		DATE - 8/27/15	REVISED -

STATE OF ILLINOIS
DEPARTMENT OF TRANSPORTATION

ROADWAY PLANS
WHITEHALL AVENUE

SCALE: SHEET NO. OF SHEETS STA. TO STA.

F.A.U. RTE.	SECTION	COUNTY	TOTAL SHEETS	SHEET NO.
1359	15-00088-00-RS	COOK	17	6
				CONTRACT NO. 61C80
ILLINOIS FED. AID PROJECT				



MATCHLINE STA. 23+00

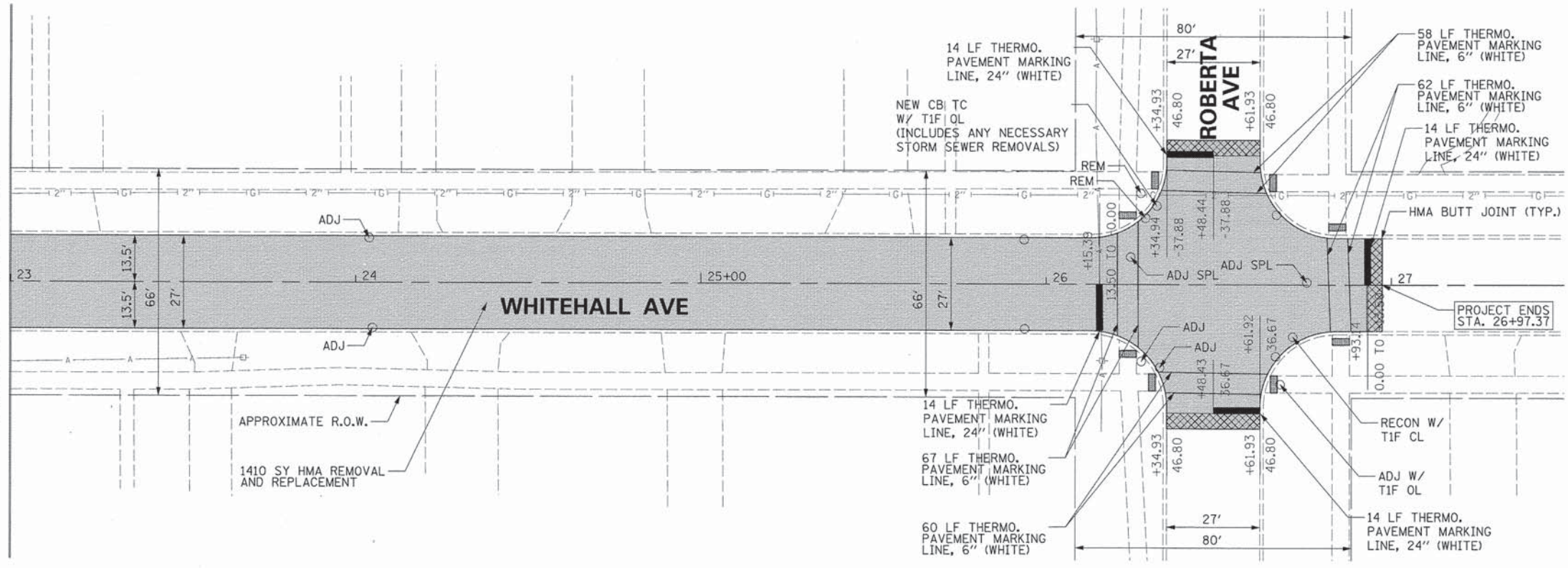

- NOTES:
1. AT LOCATIONS WHERE STRUCTURES ARE TO BE REMOVED BUT NOT REPLACED, THE CONTRACTOR SHALL PLUG AND GROUT THE EXISTING STORM SEWERS WHICH ARE TO REMAIN IN PLACE.
 2. WHERE NEW CATCH BASIN IS TO BE INSTALLED, COST OF STRUCTURE SHALL INCLUDE 5 LINEAL FEET OF NEW STORM SEWER TO MAKE CONNECTION TO EXISTING SEWER.
 3. COMBINATION CONCRETE CURB AND GUTTER REMOVAL AND REPLACEMENT, DRIVEWAY PAVEMENT REMOVAL, PORTLAND CEMENT CONCRETE DRIVEWAY PAVEMENT, 7 INCH, PORTLAND CEMENT CONCRETE SIDEWALK, 5 INCH AND 7 INCH, AND CLASS D PATCHES, 6 INCH ARE NOT SHOWN ON THE PLANS BUT WILL BE DETERMINED BY THE ENGINEER IN THE FIELD AND WILL NOT EXCEED THE PLAN QUANTITY.

FILE NAME =	USER NAME = apufundt	DESIGNED - AJS	REVISED -
N:\NORTHLAKE\9480320C148\VC\1\87_PLN.D	148.sht	DRAWN - AJS	REVISED -
	PLOT SCALE = 20'	CHECKED - AMP	REVISED -
	PLOT DATE = 3/11/2016	DATE - 8/27/15	REVISED -

**STATE OF ILLINOIS
DEPARTMENT OF TRANSPORTATION**

**ROADWAY PLANS
WHITEHALL AVENUE**

SCALE:	SHEET NO.	OF SHEETS	STA.	TO STA.
--------	-----------	-----------	------	---------

F.A.U. RTE.	SECTION	COUNTY	TOTAL SHEETS	SHEET NO.
1359	15-00088-00-RS	COOK	17	7
				CONTRACT NO. 61C80
ILLINOIS FED. AID PROJECT				

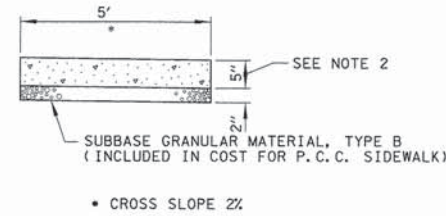

NOTES:

1. ALL REQUIRED EARTH EXCAVATION AND SUBBASE GRANULAR MATERIAL, TYPE B TO CONSTRUCT P.C.C. SIDEWALK TO MEET CURRENT ADA REQUIREMENTS SHALL BE INCLUDED IN THE COST FOR P.C.C. SIDEWALK.
2. WHEN FORMS ARE REMOVED FROM THE SIDEWALK EITHER THE SIDEWALK SHALL BE BARRICADED OR BACKFILLED WITHIN 24 HOURS.
3. ALL LANDSCAPE RESTORATION (TOPSOIL, SEEDING, CLASS I, MULCH METHOD 3) SHALL BE INCLUDED IN COST FOR P.C.C. SIDEWALK.

P.C.C. SIDEWALK DETAIL

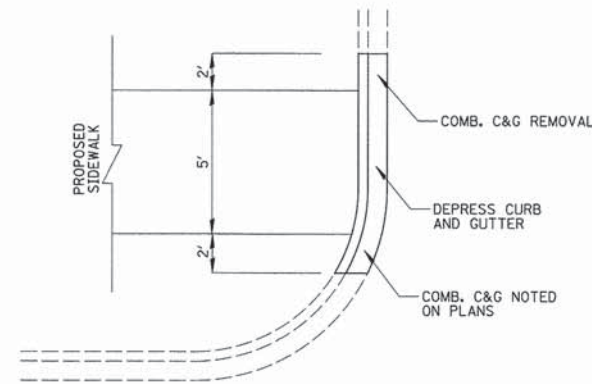

PROPOSED DEPRESSED CURB & GUTTER
EXISTING CURB & GUTTER NOT DEPRESSED
NOT TO SCALE

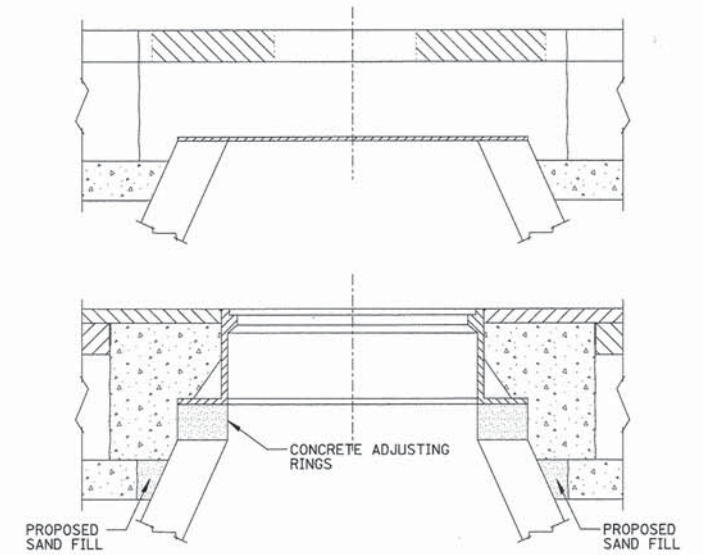

CONSTRUCTION PROCEDURES

STAGE I (BEFORE PAVEMENT MILLING)

- A) REMOVE A MINIMUM OF 12" OF THE PAVEMENT FROM AROUND THE STRUCTURE.
- B) REMOVE THE EXISTING FRAME AND LID FROM THE STRUCTURE.
- C) COVER THE STRUCTURE OPENING WITH A 36" DIAMETER METAL PLATE.
- D) BACKFILL WITH CRUSHED STONE AND A MINIMUM 1" THICK BITUMINOUS MATERIAL APPROVED BY THE ENGINEER.

STAGE II (AFTER PAVEMENT MILLING)

- A) REMOVE THE BITUMINOUS MATERIAL AND CRUSHED STONE.
- B) INSTALL THE FRAME AND LID; ADJUST THE FRAME TO ITS FINAL SURFACE ELEVATION.
- C) THE SURROUNDING SPACE SHALL BE FILLED WITH CLASS S1 CONCRETE TO THE ELEVATION OF THE SURFACE OF THE EXISTING BASE COURSE.

THE PROCEDURE EXPLAINED ABOVE SHALL CONFORM TO THE APPLICABLE PORTIONS OF SECTIONS 353, 406, 602 AND 603 OF THE STANDARD SPECIFICATIONS.

LOCATION OF STRUCTURES

THE CONTRACTOR WILL BE REQUIRED TO KEEP A RECORD OF THE LOCATIONS OF THE BURIED STRUCTURES ACCORDING TO THE STATION AND DISTANCE LEFT OR RIGHT OF THE CENTERLINE OF PAVEMENT. UPON COMPLETION OF THE WORK, THE CONTRACTOR WILL DELIVER THE RECORD TO THE ENGINEER.

BASIS OF PAYMENT

DRAINAGE & UTILITY STRUCTURE ADJUSTMENT (SPECIAL).

NOTES

1. EXISTING BROKEN FRAMES AND LIDS SHALL BE REMOVED AND DISPOSED OF BY THE CONTRACTOR AND SHALL BE REPLACED AS DIRECTED BY THE ENGINEER. REPLACEMENT FRAMES AND LIDS WILL BE PAID FOR IN ACCORDANCE WITH ARTICLE 109.04 OF THE STANDARD SPECIFICATIONS UNLESS A SEPARATE PAY ITEM HAS BEEN PROVIDED.
2. IF THE EXISTING LIDS ARE OPEN, THE FRAME WILL BE ADJUSTED TO THE ELEVATION OF THE MILLED PAVEMENT SURFACE PRIOR TO THE MILLING OPERATION. THE FRAME WILL NOT BE REMOVED AND COVERED BY THE METAL PLATE.
3. THE METAL PLATE USED TO COVER THE STRUCTURE SHALL REMAIN THE PROPERTY OF THE CONTRACTOR.

DRAINAGE & UTILITY STRUCTURE ADJUSTMENT (SPECIAL)

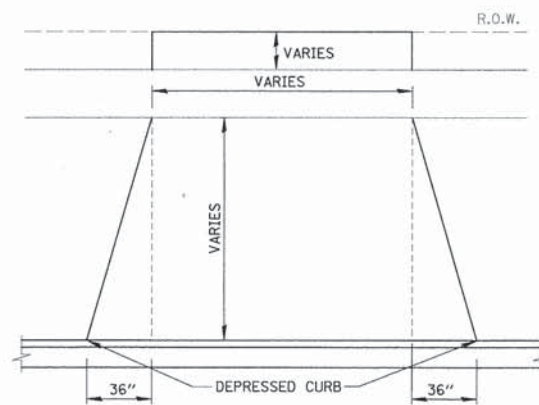

DETAIL OF DRIVEWAY

THIS TYPICAL DRIVE LAYOUT IS FOR BOTH CONCRETE AND ASPHALT DRIVES

- P.C.C. DRIVE - 7" P.C.C. DRIVEWAY PAVEMENT
2" SUB-BASE GRANULAR MATERIAL, TYPE B
- ASPHALT DRIVE - 3" HOT-MIX ASPHALT SURFACE COURSE, MIX "D", N50
6" SUB-BASE GRANULAR MATERIAL, TYPE B

NOTES:

1. PROPOSED SIDEWALK THROUGH DRIVEWAY SHALL BE 7 INCHES OF PORTLAND CEMENT CONCRETE ON 2 INCH SUB-BASE GRANULAR MATERIAL, TYPE B.
2. THE HMA SURFACE COURSE USED TO REPLACE DRIVEWAYS WILL BE PAID FOR PER TON. THE NUMBER OF DRIVEWAYS TO BE REPLACED WILL BE DETERMINED IN THE FIELD BY THE ENGINEER. FOR ESTIMATING PURPOSES IT IS ASSUMED THAT ROUGHLY 25 HMA DRIVEWAYS WILL BE REPLACED.
3. ALL LANDSCAPE RESTORATION (TOPSOIL, SEEDING, CLASS I, MULCH METHOD 3) SHALL BE INCLUDED IN COST FOR DRIVEWAY REPLACEMENT.

FILE NAME =	USER NAME = apufundt	DESIGNED - AJS	REVISED -	STATE OF ILLINOIS DEPARTMENT OF TRANSPORTATION	CONSTRUCTION DETAILS				F.A.U. RTE.	SECTION	COUNTY	TOTAL SHEETS	SHEET NO.
N:\NORTH LAKE\940032DC148\Civil\1\08_DET.D	148.dwt	DRAWN - AJS	REVISED -		1359	15-00088-00-RS	COOK	17	8				
PLOT SCALE = 28"		CHECKED - AMP	REVISED -						CONTRACT NO. 61C80				
PLOT DATE = 3/11/2016		DATE - 8/27/15	REVISED -		SCALE:	SHEET NO.	OF SHEETS	STA.	TO STA.	ILLINOIS FED. AID PROJECT			

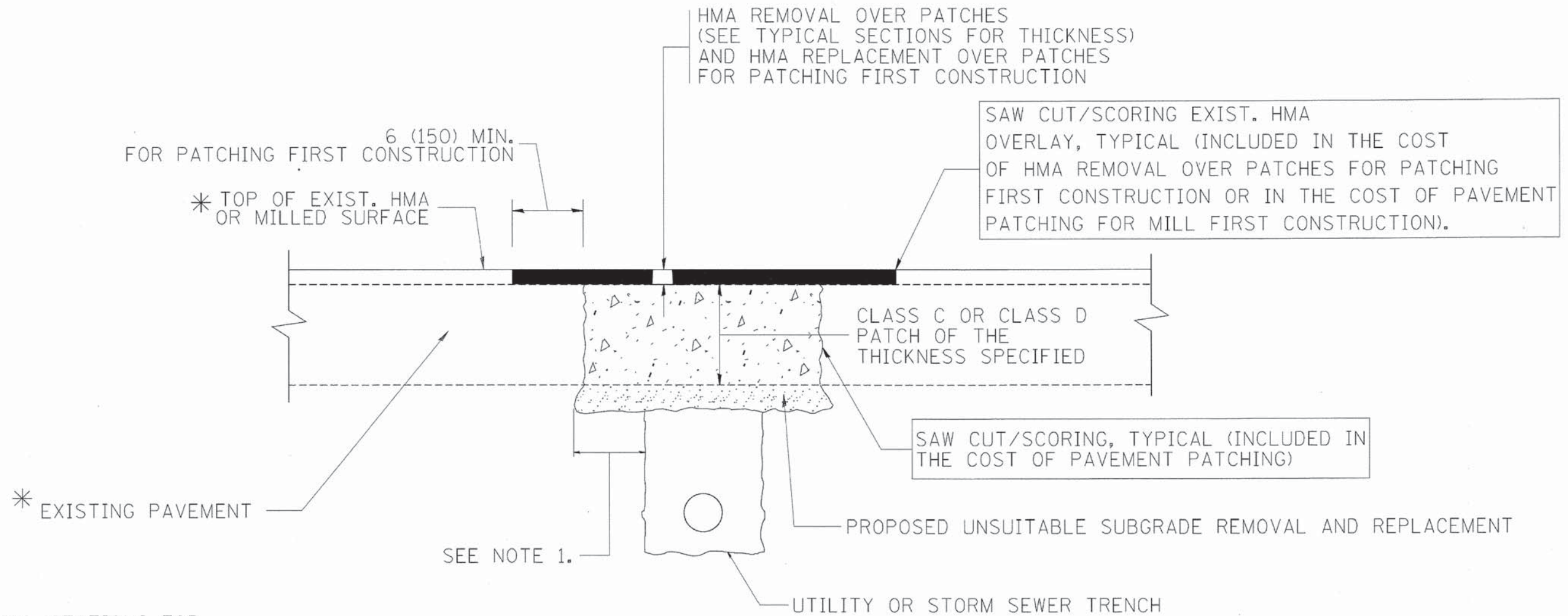

* SEE TYPICAL SECTIONS FOR THICKNESS AND MATERIALS

NOTES:

1. THE WIDTH OF THE FULL DEPTH PATCH OVER A TRENCH SHALL BE 12 (300) WIDER ON EACH SIDE OF THE TRENCH.
2. FOR METHOD OF MEASUREMENT AND BASIS OF PAYMENT, SEE RECURRING SPECIAL PROVISION "PATCHING WITH HOT-MIX ASPHALT OVERLAY REMOVAL".

SEQUENCE OF CONSTRUCTION (PATCHING FIRST)

1. REMOVE THE EXISTING HMA MATERIAL OVER THE AREA TO BE PATCHED.
2. REMOVE AND REPLACE WITH CLASS C OR D PATCH.
3. REPLACE HMA MATERIAL OVER THE AREA TO BE PATCHED.

SEQUENCE OF CONSTRUCTION (MILLING FIRST)

1. MILL HMA FIRST IF THERE IS AT LEAST 4 1/2 INCHES OR MORE OF HMA MATERIAL ON TOP OF THE EXISTING PAVEMENT OR IF THE PAVEMENT IS FULL DEPTH HMA. A MINIMUM OF 2 INCHES OF HMA MATERIAL SHALL BE IN PLACE AFTER MILLING.
2. REMOVE AND REPLACE WITH FULL DEPTH CLASS D PATCHES TO TOP OF MILLED SURFACE.

ALL DIMENSIONS ARE IN INCHES (MILLIMETERS) UNLESS OTHERWISE SHOWN.

FILE NAME = c:\projects\dstsd22x34\bd22.dgn	USER NAME = bouardl	DESIGNED - R. SHAH	REVISED - A. ABBAS 04-27-98	STATE OF ILLINOIS DEPARTMENT OF TRANSPORTATION	PAVEMENT PATCHING FOR HMA SURFACED PAVEMENT			F.A.U. RTE. 1359	SECTION 15-00088-00-RS	COUNTY COOK	TOTAL SHEETS 17	SHEET NO. 9
	PLOT SCALE = 50,000 ' / IN.	DRAWN -	REVISED - R. BORO 01-01-07		SCALE: NONE	SHEET NO. 1	OF 1 SHEETS	STA.	TO STA.	FED. ROAD DIST. NO. 1 ILLINOIS FED. AID PROJECT		
	PLOT DATE = 10/27/2008	CHECKED -	REVISED - R. BORO 09-04-07							BD400-04 (BD-22) CONTRACT NO. 61C80		
		DATE - 10-25-94	REVISED - K. ENG 10-27-08									

VARIABLE - TO MEET EXISTING DIMENSIONS AND FIELD CONDITIONS (SEE NOTE ②)

PROP. CONC. CURB OR CURB AND GUTTER REPLACEMENT IN ACCORDANCE WITH STATE STANDARD 606001. (SEE NOTE ②)

SAW CUT FULL DEPTH - INCLUDED IN THE COST OF SIDEWALK, DRIVEWAY OR MEDIAN SURFACE REMOVAL PAY ITEM.

SEE STATE STANDARD 606001
EXISTING OR PROPOSED HMA SURFACE (IF APPLICABLE)

1/4" (5) **

18" (450) MAX.

EXISTING SIDEWALK, DRIVEWAY, MEDIAN SURFACE, SOD OR GROUND.

PROPOSED SIDEWALK, DRIVEWAY PAVEMENT, MEDIAN SURFACE OR SODDING SALT TOLERANT WITH TOP SOIL, 4" (100) SOD RESTORATION (SEE NOTE ①).

EXISTING CONCRETE PAVEMENT, CONCRETE BASE COURSE OR FLEXIBLE PAVEMENT

T/2 *

SUITABLE BACKFILL MATERIAL (INCLUDED IN THE COST OF CURB OR CURB AND GUTTER REMOVAL AND REPLACEMENT)

3" (75) MIN.

PROPOSED 3/4" (20) PREFORMED EXPANSION JOINT AT CONCRETE SIDEWALKS, DRIVEWAYS, AND MEDIANS. (INCLUDED IN THE COST OF CURB OR CURB AND GUTTER REMOVAL AND REPLACEMENT.)

* 3" (75) MINIMUM FROM TOP AND BOTTOM OF THE CONCRETE PAVEMENT OR BASE COURSE.

** IF THE FINAL SURFACE OF THE PAVEMENT IS CONCRETE, THE GUTTER IS TO BE FLUSH WITH THE PAVEMENT.

NOTE: ① SIDEWALK, DRIVEWAY PAVEMENT OR MEDIAN SURFACE SHALL BE SIMILAR TO THE MATERIAL BEING REMOVED AND WILL BE PAID FOR SEPARATELY.

SEEDING, MULCH, AND TOPSOIL, FURNISH AND PLACE 4" WILL NOT BE PAID FOR SEPARATELY.

② FERTILIZER FOR THE PLACEMENT OF THE SOD IS NOT REQUIRED

③ CURB OR CURB AND GUTTER REPLACEMENT SHALL MATCH THE SHAPE OF THE EXISTING CURB OR CURB AND GUTTER UNLESS OTHERWISE SPECIFIED.

④ FOR CURB OR CURB AND GUTTER REMOVAL AND REPLACEMENT ADJACENT TO FLEXIBLE PAVEMENT DELETE EPOXY COATED TIE BARS.

⑤ LONGITUDINAL BARS, IF ENCOUNTERED IN THE EXISTING CURB OR CURB AND GUTTER, ARE NOT TO BE REPLACED. CUTTING AND REMOVING LONGITUDINAL BARS SHALL BE INCLUDED IN THE COST OF CURB OR CURB AND GUTTER REMOVAL AND REPLACEMENT.

⑥ THE COST OF HMA SURFACE REMOVAL IN THE EXISTING GUTTER FLAG SHALL BE INCLUDED IN THE COST OF THE CURB AND GUTTER REMOVAL AND REPLACEMENT.

⑦ THE REMOVAL AND REPLACEMENT OF THE EXISTING CURB OR CURB AND GUTTER SHALL BE DONE IN ACCORDANCE WITH THE APPLICABLE PORTIONS OF SECTION 440 AND 606 OF THE STANDARD SPECIFICATIONS.

⑧ THE LOCATIONS OF REMOVAL AND REPLACEMENT OF EXISTING CURB OR CURB AND GUTTER SHALL BE DETERMINED BY THE RESIDENT ENGINEER AT THE TIME OF CONSTRUCTION.

UNSUITABLE SUB-BASE MATERIAL TO BE REMOVED, IF DIRECTED BY THE ENGINEER, SHALL BE REPLACED WITH EITHER SUB-BASE GRANULAR MATERIAL, TYPE B OR ADDITIONAL THICKNESS OF CONCRETE.

REMOVAL AND REPLACEMENT 4" (100) OR LESS IS INCLUDED IN THE COST OF CURB OR CURB AND GUTTER REMOVAL AND REPLACEMENT.

REMOVAL AND REPLACEMENT IN EXCESS OF 4" (100) WILL BE PAID FOR IN ACCORDANCE WITH ARTICLE 109.04 OF THE STANDARD SPECIFICATIONS.

PROPOSED #6 (20) EPOXY COATED TIE BARS 24" (600) LONG AT 24" (600) CENTERS WILL NOT BE PAID FOR SEPARATELY. DELETE EPOXY COATED TIE BARS IF EXISTING TIE BARS ARE USUABLE AS DETERMINED BY THE ENGINEER. (SEE NOTE ③).

BASIS OF PAYMENT:

THIS WORK WILL BE PAID FOR AT THE CONTRACT UNIT PRICE PER FOOT (METER) FOR "CURB REMOVAL AND REPLACEMENT" OR "COMBINATION CONCRETE CURB AND GUTTER REMOVAL AND REPLACEMENT".

CURB OR CURB AND GUTTER REMOVAL AND REPLACEMENT

ALL DIMENSIONS ARE IN INCHES (MILLIMETERS) UNLESS OTHERWISE SHOWN.

FILE NAME =	USER NAME = drvakosgn	DESIGNED - A. HOUSEH	REVISED - R. SHAH 10-03-96	STATE OF ILLINOIS DEPARTMENT OF TRANSPORTATION	CURB OR CURB AND GUTTER REMOVAL AND REPLACEMENT	F.A.U. RTE. 1359	SECTION 15-00088-00-RS	COUNTY COOK	TOTAL SHEETS 17	SHEET NO. 10		
DR/APP/WORK/SP/ST/DR/VAKOSGN/00100315/15/24.dgn	DRAWN -	REVISOR - A. ABBAS 03-21-97	REVISED - M. GOMEZ 01-22-01			SCALE: NONE	SHEET NO. 1 OF 1 SHEETS	STA.	TO STA.	FED. ROAD DIST. NO. 1 ILLINOIS FED. AID PROJECT		
PLOT SCALE = 50,000 / IN.	CHECKED -	REVISOR - M. GOMEZ 01-22-01	REVISED - R. BORO 12-15-09									
PLOT DATE = 12/15/2009	DATE - 03-11-94	REVISED - R. BORO 12-15-09										

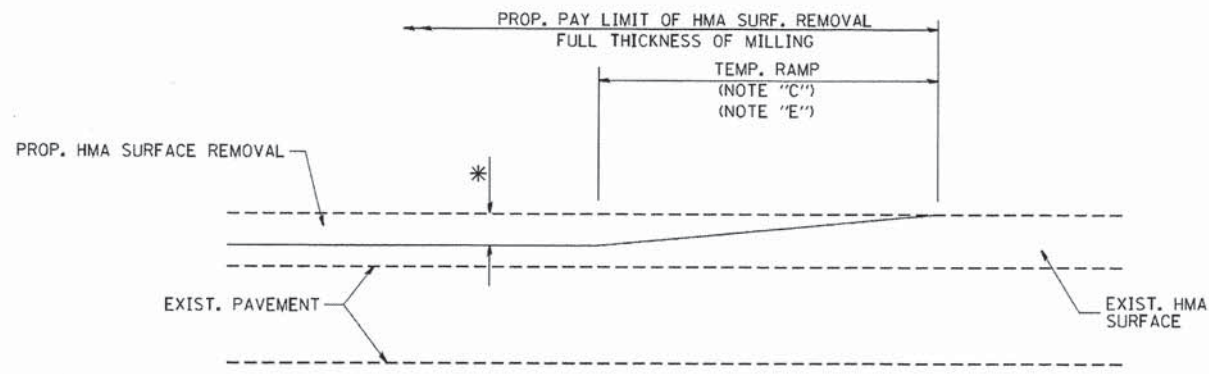

MILLED TEMPORARY RAMP
(FOR BUTT JOINT AND HMA TAPER SEE DETAIL BELOW)

OPTION 1

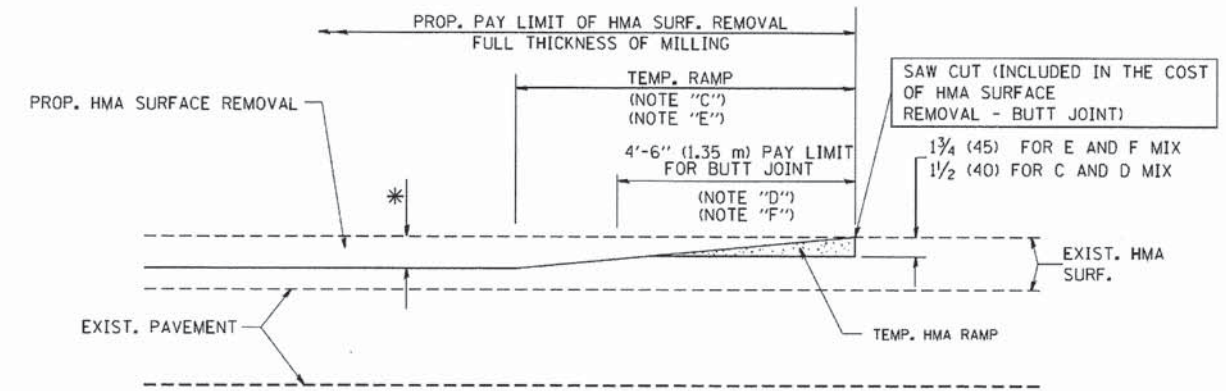

HMA CONSTRUCTED TEMPORARY RAMP
(FOR BUTT JOINT AND HMA TAPER SEE DETAIL BELOW)

OPTION 2

TYPICAL TEMPORARY RAMP

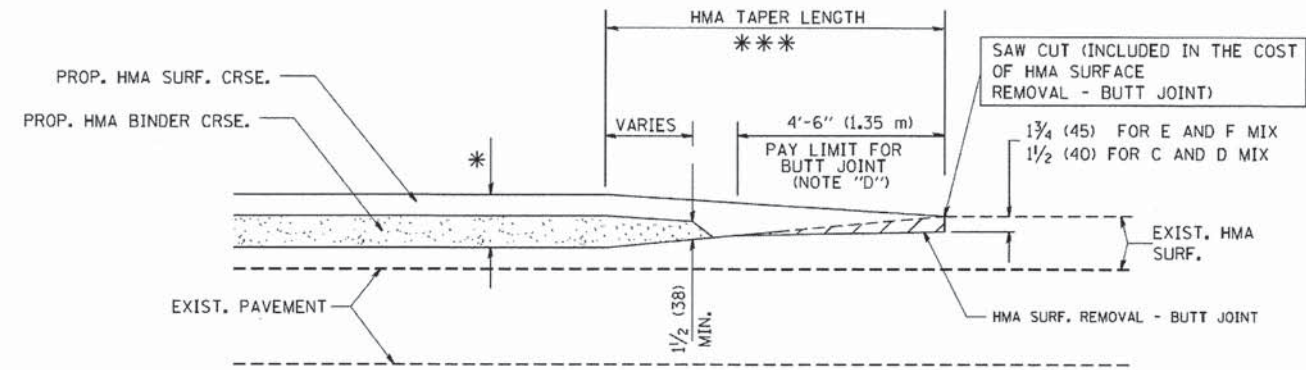

BUTT JOINT AND HMA TAPER
TYPICAL BUTT JOINT AND HMA TAPER FOR MILLING AND RESURFACING

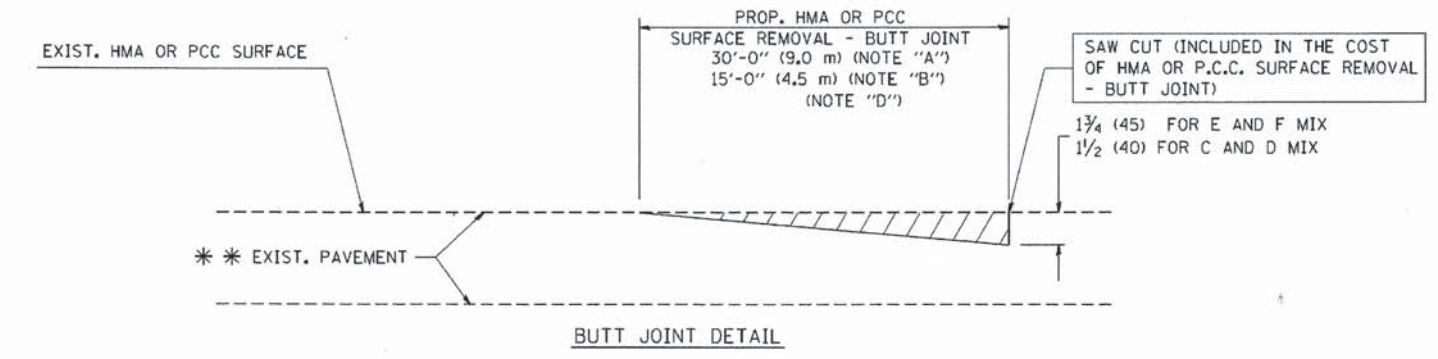

BUTT JOINT DETAIL

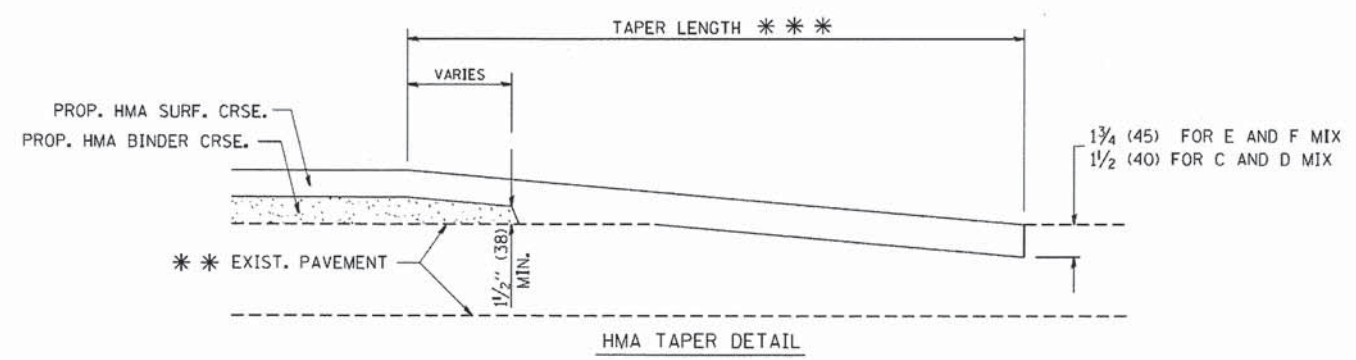

HMA TAPER DETAIL

TYPICAL BUTT JOINT AND HMA TAPER FOR RESURFACING ONLY

*** PC CONCRETE, HMA OR HMA RESURFACED PAVEMENT.

NOTES

- A: MAINLINE ROADWAYS AND MAJOR SIDE ROADS.
 - B: MINOR SIDE ROADS.
 - C: THE TEMP. RAMP SHALL BE CONSTRUCTED IMMEDIATELY UPON REMOVAL OF THE EXISTING HMA SURFACE.
 - D: THE BUTT JOINT SHALL BE CONSTRUCTED IMMEDIATELY PRIOR TO PLACING THE PROPOSED HMA COURSES.
 - E: TAPER THE TEMP. RAMP AT A RATE OF 3'-0" (900 mm) PER 1 INCH (25 mm) OF MILLING THICKNESS.
 - F: INSTALLATION AND REMOVAL OF THE 4'-6" (1.35 m) TEMP. RAMP IS INCLUDED IN COST OF HMA SURFACE REMOVAL - BUTT JOINT
 - G: SEE ARTICLE 406.08 AND 406.14 OF THE STANDARD SPECIFICATIONS FOR "HMA AND/OR PCC SURFACE REMOVAL, BUTT JOINT".
- * SEE TYPICAL SECTIONS FOR MILLING THICKNESS.
- *** 20'-0" (6.1 m) PER 1 (25) RESURFACING (NOTE "A")
10'-0" (3.0 m) PER 1 (25) RESURFACING (NOTE "B")

BASIS OF PAYMENT:

THE BUTT JOINT WILL BE PAID FOR AT THE CONTRACT UNIT PRICE PER SQUARE YARD (SQUARE METER) FOR "HOT-MIX ASPHALT SURFACE REMOVAL - BUTT JOINT" OR FOR "PORTLAND CEMENT CONCRETE SURFACE REMOVAL - BUTT JOINT".

ALL DIMENSIONS ARE IN INCHES (MILLIMETERS) UNLESS OTHERWISE SHOWN.

FILE NAME =	USER NAME = geglennob
W:\dvtstd\22x34\bd32.dgn	

DESIGNED - M. DE YONG	REVISED - R. SHAH 10-25-94
DRAWN -	REVISED - A. ABBAS 03-21-97
CHECKED -	REVISED - M. GOMEZ 04-06-01
DATE - 06-13-90	REVISED - R. BORO 01-01-07

STATE OF ILLINOIS
DEPARTMENT OF TRANSPORTATION

BUTT JOINT AND HMA TAPER DETAILS	
SCALE: NONE	SHEET NO. 1 OF 1 SHEETS STA. TO STA.

F.A.U. RTE.	SECTION	COUNTY	TOTAL SHEETS	SHEET NO.
1359	15-00088-00-RS	COOK	17	11
BD400-05 BD32			CONTRACT NO. 61C80	
FED. ROAD DIST. NO. 1 ILLINOIS FED. AID PROJECT				

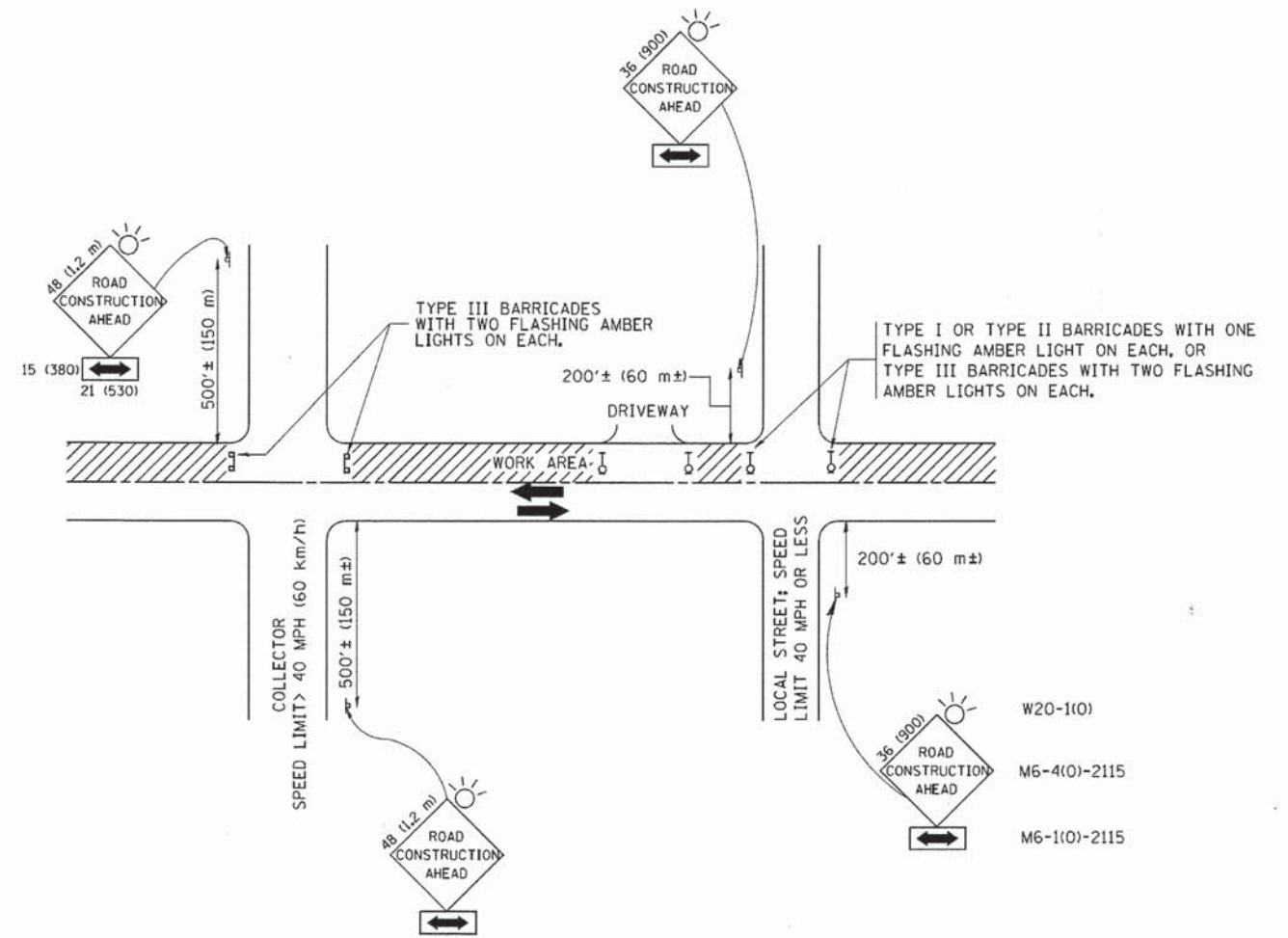

TRAFFIC CONTROL AND PROTECTION FOR SIDE ROADS, INTERSECTIONS, AND DRIVEWAYS

NOTES:

- A. FOR NO LANE RESTRICTION ON THE SIDE ROAD OR DRIVEWAYS
 1. SIDE ROAD WITH A SPEED LIMIT OF 40 MPH (60 km/h) OR LESS AS SHOWN ON THE DRAWING AND AS DIRECTED BY THE ENGINEER:
 - a) ONE ROAD CONSTRUCTION AHEAD SIGN 36 x 36 (900x900) WITH A FLASHER AND FLAG MOUNTED ON IT APPROXIMATELY 200' (60 m) IN ADVANCE OF THE MAIN ROUTE.
 - b) THE CLOSED PORTION OF THE MAIN ROUTE SHALL BE PROTECTED BY BLOCKING WITH TYPE I, TYPE II OR TYPE III BARRICADES, 1/3 OF THE CROSS SECTION OF THE CLOSED PORTION.
 2. SIDE ROAD WITH A SPEED LIMIT GREATER THAN 40 MPH (60 km/h) AS SHOWN ON THE DRAWING AND AS DIRECTED BY THE ENGINEER:
 - a) ONE ROAD CONSTRUCTION AHEAD SIGN 48 x 48 (1,2 m x 1,2 m) WITH A FLASHER MOUNTED ON IT APPROXIMATELY 500' (150 m) IN ADVANCE OF THE MAIN ROUTE.
 - b) THE CLOSED PORTION OF THE MAIN ROUTE SHALL BE PROTECTED BY BLOCKING WITH TYPE III BARRICADES, 1/2 OF THE CROSS SECTION OF THE CLOSED PORTION.
 3. WHEN THE SIDE ROAD LIES BETWEEN THE BEGINNING OF THE MAINLINE SIGNING AND THE WORK ZONE, A SINGLE HEADED ARROW (M6-1) SHALL BE USED IN LIEU OF THE DOUBLE HEADED ARROW (M6-4).
- B. FOR A LANE CLOSURE ON A SIDE ROAD OR DRIVEWAY:

USE APPLICABLE PORTIONS OF THE TYPICAL APPLICATION OF TRAFFIC CONTROL DEVICES (STD. 701501, STD. 701606 OR THE APPROPRIATE STANDARD). THE SPACING OF SIGNS AND BARRICADES SHALL BE ADJUSTED FOR FIELD CONDITIONS AS DIRECTED BY THE ENGINEER. THE DIRECTIONAL ARROW SHALL BE COVERED OR REMOVED WHEN NO LONGER CONSISTENT WITH THE SIDE ROAD LANE CLOSURE.

 - C. ADVANCE WARNING SIGNS ARE TO BE OMITTED ON DRIVEWAY UNLESS OTHERWISE NOTED.
 - D. THE TRAFFIC CONTROL AND PROTECTION FOR SIDE ROADS, INTERSECTIONS, AND DRIVEWAYS SHALL BE INCIDENTAL TO THE COST OF SPECIFIED TRAFFIC CONTROL STANDARDS OR ITEMS.

All dimensions are in millimeters (Inches) unless otherwise shown.

FILE NAME = W:\dststd\22x34\tcl0.dgn	USER NAME = geglienobt	DESIGNED - LHA	REVISED - J. OBERLE 10-18-95
		DRAWN -	REVISED - A. HOUSEH 03-06-96
	PLOT SCALE = 50,000' / IN.	CHECKED -	REVISED - A. HOUSEH 10-15-96
	PLOT DATE = 1/4/2008	DATE - 06-89	REVISED - T. RAMMACHER 01-06-00

STATE OF ILLINOIS
DEPARTMENT OF TRANSPORTATION

TRAFFIC CONTROL AND PROTECTION FOR
SIDE ROADS, INTERSECTIONS, AND DRIVEWAYS

SCALE: NONE SHEET NO. 1 OF 1 SHEETS STA. TO STA.

F.A.U. RTE.	SECTION	COUNTY	TOTAL SHEETS	SHEET NO.
1359	15-00088-00-RS	COOK	17	12
TC-10			CONTRACT NO. 61C80	
FED. ROAD DIST. NO. 1 (ILLINOIS) FED. AID PROJECT				

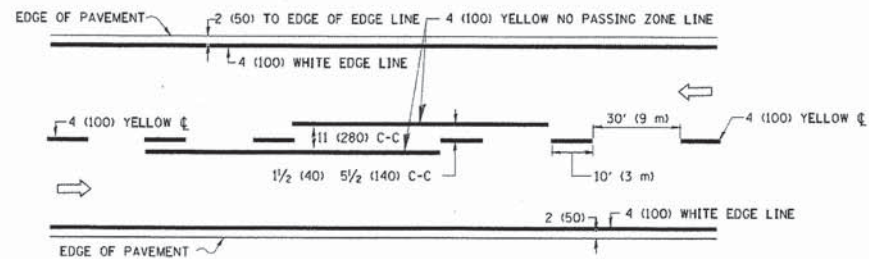

2-LANE ROADWAY

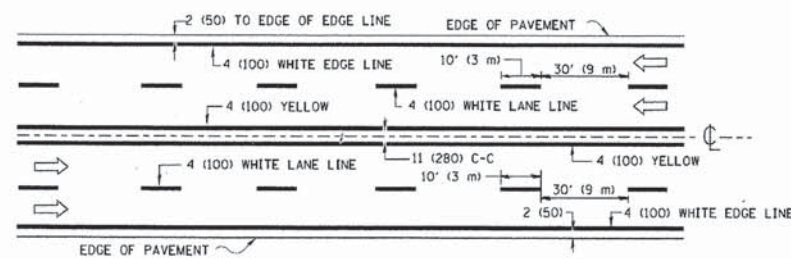

MULTI-LANE UNDIVIDED

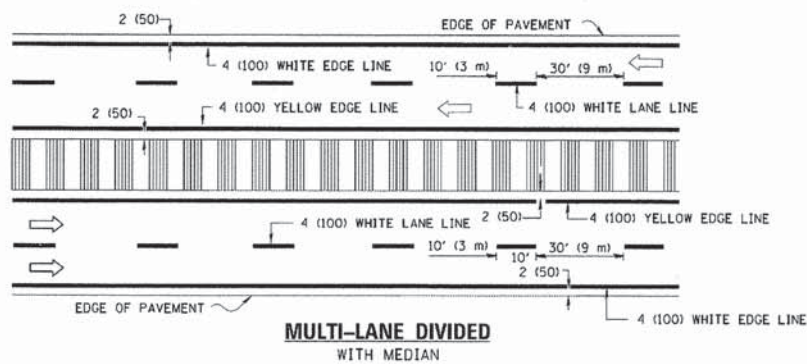

MULTI-LANE DIVIDED WITH MEDIAN

TYPICAL LANE AND EDGE LINE MARKING

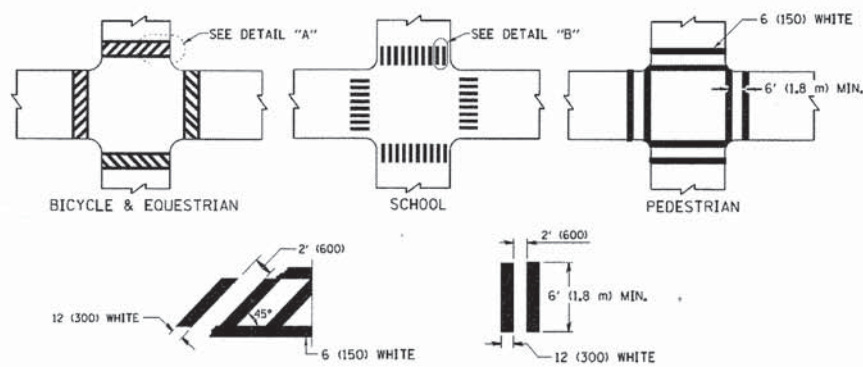

DETAIL "A"

DETAIL "B"

TYPICAL CROSSWALK MARKING

* MARKINGS SHALL BE INSTALLED PARALLEL TO THE CENTERLINE OF THE ROAD WHICH IT CROSSES

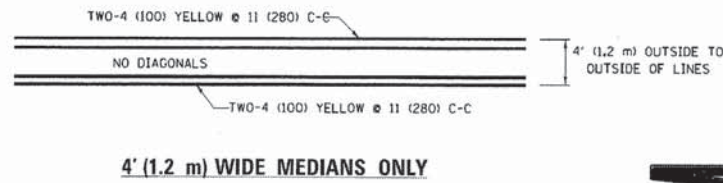

4' (1.2 m) WIDE MEDIANS ONLY

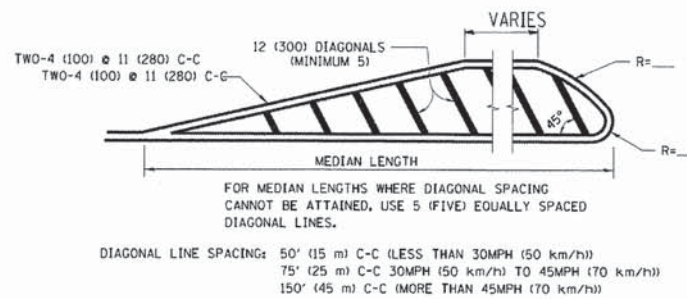

MEDIANS OVER 4' (1.2 m) WIDE

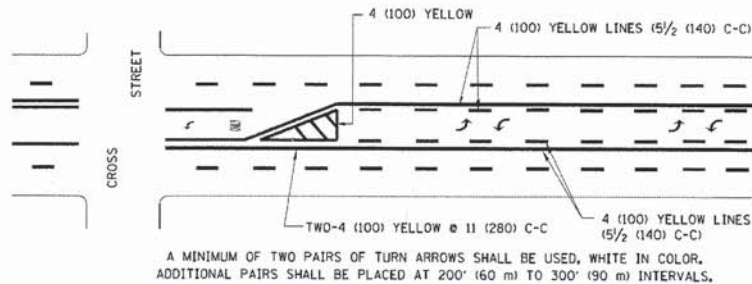

MEDIAN WITH TWO-WAY LEFT TURN LANE

TYPICAL PAINTED MEDIAN MARKING

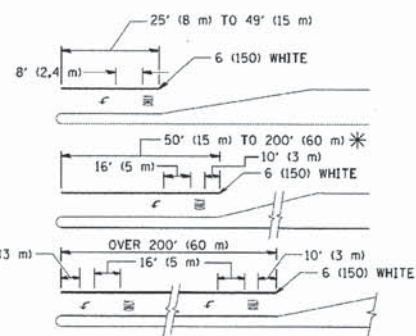

TYPICAL LEFT (OR RIGHT) TURN LANE

TYPICAL TURN LANE MARKING

FULL SIZE LETTERS 8' (2.4 m) AND ARROWS SHALL BE USED.
 * TURN LANES IN EXCESS OF 400' (120 m) IN LENGTH MAY HAVE AN ADDITIONAL SET OF ARROW - "ONLY" INSTALLED MIDWAY BETWEEN THE OTHER TWO SETS OF ARROW - "ONLY".

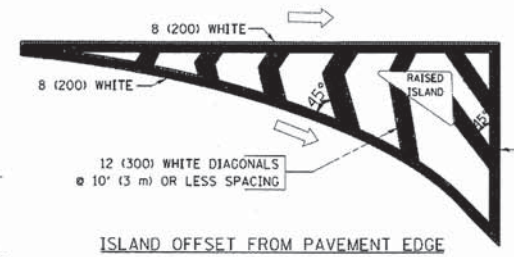

ISLAND OFFSET FROM PAVEMENT EDGE

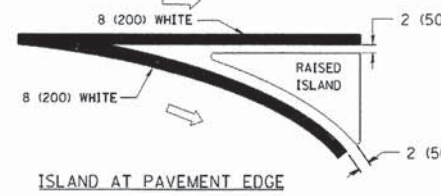

ISLAND AT PAVEMENT EDGE

TYPICAL ISLAND MARKING

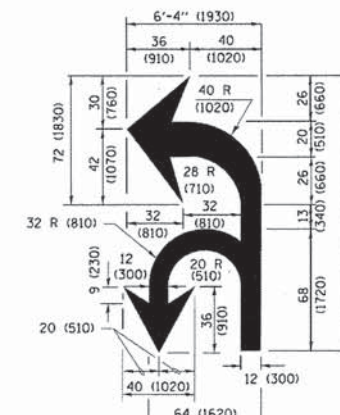

COMBINATION LEFT AND U-TURN

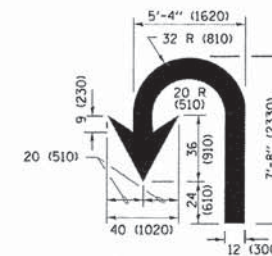

U-TURN

LANE REDUCTION TRANSITION

* LANE REDUCTION ARROWS REQUIRED AT SPEEDS OF 45 MPH OR GREATER OR WHEN SPECIFIED IN PLANS.

D(FT)	SPEED LIMIT
345	30
425	35
500	40
580	45
665	50
750	55

TYPE OF MARKING	WIDTH OF LINE	PATTERN	COLOR	SPACING /REMARKS
CENTERLINE ON 2 LANE PAVEMENT	4 (100)	SKIP-DASH	YELLOW	10' (3 m) LINE WITH 30' (9 m) SPACE
CENTERLINE ON MULTI-LANE UNDIVIDED PAVEMENT	2 @ 4 (100)	SOLID	YELLOW	11 (280) C-C
NO PASSING ZONE LINES: FOR ONE DIRECTION FOR BOTH DIRECTIONS	4 (100) 2 @ 4 (100)	SOLID SOLID	YELLOW YELLOW	5/2 (140) C-C FROM SKIP-DASH CENTERLINE 11 (280) C-C OMIT SKIP-DASH CENTERLINE BETWEEN
LANE LINES	4 (100) 5 (125) ON FREEWAYS	SKIP-DASH SKIP-DASH	WHITE WHITE	10' (3 m) LINE WITH 30' (9 m) SPACE
DOTTED LINES (EXTENSIONS OF CENTER, LANE OR TURN LANE MARKINGS)	SAME AS LINE BEING EXTENDED	SKIP-DASH	SAME AS LINE BEING EXTENDED	2' (600) LINE WITH 6' (1.8 m) SPACE
EDGE LINES	4 (100)	SOLID	YELLOW-LEFT WHITE-RIGHT	OUTLINE MEDIANS IN YELLOW
TURN LANE MARKINGS	6 (150) LINE, FULL SIZE LETTERS & SYMBOLS (8' (2.4m))	SOLID	WHITE	SEE TYPICAL TURN LANE MARKING DETAIL
TWO WAY LEFT TURN MARKING	2 @ 4 (100) EACH DIRECTION 8' (2.4m) LEFT ARROW	SKIP-DASH AND SOLID IN PAIRS	YELLOW WHITE	10' (3 m) LINE WITH 30' (9 m) SPACE FOR SKIP-DASH; 5/2 (140) C-C BETWEEN SOLID LINE AND SKIP-DASH LINE SEE TYPICAL TWO-WAY LEFT TURN MARKING DETAIL
CROSSWALK LINES (PEDESTRIAN) A. DIAGONALS (BIKE & EQUESTRIAN) B. LONGITUDINAL BARS (SCHOOL)	2 @ 6 (150) 12 (300) @ 45° 12 (300) @ 90°	SOLID SOLID SOLID	WHITE WHITE WHITE	NOT LESS THAN 6' (1.8 m) APART 2' (600) APART 2' (600) APART SEE TYPICAL CROSSWALK MARKING DETAILS.
STOP LINES	24 (600)	SOLID	WHITE	PLACE 4' (1.2 m) IN ADVANCE OF AND PARALLEL TO CROSSWALK, IF PRESENT, OTHERWISE, PLACE AT DESIRED STOPPING POINT, PARALLEL TO CROSSROAD CENTERLINE, WHERE POSSIBLE
PAINTED MEDIANS	2 @ 4 (100) WITH 12 (300) DIAGONALS @ 45° NO DIAGONALS USED FOR 4' (1.2 m) WIDE MEDIANS	SOLID	YELLOW TWO WAY TRAFFIC WHITE ONE WAY TRAFFIC	11 (280) C-C FOR THE DOUBLE LINE. SEE TYPICAL PAINTED MEDIAN MARKING.
CORE MARKING AND CHANNELIZING LINES	8 (200) WITH 12 (300) DIAGONALS @ 45°	SOLID	WHITE	DIAGONALS: 15' (4.5 m) C-C (LESS THAN 30MPH (50 km/h)) 20' (6 m) C-C (30MPH (50 km/h) TO 45MPH (70 km/h)) 30' (9 m) C-C (OVER 45MPH (70 km/h))
RAILROAD CROSSING	24 (600) TRANSVERSE LINES; "RR" IS 6' (1.8 m) LETTERS; 16 (400) LINE FOR "X"	SOLID	WHITE	SEE STATE STANDARD 780001 AREA OF: "R"=3.6 SQ. FT. (0.33 m ²) EACH "X"=54.0 SQ. FT. (5.0 m ²)
SHOULDER DIAGONALS (REQUIRED FOR SHOULDERS ≥ 8')	12 (300) @ 45°	SOLID	WHITE - RIGHT YELLOW - LEFT	50' (15 m) C-C (LESS THAN 30MPH (50 km/h)) 75' (25 m) C-C (30 MPH (50 km/h) TO 45MPH (70 km/h)) 150' (45 m) C-C (OVER 45MPH (70 km/h))
U TURN ARROW	SEE DETAIL	SOLID	WHITE	16.3 SF
2 ARROW COMBINATION LEFT AND U TURN	SEE DETAIL	SOLID	WHITE	30.4 SF

FOR FURTHER DETAILS ON PAVEMENT MARKING REFER TO STANDARD SPECIFICATIONS FOR ROAD AND BRIDGE CONSTRUCTION AND STATE STANDARD 780001.

All dimensions are in inches (millimeters) unless otherwise shown.

FILE NAME =	USER NAME = jaszekrf	DESIGNED - EVERS	REVISED - T. RAMMACHER 10-27-94
pw\l\l084EBID\INTEG\Illinois.gov\PI\DOT\Documents\DOT_D\Fiscan\District_1\Projects\Dist	DRAWN - CAD\dwg\ta\ta13.dgn	CHECKED -	REVISED - C. JUCIUS 09-09-09
Default	PLOT SCALE = 50.000' / in.	DATE - 03-19-90	REVISED - C. JUCIUS 07-01-13
	PLOT DATE = 12/21/2015		REVISED - C. JUCIUS 12-21-15

**STATE OF ILLINOIS
DEPARTMENT OF TRANSPORTATION**

DISTRICT ONE			
TYPICAL PAVEMENT MARKINGS			
SCALE: NONE	SHEET 1	OF 1 SHEETS	STA. TO STA.

F.A.U. RTE.	SECTION	COUNTY	TOTAL SHEETS	SHEET NO.
1359	15-00088-00-RS	COOK	17	13
TC-13			CONTRACT NO. 61C80	
ILLINOIS FED. AID PROJECT				

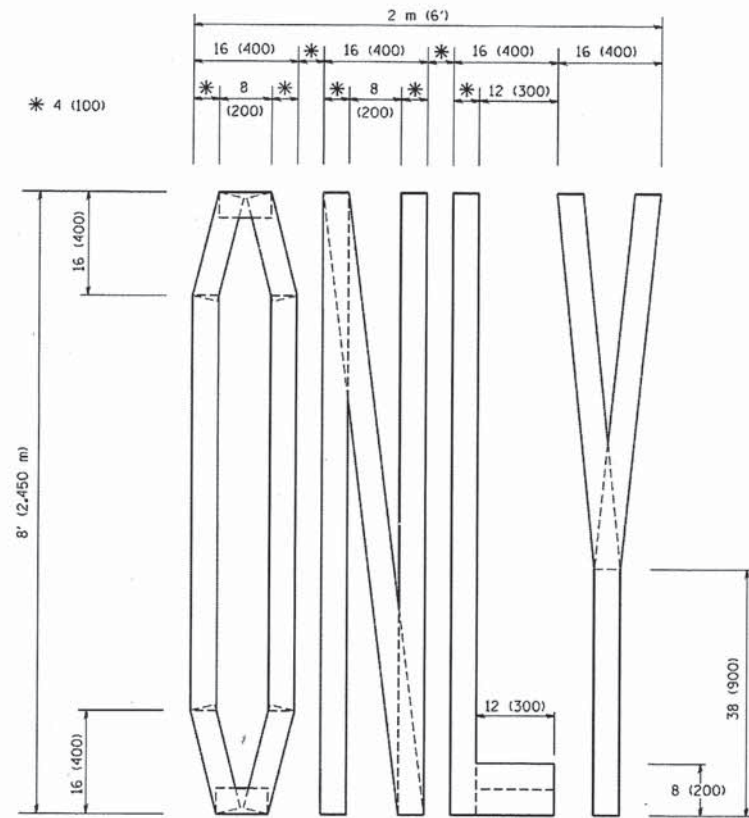

QUANTITY
 4 (100) LINE = 64.1 ft. (19.7 m)
 21.1 sq. ft. (1.97 sq. m)

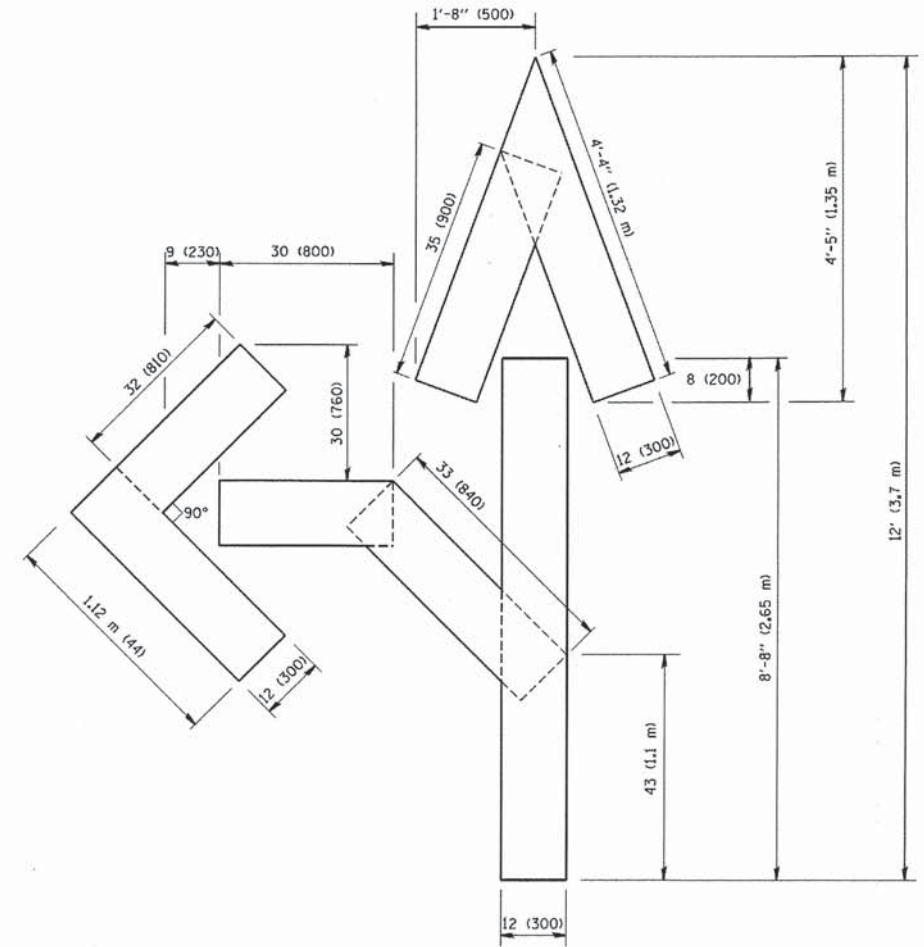

QUANTITY
 4 (100) LINE = 82.5 ft. (25.3 m)
 27.5 sq. ft. (2.53 sq. m)

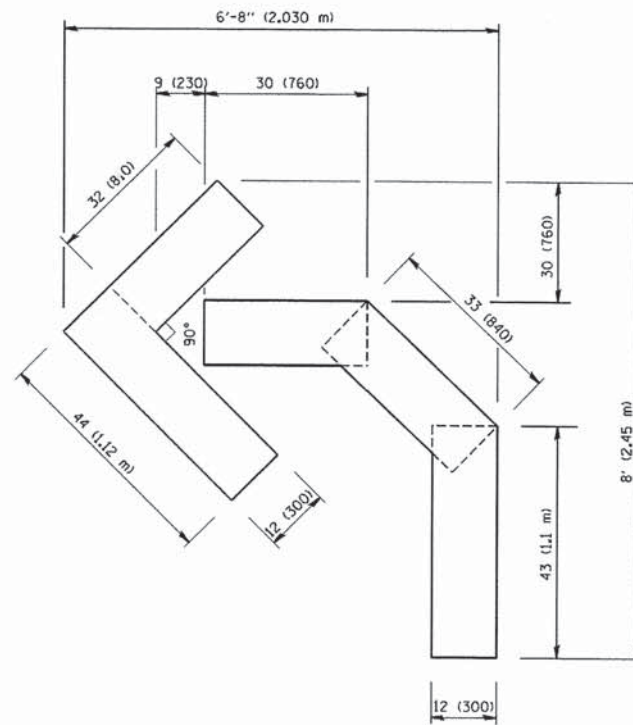

QUANTITY
 4 (100) LINE = 45.5 ft. (13.9 m)
 15.2 sq. ft. (1.39 sq. m)

All dimensions are in inches (millimeters) unless otherwise shown.

FILE NAME = W:\diststd\22x34\tel16.dgn	USER NAME = goglianobt	DESIGNED -	REVISED -T. RAMMACHER 06-05-96
		DRAWN -	REVISED -T. RAMMACHER 11-04-97
	PLOT SCALE = 50.0000 ' / IN.	CHECKED -	REVISED -T. RAMMACHER 03-02-98
	PLOT DATE = 1/4/2008	DATE = 09-18-94	REVISED -E. GOMEZ 08-28-00

STATE OF ILLINOIS
 DEPARTMENT OF TRANSPORTATION

PAVEMENT MARKING LETTERS AND SYMBOLS
 FOR TRAFFIC STAGING

SCALE: NONE SHEET NO. 1 OF 1 SHEETS STA. TO STA.

F.A.U. RTE.	SECTION	COUNTY	TOTAL SHEETS	SHEET NO.
1359	15-00088-00-RS	COOK	17	14
TC-16			CONTRACT NO. 61C80	
FED. ROAD DIST. NO. 1 ILLINOIS FED. AID PROJECT				

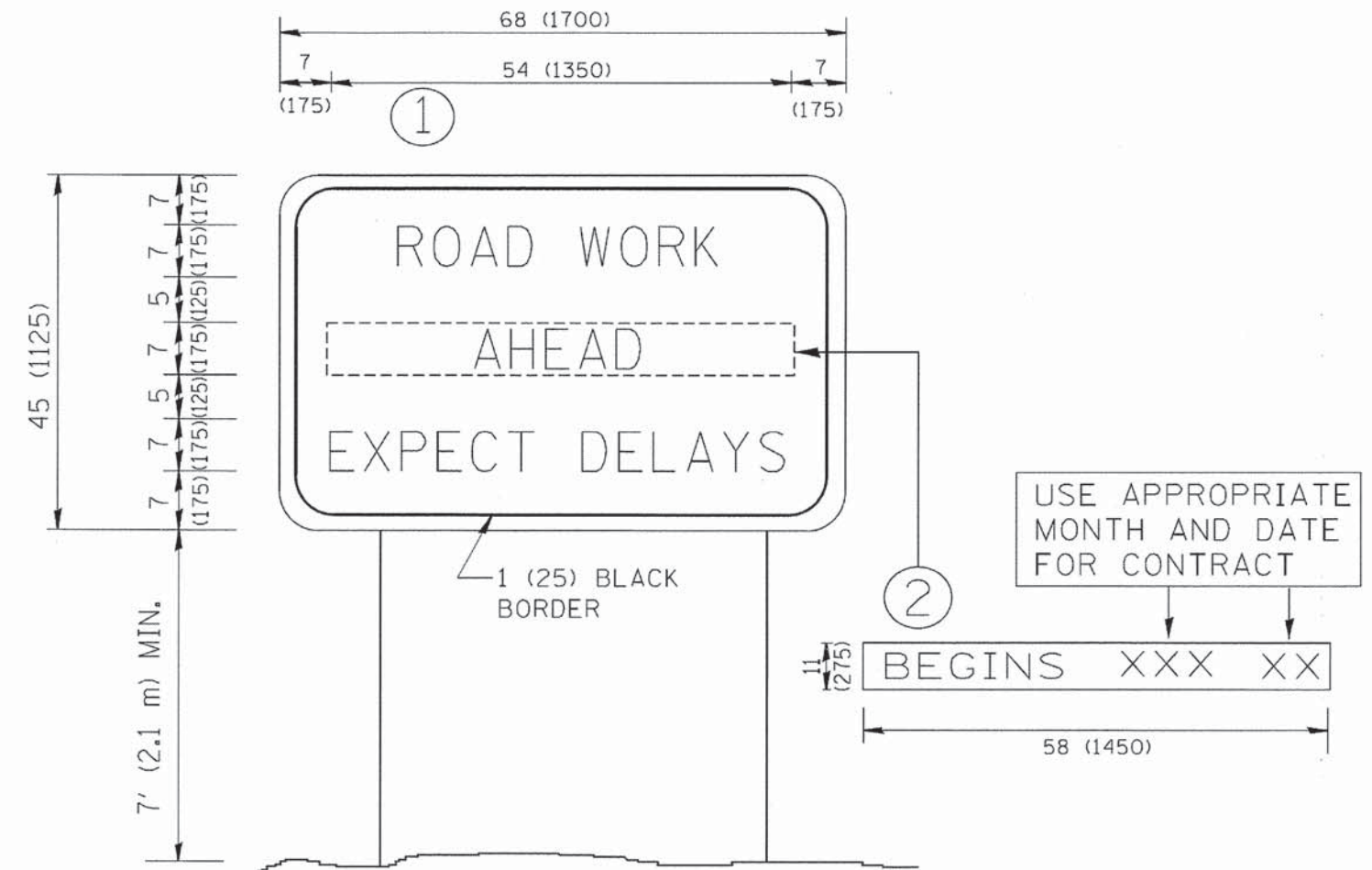

NOTES:

1. USE BLACK LETTERING ON ORANGE BACKGROUND.
2. ERECT SIGNS IN ADVANCE OF THE LOCATION FOR THE "ROAD CONSTRUCTION AHEAD" SIGN AT LOCATIONS AS DIRECTED BY THE ENGINEER.
3. ERECT SIGN ① WITH INSTALLED PANEL ② ONE WEEK PRIOR TO THE START OF CONSTRUCTION.
4. REMOVE PANEL ② SOON AFTER THE START OF CONSTRUCTION.
5. SEE SPECIAL PROVISION FOR "TEMPORARY INFORMATION SIGNING" FOR ADDITIONAL INFORMATION.
6. ONE SIGN ASSEMBLY EQUALS 25.70 SQ. FT. (2.3 SQ. M.)
7. SHALL BE PAID FOR AS TEMPORARY INFORMATION SIGNING.

ALL DIMENSIONS ARE IN INCHES (MILLIMETERS) UNLESS OTHERWISE SHOWN.

FILE NAME = W:\distatd\22x34\to22.dgn	USER NAME = goglienob	DESIGNED - DRAWN -	REVISED - R. MIRS 09-15-97 REVISED - R. MIRS 12-11-97
	PLOT SCALE = 50.000' / IN.	CHECKED -	REVISED - T. RAMMACHER 02-02-99
	PLOT DATE = 1/4/2008	DATE -	REVISED - C. JUCIUS 01-31-07

STATE OF ILLINOIS
DEPARTMENT OF TRANSPORTATION

ARTERIAL ROAD
INFORMATION SIGN

SCALE: NONE SHEET NO. 1 OF 1 SHEETS STA. TO STA.

F.A.U. RTE.	SECTION	COUNTY	TOTAL SHEETS	SHEET NO.
1359	15-00088-00-RS	COOK	17	15
TC-22			CONTRACT NO. 61C80	
FED. ROAD DIST. NO. 1 ILLINOIS FED. AID PROJECT				

TRAFFIC SIGNAL LEGEND

ITEM	REMOVAL	EXISTING	PROPOSED	ITEM	REMOVAL	EXISTING	PROPOSED	ITEM	REMOVAL	EXISTING	PROPOSED
CONTROLLER CABINET				EMERGENCY VEHICLE LIGHT DETECTOR				ELECTRIC CABLE IN CONDUIT, TRACER, NO. 14 1/2, UNLESS NOTED OTHERWISE			
RAILROAD CONTROL CABINET				CONFIRMATION BEACON				COAXIAL CABLE			
COMMUNICATIONS CABINET				HANDHOLE				VENDOR CABLE FOR CAMERA			
MASTER CONTROLLER				HEAVY DUTY HANDHOLE				COPPER INTERCONNECT CABLE, NO. 18 3 PAIR TWISTED, SHIELDED			
MASTER MASTER CONTROLLER				DOUBLE HANDHOLE				FIBER OPTIC CABLE NO. 62.5/125, MM12F			
UNINTERRUPTABLE POWER SUPPLY				JUNCTION BOX				FIBER OPTIC CABLE NO. 62.5/125, MM12F SM12F			
SERVICE INSTALLATION, (P) POLE OR (G) GROUND MOUNT				UNDERGROUND CONDUIT, GALVANIZED STEEL (UC)				FIBER OPTIC CABLE NO. 62.5/125, MM12F SM24F			
TELEPHONE CONNECTION (P) POLE OR (G) GROUND MOUNT				TEMPORARY SPAN WIRE, TETHER WIRE, AND CABLE							
STEEL MAST ARM ASSEMBLY AND POLE				COMMON TRENCH							
ALUMINUM MAST ARM ASSEMBLY AND POLE				COILABLE NONMETALLIC CONDUIT (EMPTY)							
STEEL COMBINATION MAST ARM ASSEMBLY AND POLE WITH LUMINAIRE				SYSTEM ITEM		S	S				
STEEL COMBINATION MAST ARM ASSEMBLY AND POLE WITH PTZ CAMERA				INTERSECTION ITEM		I	IP				
SIGNAL POST				REMOVE ITEM	R						
TEMPORARY WOOD POLE (CLASS 5 OR BETTER) 45 FOOT (13.7m) MINIMUM				RELOCATE ITEM	RL						
GUY WIRE				ABANDON ITEM	A						
SIGNAL HEAD				12" (300mm) TRAFFIC SIGNAL SECTION							
SIGNAL HEAD CONSTRUCTION STAGES (NUMBERS INDICATE THE CONSTRUCTION STAGE)				12" (300mm) RED WITH 8" (200mm) YELLOW AND GREEN TRAFFIC SIGNAL FACE							
SIGNAL HEAD WITH BACKPLATE				SIGNAL FACE							
SIGNAL HEAD OPTICALLY PROGRAMMED				SIGNAL FACE WITH BACKPLATE, "P" INDICATES PROGRAMMED HEAD							
FLASHER INSTALLATION (S DENOTES SOLAR POWER)				"RB" INDICATES REFLECTIVE BACKPLATE							
PEDESTRIAN SIGNAL HEAD				12" (300mm) PEDESTRIAN SIGNAL HEAD WALK/DON'T WALK SYMBOL							
PEDESTRIAN PUSHBUTTON DETECTOR				12" (300mm) PEDESTRIAN SIGNAL HEAD INTERNATIONAL SYMBOL, OUTLINED							
ACCESSIBLE PEDESTRIAN PUSHBUTTON DETECTOR				12" (300mm) PEDESTRIAN SIGNAL HEAD INTERNATIONAL SYMBOL, SOLID							
ILLUMINATED SIGN "NO LEFT TURN"				PEDESTRIAN SIGNAL HEAD, INTERNATIONAL SYMBOL, WITH COUNTDOWN TIMER							
ILLUMINATED SIGN "NO RIGHT TURN"				RADIO INTERCONNECT							
DETECTOR LOOP, TYPE I				RADIO REPEATER							
PERFORMED DETECTOR LOOP				DENOTES NUMBER OF CONDUCTORS, ELECTRIC CABLE NO. 14, UNLESS NOTED OTHERWISE, ALL DETECTOR LOOP CABLE TO BE SHIELDED							
MICROWAVE VEHICLE SENSOR				GROUND CABLE IN CONDUIT NO. 6 SOLID COPPER (GREEN)							
VIDEO DETECTION CAMERA											
VIDEO DETECTION ZONE											
PAN, TILT, ZOOM CAMERA											
WIRELESS DETECTOR SENSOR											
WIRELESS ACCESS POINT											

RAILROAD SYMBOLS

	EXISTING	PROPOSED
RAILROAD CONTROL CABINET		
RAILROAD CANTILEVER MAST ARM		
FLASHING SIGNAL		
CROSSING GATE		
CROSSBUCK		

