

06-10-2016 LETTING ITEM 208

STATE OF ILLINOIS  
DEPARTMENT OF TRANSPORTATION  
DIVISION OF HIGHWAYS

**PLANS FOR PROPOSED  
LOCAL AGENCY PROJECT**  
TRANSPORTATION ALTERNATIVES  
O'FALLON SAFE ROUTES TO SCHOOLS IMPROVEMENTS  
SECTION 15-00070-00-SW  
PROJECT NO. TE-00D8 (210)  
CITY OF O'FALLON, ILLINOIS  
ST. CLAIR COUNTY, ILLINOIS  
JOB NO. C-98-309-15

F.A.U. ROUTE	SECTION	COUNTY	TOTAL SHEETS	SHEET NUMBER
N/A	15-00070-00-SW	ST. CLAIR	20	1
FEDERAL AID PROJECT		CONTRACT 97628		



**INDEX OF SHEETS**

1. COVER SHEET
2. GENERAL NOTES, HIGHWAY STANDARDS & UTILITIES
3. SUMMARY OF QUANTITIES
- 4.-5. TYPICAL SECTIONS
- 6.-7. CONSTRUCTION SCHEDULES
8. PLAN VIEW - ESTELLE KAMPMEYER SCHOOL
9. SIDEWALK PROFILE - ESTELLE KAMPMEYER SCHOOL
- 10.-11. PLAN & PROFILE - MARIE SCHAEFER SCHOOL
- 12.-13. PLAN & PROFILE - HINCHCLIFFE SCHOOL
14. DRAINAGE PROFILES
- 15.-20. CROSS SECTIONS

**SCALES:**

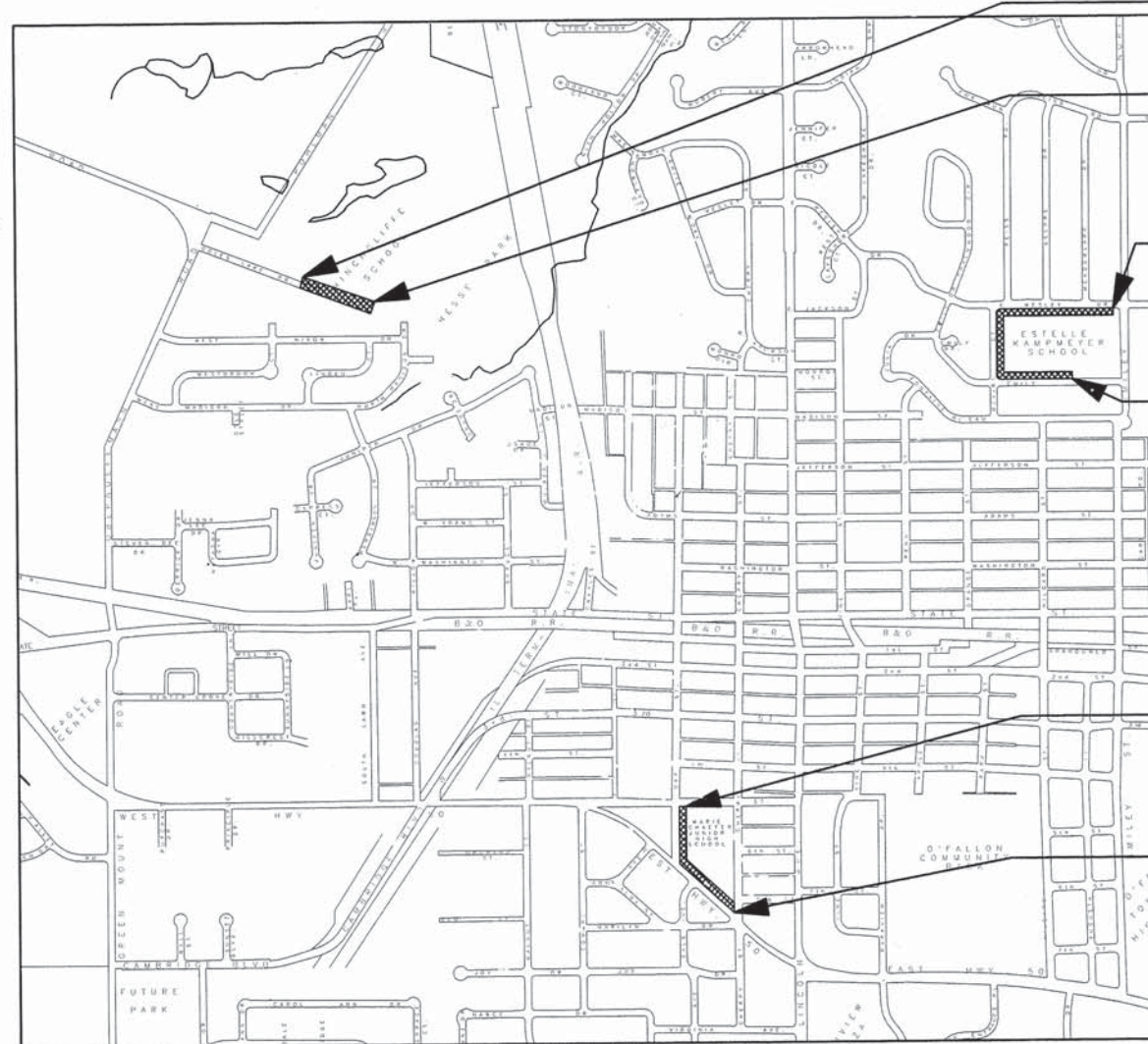
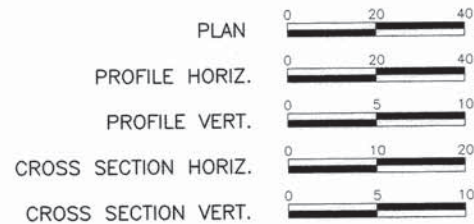

PROJECT BEGIN STA. 10+32.71  
HINCHCLIFFE SCHOOL

PROJECT END STA. 18+91.68  
HINCHCLIFFE SCHOOL

PROJECT END STA. 20+83.80  
ESTELLE KAMPMEYER SCHOOL

PROJECT BEGIN STA. 0+00.00  
ESTELLE KAMPMEYER SCHOOL

PROJECT END STA. 110+18.32  
MARIE SCHAEFER SCHOOL

PROJECT BEGIN STA. 100+53.51  
MARIE SCHAEFER SCHOOL

LOCATION MAP  
NOT TO SCALE

**HOLD IT! CALL BEFORE YOU DIG!**  
Phone J.U.L.I.E.



The owner would like to remind you that underground utility facilities can be damaged by shovel blades or other digging equipment. You can prevent damage or possible personal danger by phoning 800/892-0123 at least 48 hours before you dig. That's the toll-free number for "J.U.L.I.E.", which stands for Joint Utilities Location Information for Excavators.

If there are any pipes, cables, lines or mains in the excavation area, utility personnel will be out to mark the facilities so you can work around them.

Toll Free 800/892-0123

ESTELLE KAMPMEYER SCHOOL	- STA. 0+00.00 TO 20+83.80	2,083.80 FT. = 0.395 MILES
HINCHCLIFFE SCHOOL	- STA. 10+32.71 TO 18+91.68	858.97 FT. = 0.163 MILES
MARIE SCHAEFER SCHOOL	- STA 100+53.51 TO 110+18.32	964.81 FT. = 0.183 MILES
NET LENGTH OF IMPROVEMENT		3,907.58 FT. = 0.740 MILES



*Anthony A. Schenk*  
4/4/16  
Date of Signing  
11/30/17  
Date of License Expiration



**RHUTASEL and ASSOCIATES, INC.**  
CONSULTING ENGINEERS • LAND SURVEYORS

CORPORATE OFFICE  
4 INDUSTRIAL DRIVE  
FREEBURG, ILLINOIS 62243  
(618) 539-3178

REGIONAL OFFICE  
201 SOUTH LOCUST STREET  
CENTRALIA, ILLINOIS 62801  
(618) 532-1992

STATE OF ILLINOIS  
DEPARTMENT OF TRANSPORTATION

APPROVED: 3/31/16 DATE  
*Amy Z. Abraham*  
MAYOR, CITY OF O'FALLON

PASSED: 4/12/16 DATE  
*Anthony A. Schenk*  
DISTRICT EIGHT ENGINEER OF LOCAL ROADS & STREETS

RELEASING FOR BID  
BASED ON LIMITED  
REVIEW: 4/12/16 DATE  
*Jeffrey S. Klein*  
REGION FIVE ENGINEER

\* PRINTED BY AUTHORITY OF THE STATE OF ILLINOIS \*

PREPARED BY:

GENERAL NOTES

F.A.U. ROUTE	SECTION	COUNTY	TOTAL SHEETS	SHEET NUMBER
N/A	15-00070-00-SW	ST. CLAIR	20	2
FEDERAL AID PROJECT		CONTRACT 97628		

- 1.) ALL CONSTRUCTION SHALL BE ACCORDING TO THE ILLINOIS DEPARTMENT OF TRANSPORTATION STANDARD SPECIFICATIONS FOR ROAD AND BRIDGE CONSTRUCTION, ADOPTED APRIL 1, 2016.
- 2.) ALL PROPOSED EMBANKMENT SHALL BE BENCHED INTO THE EXISTING SLOPES TO THE SATISFACTION OF THE ENGINEER.
- 3.) THE CONTRACTOR SHALL VERIFY ALL DIMENSIONS AND CONDITIONS IN THE FIELD PRIOR TO ORDERING OF MATERIALS AND CONSTRUCTION.
- 4.) "ROAD CONSTRUCTION AHEAD" SIGNS SHALL BE PLACED AT THE BEGINNING AND END OF THE PROJECT PLUS THE INTERSECTING SIDE ROADS AND WILL BE INCLUDED IN THE TRAFFIC CONTROL PAY ITEMS. ALL CONSTRUCTION SIGNS SHALL BE FLUORESCENT ORANGE 48"x48".
- 5.) ALL AREAS DISTURBED FOR ANY REASON WITHIN THE CONSTRUCTION LIMITS SHALL BE SEEDED WITH CLASS 1 SEEDING. NUTRIENTS SHALL CONFORM TO ARTICLE 250.04. AREAS DISTURBED BEYOND THE CONSTRUCTION LIMITS SHALL BE SEEDED BY THE CONTRACTOR AT HIS/HER OWN EXPENSE.
- 6.) THE CONTRACTOR SHALL COORDINATE WITH RESIDENTS PRIOR TO REMOVAL AND REPLACEMENT OF DRIVEWAYS.
- 7.) PROTECTIVE COAT SHALL BE APPLIED TO ALL GUTTER FLAGS AND FACE OF CURBS.
- 8.) LANDSCAPING ITEMS WITHIN THE LIMITS OF CONSTRUCTION WHICH MUST BE REMOVED SHALL BE SALVAGED FOR RE-USE OR DISPOSAL AS DIRECTED BY THE ENGINEER. REMOVAL AND/OR SALVAGE OF LANDSCAPING ITEMS SHALL BE INCLUDED IN THE COST OF THE CONTRACT.
- 9.) ALL EXISTING SIGNS WHICH INTERFERE WITH THE IMPROVEMENTS NOT NOTED FOR REMOVAL SHALL BE REMOVED AND REINSTALLED AT THEIR PERMANENT LOCATIONS AS DIRECTED BY THE ENGINEER IN THE FIELD. THIS WORK SHALL BE INCLUDED IN THE COST OF THE CONTRACT.
- 10.) THE TOP 6 INCHES OF ALL NECESSARY BACKFILL SHALL BE FREE FROM ALL ROCKS AND FOREIGN DEBRIS.
- 11.) EXISTING UTILITIES SHOWN ARE LOCATED FROM OR INFORMATION PROVIDED BY THE RESPECTIVE UTILITIES AND MUST BE CONSIDERED APPROXIMATE. THERE MAY BE OTHERS, THE EXACT LOCATION OF WHICH ARE UNKNOWN AND NOT SHOWN. THE CONTRACTOR WILL BE RESPONSIBLE FOR NOTIFYING THE RESPECTIVE UTILITIES BEFORE WORK IS BEGUN. FIELD MARKINGS OF UNDERGROUND UTILITIES MAY BE OBTAINED BY PROVIDING A MINIMUM OF 48 HOURS ADVANCE NOTICE THROUGH THE J.U.L.I.E. SYSTEM BY CALLING 1-800-892-0123 OR BY DIRECT CONTACT WITH NON-MEMBERS OF J.U.L.I.E.
- 12.) FACTORS USED FOR QUANTITY CALCULATIONS ARE AS FOLLOWS:
 

SEEDING	
NITROGEN FERTILIZER NUTRIENT	90 LBS/ACRE
PHOSPHORUS FERTILIZER NUTRIENT	90 LBS/ACRE
POTASSIUM FERTILIZER NUTRIENT	90 LBS/ACRE
MULCH	2 TONS/ACRE

<u>UTILITY TYPE</u>	<u>NAME OF UTILITY</u>	<u>PHONE NUMBER</u>	<u>CONTACT NAME</u>
ELECTRIC	AMEREN IP	618-236-4309	JASON KLEIN
GAS	AMEREN IP	618-236-4309	JASON KLEIN
WATER	CITY OF O'FALLON	618-624-4500 EXT. 3	HEIDE BELL
TELEPHONE	AT&T	618-346-6422	DEAN LITZENBURG
CABLE	CHARTER COMMUNICATIONS	618-374-7058	SARAH BISHOP
SANITARY SEWER	CASEYVILLE TOWNSHIP	618-632-2414	JOSEPH HOGG

COMMITMENTS

- 1.) NO COMMITMENTS AT THIS TIME.

APPLICABLE HIGHWAY STANDARDS

280001-07	604036-03
424001-08	606001-06
424016-02	701501-06
602301-04	701801-06
602306-03	701901-05
602601-04	

F.A.U. ROUTE	SECTION	COUNTY	TOTAL SHEETS	SHEET NUMBER
N/A	15-00070-00-SW	ST. CLAIR	20	3
FEDERAL AID PROJECT		CONTRACT 97628		

SUMMARY OF QUANTITIES

CODE NUMBER	ITEM DESCRIPTION	UNIT	QUANTITY
20200100	EARTH EXCAVATION	CU YD	248
20400800	FURNISHED EXCAVATION	CU YD	162
25000100	SEEDING, CLASS 1	ACRE	0.55
25000400	NITROGEN FERTILIZER NUTRIENT	POUND	51
25000500	PHOSPHORUS FERTILIZER NUTRIENT	POUND	51
25000600	POTASSIUM FERTILIZER NUTRIENT	POUND	51
25100115	MULCH, METHOD 2	ACRE	0.55
28000250	TEMPORARY EROSION CONTROL SEEDING	POUND	55
28000500	INLET AND PIPE PROTECTION	EACH	7
35101600	AGGREGATE BASE COURSE, TYPE B 4"	SQ YD	70
35102000	AGGREGATE BASE COURSE, TYPE B 8"	SQ YD	11
40800050	INCIDENTAL HOT-MIX ASPHALT SURFACING	TON	38
42001300	PROTECTIVE COAT	SQ YD	148
42300200	PORTLAND CEMENT CONCRETE DRIVEWAY PAVEMENT, 6 INCH	SQ YD	70
42400100	PORTLAND CEMENT CONCRETE SIDEWALK 4 INCH	SQ FT	17,605
42400800	DETECTABLE WARNINGS	SQ FT	74
44000100	PAVEMENT REMOVAL	SQ YD	91
44000200	DRIVEWAY PAVEMENT REMOVAL	SQ YD	70
44000500	COMBINATION CURB AND GUTTER REMOVAL	FOOT	20
44000600	SIDEWALK REMOVAL	SQ FT	165
50104400	CONCRETE HEADWALL REMOVAL	EACH	2
50105220	PIPE CULVERT REMOVAL	FOOT	50
542A0217	PIPE CULVERTS, CLASS A, TYPE 1 12"	FOOT	40
542A0223	PIPE CULVERTS, CLASS A, TYPE 1 18"	FOOT	22
550A2320	STORM SEWERS, RUBBER GASKET, CLASS A, TYPE 1 12"	FOOT	195
550A2360	STORM SEWERS, RUBBER GASKET, CLASS A, TYPE 1 24"	FOOT	6
60236200	INLETS, TYPE A, TYPE B GRATE	EACH	2
60240301	INLETS, TYPE B TYPE B GRATE	EACH	1
60604400	COMBINATION CONCRETE CURB AND GUTTER, TYPE B-6.18	FOOT	400
Δ 66400105	CHAIN LINK FENCE, 4'	FOOT	28
Δ 66900200	NON SPECIAL WAST DISPOSAL	CU YD	75
Δ 66900450	SPECIAL WASTE PLANS AND REPORTS	L SUM	1
Δ 66900530	SOIL DISPOSAL ANALYSIS	EACH	1
67100100	MOBILIZATION	L SUM	1
X6024242	INLETS, SPECIAL, NO. 1	EACH	3
X6026200	INLETS TO BE ADJUSTED (SPECIAL)	EACH	1
X6062400	CONCRETE GUTTER (SPECIAL)	FOOT	203
X7010216	TRAFFIC CONTROL AND PROTECTION, (SPECIAL)	L SUM	1
Z0022800	FENCE REMOVAL	FOOT	40

Δ SPECIALTY ITEMS

F.A.U. ROUTE	SECTION	COUNTY	TOTAL SHEETS	SHEET NUMBER
N/A	15-00070-00-SW	ST. CLAIR	20	4
FEDERAL AID PROJECT		CONTRACT 97628		

**ESTELLE KAMPMEYER SCHOOL**

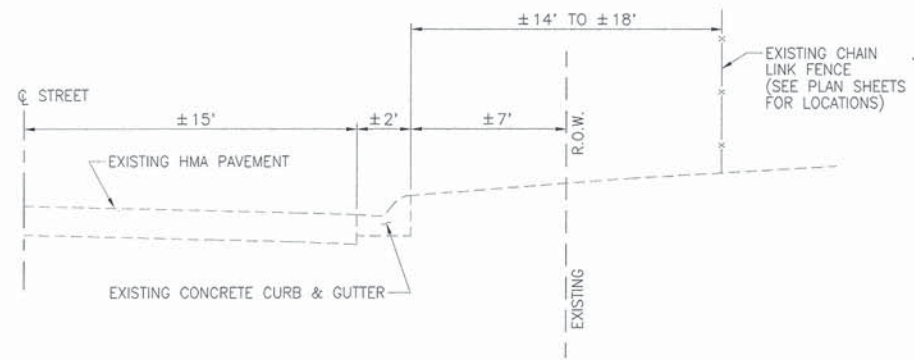

**EXISTING TYPICAL SECTION**  
N.T.S.

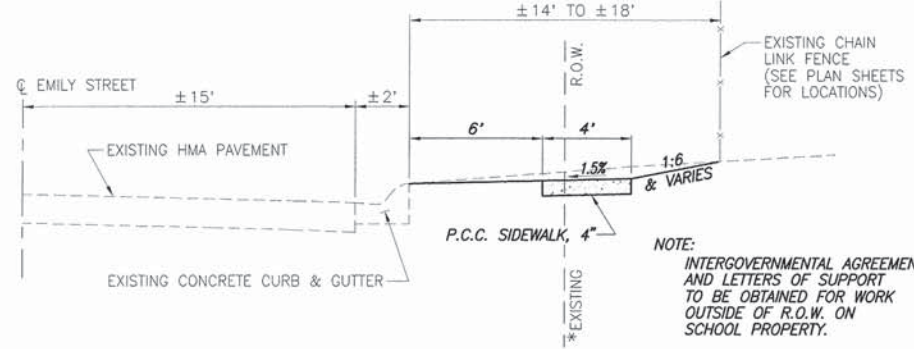

**PROPOSED TYPICAL SECTION**  
EMILY STREET  
N.T.S.

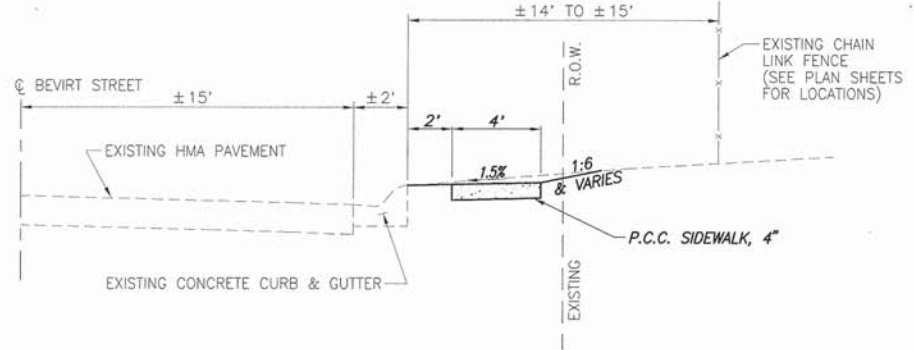

**PROPOSED TYPICAL SECTION**  
BEVIRT STREET  
N.T.S.

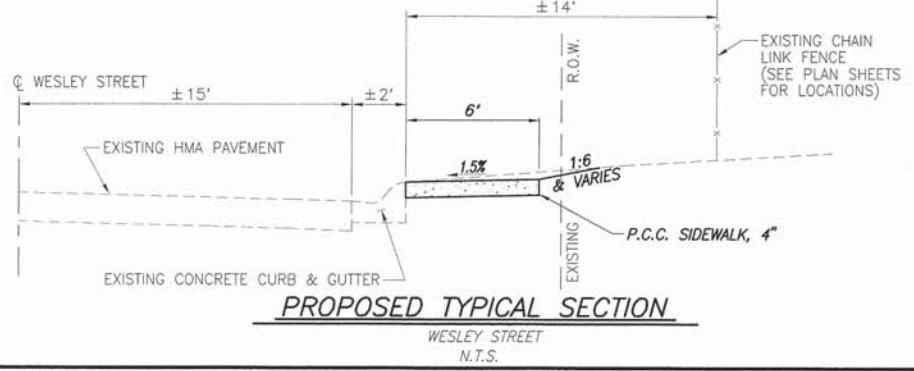

**PROPOSED TYPICAL SECTION**  
WESLEY STREET  
N.T.S.

**J.E. HINCLIFFE SCHOOL**

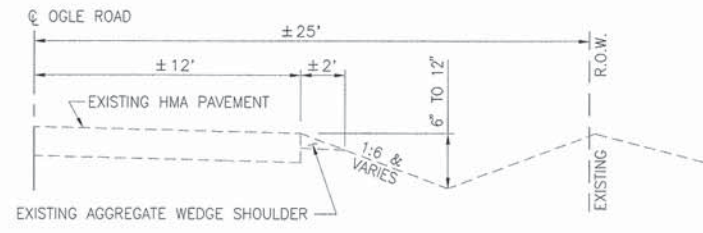

**EXISTING TYPICAL SECTION**  
STA. 10+32.71 TO 14+46.08  
N.T.S.

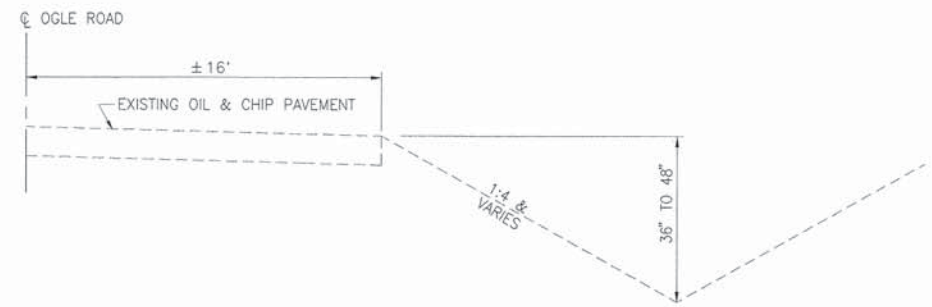

**EXISTING TYPICAL SECTION**  
STA. 14+46.08 TO 18+91.68 (SCHOOL PROPERTY)  
N.T.S.

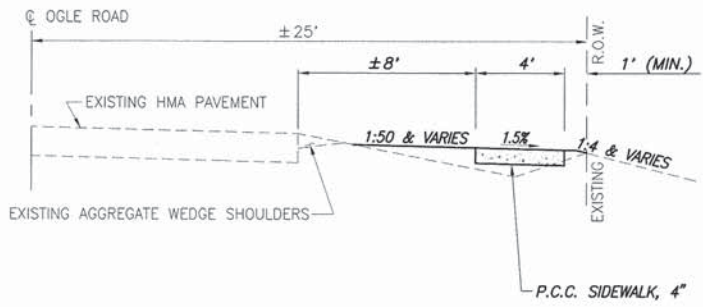

**PROPOSED TYPICAL SECTION**  
STA. 10+32.71 TO 12+82.47  
N.T.S.

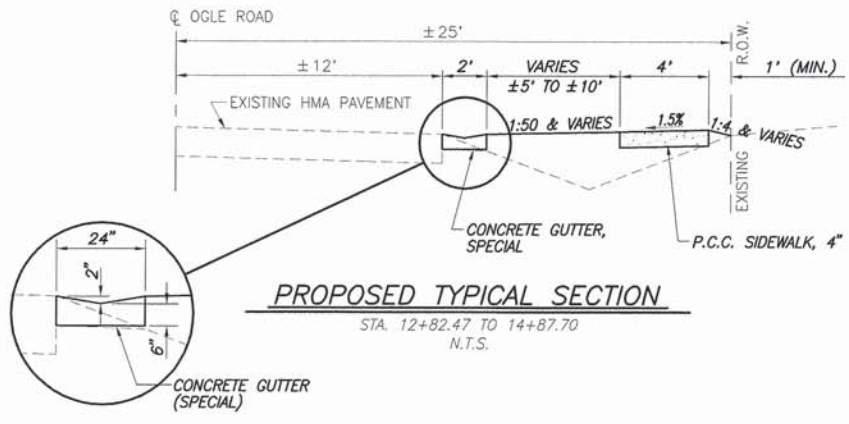

**PROPOSED TYPICAL SECTION**  
STA. 12+82.47 TO 14+87.70  
N.T.S.

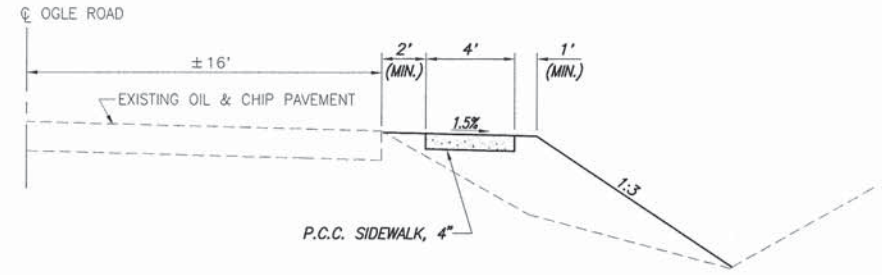

**PROPOSED TYPICAL SECTION**  
STA. 14+87.70 TO 18+91.68 (SCHOOL PROPERTY)  
N.T.S.

**MARIE SCHAEFFER SCHOOL**

F.A.U. ROUTE	SECTION	COUNTY	TOTAL SHEETS	SHEET NUMBER
N/A	15-00070-00-SW	ST. CLAIR	20	5
FEDERAL AID PROJECT		CONTRACT 97628		

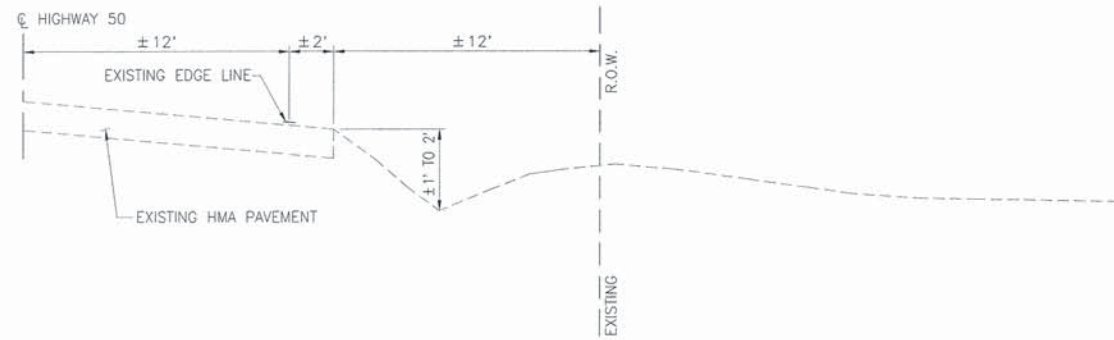

**EXISTING TYPICAL SECTION**

HIGHWAY 50  
STA. 100+53.51 TO 106+37.64  
N.T.S.

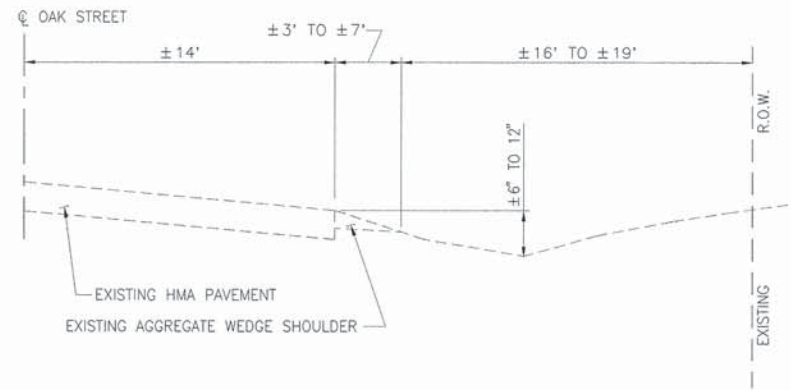

**EXISTING TYPICAL SECTION**

OAK STREET  
STA. 106+37.64 TO 110+11.04  
N.T.S.

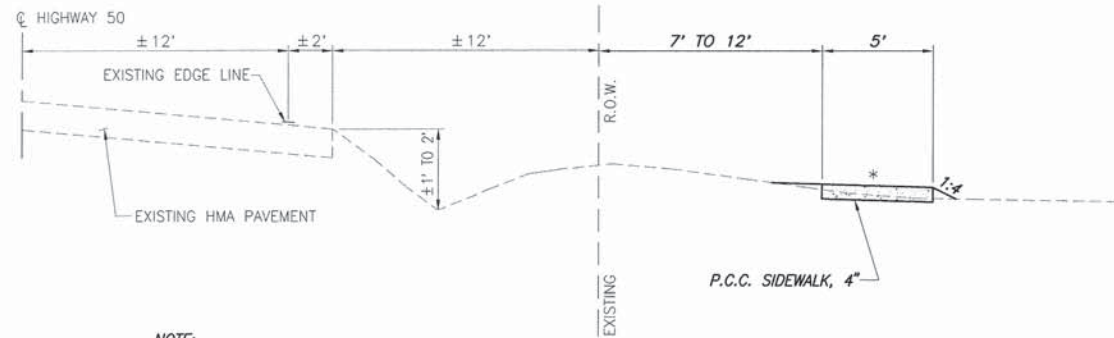

**PROPOSED TYPICAL SECTION**

HIGHWAY 50  
STA. 100+53.51 TO 106+37.64  
N.T.S.

**NOTE:**  
INTERGOVERNMENTAL AGREEMENT  
AND LETTERS OF SUPPORT  
TO BE OBTAINED FOR WORK  
OUTSIDE OF R.O.W. ON  
SCHOOL PROPERTY.

\* SLOPE 1.5% AWAY FROM ROAD STA. 100+53.51 TO 102+87.80  
SLOPE 1.5% TOWARD ROAD STA. 102+87.80 TO 106+37.64

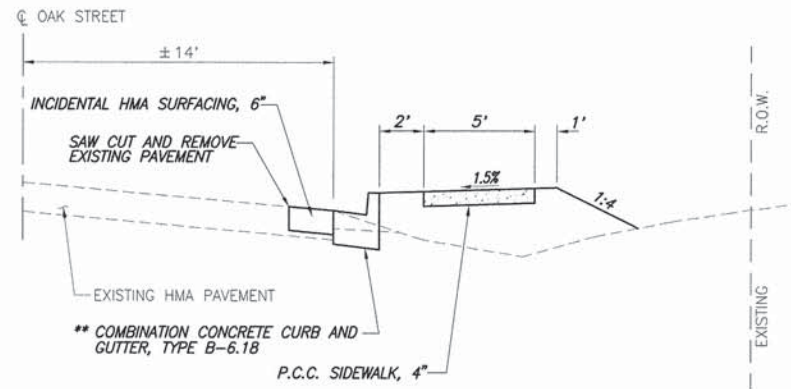

**PROPOSED TYPICAL SECTION**

OAK STREET  
STA. 106+37.64 TO 110+18.32  
N.T.S.

\*\* - END STA. 110+11.13  
\*\*\* - VARIES 2' TO 10' STA. 109+87.87 TO 110+18.32

P:\2015\2015-08-18\15-00070-00-SW\15-00070-00-SW.dwg, 4/1/2016 9:11:07 AM, Plotter: 6, 104

F.A.U. ROUTE	SECTION	COUNTY	TOTAL SHEETS	SHEET NUMBER
N/A	15-00070-00-SW	ST. CLAIR	20	6
FEDERAL AID PROJECT		CONTRACT 97628		

**PCC SIDEWALK SCHEDULE**

LOCATION	P.C.C. SIDEWALK, 4"	DETECTABLE WARNINGS
	SQ FT	SQ FT
ESTELLE KAMPMEYER SCHOOL		
STA. 0+00 TO 0+36	144	---
STA. 0+70 TO 3+29	1,036	---
STA. 3+80 TO 12+68	3,698	---
STA. 12+84 TO 15+55	1,626	---
STA. 15+71 TO 17+72	1,206	---
STA. 18+28 TO 20+84	1,536	---
MARIE SCHAEFER SHOOOL		
STA. 100+54 TO 106+70	3,140	---
STA. 106+68 (SOUTH SCHOOL ENT.)	---	12
STA. 106+36 (EAST OF OAK)	---	10
STA. 106+42 TO 106+46 (WEST OF OAK)	42	10
STA. 107+19 TO 110+18	1,793	---
STA. 107+24 (NORTH SCHOOL ENT.)	---	22
STA. 110+17	---	8
HINCHCLIFFE SCHOOL		
STA. 10+33 TO 13+67	1,340	---
STA. 13+85 TO 18+92	2,044	---
STA. 18+85	---	10
TOTAL	17,605	74

**ENTRANCE SCHEDULE**

STATION	EXISTING SURFACE	TYPE	"L"	"W"	DRIVEWAY PAV'T	INCIDENTAL HMA	AGGREGATE BASE	PCC DRIVEWAY	AGGREGATE BASE	COMMENTS
			FOOT	FOOT	REMOVAL	SURFACING	COURSE, TYPE B, 8"	PAVEMENT, 6"	COURSE, TYPE B 4"	
			SQ. YD.	TON	SQ. YD.	SQ. YD.	SQ. YD.	SQ. YD.		
MARIE SCHAEFER SHOOOL										
106+97 RT.	ASPHALT	C.E.	16.7	24.0	70	4	11	46	46	MEASURED ALONG C
OAK STREET BETWEEN CURB AND EXISTING PAVEMENT						34	---	---	---	---
HINCHCLIFFE SCHOOL										
121+95.28 RT.	ASPHALT	P.E.	6.0	13.9	---	---	---	24	24	---
TOTAL					70	38	11	70	70	---

**MISCELLANEOUS SCHEDULE**

LOCATION	FENCE REMOVAL	CHAIN LINK FENCE, 4'	CONCRETE GUTTER (SPECIAL)	COMBINATION CURB & GUTTER REMOVAL	COMBINATION CONCRETE CURB AND GUTTER, TYPE B-6.18	PAVEMENT REMOVAL	SIDEWALK REMOVAL	CONCRETE HEADWALL REMOVAL	PIPE CULVERT REMOVAL
	FOOT	FOOT	FOOT	FOOT	FOOT	SQ. YD.	SQ. FT.	EACH	FOOT
ESTELLE KAMPMEYER SCHOOL									
STA. 3+71 TO 3+92	---	---	---	---	---	---	90	---	---
STA. 11+63 TO 12+01	40	28	---	---	---	---	---	---	---
STA. 17+72 TO 18+28	---	---	---	20	20	---	---	---	---
MARIE SCHAEFER SHOOOL									
STA. 106+33 TO 110+18	---	---	---	---	380	91	---	---	---
STA. 107+45	---	---	---	---	---	---	---	---	10
STA. 110+13 TO 110+22	---	---	---	---	---	---	75	---	---
STA. 110+15	---	---	---	---	---	---	---	---	20
HINCHCLIFFE SCHOOL									
STA. 12+82 TO 14+85	---	---	203	---	---	---	---	---	---
STA. 13+76	---	---	---	---	---	---	---	---	20
STA. 15+05	---	---	---	---	---	---	---	1	---
STA. 16+95	---	---	---	---	---	---	---	1	---
TOTAL	40	28	203	20	400	91	165	2	50

**SEEDING SCHEDULE**

LOCATION	SEEDING CLASS 1 ACRE	MULCH METHOD 2 ACRE	FERTILIZER NUTRIENTS			TEMPORARY EROSION CONTROL SEEDING
			NITROGEN POUND	PHOSPHORUS POUND	POTASSIUM POUND	POUND
ESTELLE KAMPMEYER SCHOOL	0.25	0.25	23	23	23	25
MARIE SCHAEFER SHOOOL	0.15	0.15	14	14	14	15
HINCHCLIFFE SCHOOL	0.15	0.15	14	14	14	15
TOTAL	0.55	0.55	51	51	51	55

**EARTHWORK SCHEDULE**

LOCATION	EARTH EXCAVATION	EARTH EXCAVATION ADJUSTED FOR SHRINKAGE (25%)	EMBANKMENT	EARTHWORK BALANCE WASTE (+) OR SHORTAGE (-)	FURNISHED EXCAVATION
	CU YD	CU YD	CU YD	CU YD	CU YD
ESTELLE KAMPMEYER SCHOOL	171	128	0	+128	0
MARIE SCHAEFER SHOOOL	47	35	109	-74	74
HINCHCLIFFE SCHOOL	30	23	111	-88	88
TOTAL	248	186	220	-134	162

**INLET AND PIPE PROTECTION SCHEDULE**

LOCATION	INLET AND PIPE PROTECTION EACH
MARIE SCHAEFER SHOOOL	6
HINCHCLIFFE SCHOOL	1
TOTAL	7

**PROTECTIVE COAT SCHEDULE**

LOCATION	PROTECTIVE COAT AREA SQ YD
FLAG AND FACE OF CURB AND GUTTER	148

P:\2015\15-00070-00-SW\15-00070-00-SW\_SCH06.dwg 1/1/2015 1:55:31 AM

F.A.U. ROUTE	SECTION	COUNTY	TOTAL SHEETS	SHEET NUMBER
N/A	15-00070-00-SW	ST. CLAIR	20	7
FEDERAL AID PROJECT		CONTRACT 97628		

STORM SEWER & DRAINAGE STRUCTURE SCHEDULE				
PT	LOCATION STATION / OFFSET	DESCRIPTION	RIM <sup>(1)</sup>	INVERTS
MARIE SCHAEFER SHOOL				
1.	107+44.53 2.10'L	INLETS TO BE ADJUSTED (SPECIAL) - W/NEW LID	543.62	---
2.	107+44.50 7.33'R	INLETS, TYPE B, TYPE 8 GRATE *	542.55	539.80 E 539.80 W
3.	108+23.98 5.58'L	INLETS, SPECIAL NO. 1	543.31	540.59 N
4.	109+15.08 5.57'L	INLETS, SPECIAL NO. 1	543.05	540.32 S 540.32 N
5.	109+74.99 5.57'L	INLETS, SPECIAL NO. 1	543.16	540.14 S 540.14 N 540.24 E
6.	109+75.00 4.41'R	INLETS, TYPE A, TYPE 8 GRATE	542.50	540.44 W
HINCHCLIFFE SCHOOL				
7.	14+85.91 5.39'L	INLETS, TYPE A, TYPE 8 GRATE	547.41	543.25 SE

NOTE: OFFSETS TO ALL INLETS AND MANHOLES ARE TO THE CENTER OF THE DRAINAGE STRUCTURE.

PLEASE REFER TO DETAILS ON THIS SHEET FOR DIMENSIONS OF INLET SPECIAL, TYPE SPECIFIED.

(1) - AT TOP OF CURB WHERE APPLICABLE (INCLUDES LID)

(\*) - DENOTES FLAT SLAB TOP

STORM SEWER SCHEDULE									
PIPE NO.	START PIPE STRUCTURE	END PIPE STRUCTURE	PIPE DESCRIPTION	PIPE SIZE	PIPE LENGTH	UPSTREAM INVERT ELEV.	DOWNSTREAM INVERT ELEV.	PIPE SLOPE	
MARIE SCHAEFER SHOOL									
1.	OPEN DITCH	OPEN DITCH	Pipe Culverts, Class A, Type 1	12"	14'	543.97	543.45	3.60%	
2.	2.	1.	Storm Sewers, RG, Class A, Type 1	24"	6'	539.80	539.75	0.73%	
3.	3.	4.	Storm Sewers, RG, Class A, Type 1	12"	88'	540.59	540.32	0.31%	
4.	4.	5.	Storm Sewers, RG, Class A, Type 1	12"	57'	540.32	540.14	0.32%	
5.	5.	EXISTING INLET	Storm Sewers, RG, Class A, Type 1	12"	43'	540.14	540.00	0.32%	
6.	6.	5.	Storm Sewers, RG, Class A, Type 1	12"	7'	540.44	540.24	2.67%	
HINCHCLIFFE SCHOOL									
7.	7.	OPEN DITCH	Pipe Culverts, Class A, Type 1	12"	26'	543.25	542.71	2.08%	
8.	EXISTING 18" RCCP	OPEN DITCH	Pipe Culverts, Class A, Type 1	18"	8'	542.75	542.71	0.50%	
9.	EXISTING 18" RCCP	OPEN DITCH	Pipe Culverts, Class A, Type 1	18"	14'	539.20	539.13	0.50%	

NOTE: TRENCH BACKFILL SHALL BE INCLUDED IN THE COST OF STORM SEWER AND PIPE CULVERT PAY ITEMS.  
ALL REQUIRED CONNECTIONS, COLLARS, ETC. FOR PIPE CULVERTS TO BE EXTENDED SHALL BE INCLUDED IN THE COST OF THAT ITEM.

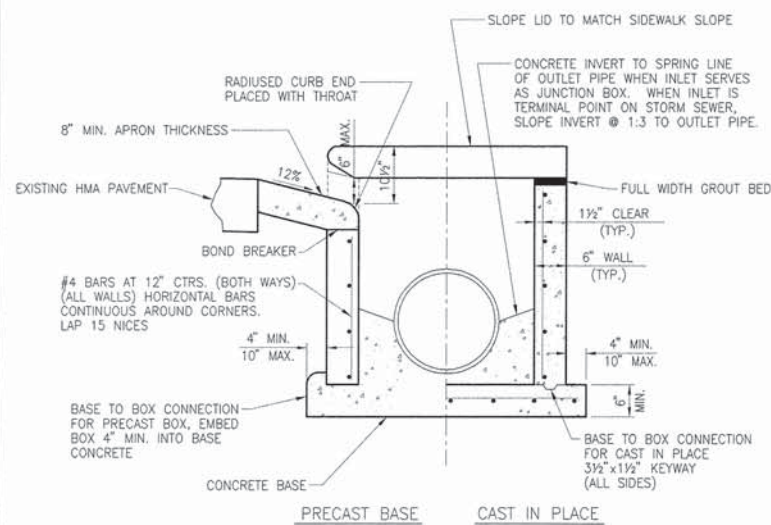

END VIEW

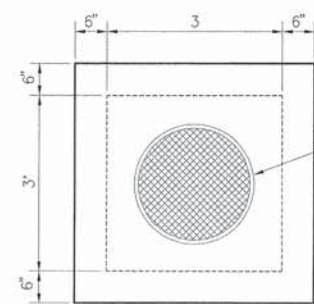

PRECAST LID DETAIL

INLETS, SPECIAL, NO. 1

N.T.S.

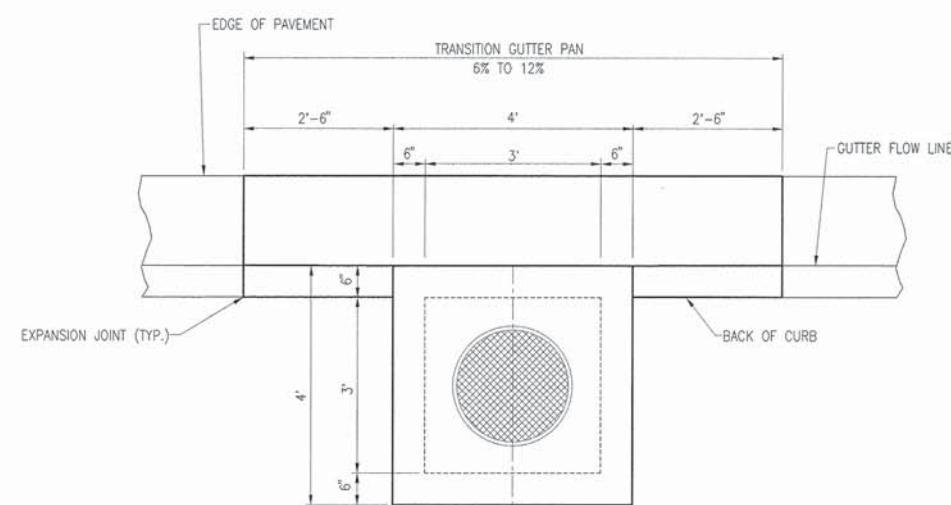

PLAN

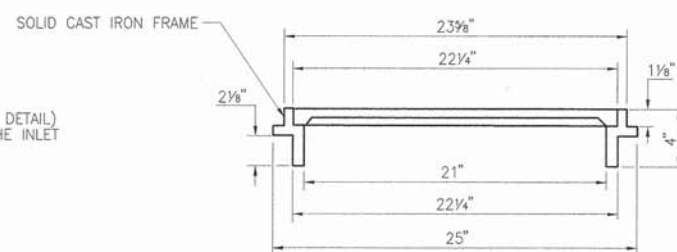

FRAME AND CLOSED LID

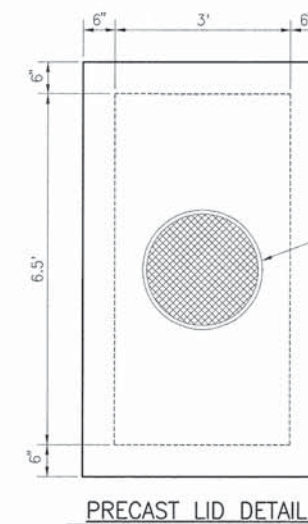

PRECAST LID DETAIL

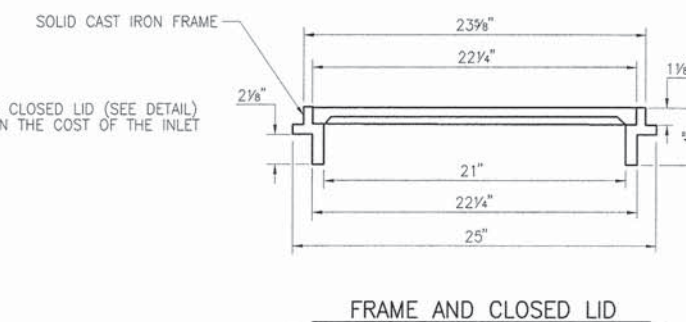

FRAME AND CLOSED LID

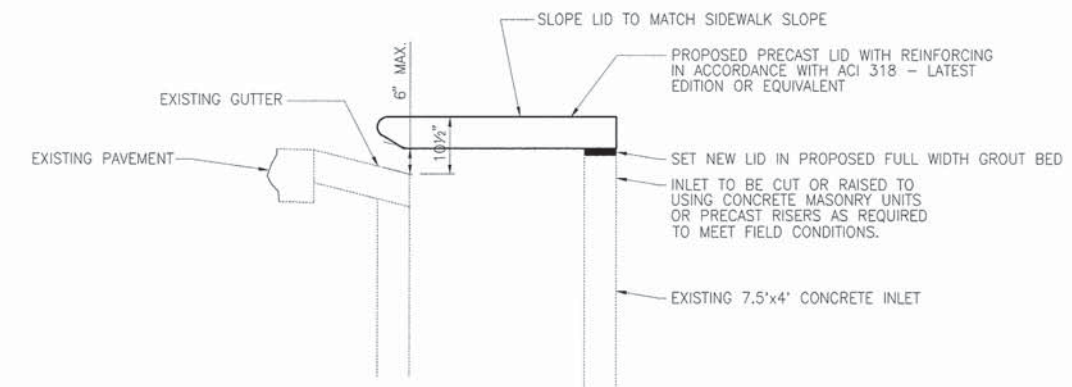

INLETS TO BE ADJUSTED (SPECIAL)

N.T.S.

F.A.U. ROUTE	SECTION	COUNTY	TOTAL SHEETS	SHEET NUMBER
N/A	15-00070-00-SW	ST. CLAIR	20	8
FEDERAL AID PROJECT		CONTRACT 97628		

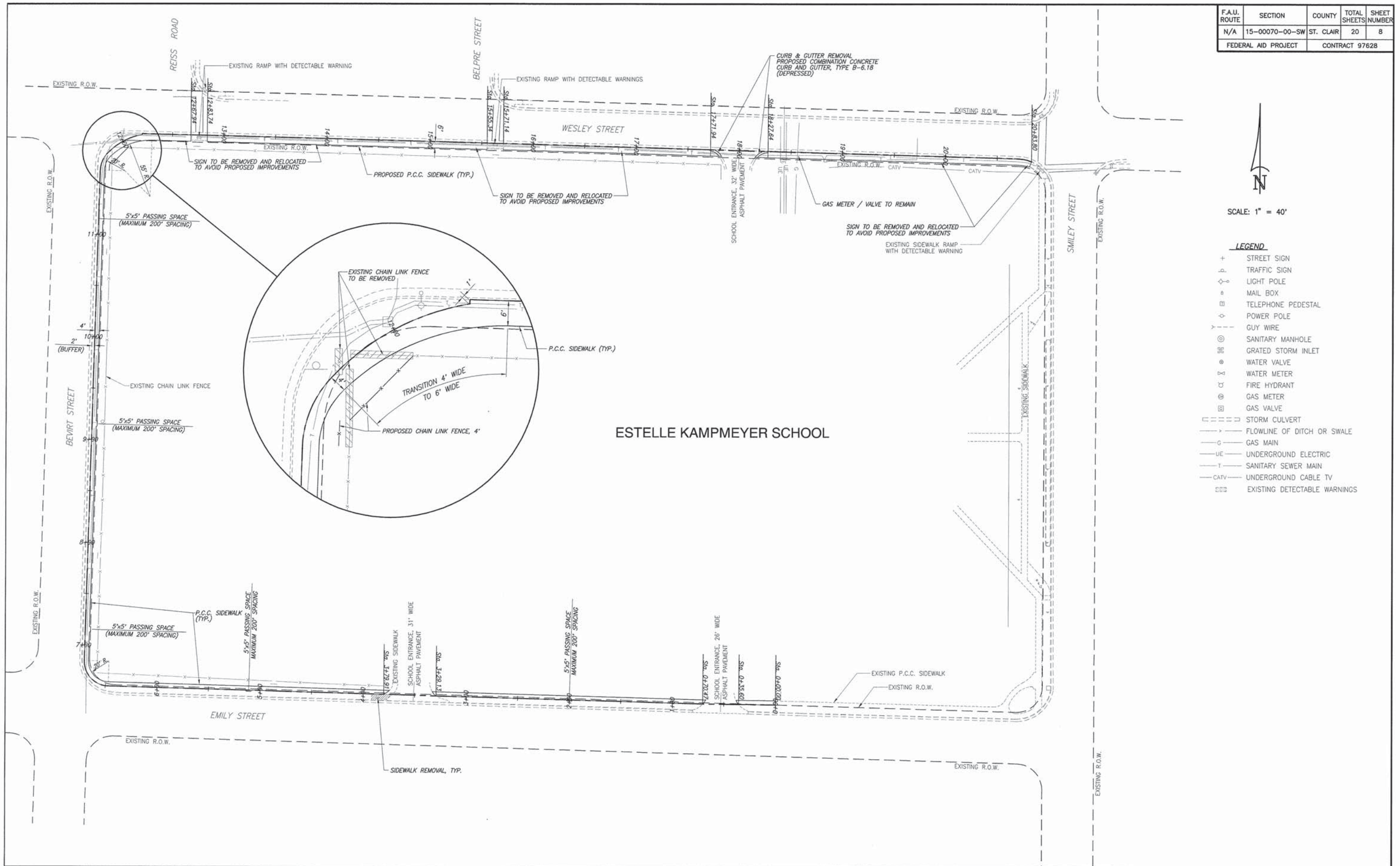

N  
SCALE: 1" = 40'

- LEGEND**
- + STREET SIGN
  - ⊕ TRAFFIC SIGN
  - ⊙ LIGHT POLE
  - ⊕ MAIL BOX
  - ⊕ TELEPHONE PEDESTAL
  - ⊕ POWER POLE
  - ⊕ GUY WIRE
  - ⊕ SANITARY MANHOLE
  - ⊕ GRATED STORM INLET
  - ⊕ WATER VALVE
  - ⊕ WATER METER
  - ⊕ FIRE HYDRANT
  - ⊕ GAS METER
  - ⊕ GAS VALVE
  - ⊕ STORM CULVERT
  - ⊕ FLOWLINE OF DITCH OR SWALE
  - ⊕ GAS MAIN
  - ⊕ UNDERGROUND ELECTRIC
  - ⊕ SANITARY SEWER MAIN
  - ⊕ UNDERGROUND CABLE TV
  - ⊕ EXISTING DETECTABLE WARNINGS



F.A.U. ROUTE	SECTION	COUNTY	TOTAL SHEETS	SHEET NUMBER
N/A	15-00070-00-SW	ST. CLAIR	20	9
FEDERAL AID PROJECT		CONTRACT 97628		

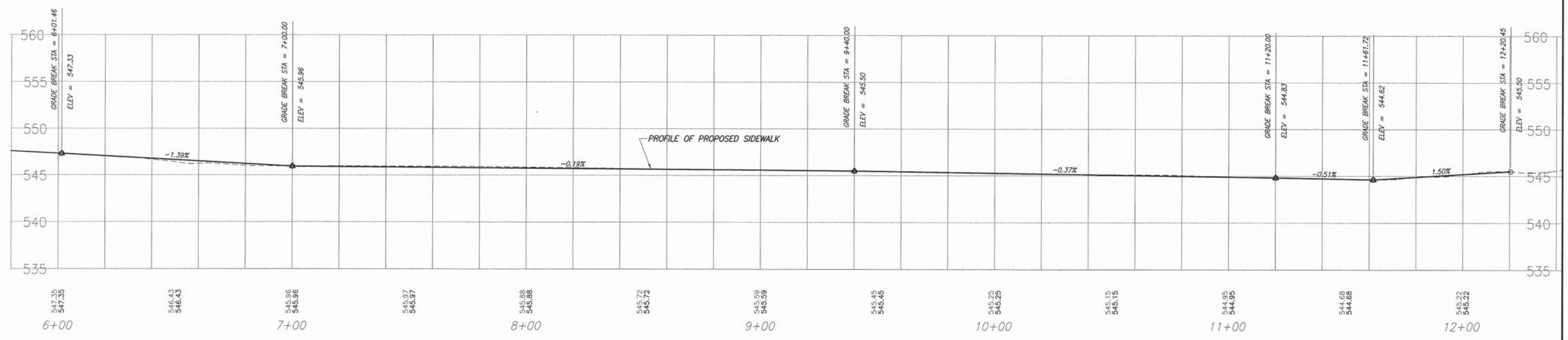
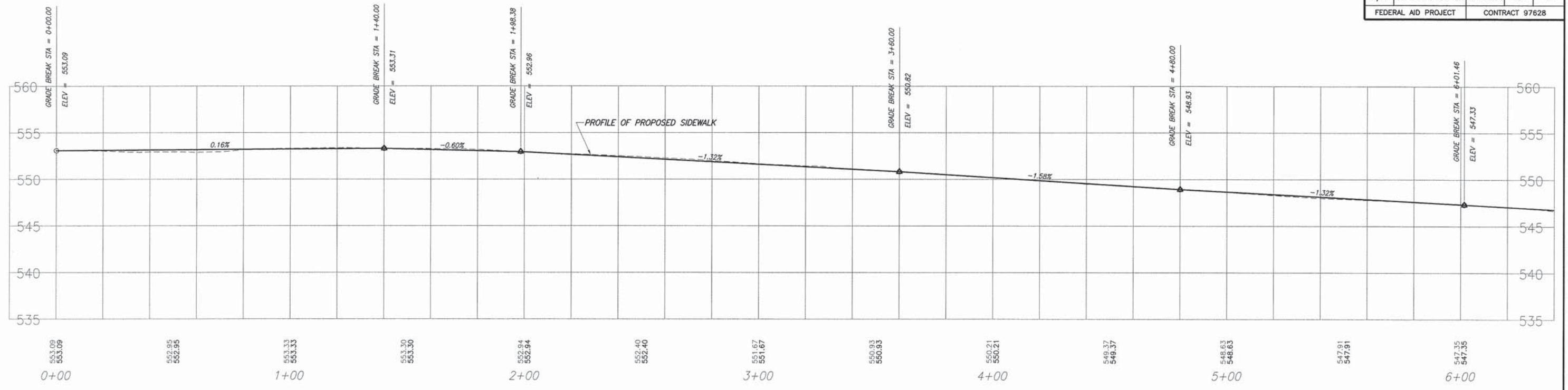

SIDEWALK PROFILE - ESTELLE KAMPMEYER SCHOOL O'FALLON - SAFE ROUTES TO SCHOOL  
SECTION 15-00070-00-SW ST. CLAIR COUNTY, ILLINOIS

P:\04045\_CadFiles\2305\_0873\1500070-00-SW\ESTELLE\_SCHOOL\_SAFEROUTES\_TO\_SCHOOL\_SIDWALK\_PROFILE.dwg, 07/20/16 11:33:40, Plot 16, 1/4"

F.A.U. ROUTE	SECTION	COUNTY	TOTAL SHEETS	SHEET NUMBER
N/A	15-00070-00-SW	ST. CLAIR	20	10
FEDERAL AID PROJECT		CONTRACT 97628		

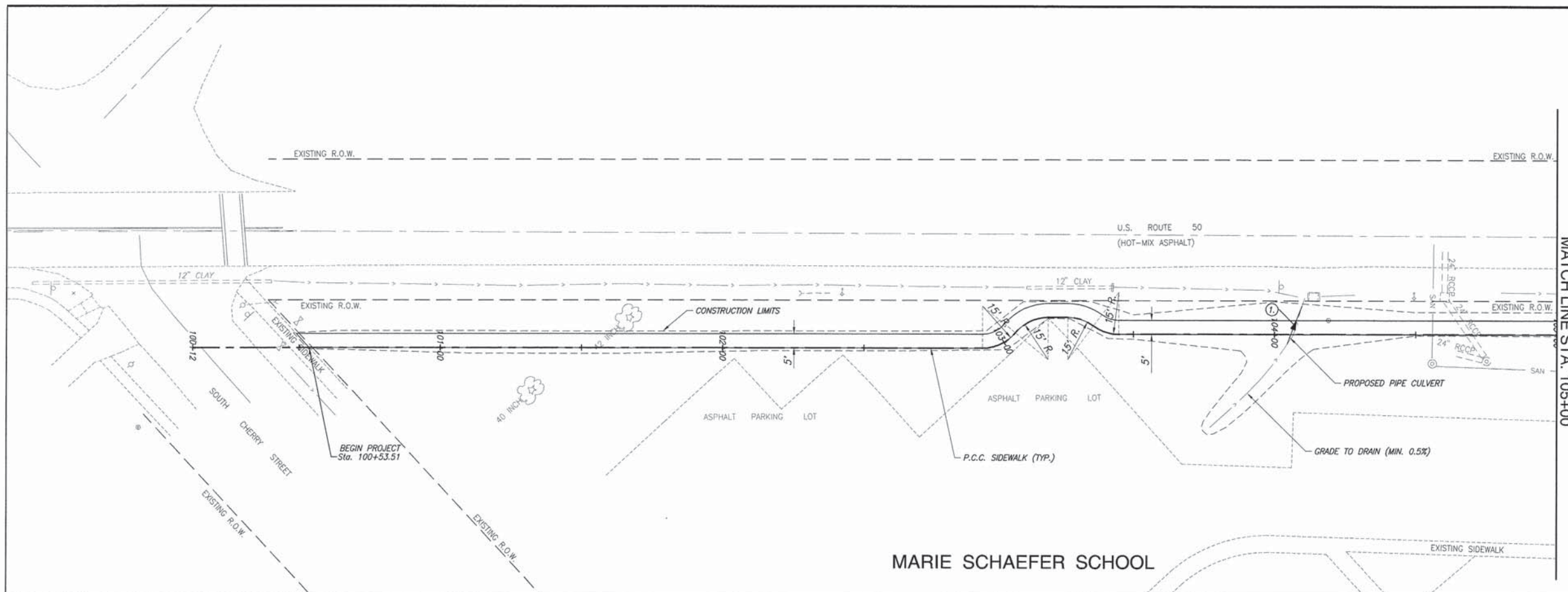

**LEGEND**

- + STREET SIGN
- ⊙ TRAFFIC SIGN
- ⊙ LIGHT POLE
- ⊙ MAIL BOX
- ⊙ ELECTRIC PEDESTAL
- ⊙ POWER POLE
- ⊙ GUY WIRE
- ⊙ SANITARY MANHOLE
- ⊙ GRATED STORM INLET
- ⊙ WATER VALVE
- ⊙ WATER METER
- ⊙ FIRE HYDRANT
- ⊙ STORM CULVERT
- FLOWLINE OF DITCH OR SWALE
- GAS MAIN
- UE UNDERGROUND ELECTRIC
- SAN SANITARY SEWER MAIN
- ⊙ EXISTING DETECTABLE WARNINGS
- ▬ PROPOSED DETECTABLE WARNINGS

**SCALE:**  
 PLAN: 1"=20'  
 PROFILE: 1"=20' HORIZ.  
 1"=5' VERT.

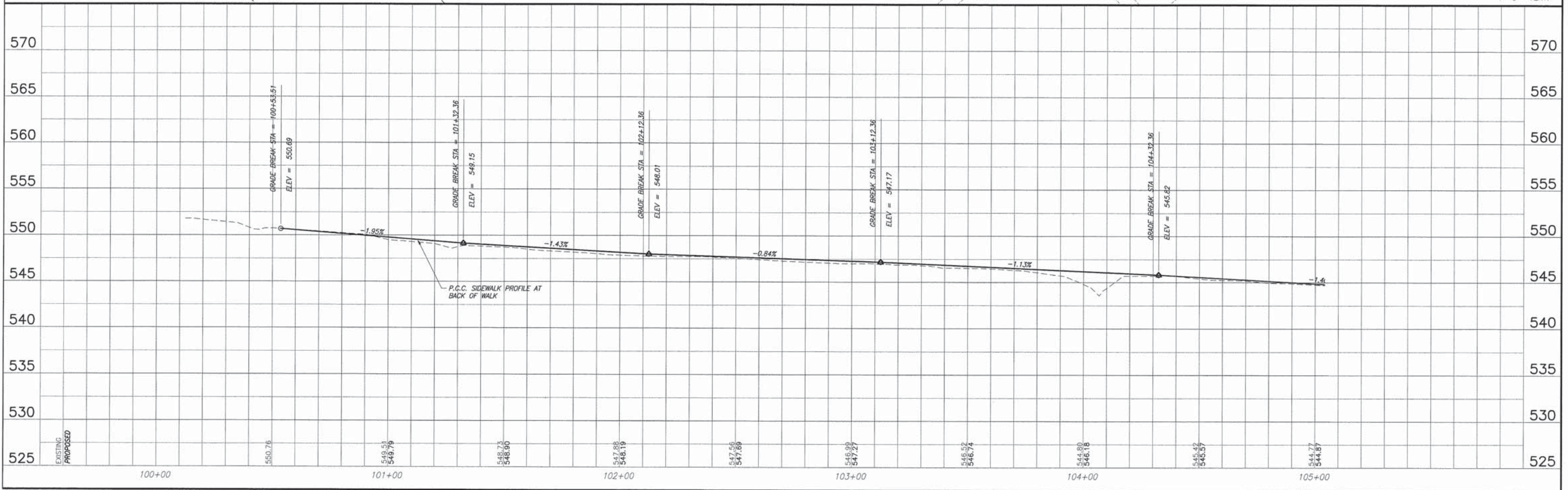

PLAN & PROFILE - MARIE SCHAEFER SCHOOL O'FALLON - SAFE ROUTES TO SCHOOL  
 SECTION 15-00070-00-SW ST. CLAIR COUNTY, ILLINOIS

P:\Users\jchick\2015\2015 - ST. CLAIR COUNTY\15-00070-00-SW\15-00070-00-SW - ST. CLAIR COUNTY, ILLINOIS - SAFE ROUTES TO SCHOOL.dwg, 4/17/2016 9:28:17 AM, Plot Date: 4/17/2016



F.A.U. ROUTE	SECTION	COUNTY	TOTAL SHEETS	SHEET NUMBER
N/A	15-00070-00-SW	ST. CLAIR	20	12
FEDERAL AID PROJECT		CONTRACT 97628		

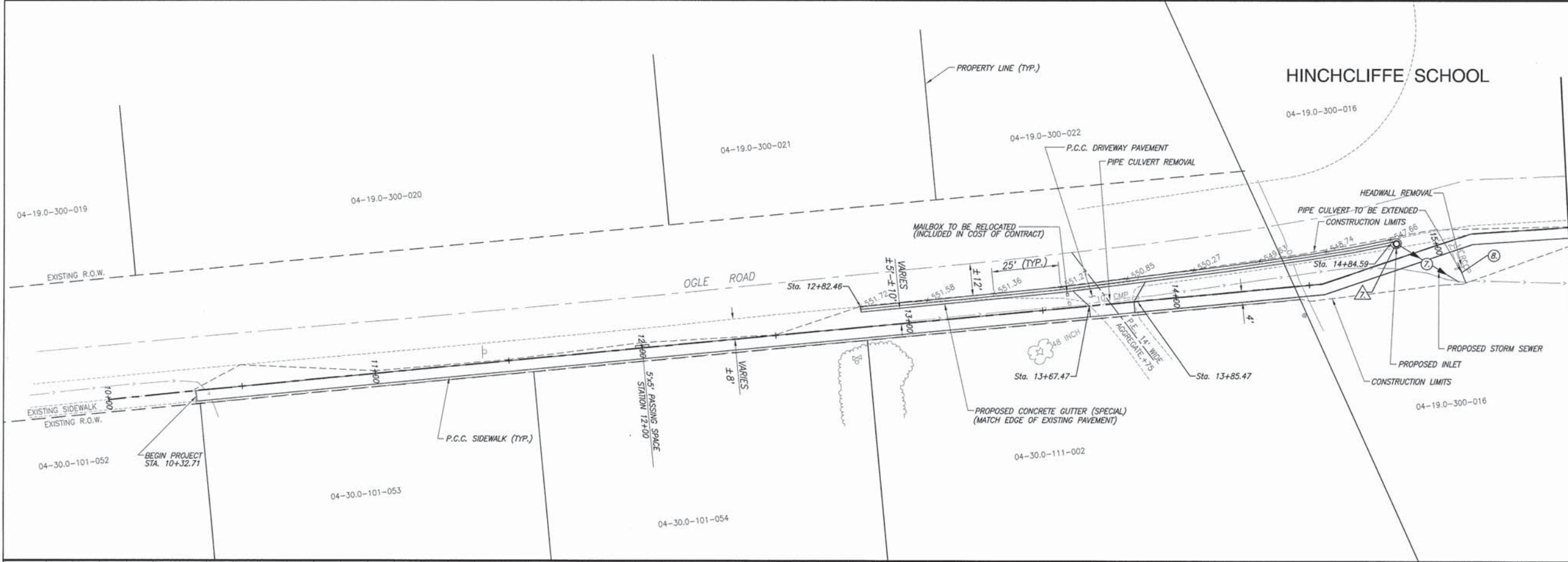

- LEGEND**
- + STREET SIGN
  - ⊕ TRAFFIC SIGN
  - ⊙ LIGHT POLE
  - ⊕ MAIL BOX
  - ⊕ ELECTRIC PEDESTAL
  - ⊕ POWER POLE
  - ⊕ GUY WIRE
  - ⊕ SANITARY MANHOLE
  - ⊕ GRATED STORM INLET
  - ⊕ STORM CULVERT
  - ⊕ FLOWLINE OF DITCH OR SWALE
  - ⊕ GAS MAIN
  - ⊕ UNDERGROUND ELECTRIC
  - ⊕ SANITARY SEWER MAIN
  - PROPOSED DETECTABLE WARNINGS

**SCALE:**  
 PLAN: 1" = 20'  
 PROFILE: 1" = 20' HORIZ.  
 1" = 5' VERT.

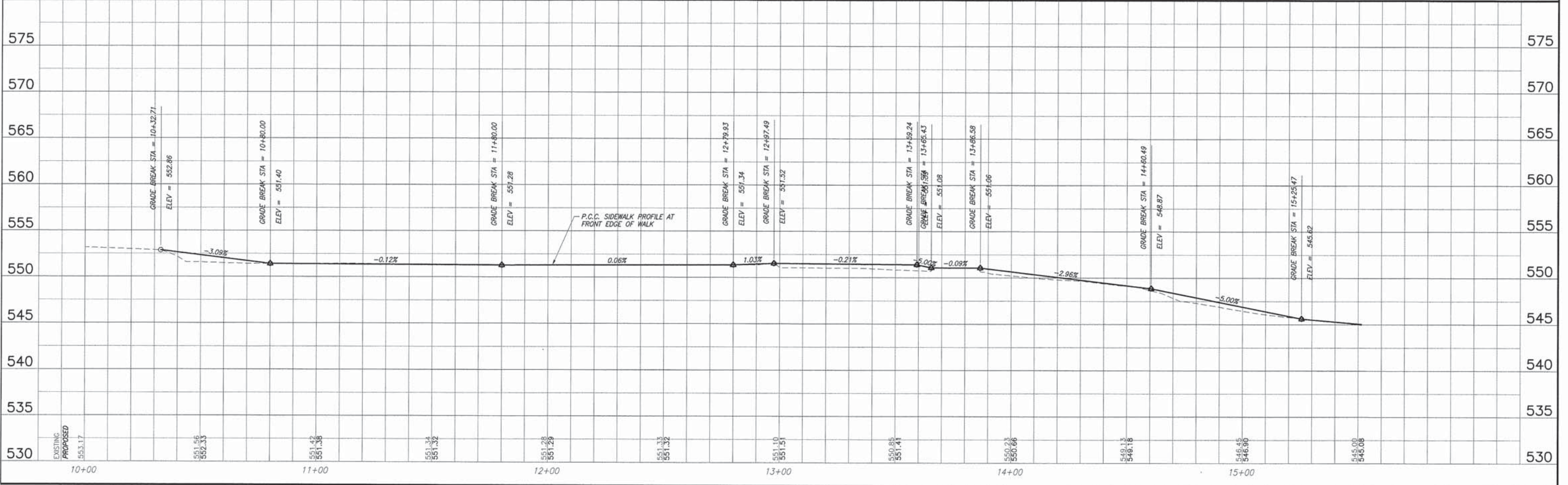

PLAN & PROFILE - HINCHCLIFFE SCHOOL O'FALLON - SAFE ROUTES TO SCHOOL  
 SECTION 15-00070-00-SW ST. CLAIR COUNTY, ILLINOIS

K:\Projects\15-00070-00-SW\15-00070-00-SW.dwg 4/17/2018 9:16:29 AM, P:\Users\K...

F.A.U. ROUTE	SECTION	COUNTY	TOTAL SHEETS	SHEET NUMBER
N/A	15-00070-00-SW	ST. CLAIR	20	13
FEDERAL AID PROJECT			CONTRACT 97628	

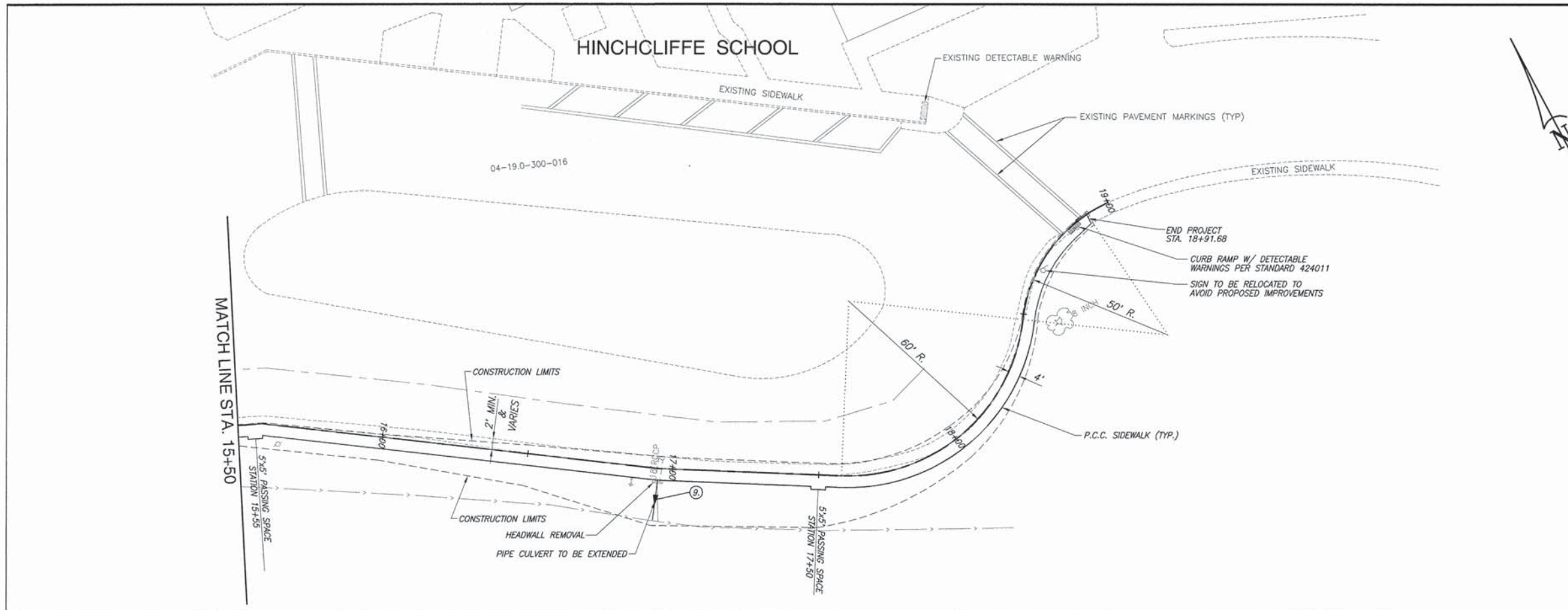

**LEGEND**

- + STREET SIGN
- △ TRAFFIC SIGN
- ⊕ LIGHT POLE
- Ⓜ MAIL BOX
- Ⓜ ELECTRIC PEDESTAL
- ⊙ POWER POLE
- ⋈ GUY WIRE
- ⊙ SANITARY MANHOLE
- Ⓜ GRATED STORM INLET
- Ⓜ STORM CULVERT
- FLOWLINE OF DITCH OR SWALE
- GAS MAIN
- UE UNDERGROUND ELECTRIC
- SAN SANITARY SEWER MAIN
- Ⓜ EXISTING DETECTABLE WARNINGS
- Ⓜ PROPOSED DETECTABLE WARNINGS

**SCALE:**  
 PLAN: 1" = 20'  
 PROFILE: 1" = 20' HORIZ.  
 1" = 5' VERT.

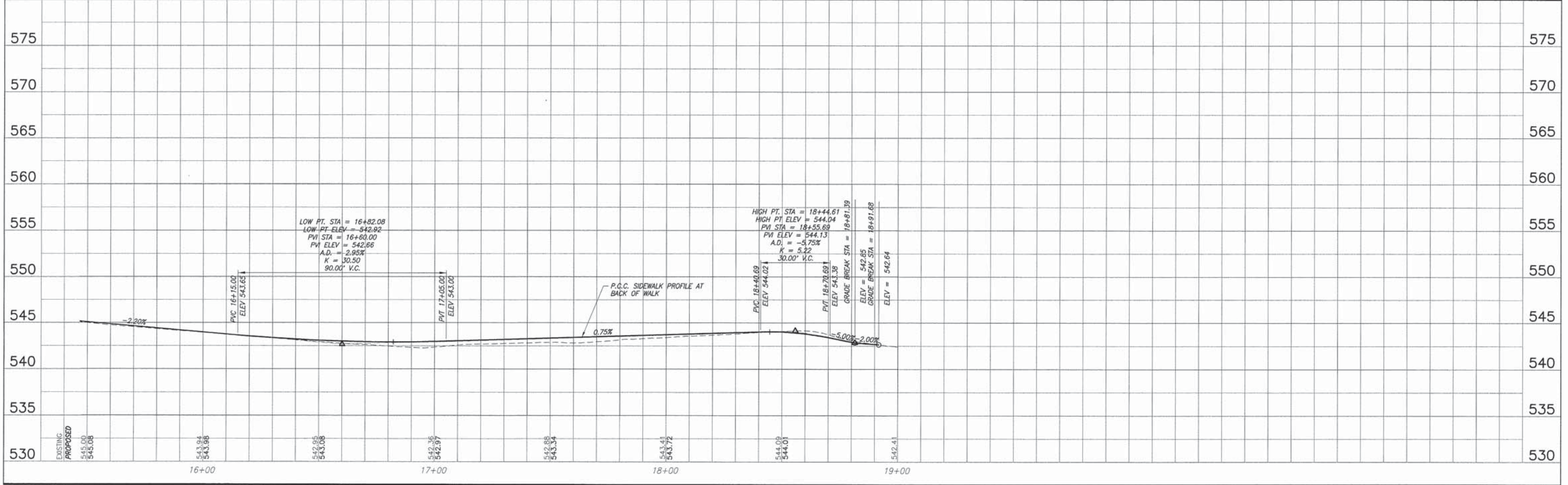

PLAN & PROFILE - HINCHCLIFFE SCHOOL O'FALLON - SAFE ROUTES TO SCHOOL  
 SECTION 15-00070-00-SW ST. CLAIR COUNTY, ILLINOIS

K:\Projects\2015\15075\15075.dwg (15075.dwg) - 4/1/2016 9:10:56 AM - 15075.dwg

F.A.U. ROUTE	SECTION	COUNTY	TOTAL SHEETS	SHEET NUMBER
N/A	15-00070-00-SW	ST. CLAIR	20	14
FEDERAL AID PROJECT		CONTRACT 97628		

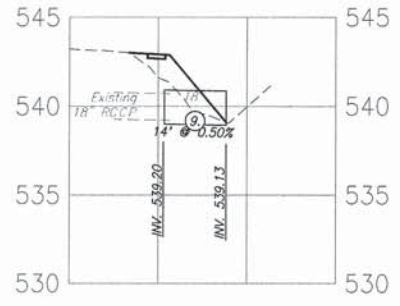
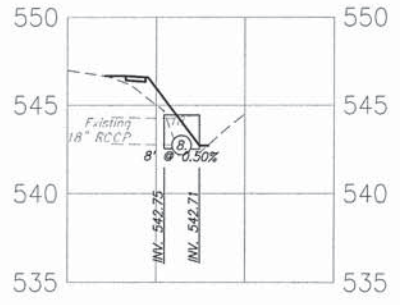
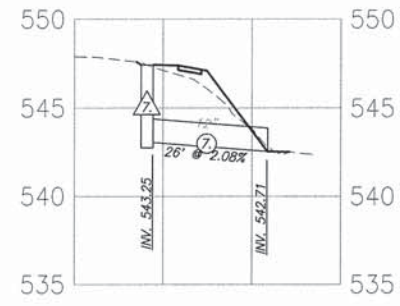

HINCHCLIFFE SCHOOL  
DRAINAGE PROFILES

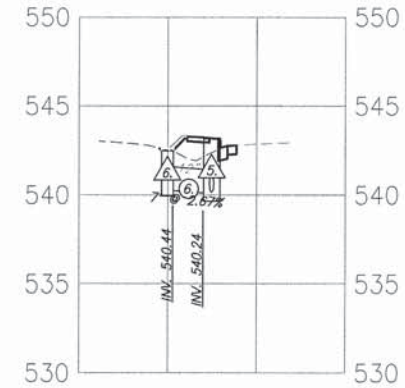
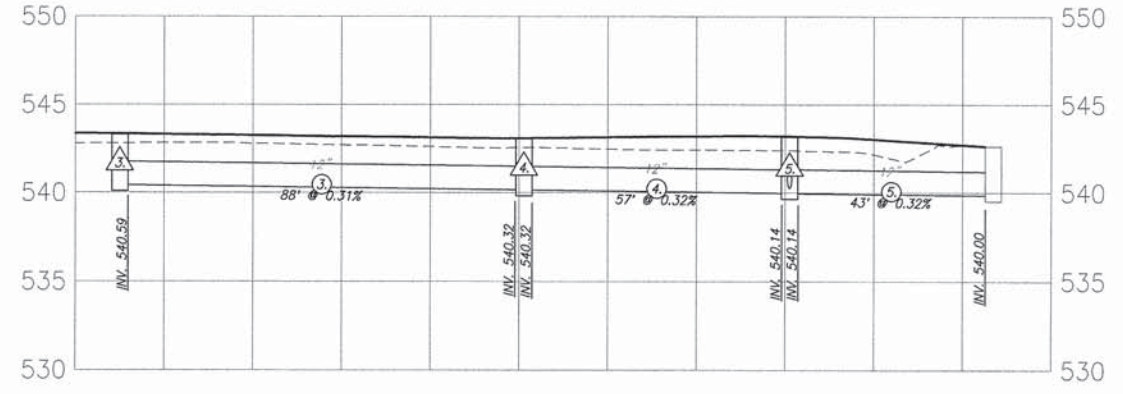
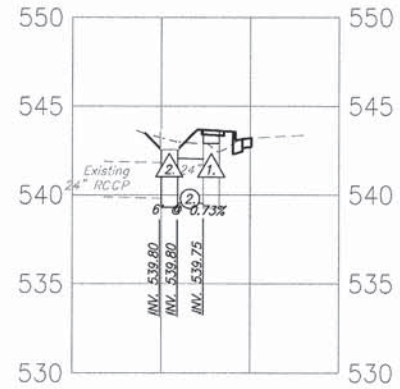
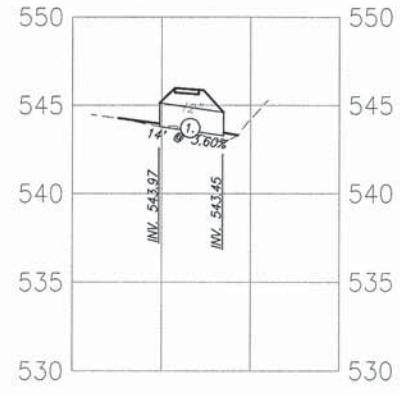

MARIE SCHAEFER SCHOOL  
DRAINAGE PROFILES

P:\0015\0015.dwg 2/15/07 10:53 AM

F.A.U. ROUTE	SECTION	COUNTY	TOTAL SHEETS	SHEET NUMBER
N/A	15-00070-00-SW	ST. CLAIR	20	15
FEDERAL AID PROJECT		CONTRACT 97628		

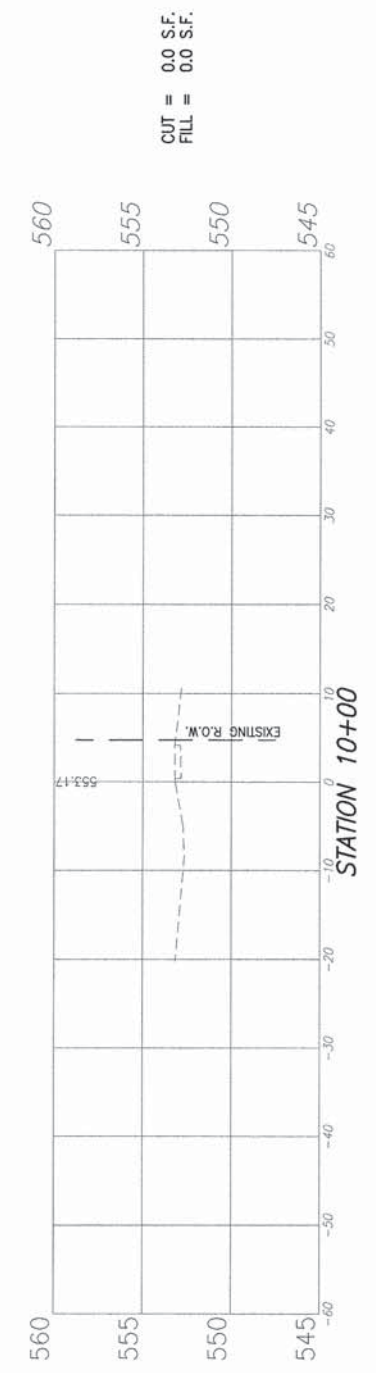
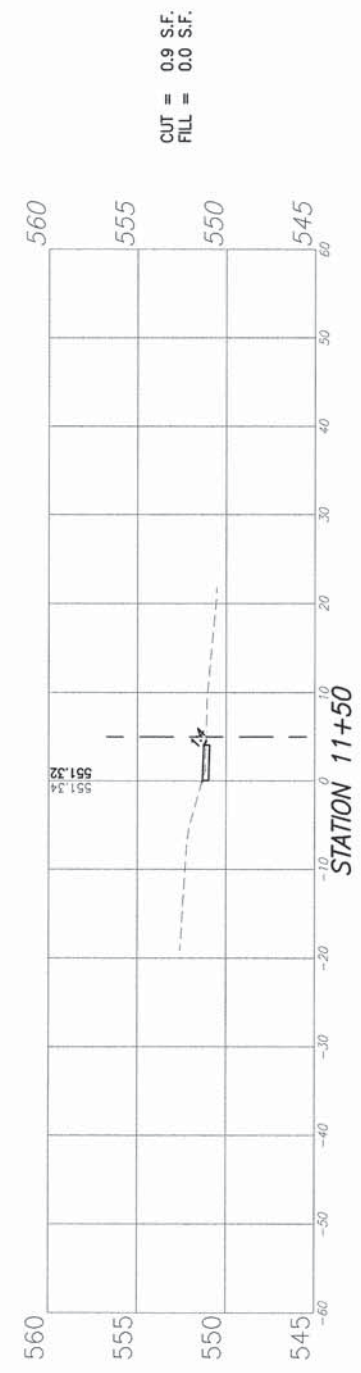
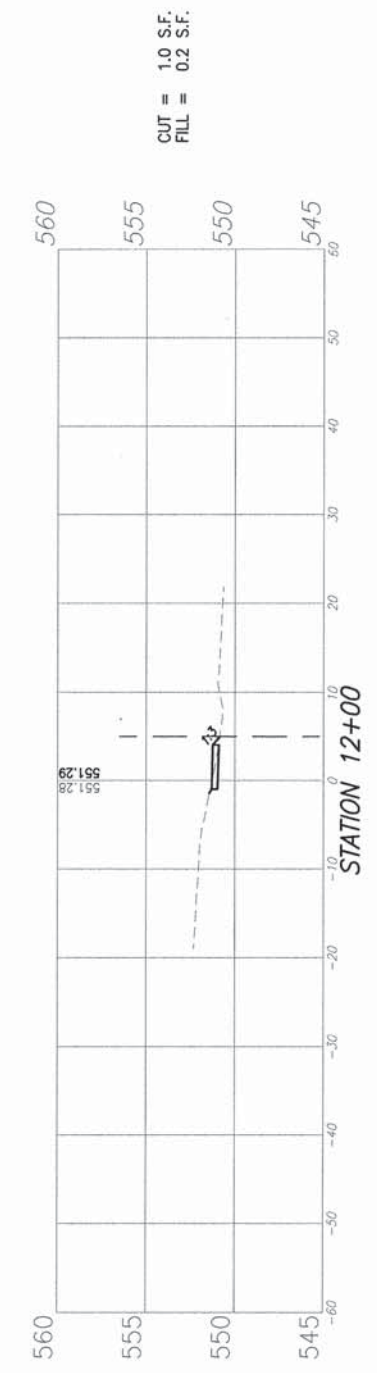
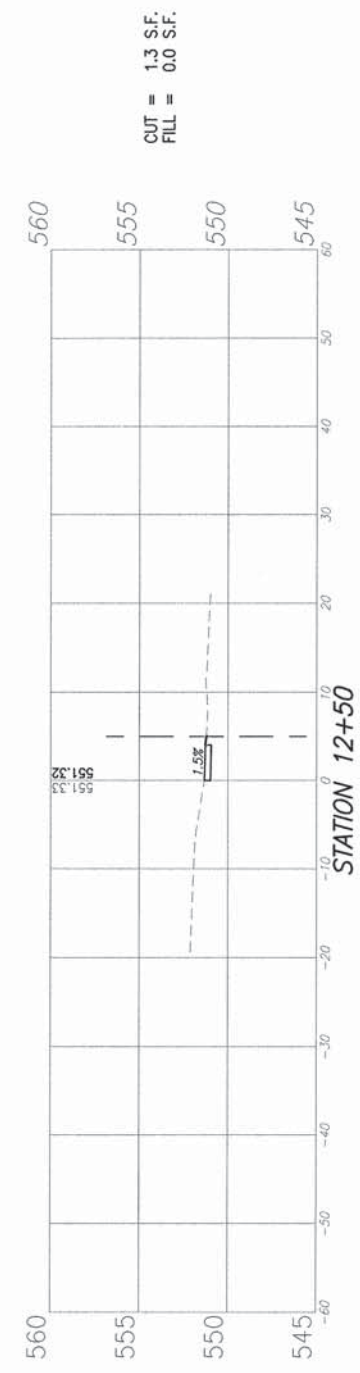

F.A.U. ROUTE	SECTION	COUNTY	TOTAL SHEETS	SHEET NUMBER
N/A	15-00070-00-SW	ST. CLAIR	20	16
FEDERAL AID PROJECT		CONTRACT 97628		

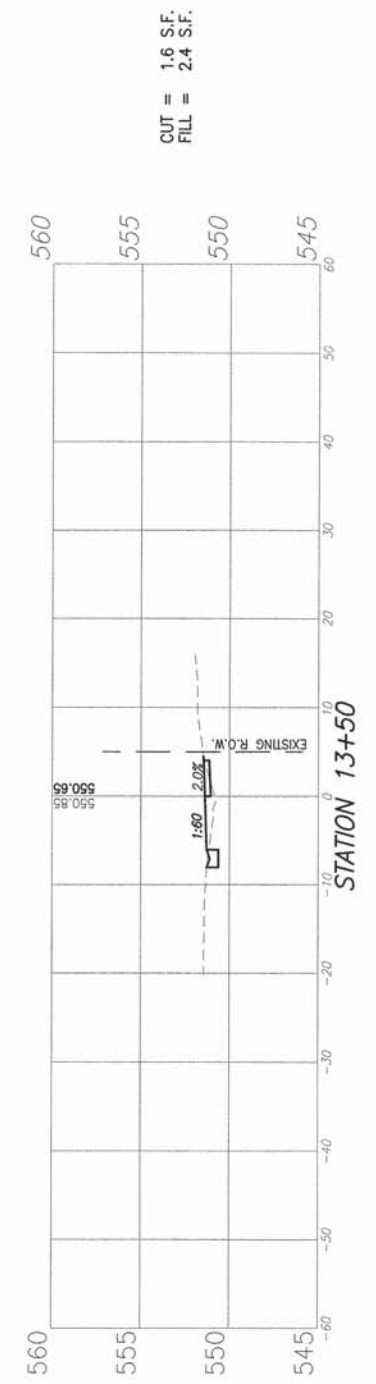
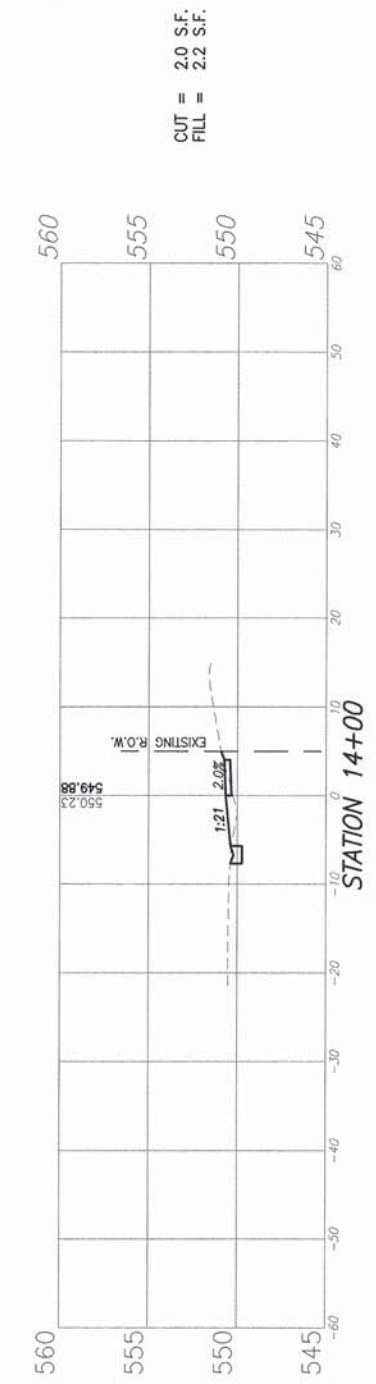
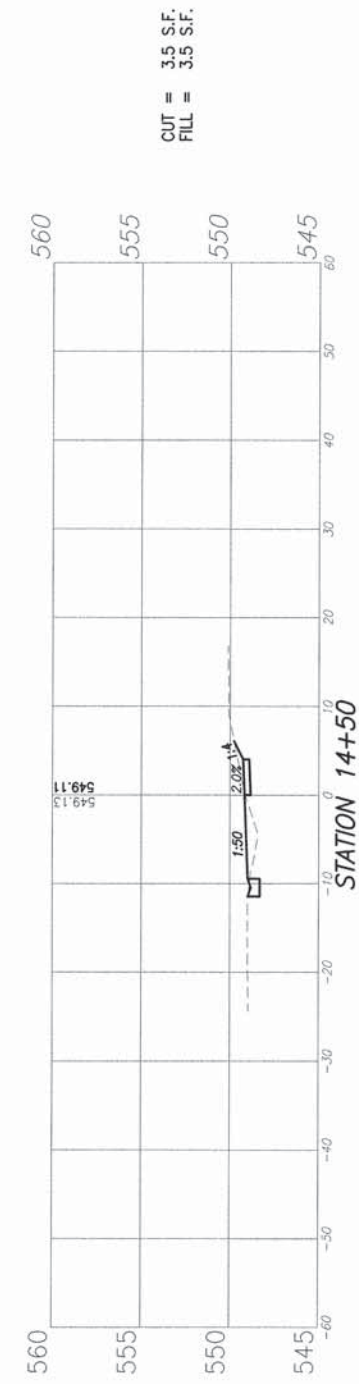
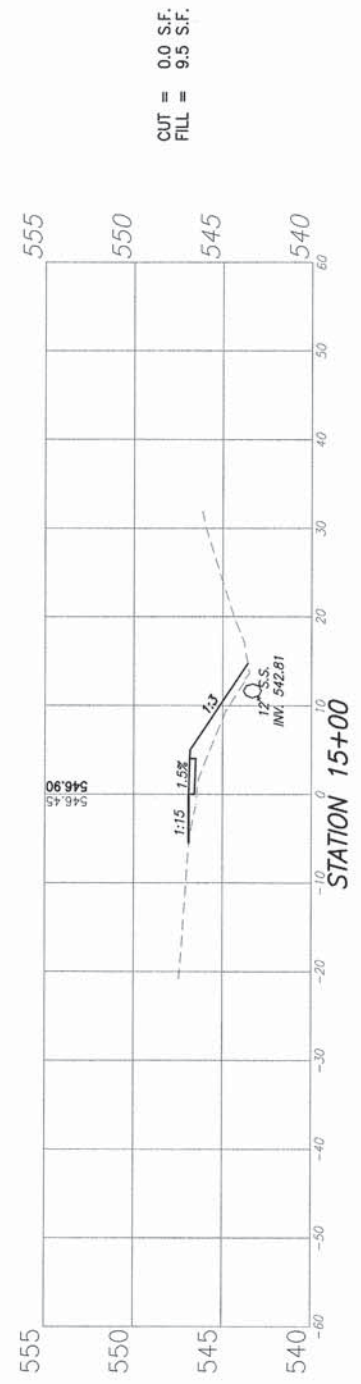
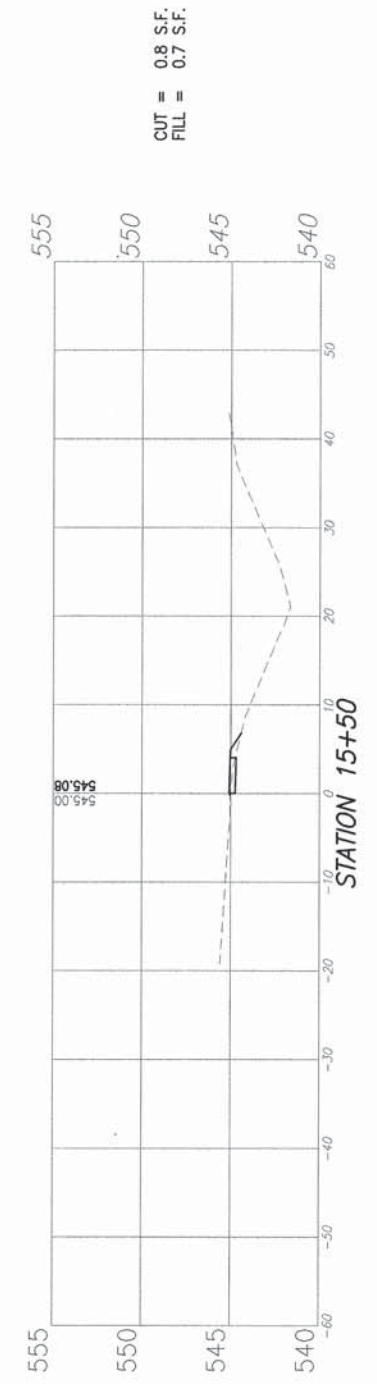
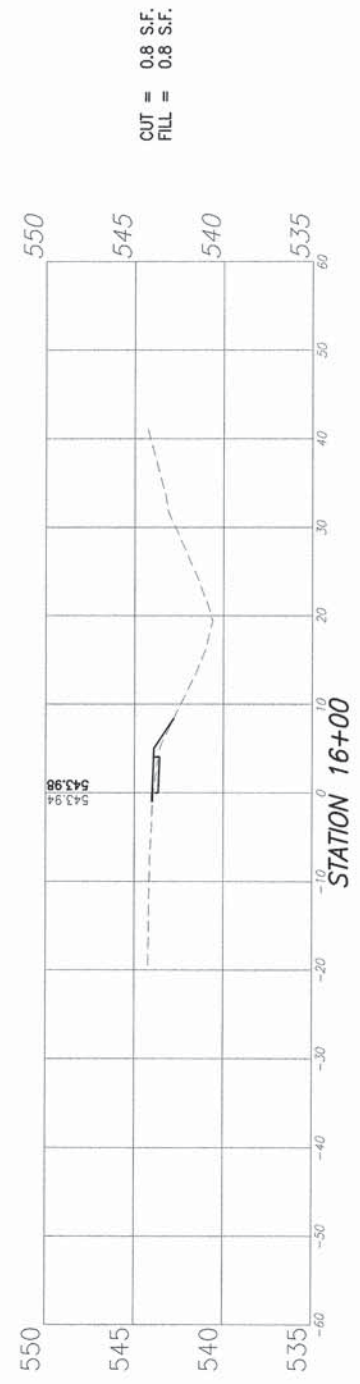



F.A.U. ROUTE	SECTION	COUNTY	TOTAL SHEETS	SHEET NUMBER
N/A	15-00070-00-SW	ST. CLAIR	20	17
FEDERAL AID PROJECT		CONTRACT 97628		

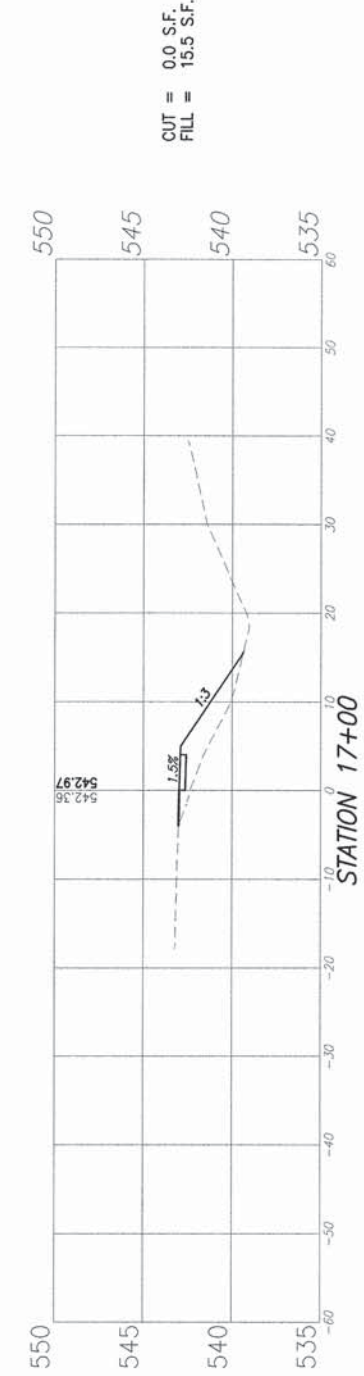
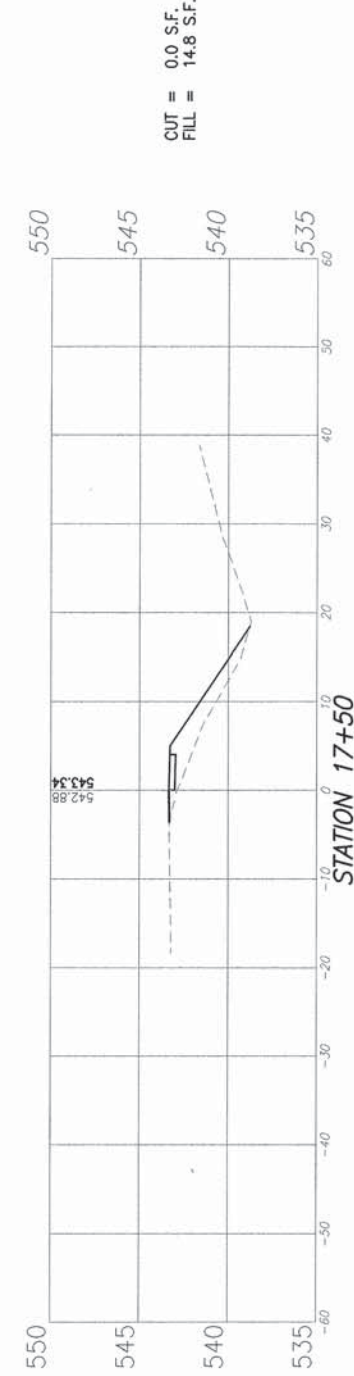
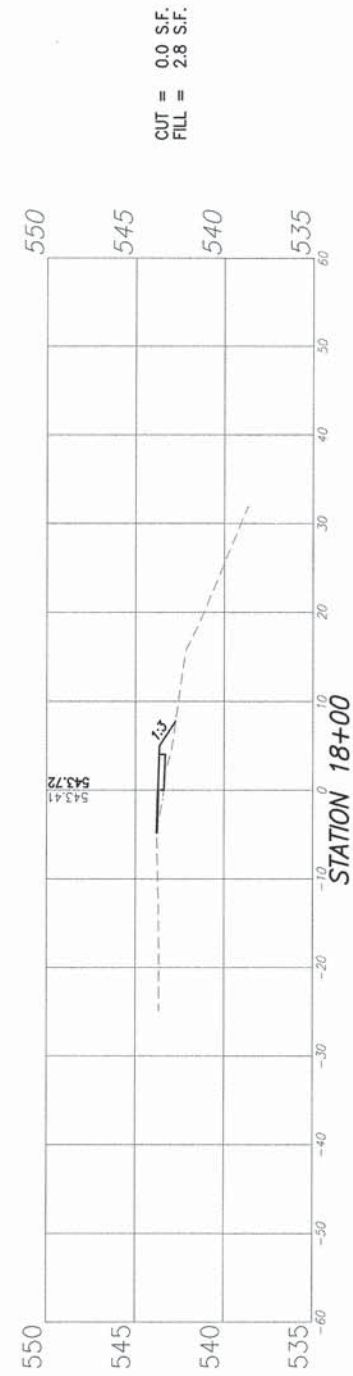
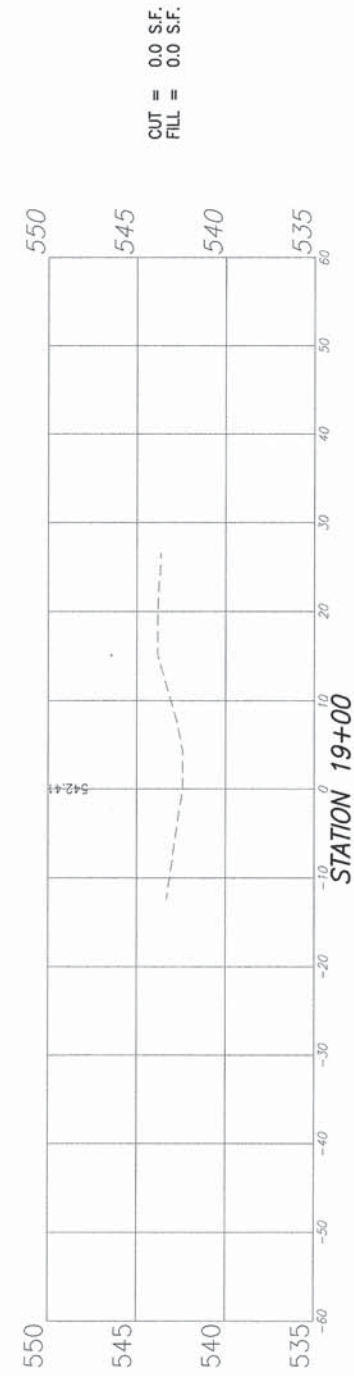

F.A.U. ROUTE	SECTION	COUNTY	TOTAL SHEETS	SHEET NUMBER
N/A	15-00070-00-SW	ST. CLAIR	20	18
FEDERAL AID PROJECT		CONTRACT 97628		

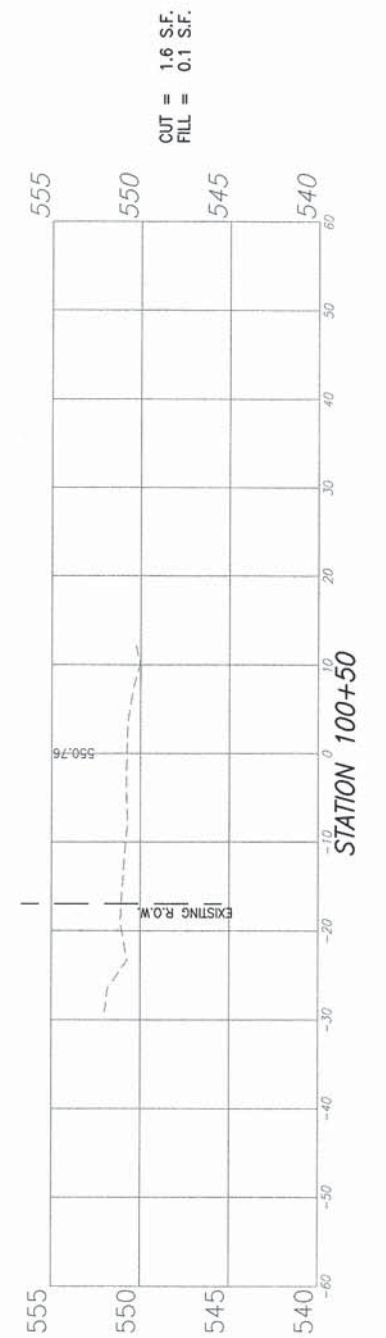
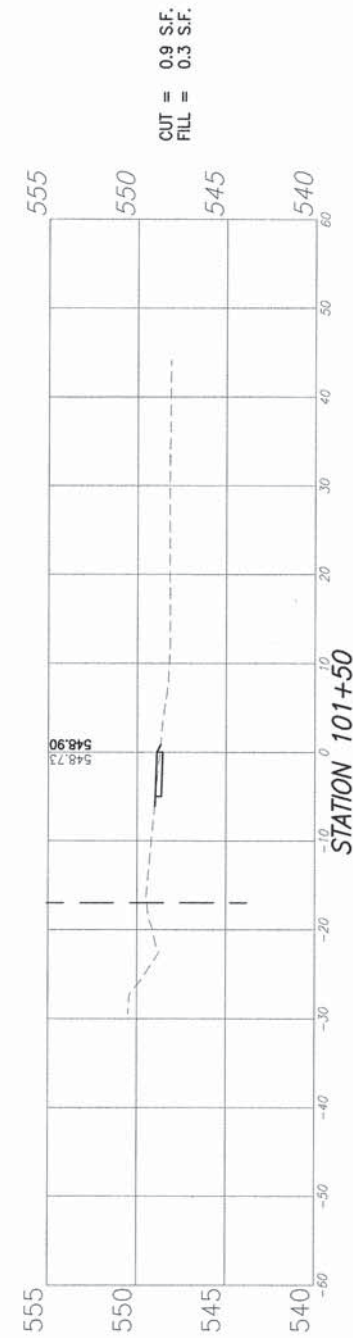
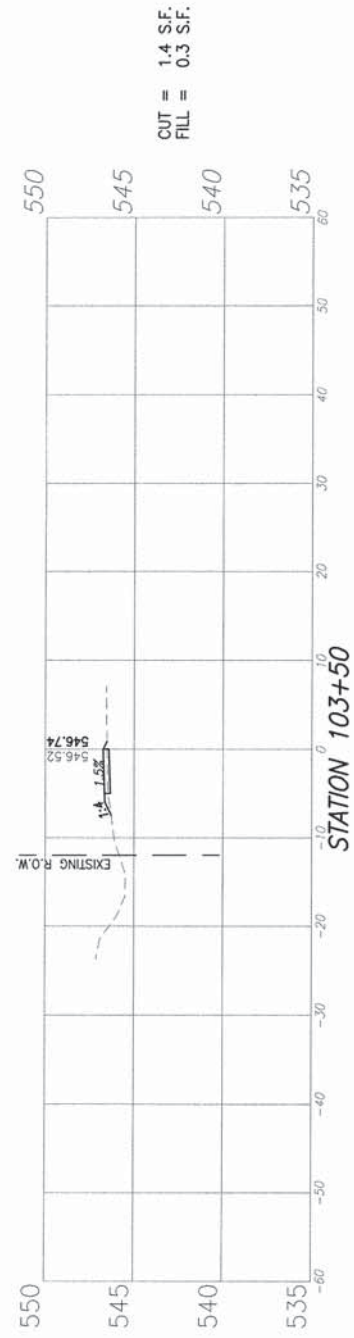

F.A.U. ROUTE	SECTION	COUNTY	TOTAL SHEETS	SHEET NUMBER
N/A	15-00070-00-SW	ST. CLAIR	20	19
FEDERAL AID PROJECT		CONTRACT 97628		

CUT = 1.8 S.F.  
FILL = 0.0 S.F.



STATION 107+00  
SCHOOL ENTRANCE

CUT = 1.8 S.F.  
FILL = 5.0 S.F.



STATION 106+50

CUT = 0.9 S.F.  
FILL = 0.3 S.F.



STATION 106+00

CUT = 0.2 S.F.  
FILL = 2.2 S.F.



STATION 105+50

CUT = 1.4 S.F.  
FILL = 0.6 S.F.



STATION 105+00

CUT = 1.0 S.F.  
FILL = 0.8 S.F.



STATION 104+50

CUT = 0.0 S.F.  
FILL = 12.5 S.F.



STATION 104+00

F.A.U. ROUTE	SECTION	COUNTY	TOTAL SHEETS	SHEET NUMBER
N/A	15-00070-00-SW	ST. CLAIR	20	20
FEDERAL AID PROJECT			CONTRACT 97628	

