

STATE OF ILLINOIS  
DEPARTMENT OF TRANSPORTATION

F.A.P. RTE.	SECTION	COUNTY	TOTAL SHEETS	SHEET NO.
777	D7 BRIDGE REPAIRS 2021-2	FAYETTE	15	1
		ILLINOIS	CONTRACT NO. 74989	

FOR INDEX OF SHEETS, SEE SHEET NO. 2

AADT (2021) = 2300

# PROPOSED HIGHWAY PLANS

FAP ROUTE 777 (IL 185)  
D7 BRIDGE REPAIRS 2021-2  
PROJECT NHPP-59IU(648)  
BRIDGE DECK REPAIRS  
FAYETTE COUNTY

C-97-074-20

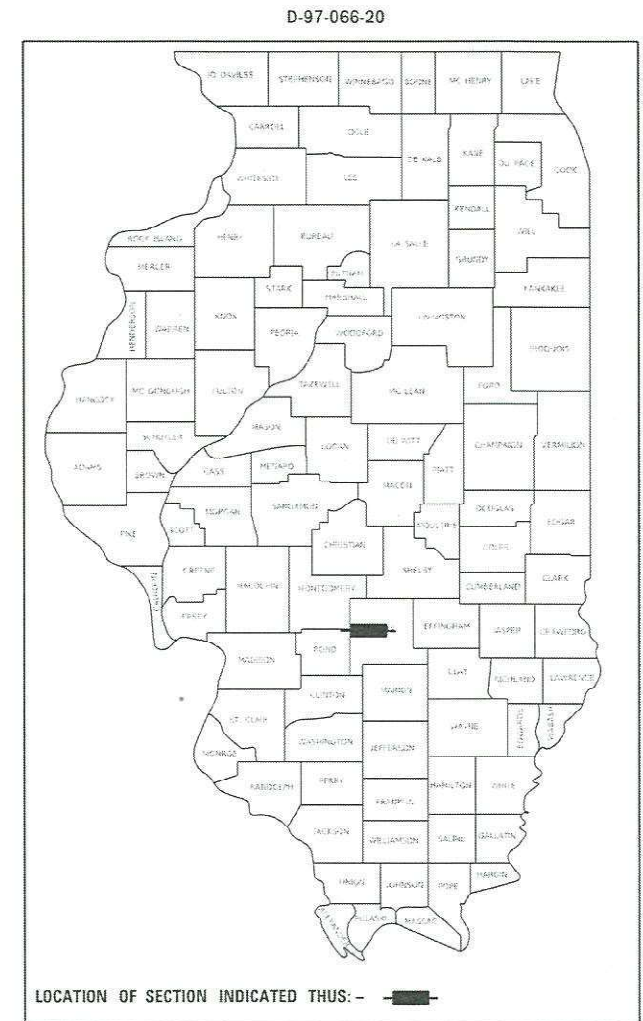

PROJECT LOCATION  
STATION 911+60  
SN 026-0051

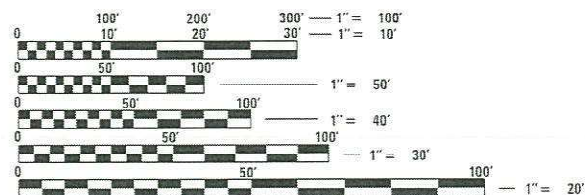
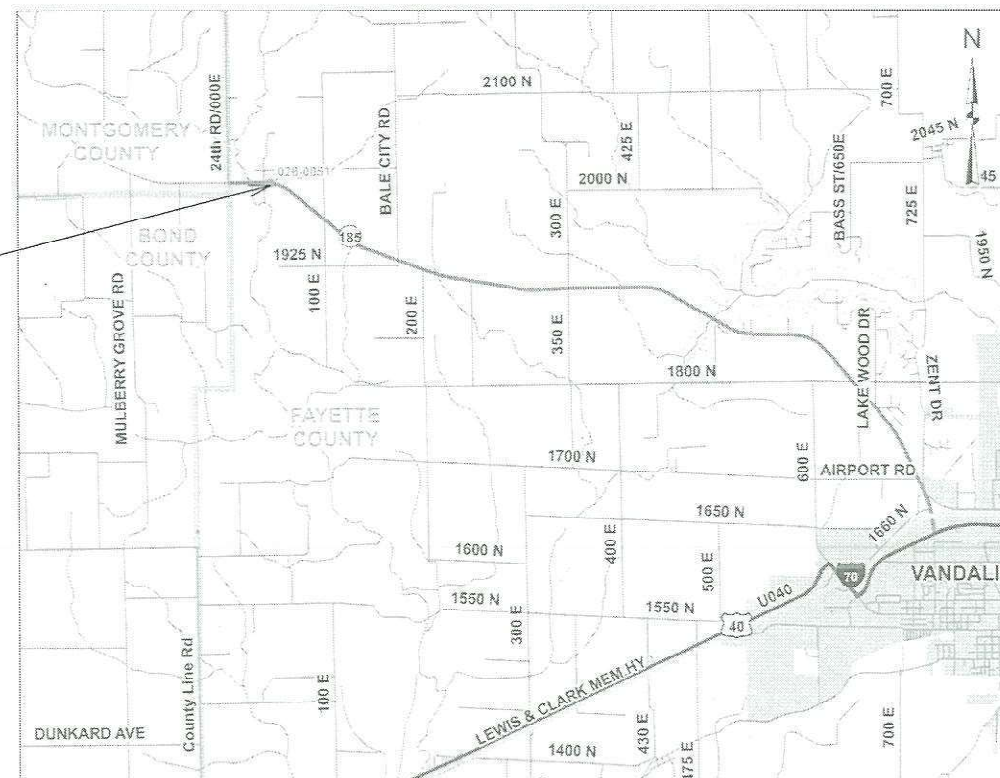

FULL SIZE PLANS HAVE BEEN PREPARED USING STANDARD ENGINEERING SCALES. REDUCED SIZED PLANS WILL NOT CONFORM TO STANDARD SCALES. IN MAKING MEASUREMENTS ON REDUCED PLANS, THE ABOVE SCALES MAY BE USED.

J.U.L.I.E.  
JOINT UTILITY LOCATION INFORMATION FOR EXCAVATORS  
1-800-892-0123  
OR 811

PROJECT ENGINEER: DEBRA G. BARRETT  
PROJECT MANAGER: DEBRA G. BARRETT  
PHONE NUMBER: (217) 342-8243  
CONTRACT NO. 74989

GROSS LENGTH = 34.24 FT. = 0.006 MILE  
NET LENGTH = 34.24 FT. = 0.006 MILE

STATE OF ILLINOIS  
DEPARTMENT OF TRANSPORTATION

SUBMITTED MARCH 23 20 21  
Jeffrey P. Myer  
REGIONAL ENGINEER

May 7, 2021 Joe A. Elk  
ENGINEER OF DESIGN AND ENVIRONMENT

May 7, 2021 James J. Jan  
DIRECTOR OF HIGHWAYS PROJECT IMPLEMENTATION 13

PRINTED BY THE AUTHORITY  
OF THE STATE OF ILLINOIS



80% FED  
20% STATE

80% FED  
20% STATE

SUMMARY OF QUANTITIES			TOTAL QUANTITIES	CONSTRUCTION TYPE CODE		
CODE NO	ITEM	UNIT		0059		
40600290	BITUMINOUS MATERIALS (TACK COAT)	POUND	201	201		
40604052	HOT-MIX ASPHALT SURFACE COURSE, IL-9.5, MIX "C", N70	TON	37	37		
48101200	AGGREGATE SHOULDERS, TYPE B	TON	3.5	3.5		
50300260	BRIDGE DECK GROOVING	SQ YD	145	145		
60260100	INLETS TO BE ADJUSTED	EACH	1	1		
64200108	SHOULDER RUMBLE STRIPS, 8 INCH	FOOT	122	122		
67000400	ENGINEER'S FIELD OFFICE, TYPE A	CAL MO	3	3		
67100100	MOBILIZATION	L SUM	1	1		
70100450	TRAFFIC CONTROL AND PROTECTION, STANDARD 701201	L SUM	1	1		
70107025	CHANGEABLE MESSAGE SIGN	CAL DA	28	28		
70300220	TEMPORARY PAVEMENT MARKING - LINE 4"	FOOT	517	517		
* 78001110	PAINT PAVEMENT MARKING - LINE 4"	FOOT	517	517		
X4401198	HOT-MIX ASPHALT SURFACE REMOVAL, VARIABLE DEPTH	SQ YD	446.3	446.3		

SUMMARY OF QUANTITIES			TOTAL QUANTITIES	CONSTRUCTION TYPE CODE		
CODE NO	ITEM	UNIT		0059		
X7011800	TRAFFIC CONTROL AND PROTECTION, STANDARD BLR 21	L SUM	1	1		
Z0001800	APPROACH SLAB REPAIR (PARTIAL DEPTH)	SQ YD	11	11		
Z0012110	BRIDGE DECK FLY ASH OR GGBF SLAG CONCRETE OVERLAY, 2 1/4"	SQ YD	153	153		
Z0012130	BRIDGE DECK SCARIFICATION 3/4"	SQ YD	153	153		
Z0016001	DECK SLAB REPAIR (FULL DEPTH, TYPE I)	SQ YD	3	3		
Z0016002	DECK SLAB REPAIR (FULL DEPTH, TYPE II)	SQ YD	11	11		
Z0016702	DETOUR SIGNING	L SUM	1	1		
Z0041895	POLYMER CONCRETE	CU FT	3.8	3.8		

\* SPECIALTY ITEM

MODEL: Default  
 FILE NAME: p:\pub\harronm\dot.illinois.gov\PIWDOT\Documents\DOT\_Offices\District\_7\Projects\74989\CAD\Drawings\74989-115-S00.dwg

USER NAME = steffenmk	DESIGNED -	REVISED -
	DRAWN -	REVISED -
PLOT SCALE = 100,0000' / in.	CHECKED -	REVISED -
PLOT DATE = 3/25/2021	DATE -	REVISED -

STATE OF ILLINOIS  
DEPARTMENT OF TRANSPORTATION

SUMMARY OF QUANTITIES

SCALE: SHEET 1 OF 2 SHEETS STA. TO STA.

F.A.P. RTE.	SECTION	COUNTY	TOTAL SHEETS	SHEET NO.
777	D7 BRIDGE REPAIRS 2021-2	FAYETTE	15	3
ILLINOIS STATE AID PROJECT			CONTRACT NO. 74989	

# PROPOSED TYPICAL CROSS SECTION

STA. 910+80 TO STA. 911+42  
STA. 911+77 TO STA. 912+39

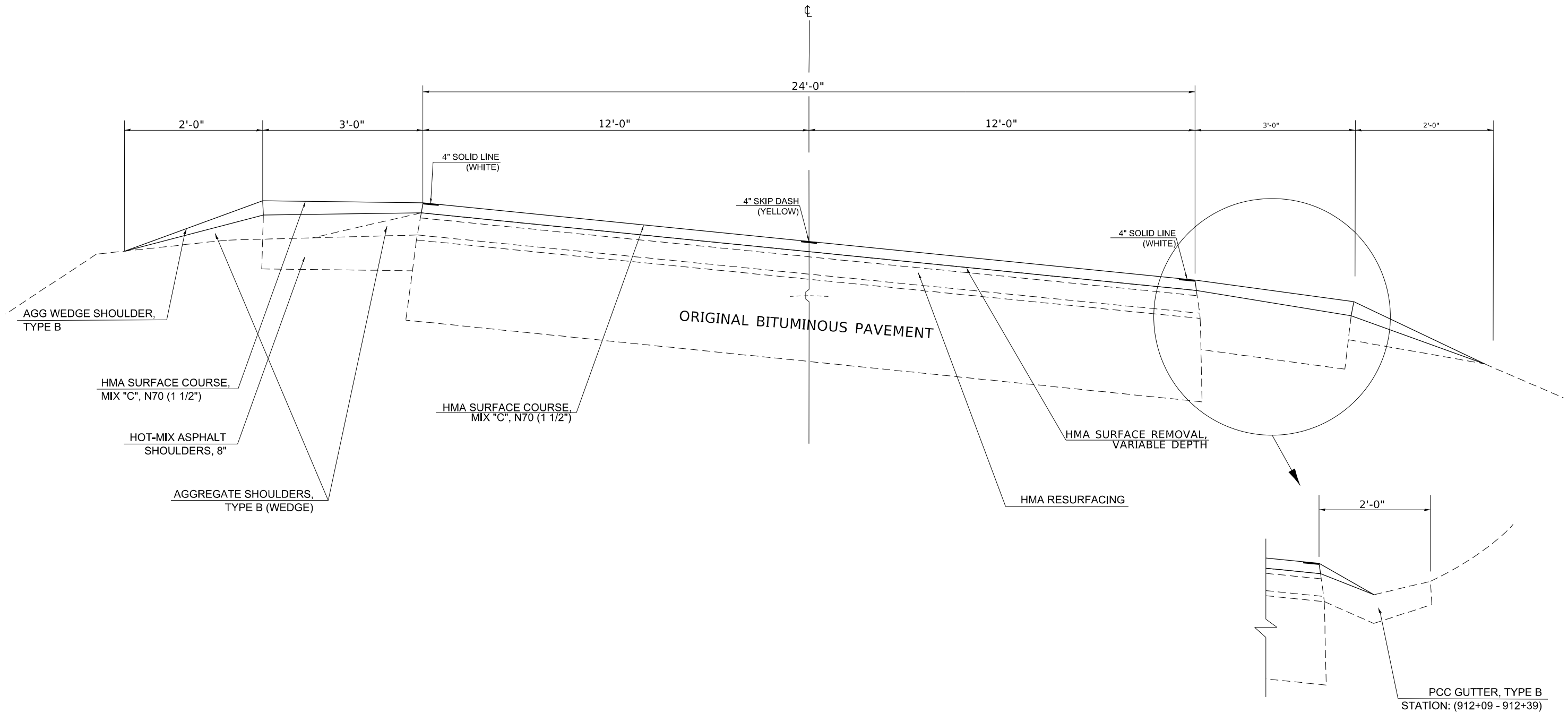

MODEL: Default  
 FILE NAME: p:\pub\lhamon.dwg  
 PLOT DATE: 3/25/2021  
 PLOT SCALE: 100,0000' / in.  
 USER NAME: steffenmk  
 DESIGNED: -  
 DRAWN: -  
 CHECKED: -  
 DATE: -  
 REVISED: -  
 REVISED: -  
 REVISED: -  
 REVISED: -  
 STATE OF ILLINOIS  
 DEPARTMENT OF TRANSPORTATION  
 TYPICAL CROSS SECTIONS  
 SCALE: SHEET OF SHEETS STA. TO STA.  
 F.A.P. RTE. SECTION COUNTY TOTAL SHEETS SHEET NO.  
 777 D7 BRIDGE REPAIRS 2021-2 FAYETTE 15 4  
 CONTRACT NO. 74989  
 ILLINOIS STATE AID PROJECT

USER NAME = steffenmk	DESIGNED -	REVISED -
	DRAWN -	REVISED -
PLOT SCALE = 100,0000' / in.	CHECKED -	REVISED -
PLOT DATE = 3/25/2021	DATE -	REVISED -

**STATE OF ILLINOIS  
DEPARTMENT OF TRANSPORTATION**

**TYPICAL CROSS SECTIONS**

SCALE: SHEET OF SHEETS STA. TO STA.

F.A.P. RTE.	SECTION	COUNTY	TOTAL SHEETS	SHEET NO.
777	D7 BRIDGE REPAIRS 2021-2	FAYETTE	15	4
CONTRACT NO. 74989				
ILLINOIS STATE AID PROJECT				

BITUMINOUS MATERIALS (TACK COAT)						
STATION	TO	STATION	LENGTH (FT)	WIDTH (FT)	AREA (SQ FT)	POUND
<b>MAINLINE</b>						
910+80.00		911+10.00	30.00	24	720.0	36.00
911+10.00		911+42.00	32.00	24	768.0	38.40
911+77.00		912+09.00	32.00	24	768.0	38.40
912+09.00		912+39.00	30.00	24	720.0	36.00
<b>SHOULDER</b>						
LT 910+80.00		911+22.00	42.00	3	126.0	6.30
LT 911+22.00		911+42.00	20.00	8	160.0	8.00
LT 911+77.00		911+93.00	16.00	8	128.0	6.40
LT 911+93.00		912+39.00	46.00	3	138.0	6.90
RT 910+80.00		911+14.00	34.00	3	102.0	5.10
RT 911+14.00		911+42.00	28.00	8	224.0	11.20
RT 911+77.00		911+97.00	20.00	8	160.0	8.00
					<b>TOTAL =</b>	<b>201</b>

HMA SURFACE COURSE, MIX "C", N70 (1 1/2")								
STATION	TO	STATION	LENGTH (FT)	WIDTH (FT)	AREA (SQ YD)	THICKNESS (IN)	TON	
910+80.00		911+42.00	62.00	24	165.3	1.50	13.9	
911+77.00		912+39.00	62.00	24	165.3	1.50	13.9	
910+80.00		911+22.00	42.00	3	14.0	1.50	1.2	
911+22.00		911+42.00	20.00	8	17.8	1.50	1.5	
911+77.00		911+93.00	16.00	8	14.2	1.50	1.2	
911+93.00		912+39.00	46.00	3	15.3	1.50	1.3	
910+80.00		911+14.00	34.00	3	11.3	1.50	1.0	
911+14.00		911+42.00	28.00	8	24.9	1.50	2.1	
911+77.00		911+97.00	20.00	8	17.8	1.50	1.5	
							<b>TOTAL =</b>	<b>37.5</b>

AGGREGATE WEDGE SHOULDERS, TYPE B							
STATION	TO	STATION	LENGTH (FT)	WIDTH (FT)	DEPTH (FT)	CU YD	TONS
LT 910+80.00		911+22.00	42.00	3	0.125	0.58	1.20
LT 911+93.00		912+39.00	46.00	3	0.125	0.64	1.31
RT 910+80.00		911+14.00	34.00	3	0.125	0.47	0.97
						<b>TOTAL =</b>	<b>3.5</b>

SHOULDER RUMBLE STRIPS, 8 INCH			
STATION	TO	STATION	LENGTH (FT)
LT 910+80.00		911+22.00	42.00
LT 911+93.00		912+39.00	46.00
RT 910+80.00		911+14.00	34.00
			<b>TOTAL =</b>
			<b>122.00</b>

INLETS TO BE ADJUSTED	
STATION	EACH
912+00.00	1.00
<b>TOTAL =</b>	
<b>1</b>	

TEMPORARY PAVEMENT MARKING - LINE 4"					
	STATION	TO	STATION	LENGTH (FT)	COLOR
CENTERLINE	910+80.00		912+39.00	40.00	YELLOW
LT	910+80.00		912+39.00	159.00	WHITE
RT	910+80.00		912+39.00	159.00	WHITE
NO PASSING ZONE	910+80.00		912+39.00	159.00	YELLOW
				<b>TOTAL =</b>	<b>517</b>

PAINT PAVEMENT MARKING - LINE 4"					
	STATION	TO	STATION	LENGTH (FT)	COLOR
CENTERLINE	910+80.00		912+39.00	40.00	YELLOW
LT	910+80.00		912+39.00	159.00	WHITE
RT	910+80.00		912+39.00	159.00	WHITE
NO PASSING ZONE	910+80.00		912+39.00	159.00	YELLOW
				<b>TOTAL =</b>	<b>517</b>

HOT-MIX ASPHALT SURFACE REMOVAL, VARIABLE DEPTH					
STATION	TO	STATION	LENGTH (FT)	WIDTH (FT)	AREA (SQ YD)
<b>MAINLINE</b>					
910+80.00		911+42.00	62.00	24	165.3
911+77.00		912+39.00	62.00	24	165.3
<b>SHOULDER</b>					
910+80.00		911+22.00	42.00	3	14.0
911+22.00		911+42.00	20.00	8	17.8
911+77.00		911+93.00	16.00	8	14.2
911+93.00		912+39.00	46.00	3	15.3
910+80.00		911+14.00	34.00	3	11.3
911+14.00		911+42.00	28.00	8	24.9
911+77.00		911+97.00	20.00	8	17.8
					<b>TOTAL =</b>
					<b>446</b>

MODEL: Default  
 FILE NAME: p:\pub\harronm.dwg  
 PROJECT: 74989-CAD\Drawings\DOT - Office\Drawings\74989-SPC\Sheet\4.dwg

USER NAME = steffenmk	DESIGNED -	REVISED -
	DRAWN -	REVISED -
PLOT SCALE = 100,0000' / in.	CHECKED -	REVISED -
PLOT DATE = 3/25/2021	DATE -	REVISED -

**STATE OF ILLINOIS  
DEPARTMENT OF TRANSPORTATION**

**SUMMARY OF QUANTITIES**

SCALE: SHEET 1 OF 2 SHEETS STA. TO STA.

F.A.P. RTE.	SECTION	COUNTY	TOTAL SHEETS	SHEET NO.
777	D7 BRIDGE REPAIRS 2021-2	FAYETTE	15	5
ILLINOIS STATE AID PROJECT			CONTRACT NO. 74989	

MODEL: Default  
 FILE NAME: p:\pub\harronm.dwt\illinois.gov\PWIDOT\Documents\DOT\_Offices\District 7\Projects\74989\CADD\Drawings\74989-Plan.dgn

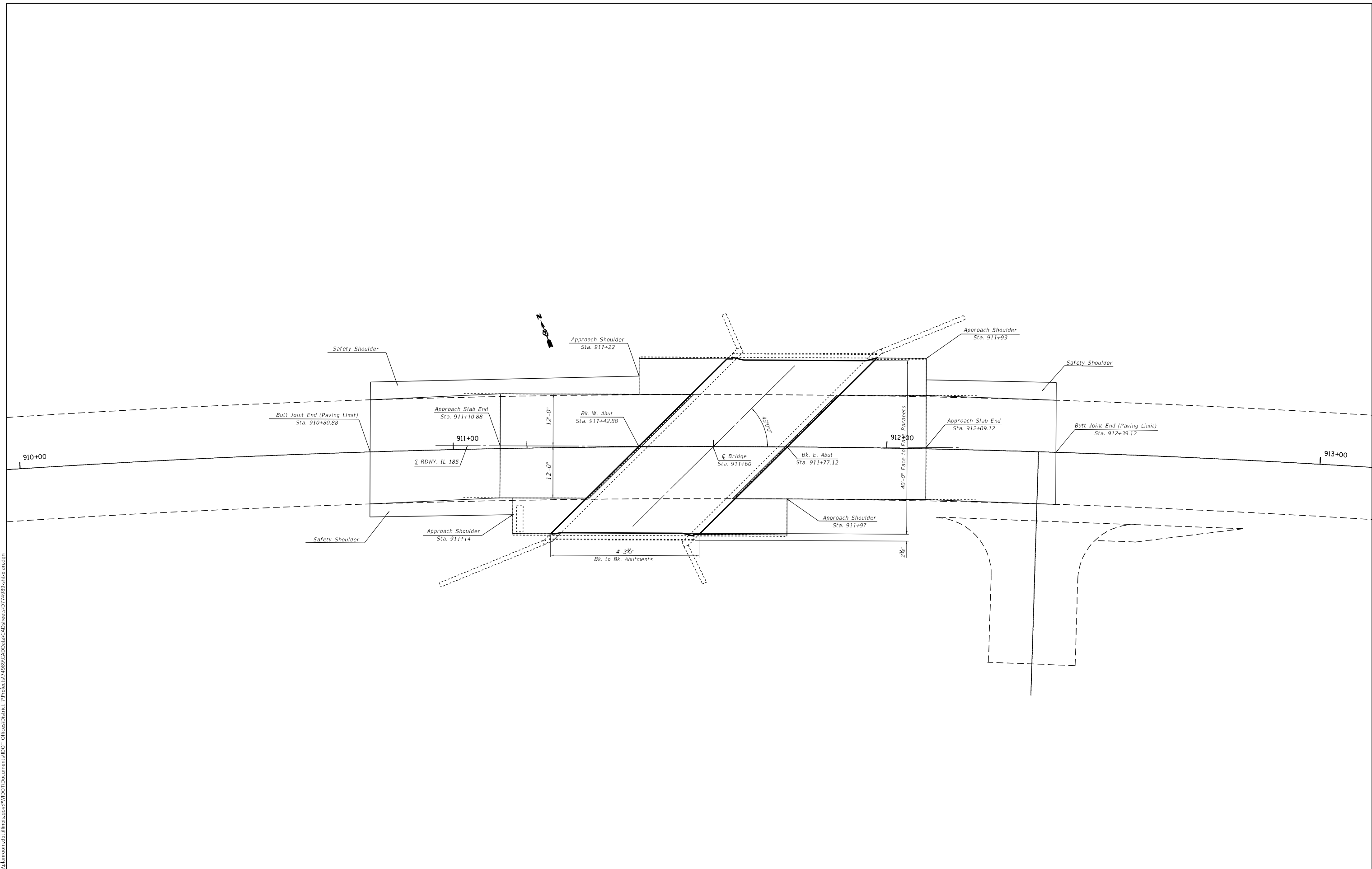

USER NAME = steffenmk	DESIGNED -	REVISED -
	DRAWN -	REVISED -
PLOT SCALE = 20,0000 * / in.	CHECKED -	REVISED -
PLOT DATE = 3/25/2021	DATE -	REVISED -

**STATE OF ILLINOIS**  
**DEPARTMENT OF TRANSPORTATION**

**PLAN VIEW**  
**SN 026-0051**

SCALE:      SHEET      OF      SHEETS      STA.      TO      STA.

F.A.P. RTE.	SECTION	COUNTY	TOTAL SHEETS	SHEET NO.
777	D7 BRIDGE REPAIRS 2021-2	FAYETTE	15	6
CONTRACT NO. 74989				
ILLINOIS STATE AID PROJECT				

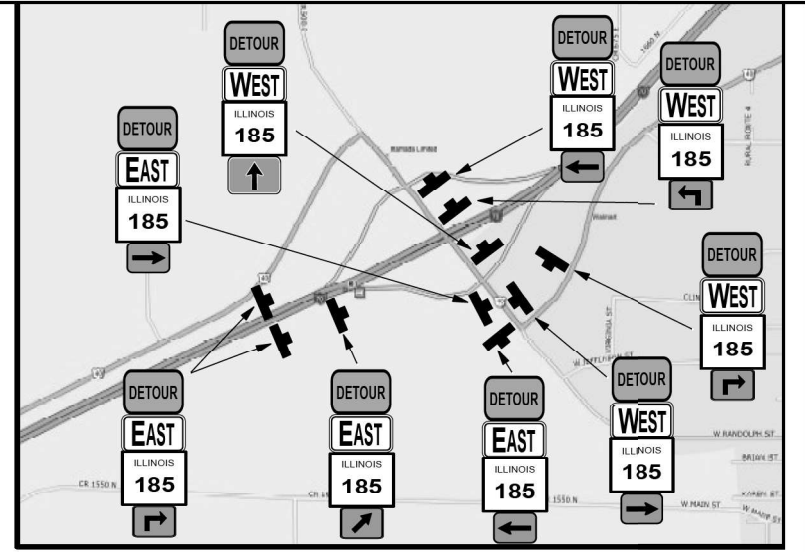
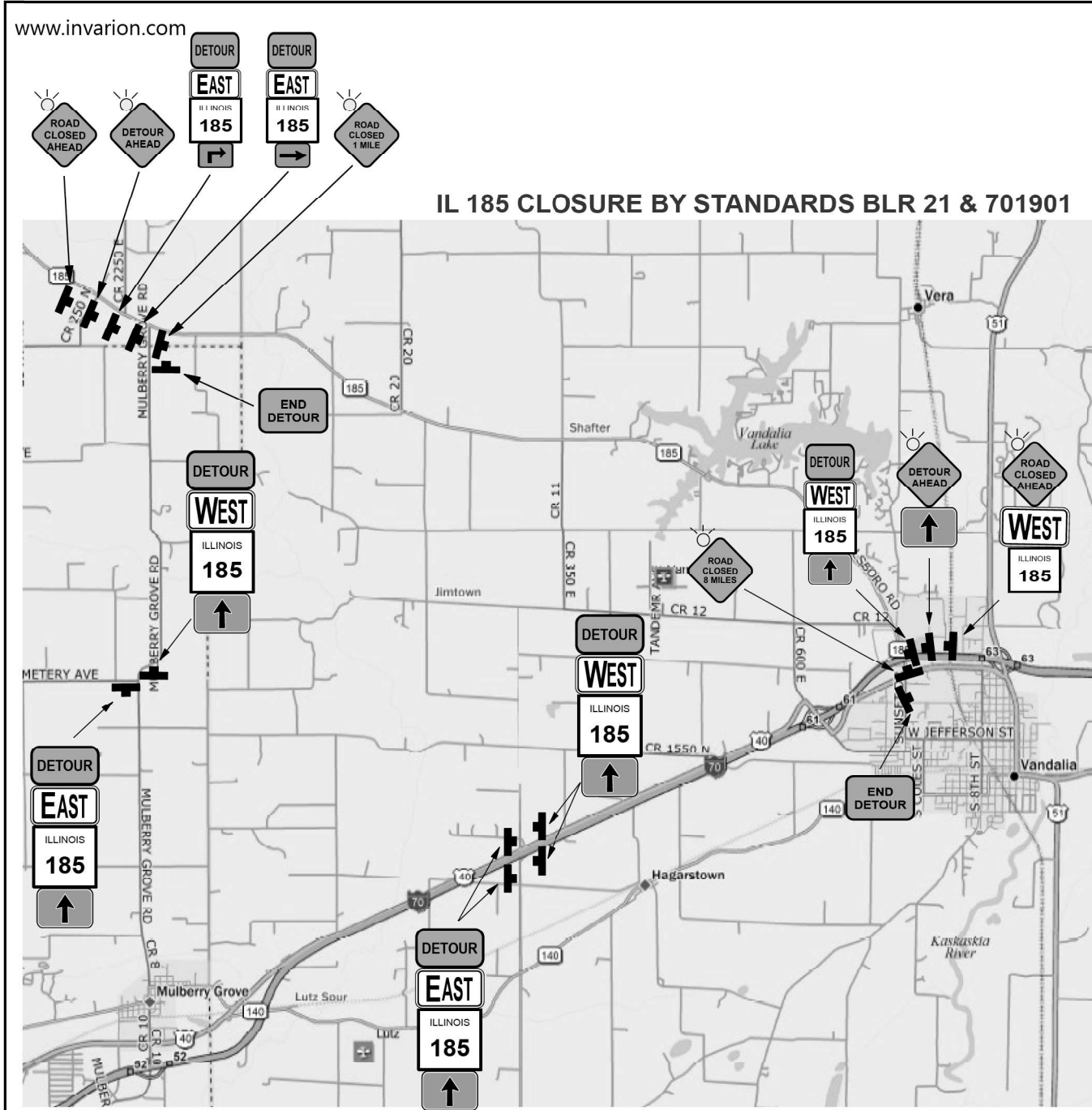

**EXIT 61**

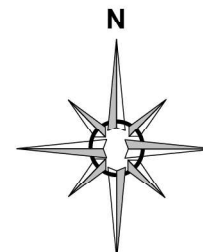

**CONTRACT NO. 74989**

**EXIT 52**

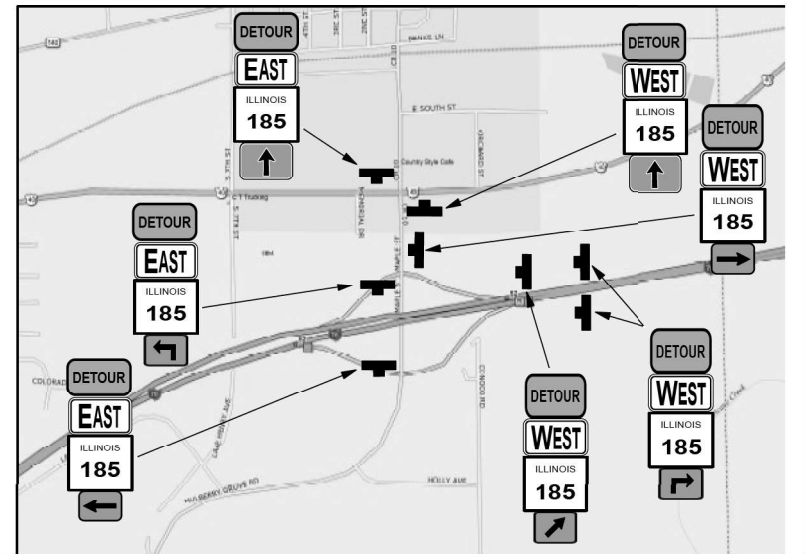

**SIGN LEGEND**

ROAD CLOSED AHEAD	W20-3-48	EAST ILLINOIS 185	M3-2-3015	M6-3(O)-3018	M6-1R(O)-3018
ROAD CLOSED 1 MILE		WEST ILLINOIS 185	M3-4-3015	M5-1R(O)-3018	M6-1L(O)-3018
DETOUR	W20-2(O)-48	ILLINOIS 185	M1-1100-4536	M5-1L(O)-3018	M4-8a(O)-3024

MODEL: Default  
 FILE NAME: p:\invarion\mtd\74989\DOT\Documents\DOT - Office\Distric: 7\Projects\74989\CADD\data\CAD\detour\74989-51c-detour.dgn  
 MODEL: Default  
 FILE NAME: p:\invarion\mtd\74989\DOT\Documents\DOT - Office\Distric: 7\Projects\74989\CADD\data\CAD\detour\74989-51c-detour.dgn

USER NAME = stefenmk	DESIGNED -	REVISED -
	DRAWN -	REVISED -
PLOT SCALE = 100,0000' / in.	CHECKED -	REVISED -
PLOT DATE = 3/25/2021	DATE -	REVISED -

**STATE OF ILLINOIS  
DEPARTMENT OF TRANSPORTATION**

**DETOUR SIGNING**

SCALE: SHEET OF SHEETS STA. TO STA.

F.A.P. RTE.	SECTION	COUNTY	TOTAL SHEETS	SHEET NO.
777	D7 BRIDGE REPAIRS 2021-2	FAYETTE	15	7
				CONTRACT NO. 74989
ILLINOIS STATE AID PROJECT				

SN. 026-0051 carries IL-185 (FAP 777) over a branch of Hurricane Creek. The existing single span, steel multi-beam structure with closed abutments was constructed in 1936. In 1984 the superstructure and approach pavements were replaced and the closed abutments were made integral. The proposed project consists of bridge deck scarification, deck patching, bridge deck overlay, and approach pavement patching.

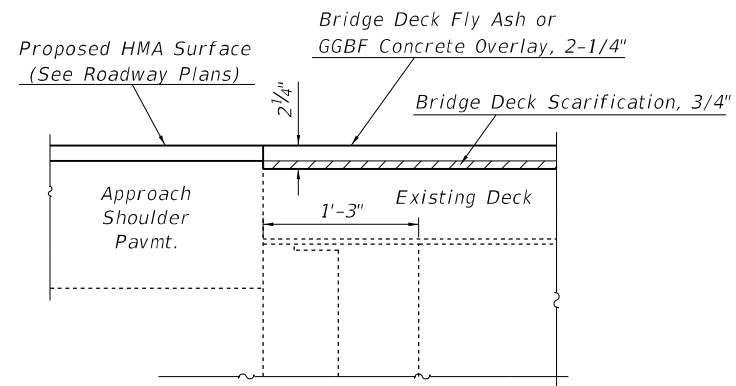

SECTION A-A

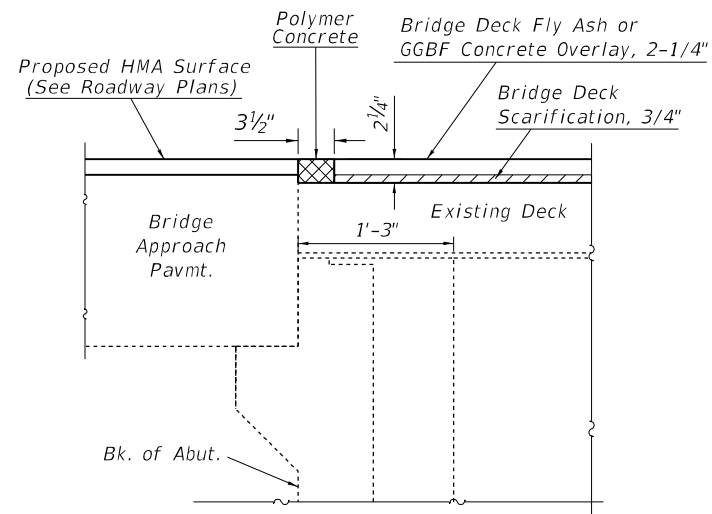

SECTION B-B

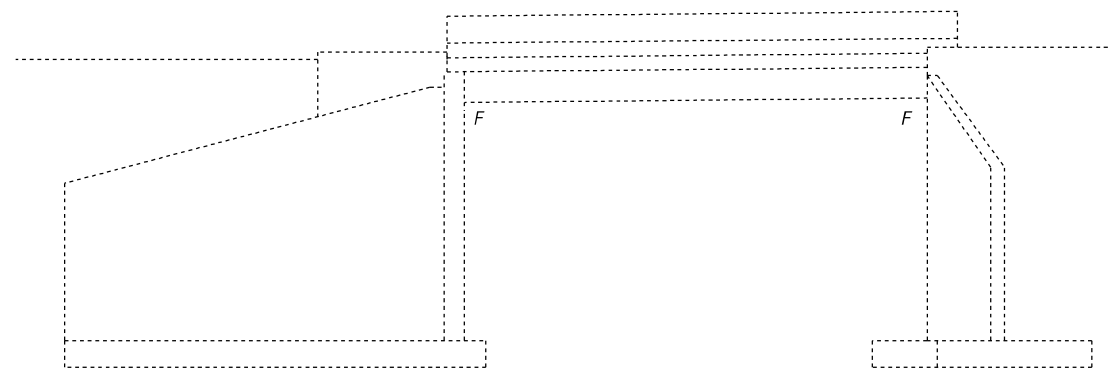

ELEVATION

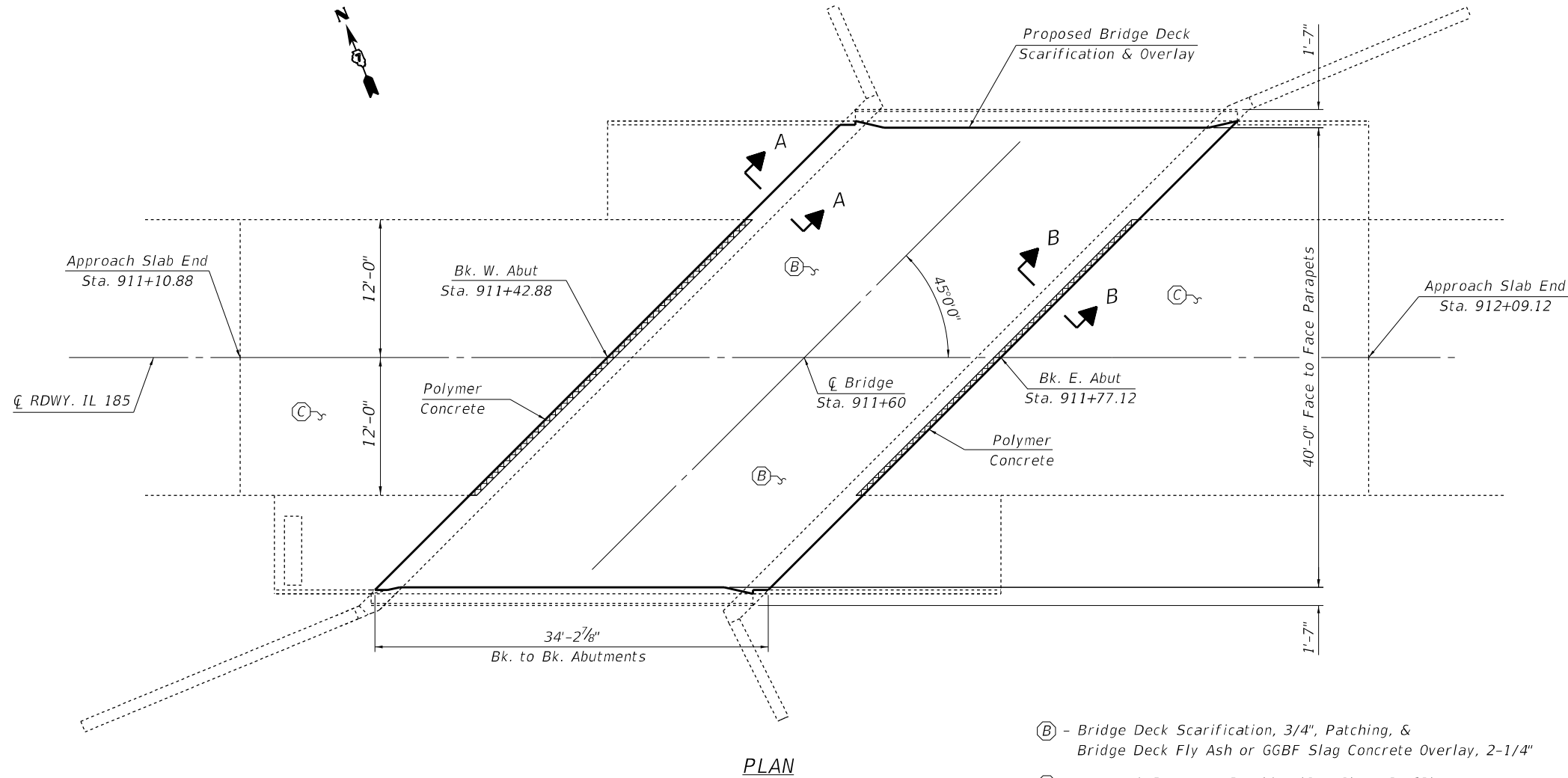

PLAN

- (B) - Bridge Deck Scarification, 3/4", Patching, & Bridge Deck Fly Ash or GGBF Slag Concrete Overlay, 2-1/4"
- (C) - Approach Pavement Patching (See Sheet 3 of 3) & Proposed HMA Overlay (See Roadway Plans)



Expires 11-30-2022  
*David Carl Puzey*  
 04/27/2021

MODEL: Default  
 FILE NAME: p:\pub\harronm.dwt\illinc\dot\p\w\dot\Documents\DOT - Office\District 7\Projects\74989\CADD\DATA\CAD\Drawings\74989-026-0051 - Bridge Repairs - Plans.dgn

USER NAME = steffennk	DESIGNED - T. Walk	REVISED -
	DRAWN - T. Walk	REVISED -
PLOT SCALE = 100,0000' / in.	CHECKED - D. Macklin	REVISED -
PLOT DATE = 3/25/2021	DATE - 02/04/2020	REVISED -

STATE OF ILLINOIS  
 DEPARTMENT OF TRANSPORTATION

PLAN & ELEVATION  
 SN. 026-0051

SCALE: SHEET 1 OF 3 SHEETS STA. TO STA.

F.A.P. RTE.	SECTION	COUNTY	TOTAL SHEETS	SHEET NO.
777	D7 BRIDGE REPAIRS 2021-2	FAYETTE	15	8
CONTRACT NO. 74989			ILLINOIS STATE AID PROJECT	







## PROPOSED MILLING DETAIL S.N. 026-0051 APPROACH

NOTE: NOT DRAWN TO SPECIFIC SCALE

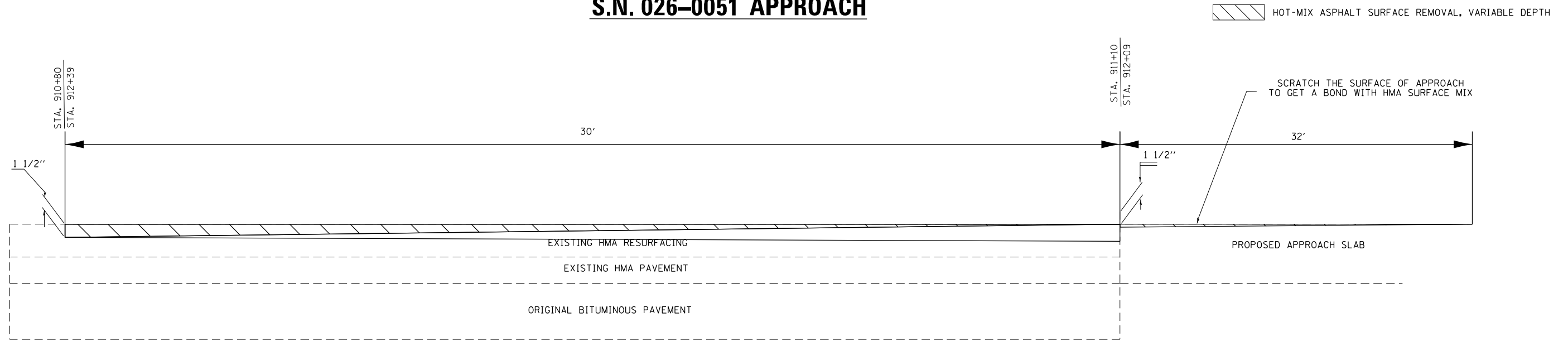

## PROPOSED PAVING DETAIL S.N. 026-0051 APPROACH

NOTE: NOT DRAWN TO SPECIFIC SCALE

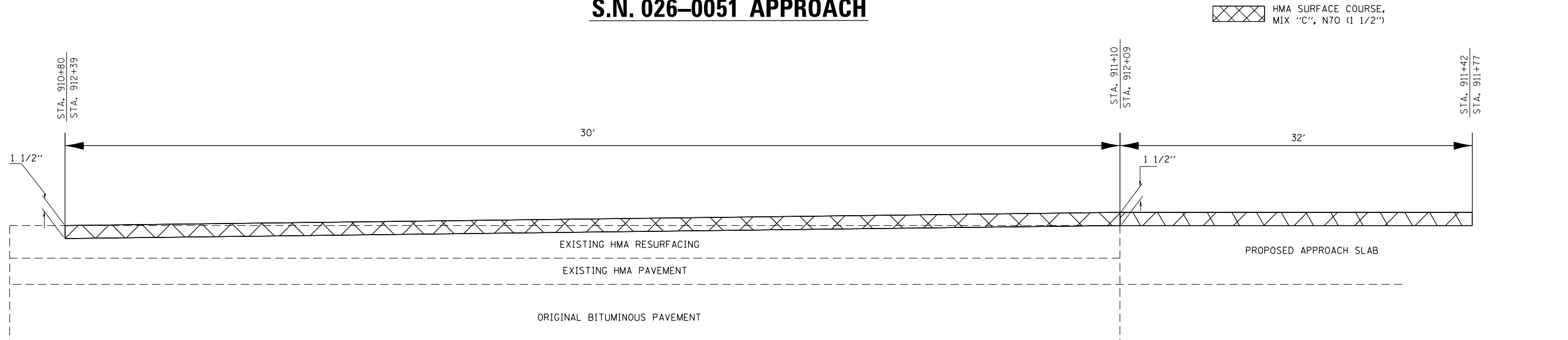

MODEL: Default  
 FILE NAME: p:\pub\harronm.dwt  
 ILLINOIS DOT  
 PROJECT: 74989  
 CAD: DataCAD  
 PROJECT: D74989-51c-detaill.dgn

USER NAME = steffenmk	DESIGNED - T. Walk	REVISED -
	DRAWN - T. Walk	REVISED -
PLOT SCALE = 100,0000' / in.	CHECKED - D. Macklin	REVISED -
PLOT DATE = 3/25/2021	DATE - 02/04/2020	REVISED -

**STATE OF ILLINOIS  
DEPARTMENT OF TRANSPORTATION**

**MILLING / PAVING DETAIL**

SCALE: SHEET 1 OF 3 SHEETS STA. TO STA.

F.A.P. RTE.	SECTION	COUNTY	TOTAL SHEETS	SHEET NO.
777	D7 BRIDGE REPAIRS 2021-2	FAYETTE	15	11
CONTRACT NO. 74989				
ILLINOIS STATE AID PROJECT				

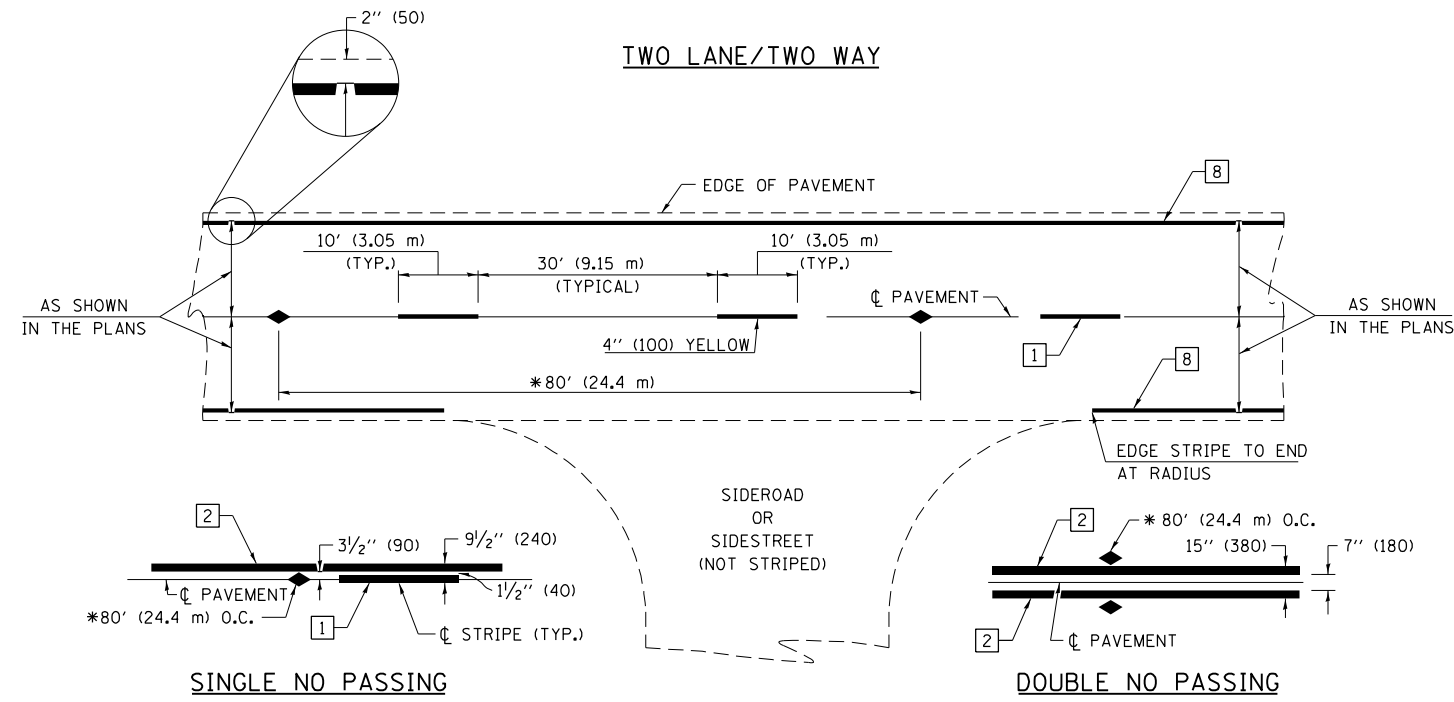

\* REDUCE TO 40' (12.2 m) O.C. ON CURVES WITH POSTED OR ADVISORY SPEEDS OF 45 mph (70 km/h) OR LESS.

PAVEMENT MARKING LEGEND

- 1 4" (100) SKIP-DASH (YELLOW)
- 2 4" (100) SOLID (YELLOW)
- 3 12" (300) DIAGONAL (YELLOW)
- 4 4" (100) DOUBLE YELLOW (NARROW)
- 5 12" (300) SOLID WHITE
- 6 RESERVED
- 7 6" (150) SKIP-DASH (WHITE)
- 8 4" (100) SOLID (WHITE)
- 9 12" (300) DIAGONAL (WHITE)
- 10 6" (150) SOLID (WHITE)
- 11 24" (600) STOP BAR (WHITE)
- 12 8" (200) SOLID (WHITE)
- 13 4" (100) PARKING WHITE

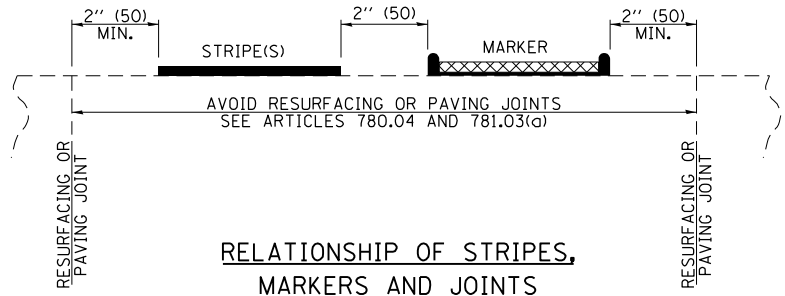

RELATIONSHIP OF STRIPES, MARKERS AND JOINTS

TYPICAL PAVEMENT MARKERS LEGEND

- ◆ TWO-WAY AMBER MARKER
- ▶ ONE-WAY AMBER MARKER
- ▷ ONE-WAY CRYSTAL MARKER

RAISED REFLECTIVE PAVEMENT MARKERS

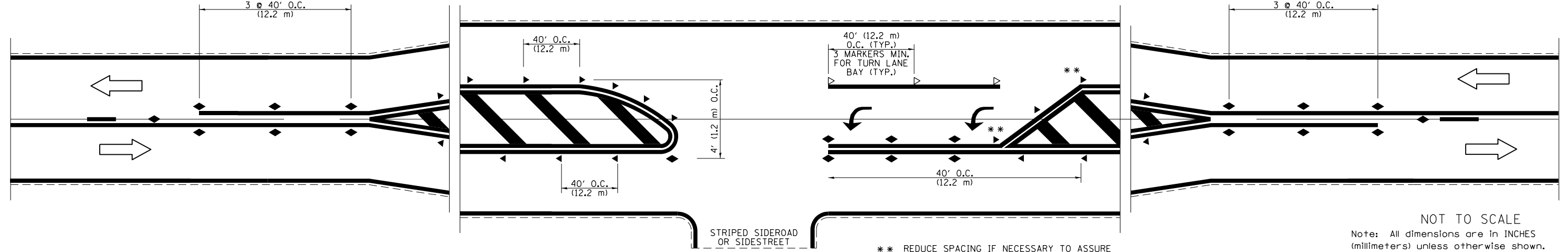

\*\* REDUCE SPACING IF NECESSARY TO ASSURE MARKERS AT CORNER POINTS.

NOT TO SCALE  
Note: All dimensions are in INCHES (millimeters) unless otherwise shown.

DISTRICT 7 DETAIL NO. 7800001

FILE NAME =	USER NAME = steffennk	DESIGNED -	REVISED -	<b>STATE OF ILLINOIS DEPARTMENT OF TRANSPORTATION</b>	<b>PAVEMENT MARKING AND RAISED REFLECTIVE PAVEMENT MARKERS (RURAL &amp; URBAN APPLICATIONS)</b>	F.A.P. RTE.	SECTION	COUNTY	TOTAL SHEETS	SHEET NO.
pw:\planning\dot.illinois.gov\PIWIDOT\Documents\IDOT Offices\District 7\Projects\74989\DRAWN\CADsheets\0774989-sht-details.dgn	DESIGNED -	REVISED -	777			07 BRIDGE REPAIRS 2021-2	FAYETTE	15	12	
PLOT SCALE = 100.0000' / in.	CHECKED -	REVISED -	CONTRACT NO. 74989							
PLOT DATE = 3/25/2021	DATE -	REVISED -	ILLINOIS STATE AID PROJECT							

SCALE: SHEET NO. 1 OF 4 SHEETS STA. TO STA.

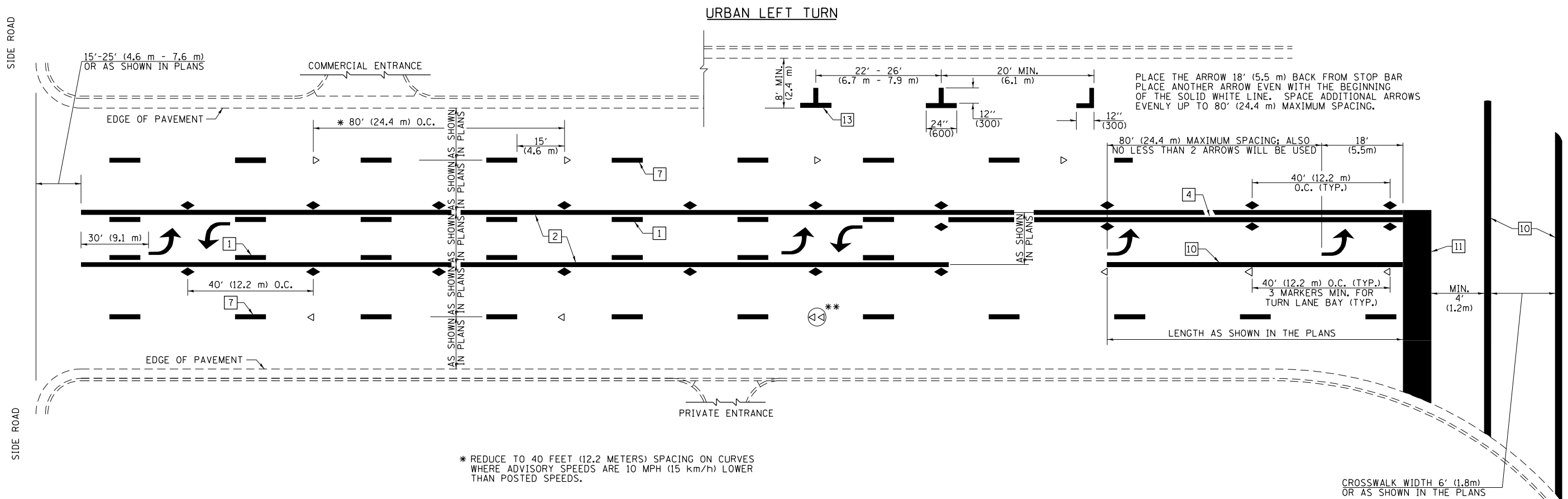

\* REDUCE TO 40 FEET (12.2 METERS) SPACING ON CURVES WHERE ADVISORY SPEEDS ARE 10 MPH (15 km/h) LOWER THAN POSTED SPEEDS.

\*\* DOUBLE LANE LINE MARKERS SHALL BE SPECIFIED AND SPACED AS SHOWN IN HIGHWAY STANDARD 781001 FOR MULTI-LANE DIVIDED AND UNDIVIDED HIGHWAYS.

**PAVEMENT MARKING LEGEND**

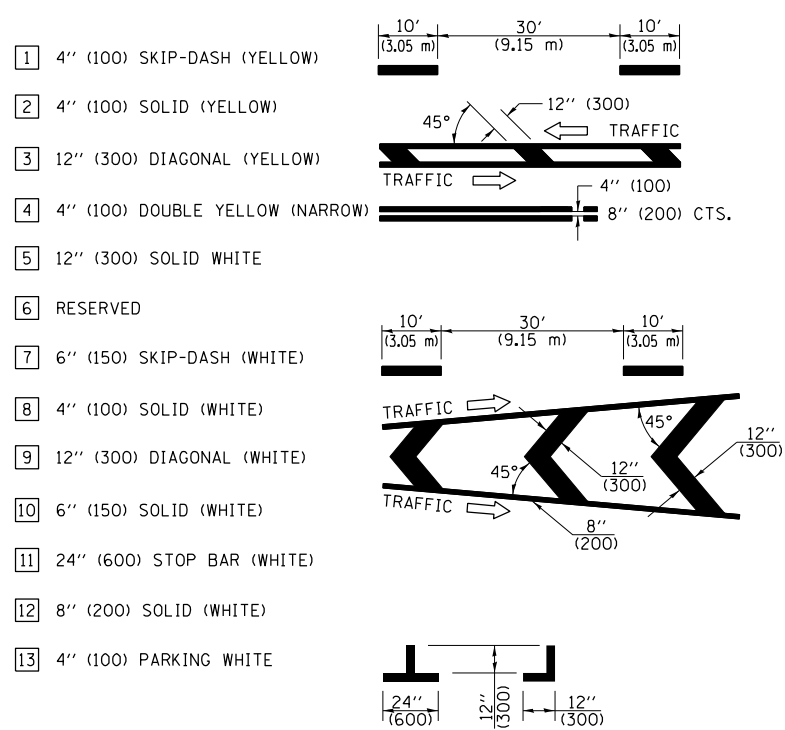

**GENERAL NOTES**

- TURN ARROW PAIRS SHALL BE PLACED AT 250' (75 m) INTERVALS AND SHALL BE EVENLY SPACED BETWEEN BOTH ENDS OF THE BIDIRECTIONAL LEFT TURN LANE. USE A MINIMUM OF TWO PAIRS PER BLOCK.
- THE SOLID YELLOW PAVEMENT MARKINGS [2] SHOULD GENERALLY START OR END NEAR THE RADIUS POINT OF EACH STREET RETURN EXCEPT WHERE ONE OR BOTH ENDS WOULD INCLUDE STOP BARS.
- THE SKIP-DASH PAVEMENT MARKINGS [1] OR [7] SHOULD BE CENTERED BETWEEN BOTH ENDS OF EACH CITY BLOCK AND SHALL BE PLACED SO THEY LINE UP ACROSS FROM EACH OTHER.
- USE LARGE ARROW SIZE FOR BOTH RURAL AND URBAN LOCATIONS. (SEE LAST PAGE OF SECTION 780x FOR SYMBOLS TABLE)
- LANE LINE EXTENSIONS SHALL BE THE SAME COLOR AND WIDTH AS THE LANE LINE BEING EXTENDED.

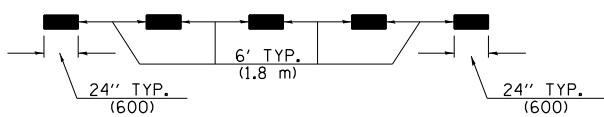

**LANE LINE EXTENSIONS**

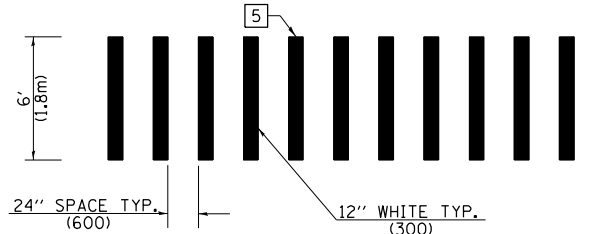

**CROSSWALK DETAIL (DECATUR CITY LIMITS ONLY)**

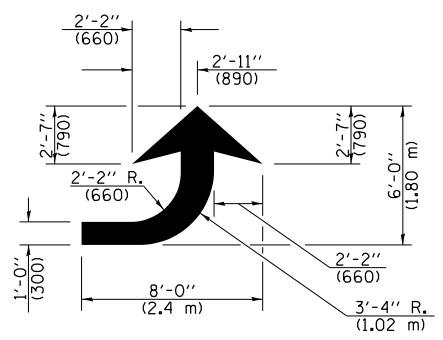

**LEFT ARROW**

REVERSE FOR RIGHT ARROW  
AREA = 15.6 SQ. FT. (1.47 m<sup>2</sup>)  
(WHITE)

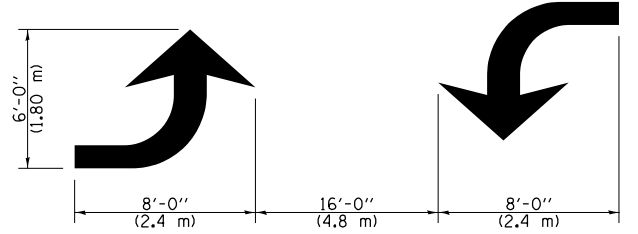

**TYPICAL DOUBLE TURN ARROWS (WHITE)**

NOT TO SCALE

Note: All dimensions are in INCHES (millimeters) unless otherwise shown.

FILE NAME =	USER NAME = steffennk	DESIGNED -	REVISED -	<b>STATE OF ILLINOIS DEPARTMENT OF TRANSPORTATION</b>	<b>PAVEMENT MARKING AND RAISED REFLECTIVE PAVEMENT MARKERS (RURAL &amp; URBAN APPLICATIONS)</b>	F.A.P. RTE.	SECTION	COUNTY	TOTAL SHEETS	SHEET NO.	
pw:\planroom.dot.illinois.gov\PWIDOT\Documents\IDOT Offices\District 7\Projects\74989\DRAWN\CADsheets\0774989-shd-details.dwg	DRWN	REVISIONS	REVISIONS			777	07 BRIDGE REPAIRS 2021-2	FAYETTE	15	13	
PLOT SCALE = 100.0000' / in.	CHECKED -	REVISIONS	REVISIONS			CONTRACT NO. 74989					
PLOT DATE = 3/25/2021	DATE -	REVISIONS	REVISIONS			ILLINOIS STATE AID PROJECT					

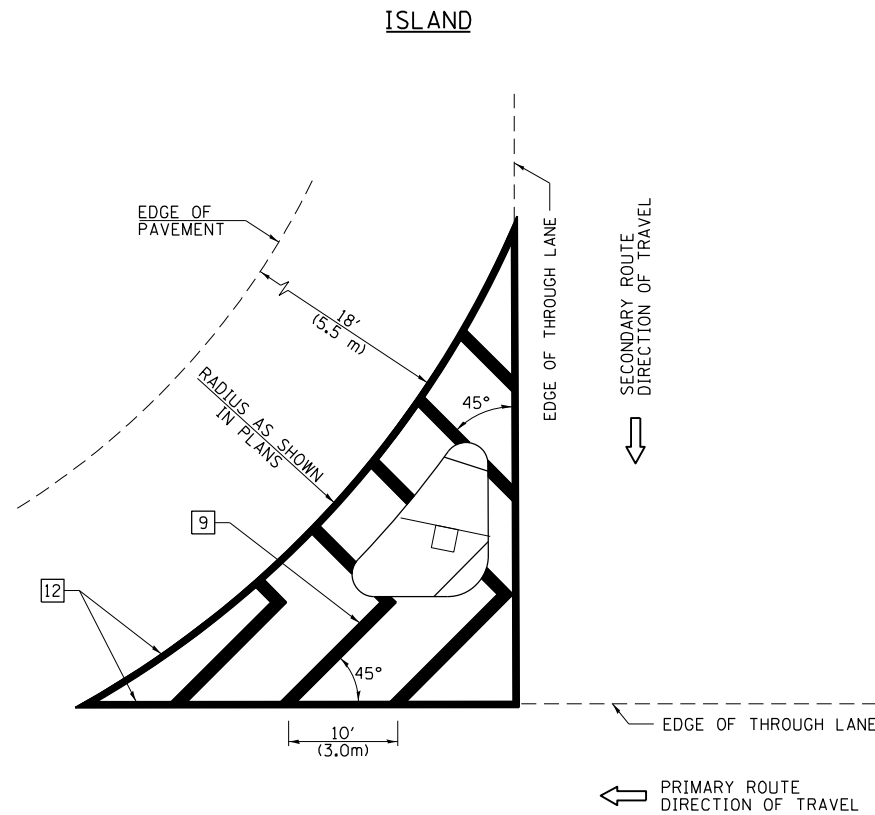

**GENERAL NOTES**

1. RAISED AND CORRUGATED MEDIANS SHALL BE OUTLINED WITH [2] IF PRESENT.
2. SOME OF THE INFORMATION INCLUDED WITH THIS DETAIL MAY NOT BE APPLICABLE TO THIS IMPROVEMENT.
3. PAVEMENT MARKINGS ARE TO BE EXTENDED THROUGH OMISSIONS WHEN APPLICABLE.
4. FINAL PAVEMENT MARKINGS SHALL BE IN PLACE PRIOR TO PLACING ANY RAISED REFLECTIVE PAVEMENT MARKERS.
5. THE FOLLOWING CRITERIA SHALL BE USED FOR SELECTING THE DIAGONAL PAVEMENT MARKING SPACING:

< 30 MPH (< 50 km/h)	15' (4.5 m)
30-45 MPH (50-75 km/h)	20' (6.0 m)
> 45 MPH (> 75 km/h)	30' (9.0 m)

**PAVEMENT MARKING LEGEND**

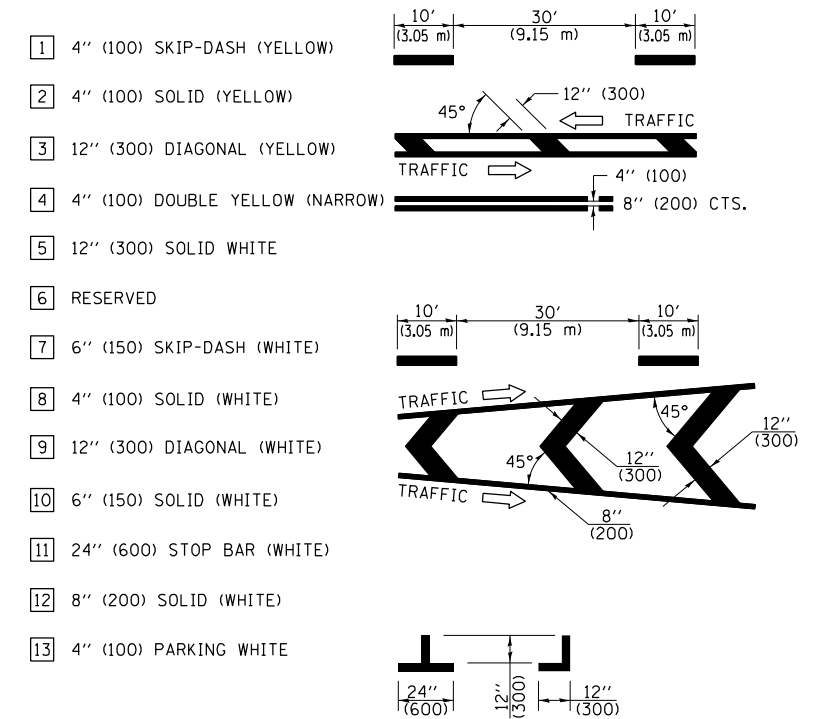

**RURAL LEFT TURN STRIPING**

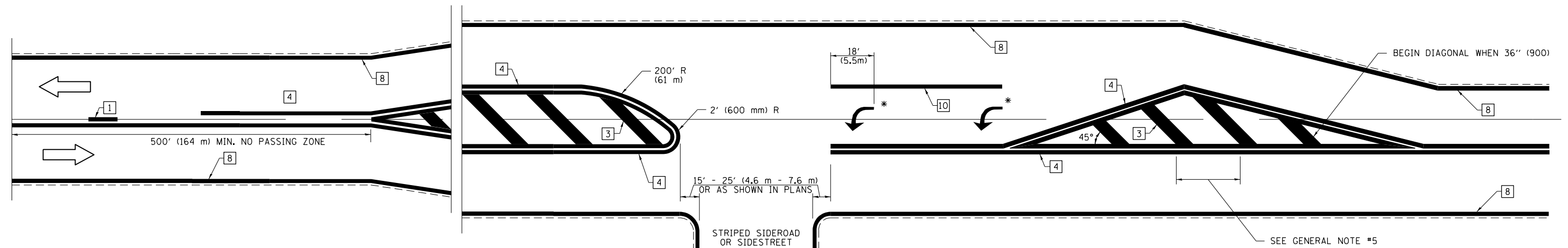

\* PLACE AN ARROW 18' (5.5 m) BACK FROM STOP BAR. PLACE ANOTHER ARROW EVEN WITH THE BEGINNING OF THE SOLID WHITE LINE. SPACE ADDITIONAL ARROWS EVENLY UP TO 80' (24.4 m) MAXIMUM SPACING. USE MINIMUM OF 2 ARROWS.

NOT TO SCALE  
Note: All dimensions are in INCHES (millimeters) unless otherwise shown.

**DISTRICT 7 DETAIL NO. 7800001**

FILE NAME =	USER NAME = steffenmk	DESIGNED -	REVISED -
pw:\plnroom.dot.illinois.gov\PIDOT\Documents\IDOT Offices\District 7\Projects\74989\DRAWN\CADsheets\0774989-sht-details.dgn		REVISIONS	REVISIONS
	PLOT SCALE = 100.0000' / in.	CHECKED -	REVISED -
	PLOT DATE = 3/25/2021	DATE -	REVISED -

**STATE OF ILLINOIS  
DEPARTMENT OF TRANSPORTATION**

**PAVEMENT MARKING AND RAISED REFLECTIVE PAVEMENT MARKERS  
(RURAL & URBAN APPLICATIONS)**

SCALE: SHEET NO. 3 OF 4 SHEETS STA. TO STA.

F.A.P. RTE.	SECTION	COUNTY	TOTAL SHEETS	SHEET NO.
777	07 BRIDGE REPAIRS 2021-2	FAYETTE	15	14
CONTRACT NO. 74989			ILLINOIS STATE AID PROJECT	

PAVEMENT MARKINGS AT RAILROAD-HIGHWAY GRADE CROSSING

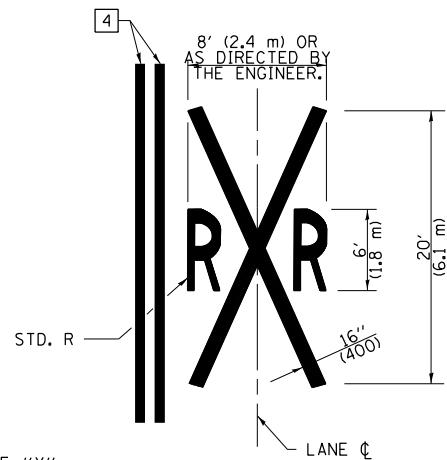
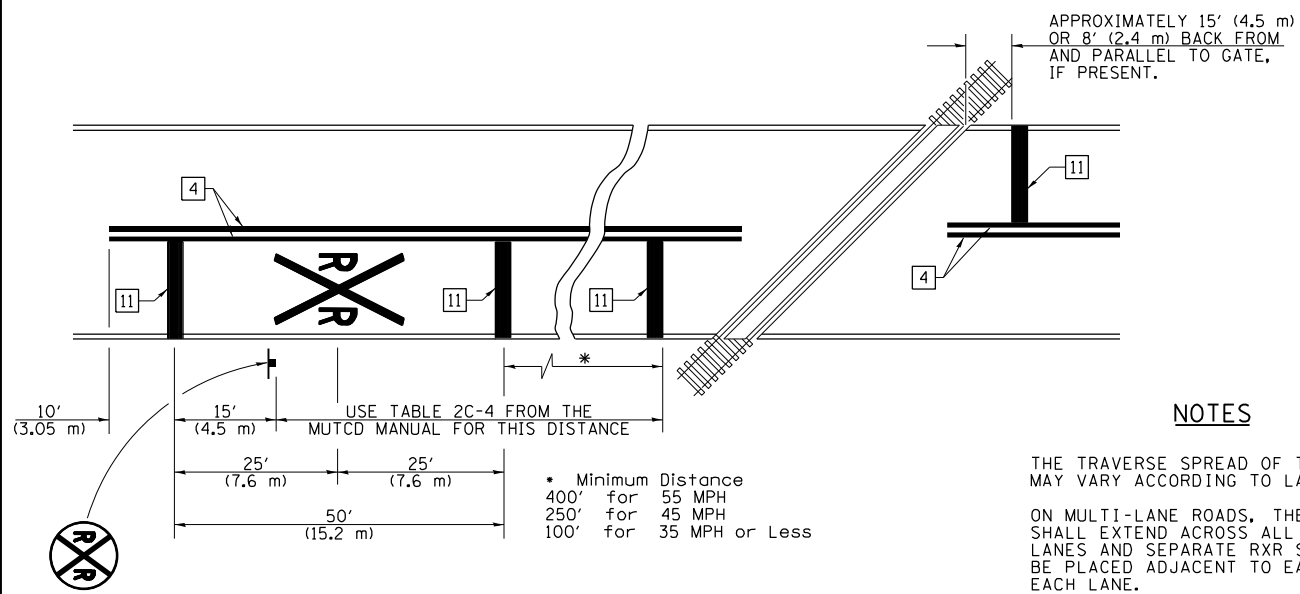

NOTES

THE TRAVERSE SPREAD OF THE "X" MAY VARY ACCORDING TO LANE WIDTH.

ON MULTI-LANE ROADS, THE STOP LINES SHALL EXTEND ACROSS ALL APPROACH LANES AND SEPARATE RXR SYMBOLS SHALL BE PLACED ADJACENT TO EACH OTHER IN EACH LANE.

WHEN THE PAVEMENT MARKING SYMBOL IS USED, A PORTION OF THE SYMBOL SHOULD BE LOCATED DIRECTLY ADJACENT TO THE ADVANCE WARNING SIGN (W10-1) AS PLACED BY TABLE II-1, CONDITION B OF THE MUTCD.

PAVEMENT MARKING LEGEND

- 1 4" (100) SKIP-DASH (YELLOW)
- 2 4" (100) SOLID (YELLOW)
- 3 12" (300) DIAGONAL (YELLOW)
- 4 4" (100) DOUBLE YELLOW (NARROW)
- 5 12" (300) SOLID WHITE
- 6 RESERVED
- 7 6" (150) SKIP-DASH (WHITE)
- 8 4" (100) SOLID (WHITE)
- 9 12" (300) DIAGONAL (WHITE)
- 10 6" (150) SOLID (WHITE)
- 11 24" (600) STOP BAR (WHITE)
- 12 8" (200) SOLID (WHITE)
- 13 4" (100) PARKING WHITE

RAILROAD CROSSING WITH INTERCONNECT ONLY

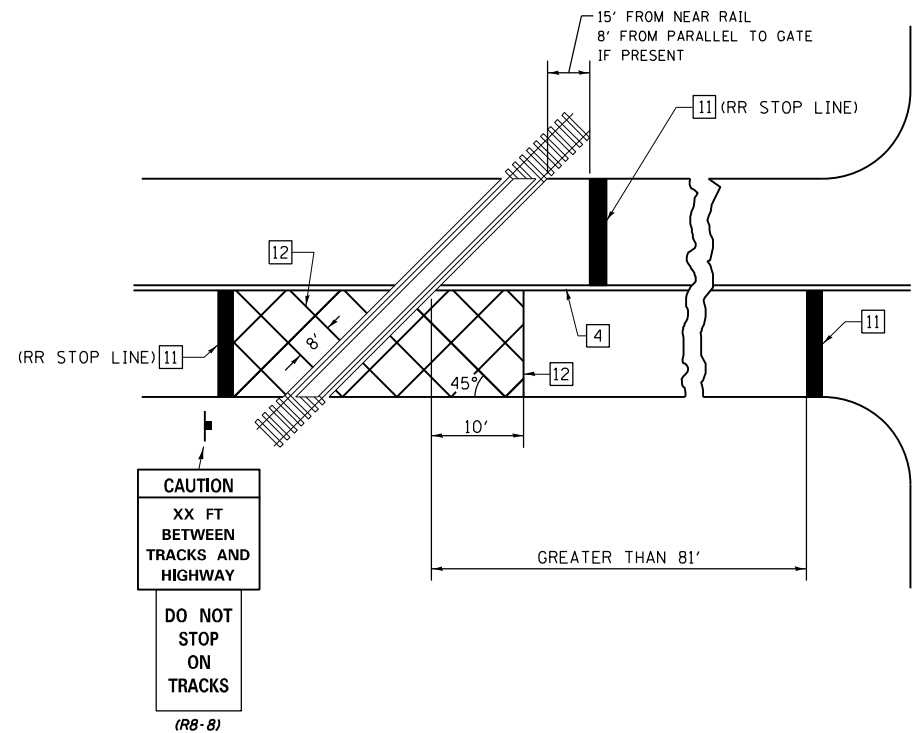

RAILROAD CROSSING WITH INTERCONNECT AND PRE-SIGNALS

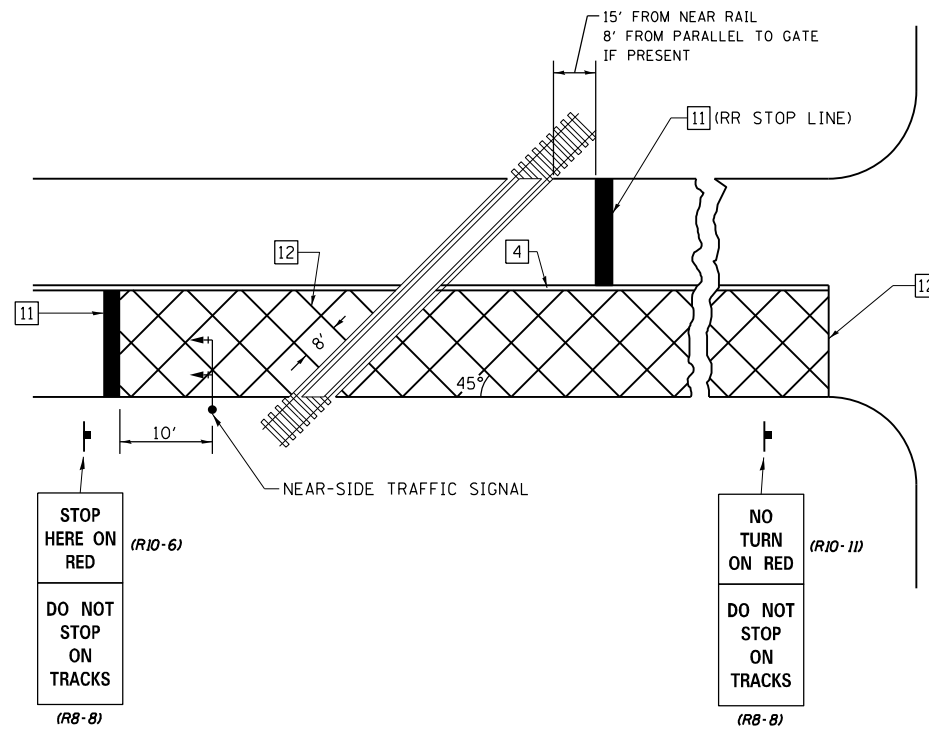

GENERAL NOTES

- SUPPLEMENTAL PAVEMENT MARKINGS TO BE INSTALLED ONLY ON APPROACHES TO INTERSECTIONS CONTROLLED BY TRAFFIC SIGNALS WHICH ARE INTERCONNECTED WITH THE RAILROAD WARNING SIGNALS.
- EXTEND PAVEMENT MARKINGS TO THE INTERSECTION ONLY WHERE NEAR-SIDE TRAFFIC SIGNALS ARE USED.

SUPPLEMENTAL PAVEMENT MARKING TREATMENT FOR RAILROAD-HIGHWAY GRADE CROSSING

NOT TO SCALE

Note: All dimensions are in INCHES (millimeters) unless otherwise shown.

FILE NAME =	USER NAME = steffennk	DESIGNED -	REVISED -	<b>STATE OF ILLINOIS DEPARTMENT OF TRANSPORTATION</b>	<b>PAVEMENT MARKING AND RAISED REFLECTIVE PAVEMENT MARKERS (RURAL &amp; URBAN APPLICATIONS)</b>	F.A.P. RTE.	SECTION	COUNTY	TOTAL SHEETS	SHEET NO.	
pw:\planroom.dot.illinois.gov\PIDOT\Documents\IDOT Offices\District 7\Projects\74989\DRAWN\CADsheets\0774989-sht-details.dgn		CHECKED -	REVISED -			777	07 BRIDGE REPAIRS 2021-2	FAYETTE	15	15	
		DATE -	REVISED -			CONTRACT NO. 74989		ILLINOIS STATE AID PROJECT			
						SCALE:	SHEET NO. 4 OF 15 SHEETS	STA.	TO STA.		