

STATE OF ILLINOIS
DEPARTMENT OF TRANSPORTATION

F.A.P. RTE.	SECTION	COUNTY	TOTAL SHEETS	SHEET NO.
	D9 Patch 2021-4	GALLATIN	6	1
		ILLINOIS	CONTRACT NO. 78842	

D-99-018-21

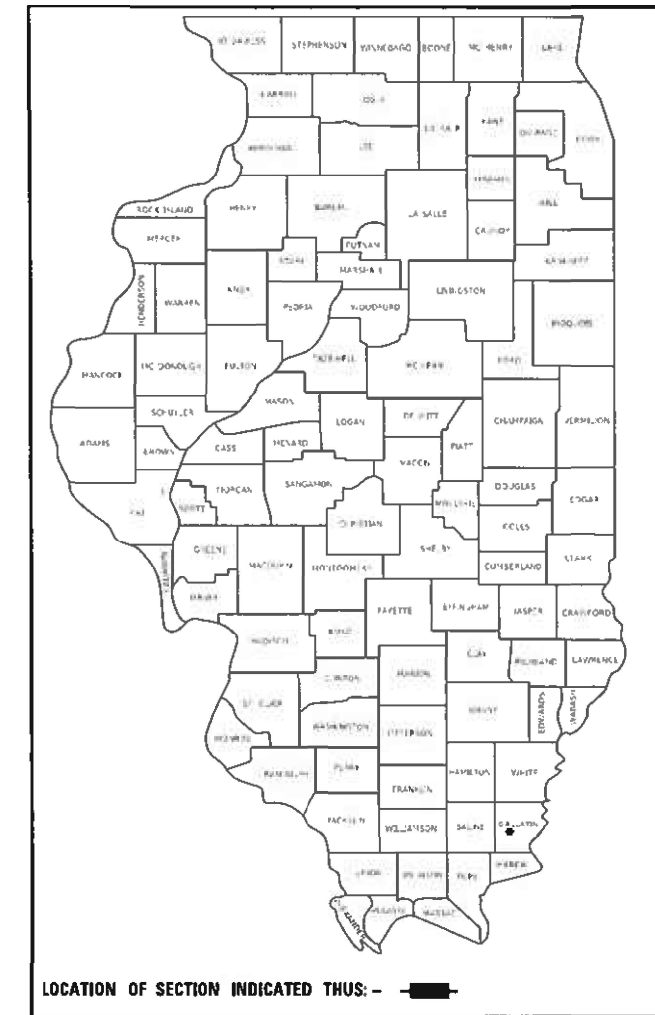

FOR INDEX OF SHEETS, SEE SHEET NO. 3
FOR SUMMARY OF QUANTITIES, SEE SHEET NO. 4

**PROPOSED
HIGHWAY PLANS**

FAP ROUTE 331/782 (IL 13/IL 1)
SECTION D9 PATCH 2021-4

TRAFFIC DATA
SEE SHEET NO. 3

**PATCHING
GALLATIN COUNTY**

**TOWNSHIPS
EQUALITY**

C-99-025-21

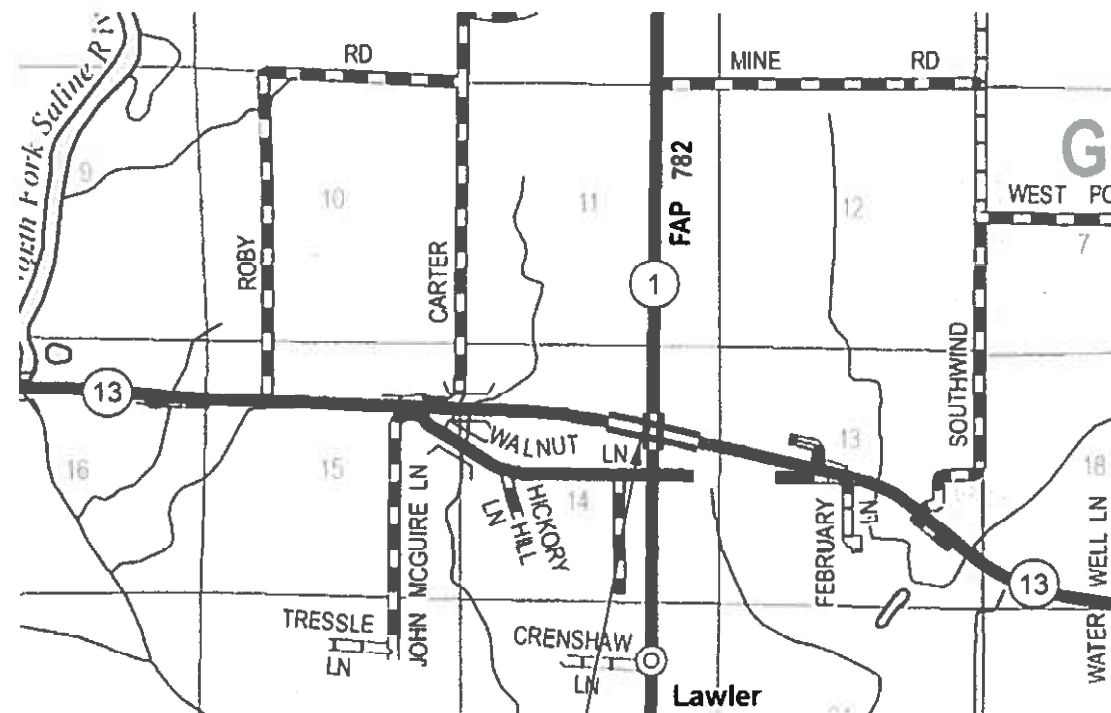

**LOCATION OF WORK
IL 13/IL 1 INTERSECTION**

DESIGN DESIGNATION : NA
COORDINATE SYSTEM : NA
POSTED SPEED : 55 MPH

STATE OF ILLINOIS
DEPARTMENT OF TRANSPORTATION

SUBMITTED 0208-2021
[Signature]
REGION FIVE ENGINEER

May 7, 2021 [Signature]
ENGINEER OF DESIGN AND ENVIRONMENT

May 7, 2021 [Signature]
DIRECTOR OF HIGHWAYS PROJECT IMPLEMENTATION 13

J.U.L.I.E.
JOINT UTILITY LOCATION INFORMATION FOR EXCAVATION
1-800-892-0123
OR 811

PROJECT ENGINEER VALERIE ROLLA
PROJECT DESIGNER MICHAELA MONTGOMERY

GROSS LENGTH = 2196.98 FT. = 0.42 MILES
NET LENGTH = 2196.98 FT. = 0.42 MILES

CONTRACT NO. 78842

**PRINTED BY THE AUTHORITY
OF THE STATE OF ILLINOIS**

INDEX OF SHEETS

SHEET NO	DESCRIPTION
1	COVER SHEET
2	SIGNATURE SHEET
3	INDEX OF SHEETS, HIGHWAY STANDARDS, TRAFFIC DATA, GENERAL NOTES
4	SUMMARY OF QUANTITIES
5-6	PATCHING SCHEDULES

HIGHWAY STANDARDS

- 000001-08: STANDARD SYMBOLS, ABBREVIATIONS, AND PATTERNS
- 001001-02: AREAS OF REINFORCEMENT BARS
- 001006: DECIMAL OF AN INCH AND OF A FOOT
- 442101-09: CLASS B PATCHES
- 701301-04: LANE CLOSURE, 2L, 2W, SHORT TIME OPERATIONS
- 701336-07: LANE CLOSURE, 2L, 2W, WORK AREAS IN SERIES, FOR SPEEDS \geq 45 MPH
- 701901-08: TRAFFIC CONTROL DEVICES
- 420701-03: PAVEMENT WELDED WIRE REINFORCEMENT
- 420001-09: PAVEMENT JOINTS

TRAFFIC DATA

ROUTE	IL 1 (N OF IL 13)	IL 1 (S OF IL 13)	IL 13 (E OF IL 1)	IL 13 (W OF IL 1)
FAP	728	728	331	331
2021				
P.V. =	1040	1245	2500	2955
S.U. =	60	100	100	155
M.U. =	280	385	610	560
DHV =	125	155	290	330
ADT =	1380	1730	3210	3670

GENERAL NOTES

COMMITMENTS: NONE

REV. - MS

MODEL: D:\draft
 FILE NAME: p:\planroom\dot\illinois\gov\p\w\dot\Documents\DOT_Offices\District 9\Projects\78842\CADD\331\CD\Sheets\78842_Sheets.dgn

USER NAME = fowlera	DESIGNED -	REVISED -	STATE OF ILLINOIS DEPARTMENT OF TRANSPORTATION	HIGHWAY STANDARDS, INDEX OF SHEETS, AND GENERAL NOTES		F.A.P. RTE.	SECTION	COUNTY	TOTAL SHEETS	SHEET NO.
PLOT SCALE = 100.0000' / in.	DRAWN -	REVISED -				*	D9 Patch 2021-4	GALLATIN	6	3
PLOT DATE = 2/22/2021	CHECKED -	REVISED +				CONTRACT NO. 78842				
	DATE -	REVISED +				ILLINOIS FED. AID PROJECT				
			SCALE:	SHEET	OF	SHEETS	STA.	TO	STA.	

*FAP 331/FAP 782

SUMMARY OF QUANTITIES

COUNTY:	GALLATIN	GALLATIN
ROUTE:	IL 13	IL 1
FUNDING:	100% STATE	100% STATE
LOCATION:	RURAL	RURAL
	ROADWAY	ROADWAY
	0005	0005

CODE NUMBER	ITEM DESCRIPTION	UNIT	TOTAL QUANTITY	ROADWAY 0005	ROADWAY 0005
44200050	WELDED WIRE REINFORCEMENT	SQ YD	1,183	226	957
44200934	CLASS B PATCHES, TYPE II, 8 INCH	SQ YD	155	73	82
44200942	CLASS B PATCHES, TYPE III, 8 INCH	SQ YD	102	64	38
44200944	CLASS B PATCHES, TYPE IV, 8 INCH	SQ YD	1,022	162	860
44201299	DOWEL BARS 1 1/2"	EACH	740	320	420
44213200	SAW CUTS	FOOT	3,180	1,070	2,110
44213204	TIE BARS 3/4"	EACH	258	35	223
67100100	MOBILIZATION	L SUM	1	0.5	0.5
70100600	TRAFFIC CONTROL AND PROTECTION, STANDARD 701336	L SUM	1	0.5	0.5
70103815	TRAFFIC CONTROL SURVEILLANCE	CAL DA	21	11	10
70107025	CHANGEABLE MESSAGE SIGN	CAL DA	28	14	14

MODEL: Default
 FILE NAME: \\paulhammon.dot.illinois.gov\PWDOT\Documents\DOT_Offices\District 9\Projects\78842_CAD\Drawings\78842_Sheets.dgn

USER NAME = fowler PLOT SCALE = 100,0000' / in. PLOT DATE = 2/22/2021	DESIGNED - DRAWN - CHECKED - DATE -	REVISED - REVISED - REVISED - REVISED -	STATE OF ILLINOIS DEPARTMENT OF TRANSPORTATION	SUMMARY OF QUANTITIES	SCALE: SHEET OF SHEETS STA. TO STA.	F.A.P. RTE. SECTION COUNTY TOTAL SHEETS SHEET NO.
					D9 Patch 2021-4 GALLATIN 6 4 CONTRACT NO. 78842	
					ILLINOIS FED. AID PROJECT <small>*FAP 331/FAP 782</small>	

IL 13 PATCHING SCHEDULE

LOCATION	PATCH NO.	STA	WIDTH	LENGTH	AREA	CLASS B PATCHES, TYPE II, 8 INCH	CLASS B PATCHES, TYPE III, 8 INCH	CLASS B PATCHES, TYPE IV, 8 INCH	WELDED WIRE REINFORCEMENT	SAW CUTS	DOWEL BARS 1 1/2"	TIE BARS 3/4"	
			FT	FT	SQ YD	SQ YD	SQ YD	SQ YD	SQ YD	SQ YD	FT	(EACH)	(EACH)
IL 13 EB (ALL WEST OF ROUTE 1)													
	1	1808+14	17	13	25					77	20		
	2	1808+89	17	6	12	12				63	20		
	3	1809+65	17	6	12	12				63	20		
	4	1810+62	19	12	26			26	26	81	20		
	5	1812+36	16.5	11	21		21		21	72	20		
	6	1814+31	16	13	24		24		24	74	20		
	7	1815+20	16	20	36			36	36	88	20	9	
LEFT TURN LANE	8	1815+20	10.7	6	8	8				44	20		
LEFT TURN LANE	9	1816+25	16.5	22	41			41	41	94	20	10	
LEFT TURN LANE	10	1817+30	12	6	8	8				48	20		
	11	1817+80	16	33	59			59	59	114	20	16	
IL 13 WB (ALL EAST OF ROUTE 1)													
LEFT TURN LANE	12	1822+25	11	7	9	9				47	20		
LEFT TURN LANE	13	1821+88	11	6	8	8				45	20		
LEFT TURN LANE	14	1820+30	11	6	8	8				45	20		
LEFT TURN LANE	15	1819+90	11	6	8	8				45	20		
TOTAL:	SUBTOTAL:						73	45	162	207	1000	300	35

IL 1 / IL13 INTERSECTION PATCHING SCHEDULE

LOCATION	PATCH NO.	STA	WIDTH	LENGTH	AREA	CLASS B PATCHES, TYPE II, 8 INCH	CLASS B PATCHES, TYPE III, 8 INCH	CLASS B PATCHES, TYPE IV, 8 INCH	WELDED WIRE REINFORCEMENT	SAW CUTS	DOWEL BARS 1 1/2"	TIE BARS 3/4"
			FT	FT	SQ YD	SQ YD	SQ YD	SQ YD	SQ YD	SQ YD	FT	(EACH)
IL 1 SBL (SOUTH OF INTERSECTION)												
	1	212+00	17.5	6	12	12			12	65	20	
	2	213+10	16	25	45			45	45	98	20	12
	3	213+99	16	6	11	11			11	60	20	
IL 1 NBL (SOUTH OF INTERSECTION)												
	4	213+20	16.5	87	160			160	160	224	20	43
	5	212+00	19.5	6	13	13			13	71	20	
RIGHT TURN LANE	6	212+00	15.5	6	11	11			11	59	20	
RIGHT TURN LANE	7	211+80	17	6	12	12			12	63	20	
IL 13 EBL (IN INTERSECTION)												
	8	1819+20	16.5	10	19		19		19	70	20	
IL 1 SUBTOTAL:						59	0	205	264	640	140	55
IL 13 SUBTOTAL:							19		19	70	20	

MODEL: Default
 FILE: M:\MIS - Planning\GIS\Projects\DOT - Office\District 9\Projects\78842_CADD\DATA\CAD\patches\78842_Sheets.dgn

USER NAME = fowlera	DESIGNED -	REVISED -
	DRAWN -	REVISED -
PLOT SCALE = 100,0000' / in.	CHECKED -	REVISED -
PLOT DATE = 2/22/2021	DATE -	REVISED -

**STATE OF ILLINOIS
DEPARTMENT OF TRANSPORTATION**

PATCHING SCHEDULES

SCALE: SHEET OF SHEETS STA. TO STA.

F.A.P. RTE.	SECTION	COUNTY	TOTAL SHEETS	SHEET NO.
-	D9 Patch 2021-4	GALLATIN	6	5
			CONTRACT NO. 78842	
		ILLINOIS FED. AID PROJECT		

IL 1 PATCHING SCHEDULE

LOCATION	PATCH NO.	STA	WIDTH	LENGTH	AREA	CLASS B PATCHES, TYPE II, 8 INCH	CLASS B PATCHES, TYPE III, 8 INCH	CLASS B PATCHES, TYPE IV, 8 INCH	WELDED WIRE REINFORCEMENT	SAW CUTS	DOWEL BARS 1 1/2"	TIE BARS 3/4"	
			FT	FT	SQ YD	SQ YD	SQ YD	SQ YD	SQ YD	FT	(EACH)	(EACH)	
IL 1 NB (NORTH OF INTERSECTION)													
	1	210+30	17	19	36			36	36.0	89	20		
	2	209+50	16	60	107			107	107.0	168	20	29	
	3	208+75	16	22	40			40	40.0	92	20	10	
	4	208+00	16	64	114			114	114.0	176	20	31	
	5	207+50	15	33	55			55	55.0	111	20	16	
	6	206+65	14	23	36			36	36.0	88	20	11	
	7	205+90	14	6	9	9				53	20		
	8	205+25	16	10	18		18		18.0	68	20		
IL 1 SB (NORTH OF INTERSECTION)													
	9	1817+30	13	46	67			67	67.0	131	20	22	
	10	1817+80	16	11	20		20		20.0	70	20		
	11	1822+25	17	33	63			63	63.0	117	20	16	
	12	1821+88	17.5	36	70			70	70.0	125	20	17	
	13	1820+30	17.5	34	67			67	67.0	121	20	16	
	14	1819+90	15.5	8	14	14				63	20		
TOTAL :			SUBTOTAL :				23	38	655	693	1470	280	168

PATCHING TOTALS

	CLASS B PATCHES, TYPE II, 8 INCH	CLASS B PATCHES, TYPE III, 8 INCH	CLASS B PATCHES, TYPE IV, 8 INCH	WELDED WIRE REINFORCEMENT	SAW CUTS	DOWEL BARS 1 1/2"	TIE BARS 3/4"
	SQ YD	SQ YD	SQ YD	SQ YD	FT	(EACH)	(EACH)
IL 1 SUBTOTAL :	82	38	860	957	2110	420	223
IL 13 SUBTOTAL :	73	64	162	226	1070	320	35
TOTAL :	155	102	1022	1183	3180	740	258

MODEL: Default
 FILE NAME: \\paulhammon.dtu.illinois.gov\PIWDOT\Documents\DOT_Office\District_9\Projects\78842_CAD\Drawings\78842_Sheets.dgn

USER NAME = fowler	DESIGNED -	REVISED -
	DRAWN -	REVISED -
PLOT SCALE = 100,0000' / in.	CHECKED -	REVISED -
PLOT DATE = 2/22/2021	DATE -	REVISED -

**STATE OF ILLINOIS
DEPARTMENT OF TRANSPORTATION**

PATCHING SCHEDULES

SCALE: SHEET OF SHEETS STA. TO STA.

F.A.P. RTE.	SECTION	COUNTY	TOTAL SHEETS	SHEET NO.
-	D9 Patch 2021-4	GALLATIN	6	6
CONTRACT NO. 78842				
ILLINOIS FED. AID PROJECT				