

06-11-2021 LETTING ITEM 136

STATE OF ILLINOIS  
DEPARTMENT OF TRANSPORTATION

HENDERSON COUNTY	SHEET NO.	1
FAS ROUTE 416	TOTAL SHEETS	2
CONTRACT NO. 89808		
FEDERAL PROJECT NO. ICHT(783)		
SECTION 20-00066-01-PV		

# PLANS FOR PROPOSED LOCAL AGENCY IMPROVEMENT SURFACE TRANSPORTATION PROGRAM - RURAL

HENDERSON COUNTY  
F.A.S. ROUTE 416 - ROSEVILLE JUNCTION ROAD  
SECTION 20-00066-01-PV  
STATE JOB NO. C-94-041-21  
FEDERAL PROJECT NO. ICHT(783)  
CONTRACT NO. 89808

### INDEX OF SHEETS

1. COVER SHEET
2. TYPICAL SECTIONS, GENERAL NOTES AND SUMMARY OF QUANTITIES

### LIST OF STANDARDS

000001-08	STANDARD SYMBOLS, ABBREVIATIONS, AND PATTERNS
701001-02	TRAFFIC CONTROL FOR OFF ROAD OPERATIONS
701006-05	TRAFFIC CONTROL FOR OFF ROAD OPERATIONS
701011-04	TRAFFIC CONTROL FOR OFF ROAD OPERATIONS
701306-04	TRAFFIC CONTROL FOR DAYTIME MOVING OPERATIONS
701311-03	TRAFFIC CONTROL FOR DAYTIME MOVING OPERATIONS
701901-08	TRAFFIC CONTROL DEVICES
BLR 21-9	TYPICAL APPLICATION OF TRAFFIC CONTROL DEVICES FOR CONSTRUCTION ON RURAL HWYS

### SUMMARY OF QUANTITIES

X4401198	HMA SURFACE REMOVAL (VAR DP)	SQ YD	31,386.0
Z0055605	RUBBLIZE PCC PAVEMENT	SQ YD	25,620.0
67100100	MOBILIZATION	L SUM	1.0

### PROJECT DESCRIPTION

REMOVE THE BITUMINOUS SURFACE FROM THE EXISTING ROADWAY AND RUBBLIZE THE EXISTING PORTLAND CEMENT CONCRETE BASE COURSE.

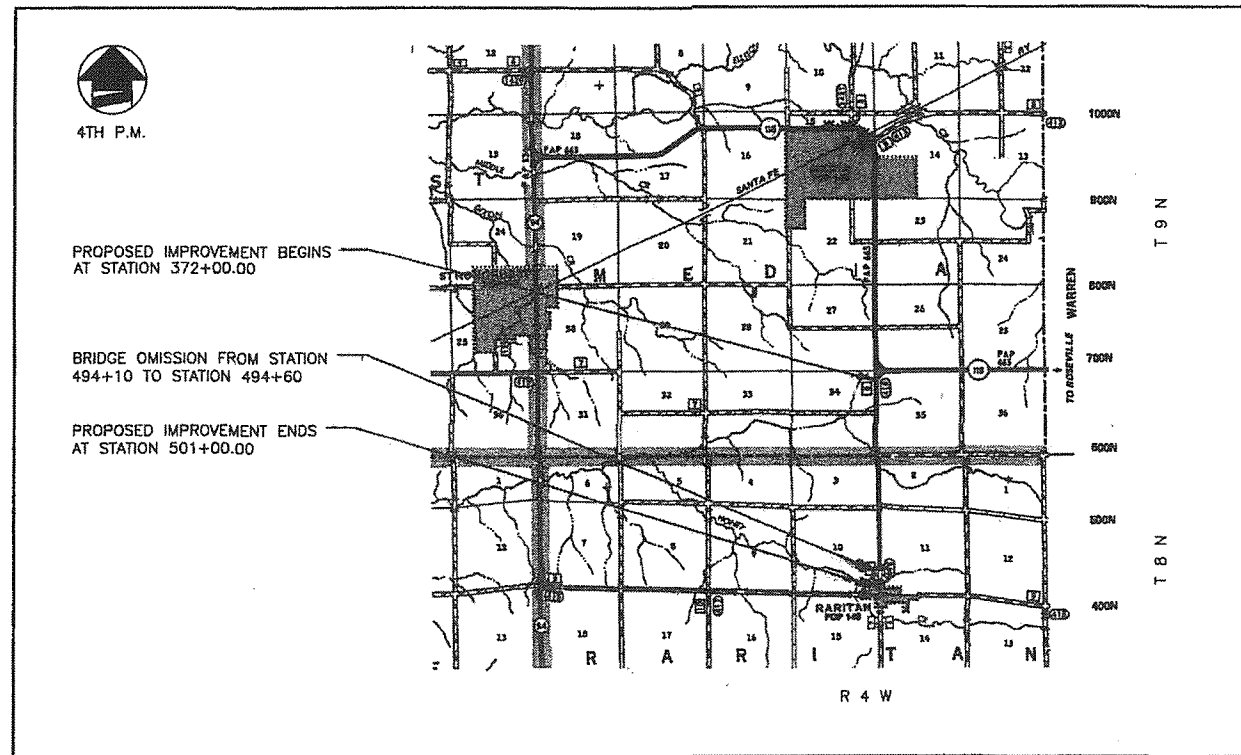

### LOCATION MAP

APPROXIMATE SCALE:

TOTAL LENGTH OF PROJECT: 12,900.0 FT = 2.443 MI.  
NET LENGTH OF PROJECT: 12,840.0 FT = 2.432 MI.  
ROADWAY CLASSIFICATION: MAJOR COLLECTOR (ADT = 450)  
DESIGN GUIDELINES: RURAL  
DESIGN SPEED = 55 M.P.H.  
COMMITMENTS: NONE



*Robert T. Hickman* 3/12/21  
ROBERT T. HICKMAN DATE  
P.E. No. 062-051211  
EXPIRES NOVEMBER 30, 2021

PLANS PREPARED BY THE  
HENDERSON COUNTY HIGHWAY DEPARTMENT  
STRONGHURST, ILLINOIS

APPROVED *Robert T. Hickman* 20 21  
ROBERT T. HICKMAN  
HENDERSON COUNTY ENGINEER

PASSED *03-29* 20 21  
DISTRICT 4 ENGINEER OF LOCAL ROADS & STREETS  
RELEASING FOR BID  
BASED ON LIMITED REVIEW *March 29* 20 21  
REGION 3 ENGINEER  
STATE OF ILLINOIS  
DEPARTMENT OF TRANSPORTATION

PRINTED BY THE AUTHORITY  
OF THE STATE OF ILLINOIS

CALL JULIE TOLL FREE  
1-(800)-892-0123 or 811  
OPERATES 24 HOURS A  
DAY 365 DAYS A YEAR



48 HOURS BEFORE  
YOU DIG

DIVISION OF HIGHWAYS  
Dept. of Transportation

MAR 18 2021  
Region 3/District 4  
RECEIVED  
Local Roads

CONTRACT NO. 89808  
CATALOG NO. 032754-01D

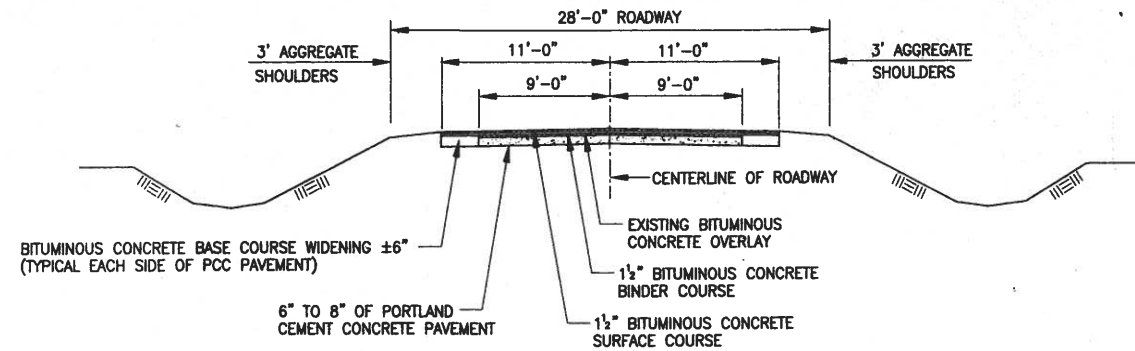

**TYPICAL SECTION THROUGH THE EXISTING ROADWAY**  
 FROM STA 372+00.00 TO STA 494+10.00 AND FROM STA 494+70.00 TO STA 501+00.00

NO SCALE

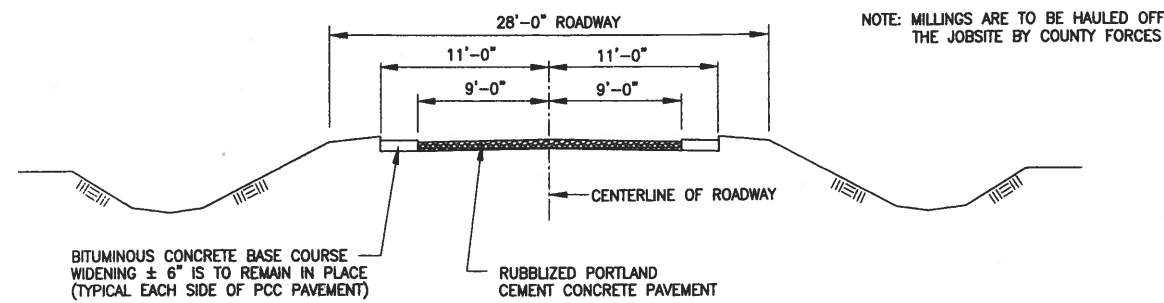

**TYPICAL SECTION THROUGH THE ROADWAY FOLLOWING CONSTRUCTION PHASE 1**  
 FROM STA 372+00.00 TO STA 494+10.00 AND FROM STA 494+70.00 TO STA 501+00.00

NO SCALE

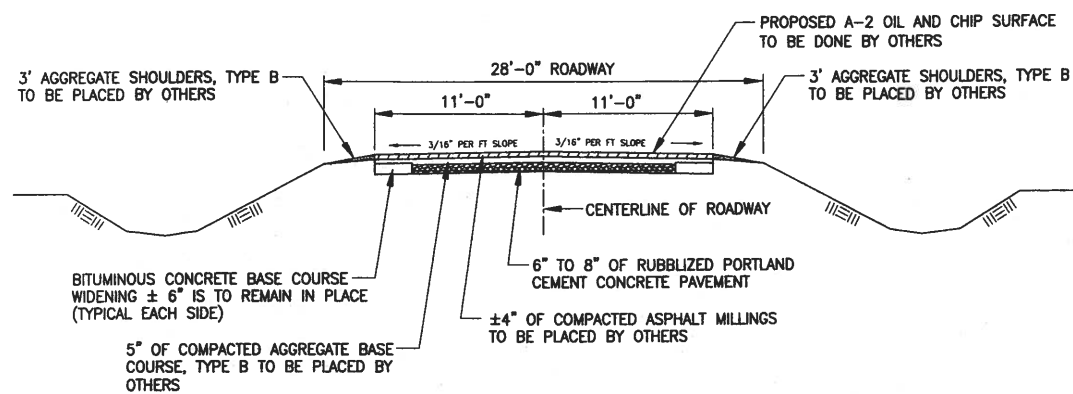

**TYPICAL SECTION THROUGH THE ROADWAY FOLLOWING CONSTRUCTION PHASE 2**  
 FROM STA 372+00.00 TO STA 494+10.00 AND FROM STA 494+70.00 TO STA 501+00.00

NO SCALE

- NOTE: PHASE 2 WORK WILL FOLLOW THE COMPLETION OF THIS CONTRACT AND WILL BE COMPLETED USING COUNTY FORCES.
- NOTE: THE FOLLOWING IS THE SEQUENCE OF OPERATIONS TO COMPLETED UNDER PHASE 2 CONSTRUCTION USING COUNTY FORCES:
1. AGGREGATE BASE COURSE, TYPE B TO BE PLACED AND COMPACTED
  2. BITUMINOUS MILLINGS TO BE PLACED AND COMPACTED
  3. AGGREGATE SHOULDERS TO BE PLACED AND COMPACTED
  4. A-2 OIL AND CHIP SURFACE IS TO BE APPLIED

**GENERAL NOTES**

1. WHERE SECTION OR SUBSECTION MONUMENTS ARE ENCOUNTERED, THE ENGINEER SHALL BE NOTIFIED BEFORE SUCH MONUMENTS ARE REMOVED. THE CONTRACTOR SHALL CAREFULLY PROTECT AND PRESERVE ALL PROPERTY MARKERS AND MONUMENTS UNTIL THE OWNER, AN AUTHORIZED SURVEYOR, OR AGENT HAS WITNESSED OR OTHERWISE REFERENCED THEIR LOCATION.
2. ALL TRAFFIC CONTROL REQUIRED TO CARRY OUT EACH PHASE OF CONSTRUCTION SHALL BE DONE BY OTHERS IN ACCORDANCE WITH THE STANDARD SPECIFICATIONS FOR ROAD AND CONSTRUCTION, ALONG WITH ANY APPLICABLE SPECIAL PROVISIONS AND HIGHWAY STANDARDS INCLUDED IN THE PLANS.
3. THE CONTRACTOR SHALL BE RESPONSIBLE FOR DETERMINING THE LOCATION AND ELEVATION OF ALL EXISTING UTILITIES AND TO NOTIFY ALL UTILITY COMPANIES PRIOR TO THE BEGINNING OF CONSTRUCTION. THIS SHALL BE INCIDENTAL TO THE CONTRACT.
4. THE CONTRACTOR SHALL BE RESPONSIBLE FOR SAWCUTTING BUTT JOINTS IN THE EXISTING HOT MIX ASPHALT PAVEMENT AT EACH END OF THE PROJECT LIMITS, AS WELL AS AT EACH END OF THE BRIDGE OMISSION PRIOR TO THE START OF REMOVING THE EXISTING HOT MIX ASPHALT SURFACE, AS DIRECTED BY THE ENGINEER. THIS WILL NOT BE PAID FOR SEPERATELY BUT IS TO BE CONSIDERED INCIDENTAL TO THE COST PER SQUARE YARD FOR HOT MIX ASPHALT SURFACE REMOVAL (VARIABLE DEPTH).
5. THE HOT MIX ASPHALT SURFACE SHALL BE REMOVED TO THE DEPTH OF THE EXISTING PCC PAVEMENT.
6. THE PCC PAVEMENT SHALL BE RUBBLIZED USING A RESONANT BREAKER ACCORDING TO METHOD 1, AS DESCRIBED IN THE SPECIAL PROVISIONS.
7. THE PCC PAVEMENT HAS PREVIOUSLY BEEN REMOVED FROM STATION 431+70 TO STATION 432+00 FOR A PRIOR CULVERT REPLACEMENT PROJECT. THIS HAS BEEN SHOWN AS AN OMISSION IN THE RUBBLIZE PORTLAND CEMENT CONCRETE PAVEMENT QUANTITY AS SHOWN IN THE QUANTITY BREAKDOWN.
8. THE OPERATIONS OF THIS PROJECT ARE TO GO STRAIGHT THROUGH ANY SIDE ROADS AND IS NOT TO INCLUDE ANY WORK ON THE RADIUS AREAS OF ANY SIDE ROAD INTERSECTIONS.
9. THE BEGINNING OF THE PROJECT WILL START AT THE SOUTH RIGHT OF WAY LINE OF ILLINOIS ROUTE 116 AND THE END OF THE PROJECT WILL STOP AT THE NORTH RIGHT OF WAY LINE OF COUNTY HIGHWAY 9. THE EXACT TERMINI LOCATIONS WILL BE MARKED BY THE ENGINEER PRIOR TO THE START OF THE PROJECT.

**QUANTITIES NOT OTHERWISE SHOWN ON THE PLANS**

X4401198: HOT MIX ASPHALT SURFACE REMOVAL (VARIABLE DEPTH)	
(USE AVERAGE WIDTH OF 22')	
STATION 372+00.00 TO STATION 494+10.00	= 29,846.6 SQ YDS
STATION 494+70.00 TO STATION 501+00.00	= 1,540.0 SQ YDS
<b>TOTAL</b>	<b>= 31,386.6 SQ YDS</b>
Z0055605: RUBBLIZE PORTLAND CEMENT CONCRETE PAVEMENT	
(USE AVERAGE WIDTH OF 18')	
STATION 372+00.00 TO STATION 494+10.00	= 24,420.0 SQ YDS
BRIDGE OMISSION STA 494+10.00 TO STA 494+70.00	= 1,260.0 SQ YDS
STATION 494+70.00 TO STATION 501+00.00	= 1,260.0 SQ YDS
(LESS) CULVERT OMISSION STA 431+70 TO STA 432+00	= (60.0 SQ YDS)
<b>TOTAL</b>	<b>= 25,620.0 SQ YDS</b>

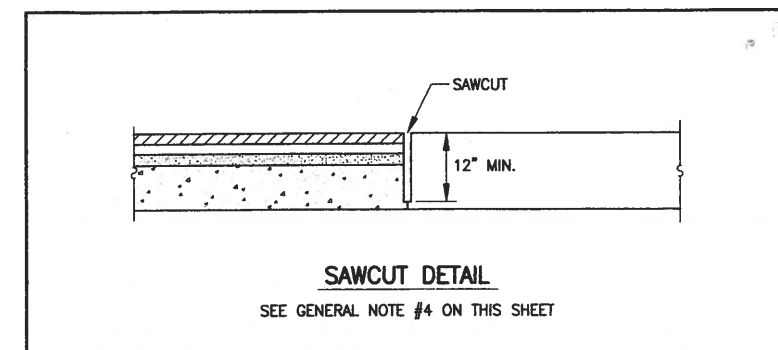

**SAWCUT DETAIL**  
 SEE GENERAL NOTE #4 ON THIS SHEET