



06-11-2021 LETTING ITEM 146

STATE OF ILLINOIS
DEPARTMENT OF TRANSPORTATION
PLANS FOR PROPOSED

SURFACE TRANSPORTATION PROGRAM

FAS ROUTE 903 (JOHNSTON CITY ROAD)
SECTION 19-00160-00-RS
PROJECT NO. 3YMB(352)
JOB NO. C-99-064-19

ROUTE	SECTION	COUNTY	TOTAL SHEETS	SHEET NO.
FAS 903	19-00160-00-RS	SALINE	14	1
PROJECT NO. 3YMB(352)			CONTRACT NO. 99661	

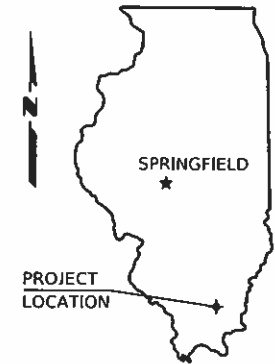

INDEX OF SHEETS

1. COVER SHEET
 2. SUMMARY OF QUANTITIES & GENERAL NOTES
 3. TYPICAL SECTIONS
 4. QUANTITY SCHEDULES
 5. TAPER DETAILS
 6. TYPICAL MAILBOX TURNOUT & RUMBLE STRIP DETAIL
 7. TYPICAL ENTRANCE & SIDE ROAD DETAILS
 - 8.-14. PLAN & PROFILE
- STANDARDS
- | | |
|-----------|---------------------------------------|
| 630001-12 | STEEL PLATE BEAM GUARDRAIL |
| 701001-02 | TRAFFIC CONTROL |
| 701006-05 | TRAFFIC CONTROL |
| 701011-04 | TRAFFIC CONTROL |
| 701201-05 | TRAFFIC CONTROL |
| 701301-04 | TRAFFIC CONTROL |
| 701306-04 | TRAFFIC CONTROL |
| 701311-03 | TRAFFIC CONTROL |
| 701326-04 | TRAFFIC CONTROL |
| 701336-07 | TRAFFIC CONTROL |
| 701901-08 | TRAFFIC CONTROL DEVICES |
| 780001-05 | TYPICAL PAVEMENT MARKINGS |
| 781001-04 | RAISED REFLECTIVE PAVEMENT MARKERS |
| BLR 21-9 | TYP APPLICATION OF TRAF CONTR DEVICES |
| BLR 24-2 | MAILBOX TURNOUTS FOR LOCAL ROADS |

SALINE COUNTY

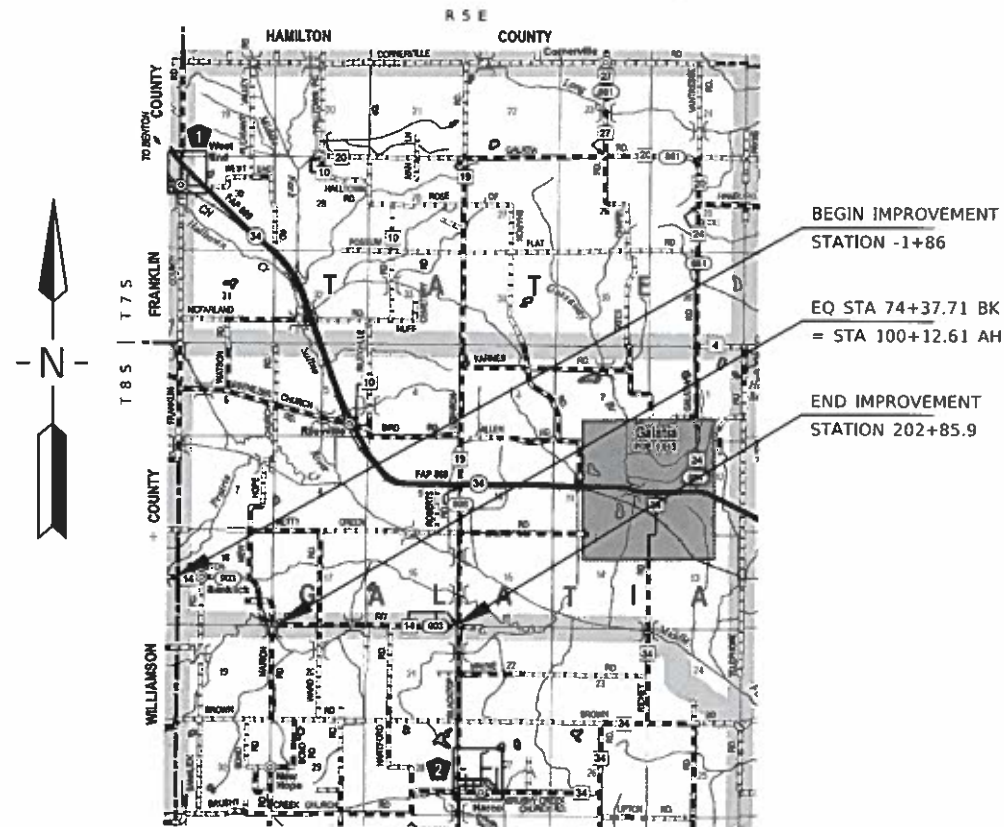

(Previously constructed as Section 94-00118-00-R5)

CLASSIFICATION : MAJOR COLLECTOR
ADT : 650
DESIGN SPEED : 50 MPH

CONTRACT NO. 99661



Kevin Phillips
Kevin Phillips
PROFESSIONAL ENGINEER
#062-047293
EXPIRES NOV. 30, 2021

Round Table Design, Inc.
PROFESSIONAL ENGINEERING - LAND SURVEYING
1457 HIGHWAY 145 S HARRISBURG, IL (618) 253-6017

ILLINOIS DEPARTMENT OF TRANSPORTATION	
Approved	<u>12/23/2020</u> <i>Larry Phillips</i> Saline County Engineer
Passed	<u>3-3-21</u> <i>Daryl Mullins</i> District 8 Engineer of Local Roads and Streets
Releasing for Bid Based on Limited Review	<u>3-3-21</u> <i>Keith Roberts</i> OH Keith Roberts, P.E. Acting Region Five Engineer

ROUTE	SECTION	COUNTY	TOTAL SHEETS	SHEET NO.
FAS 903	19-00160-00-RS	SALINE	14	2
PROJECT NO. 3YMB(352)			CONTRACT NO. 99661	

SUMMARY OF QUANTITIES

<u>CODE NO.</u>	<u>PAY ITEM</u>	<u>UNIT</u>	<u>TOTAL</u>
* Z0033700	LONGITUDINAL JOINT SEALANT	FOOT	17,897
* Z0055300	RUMBLE STRIP	EACH	3
* X1200207	REMOVE AND RELAY PIPE CULVERTS (SPECIAL)	FOOT	36
* X7010216	TRAFFIC CONTROL AND PROTECTION, (SPECIAL)	L SUM	1
40600290	BITUMINOUS MATERIALS (TACK COAT)	POUND	31,690
40600982	HOT-MIX ASPHALT SURFACE REMOVAL - BUTT JOINT	SQ YD	350
40600990	TEMPORARY RAMP	SQ YD	70
* 40602985	HOT-MIX ASPHALT BINDER COURSE, IL-9.5, N70	TON	4,080
* 40604052	HOT-MIX ASPHALT SURFACE COURSE, IL-9.5, MIX "C", N70	TON	3,900
44000155	HOT-MIX ASPHALT SURFACE REMOVAL, 1 1/2"	SQ YD	338
44000156	HOT-MIX ASPHALT SURFACE REMOVAL, 1 3/4"	SQ YD	2,662
48102100	AGGREGATE WEDGE SHOULDER, TYPE B	TON	1,430
* 48203009	HOT-MIX ASPHALT SHOULDERS, 3"	SQ YD	1,774
* 48203100	HOT-MIX ASPHALT SHOULDERS	TON	300
58100200	WATERPROOFING MEMBRANE SYSTEM	SQ YD	338
Δ * 63301210	REMOVE AND REERECT STEEL PLATE BEAM GUARDRAIL, TYPE A	FOOT	75
67100100	MOBILIZATION	L SUM	1
70300100	SHORT TERM PAVEMENT MARKING	FOOT	1,788
70300220	TEMPORARY PAVEMENT MARKING - LINE 4"	FOOT	51,710
Δ78000650	THERMOPLASTIC PAVEMENT MARKING - LINE 24"	FOOT	34
Δ78001110	PAINT PAVEMENT MARKING - LINE 4"	FOOT	51,710
Δ78100100	RAISED REFLECTIVE PAVEMENT MARKER	EACH	224

* SEE SPECIAL PROVISIONS
Δ SPECIALTY ITEMS

GENERAL NOTES

Any mention of "prime" in these plans shall be construed to mean either Bituminous Materials (Prime Coat) or Bituminous Materials (Tack Coat) in accordance with Section 406 of the Standard Specifications for Road and Bridge Construction.

Bituminous Materials Prime/Tack Coat shall be applied to the full width of the existing surface or aggregate base at the rates shown below.

The location of underground utilities shown on the plans is an approximation and is included for information only.

Factors used for quantity calculations are as follows:

Hot-Mix Asphalt 112.0 Lbs/Sq Yd/Inch
Aggregate/Riprap 2.025 Tons/Cu Yd
Bit Materials (Prime Coat),
on Agg Base 0.25 Lbs/Sq Ft
Bit Materials (Tack Coat),
on HMA Base 0.05 Lbs/Sq Ft
on HMA Lift 0.025 Lbs/Sq Ft

SUMMARY OF QUANTITIES
& GENERAL NOTES
FAS 903 (JOHNSTON CITY ROAD)
SECTION 19-00160-00-RS
PROJECT 3YMB(352)
SALINE COUNTY

ROUTE	SECTION	COUNTY	TOTAL SHEETS	SHEET NO.
FAS 903	19-00160-00-RS	SALINE	14	3
PROJECT NO. 3YMB(352)			CONTRACT NO. 99661	

NOTE: Longitudinal Joint Sealant shall be used under the Hot-Mix Asphalt Surface Course.

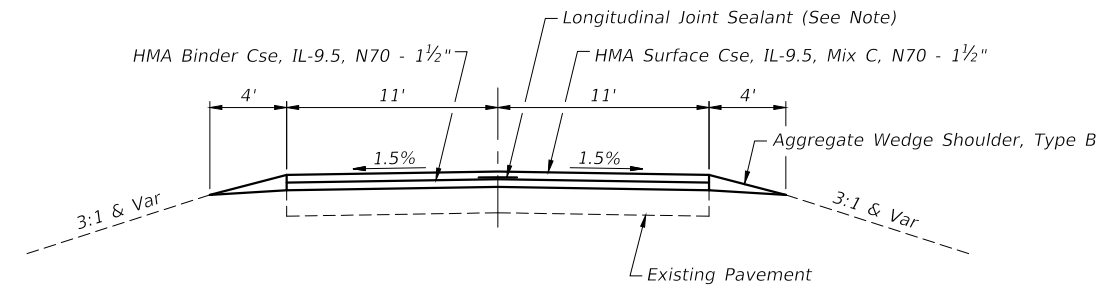

TYPICAL SECTION
Sta -1+86 to Sta 23+30
Sta 24+70 to Sta 35+95
Sta 101+60 to Sta 202+85.9

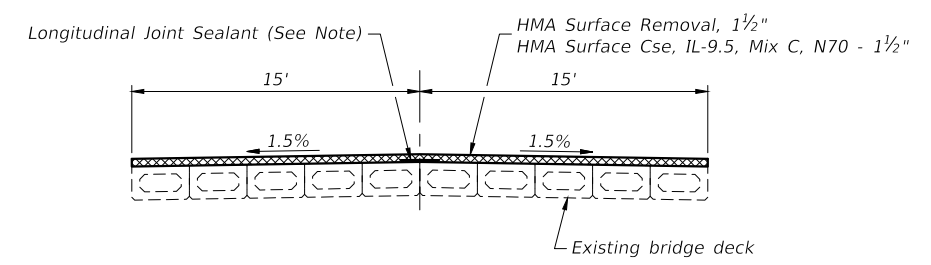

TYPICAL BRIDGE SECTION
STA 143+92.0 - STA 144+93.4

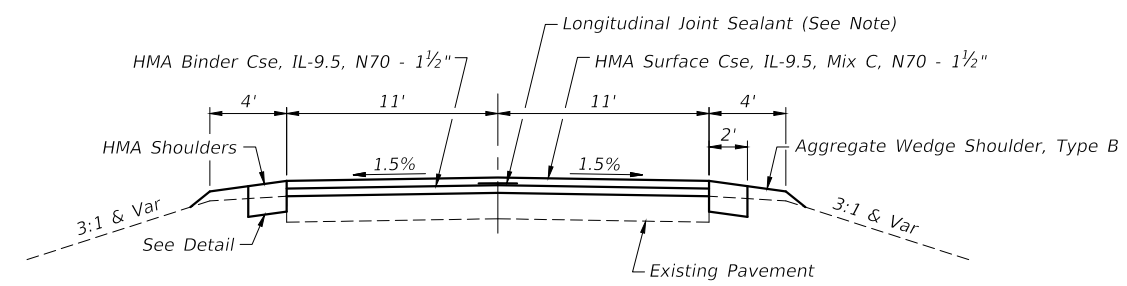

TYPICAL SECTION
Sta 35+95 to Sta 38+79
Sta 41+06 to Sta 48+94
Sta 60+40 to Sta 101+60

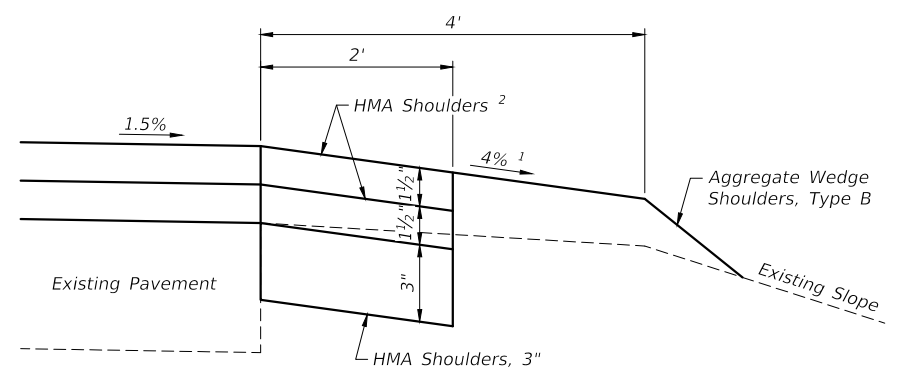

TYPICAL HMA SHOULDER DETAIL
STA 35+95 - STA 101+60

- Shoulder slope shall be adjusted at horizontal curves so that the difference between pavement and shoulder slopes does not exceed 0.10 Ft/Ft.
- Top 3" of HMA Shoulders to be placed as HMA Binder Course and HMA Surface Course in conjunction with pavement overlay.

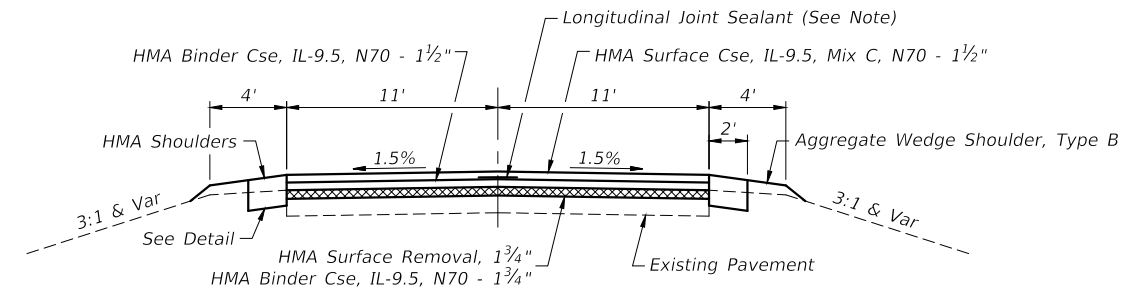

TYPICAL SECTION
STA 53+75 - STA 60+40

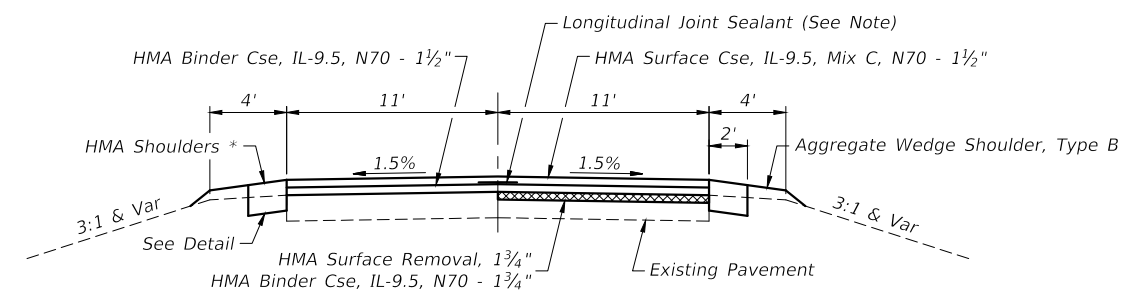

TYPICAL SECTION
Sta 23+30 to Sta 24+70*
Sta 38+79 to Sta 41+06
Sta 48+94 to Sta 53+75

* Omit HMA Shoulder
Sta 23+30 to Sta 24+70.

STRUCTURAL DESIGN DATA

Class III Roadway
Design Period - 20 Years

PC	555	IBV	3.6
SU	45	TF	0.1239
MU	30	DT	2.876

Material Coefficient

Existing Aggregate Base	- 0.08
Existing Oil & Chip	- 0.15
Existing Surface	- 0.30
HMA Binder Course	- 0.33
HMA Surface Course	- 0.40

TYPICAL SECTIONS

FAS 903 (JOHNSTON CITY ROAD)
SECTION 19-00160-00-RS
PROJECT 3YMB(352)
SALINE COUNTY

ROUTE	SECTION	COUNTY	TOTAL SHEETS	SHEET NO.
FAS 903	19-00160-00-RS	SALINE	14	4
PROJECT NO. 3YMB(352)			CONTRACT NO. 99661	

REMOVE & RELAY PIPE CULVERTS (SP)	
Location	Foot
Sta 124+33 Lt	4
Sta 150+04 Lt	12
Sta 150+04 Rt	4
Sta 160+02 Rt	16
Total	36

HMA SURFACE REMOVAL - BUTT JT	
Location	Sq Yds
Sta -1+86 to Sta -1+61	61
Sta 202+61 to Sta 202+85.9	195
Total	256

SCHEDULE OF PAVEMENT MARKING LINE 4" (LIN. FT.)			
Location	Centerline (Yellow Dashed)	Edge Line (White Solid)	No Passing (Yellow Solid)
Sta -3+56 to Sta 202+85	3,400	35,234	13,076

See Standard 780001 for typical pavement markings.

SCHEDULE OF "NO PASSING ZONES"			
WESTBOUND (LEFT) LANE		EASTBOUND (RIGHT) LANE	
Location	Length	Location	Length
Sta. -3+56 to Sta. 3+56	712'		
Sta. 9+75 to Sta. 17+33	758'	Sta. 2+05 to Sta. 8+75	670'
Sta. 32+35 to Sta. 105+96	4,786'	Sta. 25+40 to Sta. 77+30	4,830'
Sta. 187+40 to Sta. 192+50	510'	Sta. 177+35 to Sta. 185+45	810'
TOTALS	6,766'		6,310'

REMOVE & RE-ERECT STEEL PLATE BEAM GUARDRAIL, TYPE A	
Location	Foot
Sta 143+41.4 to Sta 143+78.9 Rt	37.5
Sta 145+06.6 to Sta 145+44.1 Rt	37.5
Total	75

HMA SURFACE REMOVAL, 1½"	
Location	Sq Yds
Sta 143+92.0 to Sta 144+93.4 (Full width of bridge)	338
Total	338

HOT-MIX ASPHALT SHOULDERS, 3"	
Location	Sq Yds
Sta 35+95 to Sta 100+60 Lt	887
Sta 35+95 to Sta 100+60 Rt	887
Total	1,774

TEMPORARY RAMPS	
Location	Sq Yds
Sta -1+86 to Sta -1+81.8	10
Sta 202+81.7 to Sta 202+85.9	50
Total	60

HMA SURFACE REMOVAL, 1¾"	
Location	Sq Yds
Sta 23+30 to Sta 24+70 Eastbound (Rt) lane only	171
Sta 38+79 to Sta 41+06 Eastbound (Rt) lane only	277
Sta 48+94 to Sta 53+75 Eastbound (Rt) lane only	588
Sta 53+75 to Sta 60+40 Both lanes	1,626
Total	2,662

HOT-MIX ASPHALT SHOULDERS	
Location	Tons
Sta 35+95 to Sta 100+60 Lt	150
Sta 35+95 to Sta 100+60 Rt	150
Total	300

QUANTITY SCHEDULES

FAS 903 (JOHNSTON CITY ROAD)
SECTION 19-00160-00-RS
PROJECT 3YMB(352)
SALINE COUNTY

ROUTE	SECTION	COUNTY	TOTAL SHEETS	SHEET NO.
FAS 903	19-00160-00-RS	SALINE	14	5
PROJECT NO. 3YMB(352)			CONTRACT NO. 99661	

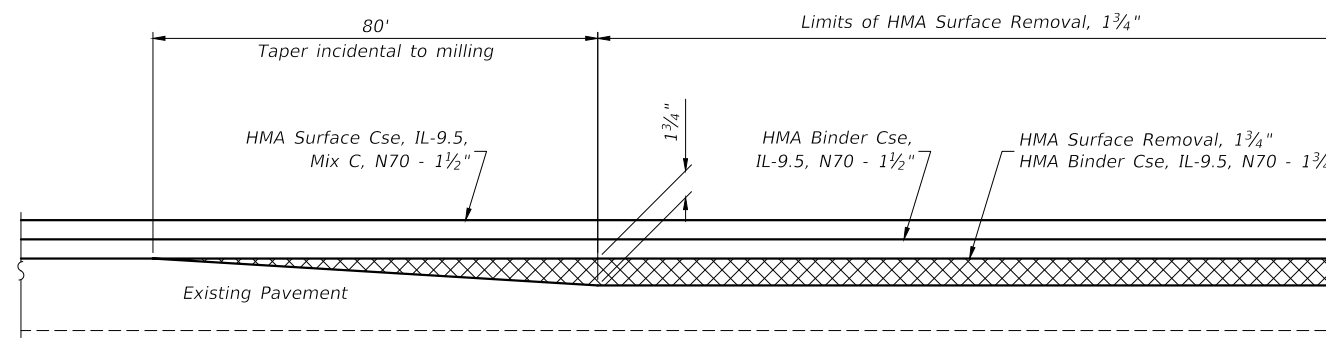
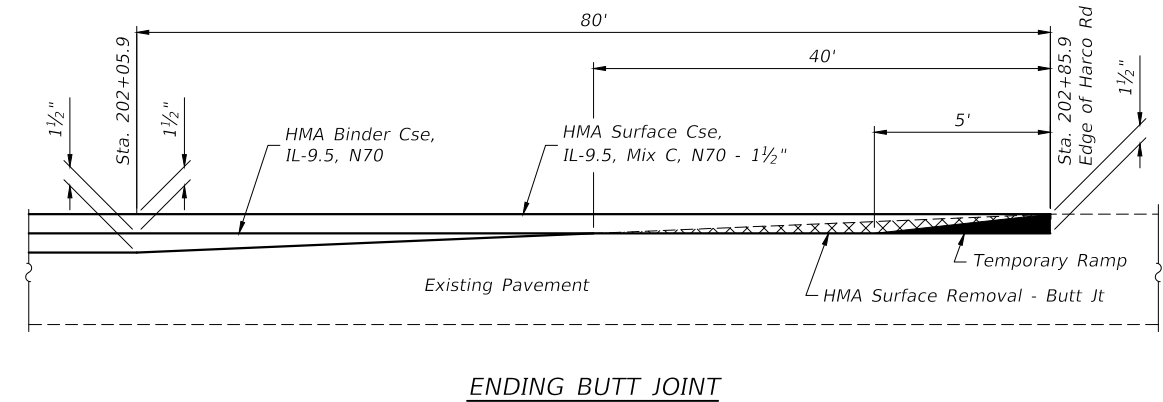
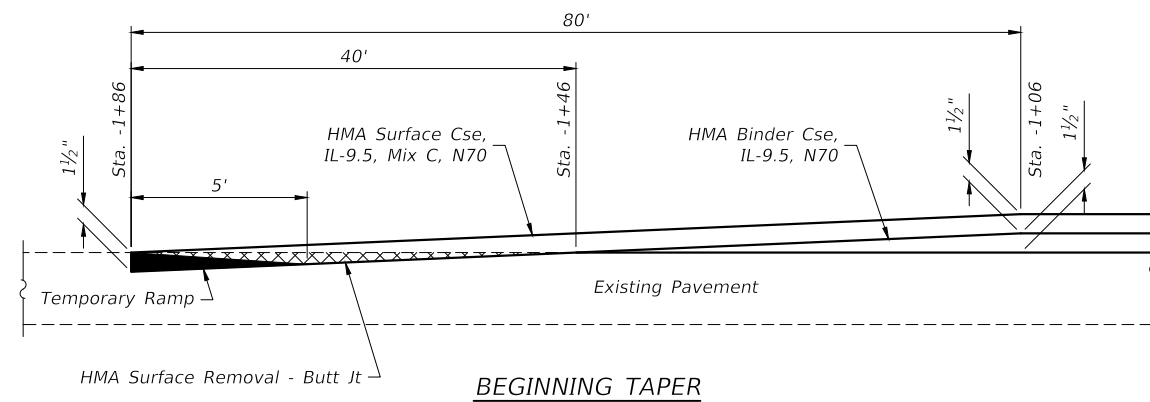

TAPER FOR MILLING
See Schedule on Sheet 4 for locations.

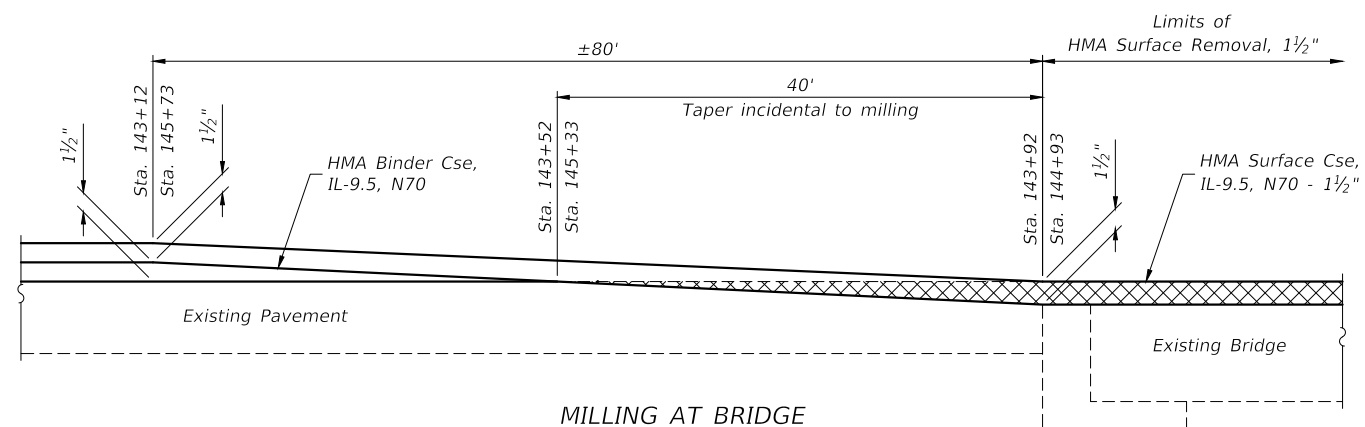

TAPER DETAILS

FAS 903 (JOHNSTON CITY ROAD)
SECTION 19-00160-00-RS
PROJECT 3YMB(352)
SALINE COUNTY

ROUTE	SECTION	COUNTY	TOTAL SHEETS	SHEET NO.
FAS 903	19-00160-00-RS	SALINE	14	6
PROJECT NO. 3YMB(352)			CONTRACT NO. 99661	

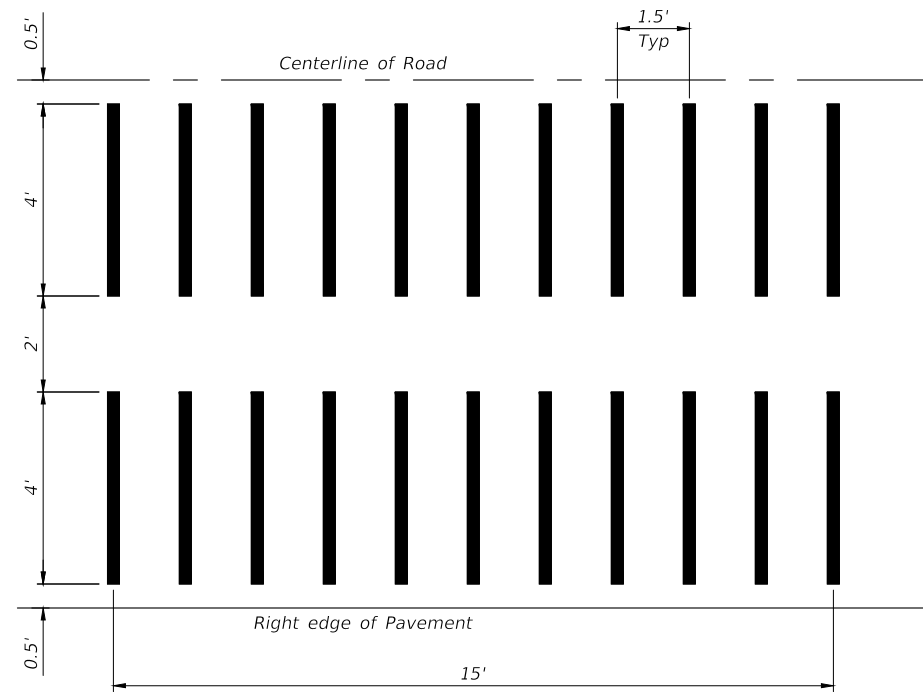

PLAN

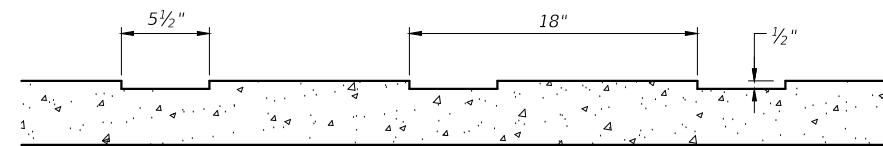

ELEVATION

RUMBLE STRIP DETAIL

Locations

Station 199+75
 Station 196+75
 Station 193+75

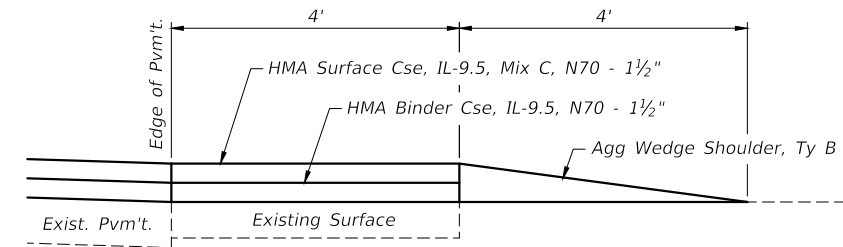

TYPICAL MAILBOX TURNOUT

(See Standard BLR 24 for more details)

SCHEDULE OF MAILBOX TURNOUTS
Location
Sta 3+30 Rt
Sta 9+25 Rt
Sta 10+00 Rt
Sta 55+90 Lt
Sta 114+95 Rt
Sta 131+50 Rt
Sta 146+90 Rt
Sta 151+10 Rt
Sta 159+25 Rt
Sta 162+60 Rt
Sta 165+70 Rt
Sta 171+55 Rt
Sta 179+75 Rt
Sta 183+95 Rt
Sta 187+65 Rt
Sta 188+00 Rt
Sta 191+80 Rt
Sta 201+00 Rt

TYPICAL MAILBOX TURNOUT
 & RUMBLE STRIP DETAIL
 FAS 903 (JOHNSTON CITY ROAD)
 SECTION 19-00160-00-RS
 PROJECT 3YMB(352)
 SALINE COUNTY

ROUTE	SECTION	COUNTY	TOTAL SHEETS	SHEET NO.
FAS 903	19-00160-00-RS	SALINE	14	7
PROJECT NO. 3YMB(352)			CONTRACT NO. 99661	

SCHEDULE OF PRIVATE ENTRANCES

Location	Width	Binder Tons	Surface Tons
Sta 3+41 Rt	12'	0.3	0.8
Sta 5+35 Rt	10'	0.2	0.7
Sta 6+55 Rt	38'	0.6	1.7
Sta 8+43 Rt	16'	0.3	0.9
Sta 9+11 Rt	14'	0.3	0.9
Sta 10+02 Lt	24'	0.4	1.2
Sta 14+35 Lt	20'	0.3	1.1
Sta 15+92 Lt	14'	0.3	0.9
Sta 21+39 Rt	10'	0.2	0.7
Sta 54+78 Rt	18'	0.3	1.0
Sta 100+87 Rt	24'	0.4	1.2
Sta 113+22 Lt	12'	0.3	0.8
Sta 113+70 Rt	12'	0.3	0.8
Sta 113+97 Lt	12'	0.3	0.8
Sta 126+53 Lt	10'	0.2	0.7
Sta 131+56 Lt	10'	0.2	0.7
Sta 146+56 Rt	24'	0.4	1.2
Sta 150+79 Lt	24'	0.4	1.2
Sta 150+93 Rt	12'	0.3	0.8
Sta 151+97 Lt	12'	0.3	0.8
Sta 157+74 Lt	10'	0.2	0.7
Sta 159+21 Lt	12'	0.3	0.8
Sta 162+43 Rt	12'	0.3	0.8
Sta 165+69 Lt	16'	0.3	0.9
Sta 171+55 Lt	16'	0.3	0.9
Sta 177+01 Lt	16'	0.3	0.9
Sta 179+73 Lt	14'	0.3	0.9
Sta 183+74 Rt	22'	0.4	1.1
Sta 185+46 Lt	20'	0.3	1.1
Sta 187+47 Rt	24'	0.4	1.2
Sta 188+29 Rt	12'	0.3	0.8
Sta 188+39 Lt	24'	0.4	1.2
Sta 189+77 Lt	20'	0.3	1.1
Sta 199+01 Rt	12'	0.3	0.8
Sta 191+90 Lt	12'	0.3	0.8
Sta 200+76 Rt	16'	0.3	0.9
Totals		11.3	33.8

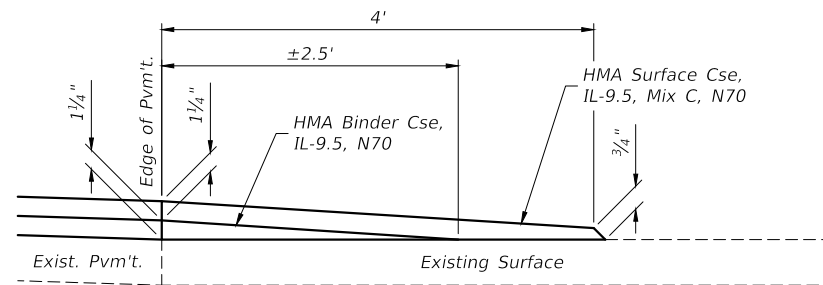

SECTION A-A PRIVATE ENTRANCE

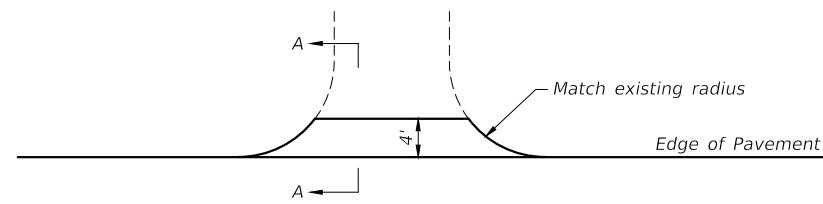

PLAN

NOTE: Where HMA material is to be placed, the existing surface shall be primed as elsewhere specified.

TYPICAL ENTRANCE DETAILS

SCHEDULE OF SIDE ROADS

Location	Width	Binder Tons	Surface Tons
Sta 13+77 Rt	20'	1.4	3.9
Sta 40+66 Lt	20'	1.4	3.9
Sta 55+57 Rt	20'	1.4	3.9
Sta 71+14 Lt	22'	1.5	4.1
Sta 71+14 Rt	20'	1.4	3.9
Sta 124+02 Lt	18'	1.4	3.7
Sta 124+02 Rt	16'	1.3	3.6
Sta 163+95 Rt	20'	1.4	3.9
Totals		11.2	30.9

NOTE: Where HMA material is to be placed, the existing surface shall be primed as elsewhere specified.

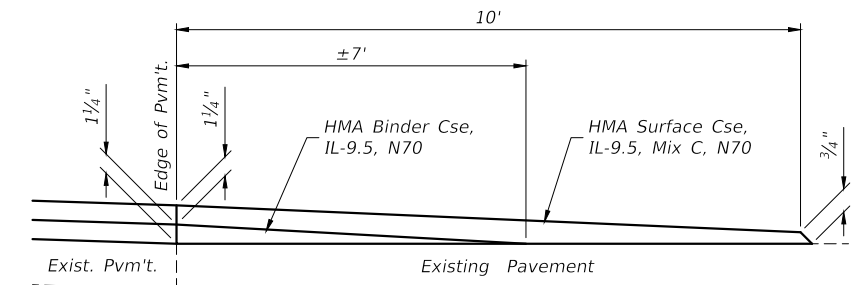

SECTION A-A SIDE ROAD

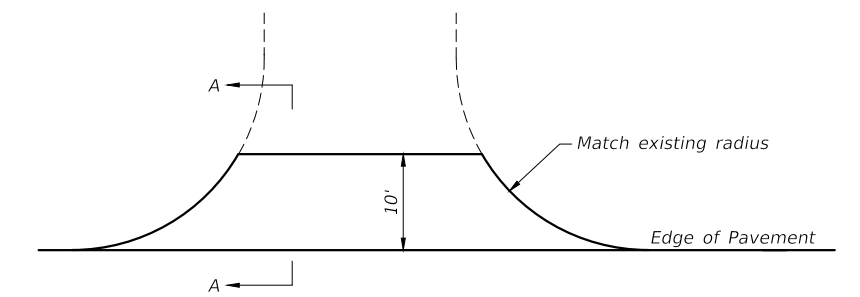

PLAN

TYPICAL SIDE ROAD DETAILS

TYPICAL ENTRANCE &
SIDE ROAD DETAILS
FAS 903 (JOHNSTON CITY ROAD)
SECTION 19-00160-00-RS
PROJECT 3YMB(352)
SALINE COUNTY

CURVE DATA - PI STA=9+22.40
 N=422691.372 E=877255.528
 $\Delta=2^{\circ}46'01''$ T=277.73'
 $D=0^{\circ}29'54''$ L=555.35'
 R=11500.00' E=3.35'
 S.E. = Normal Crown

ROUTE	SECTION	COUNTY	TOTAL SHEETS	SHEET NO.
FAS 903	19-00160-00-RS	SALINE	14	8
PROJECT NO. 3YMB(352)			CONTRACT NO. 99661	

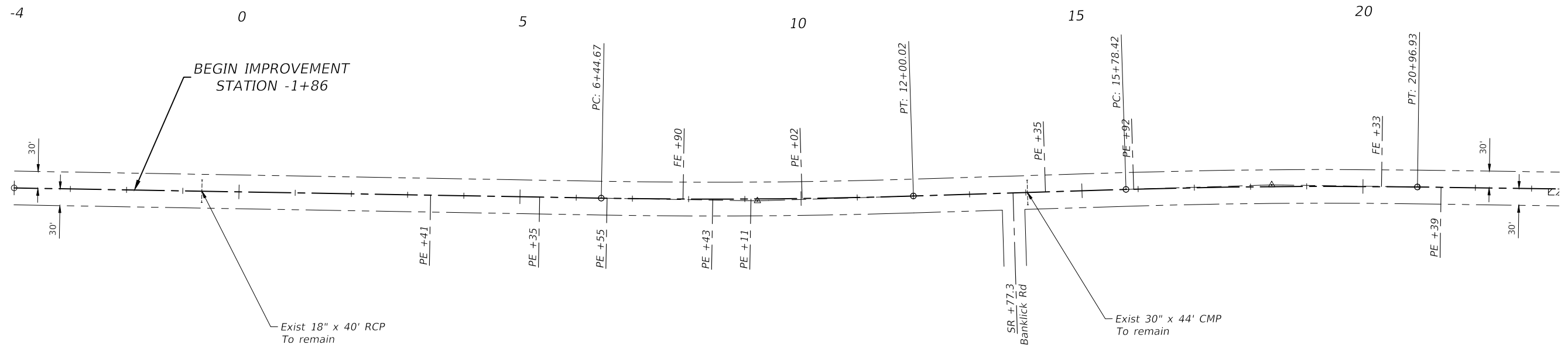

CURVE DATA - PI STA=18+37.72
 N=422717.593 E=878170.583
 $\Delta=2^{\circ}35'00''$ T=259.30'
 $D=0^{\circ}29'54''$ L=518.51'
 R=11500.00' E=2.92'
 S.E. = Normal Crown

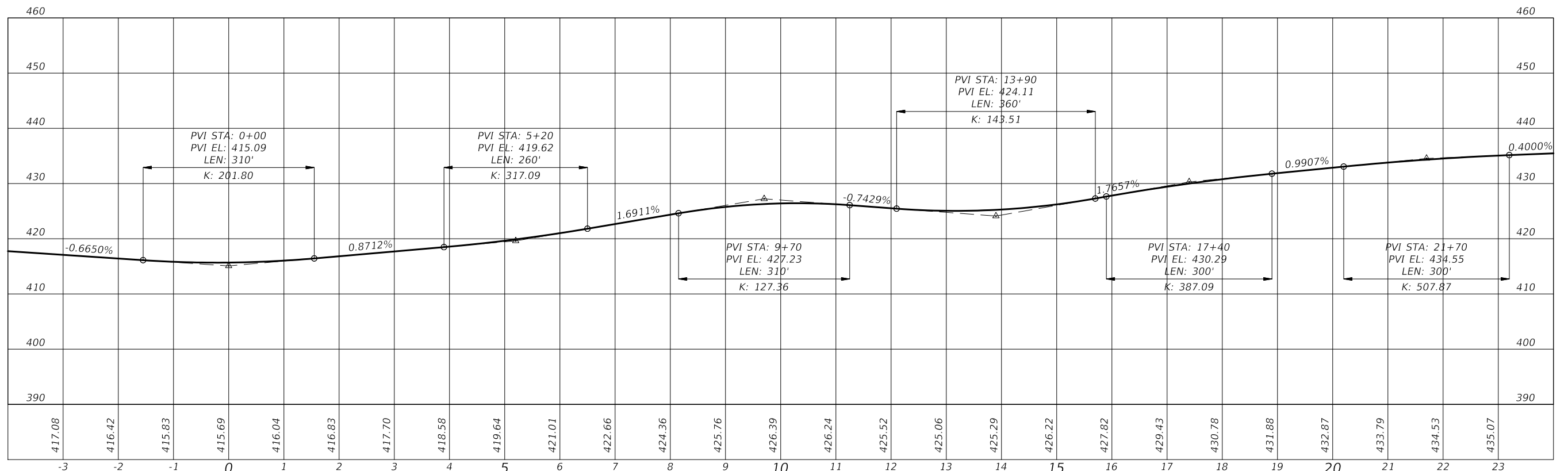

ROUTE	SECTION	COUNTY	TOTAL SHEETS	SHEET NO.
FAS 903	19-00160-00-RS	SALINE	14	9
PROJECT NO. 3YMB(352)			CONTRACT NO. 99661	

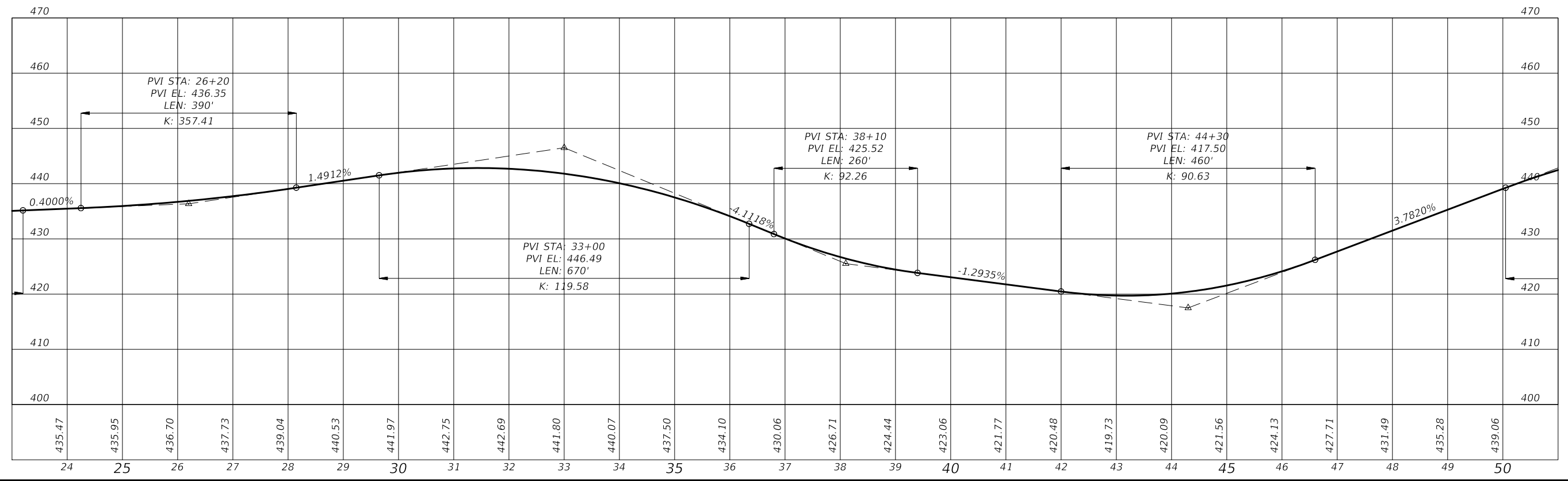
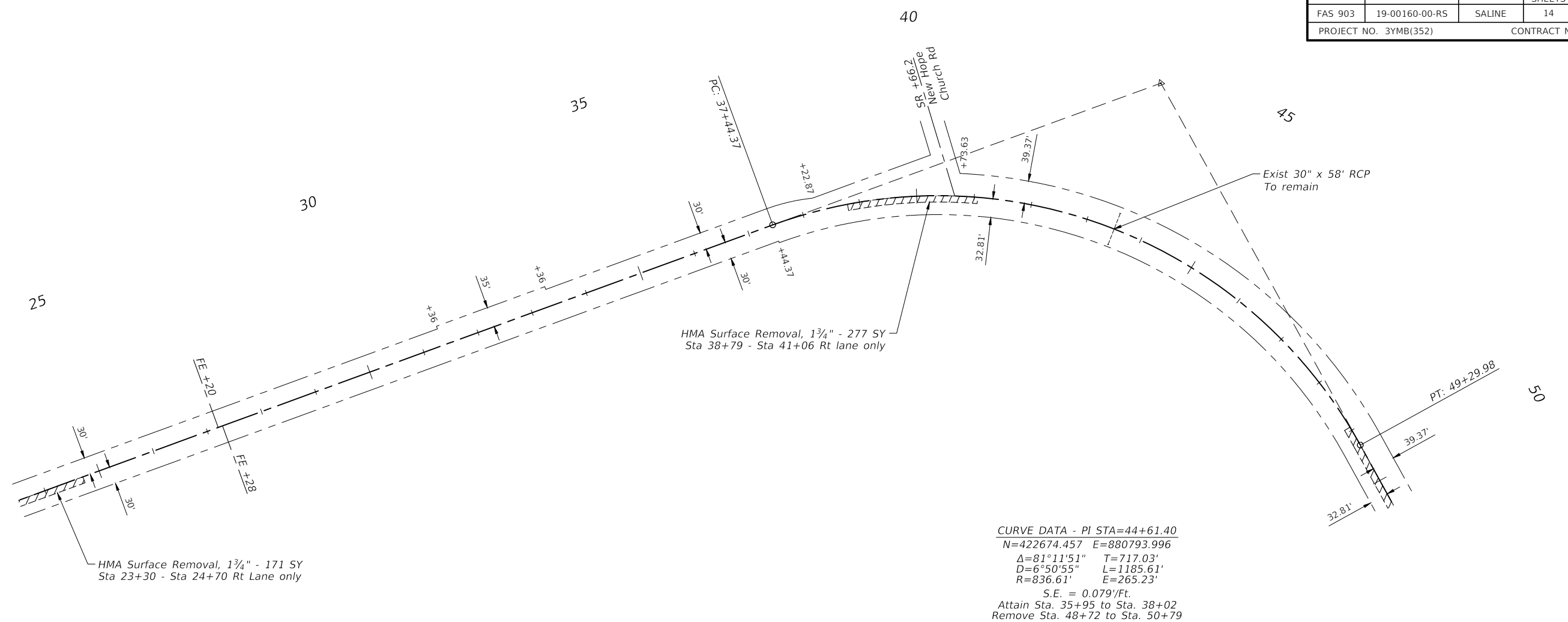

ROUTE	SECTION	COUNTY	TOTAL SHEETS	SHEET NO.
FAS 903	19-00160-00-RS	SALINE	14	10
PROJECT NO. 3YMB(352)			CONTRACT NO. 99661	

CURVE DATA - PI STA=69+11.27
 N=420001.493 E=881163.022
 $\Delta=82^{\circ}32'51''$ T=820.69'
 D=6 $^{\circ}07'40''$ L=1347.13'
 R=935.04' E=309.08'
 S.E. = 0.078'/Ft.
 Attain Sta. 59+43 to Sta. 61+48
 Remove Sta. 73+80 to Sta. 101+60

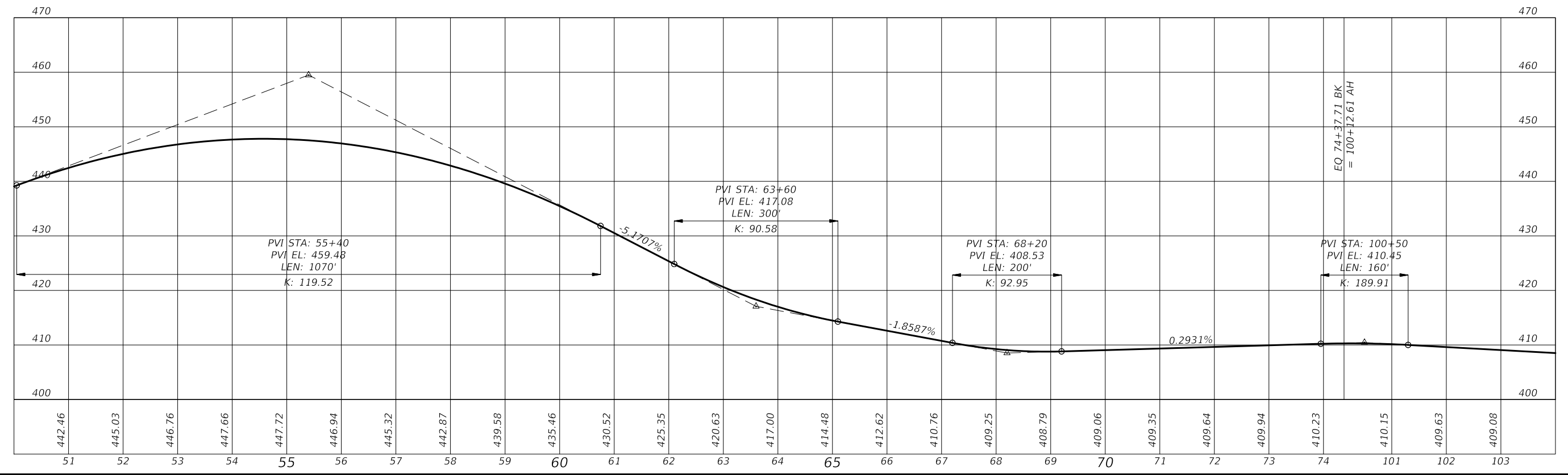
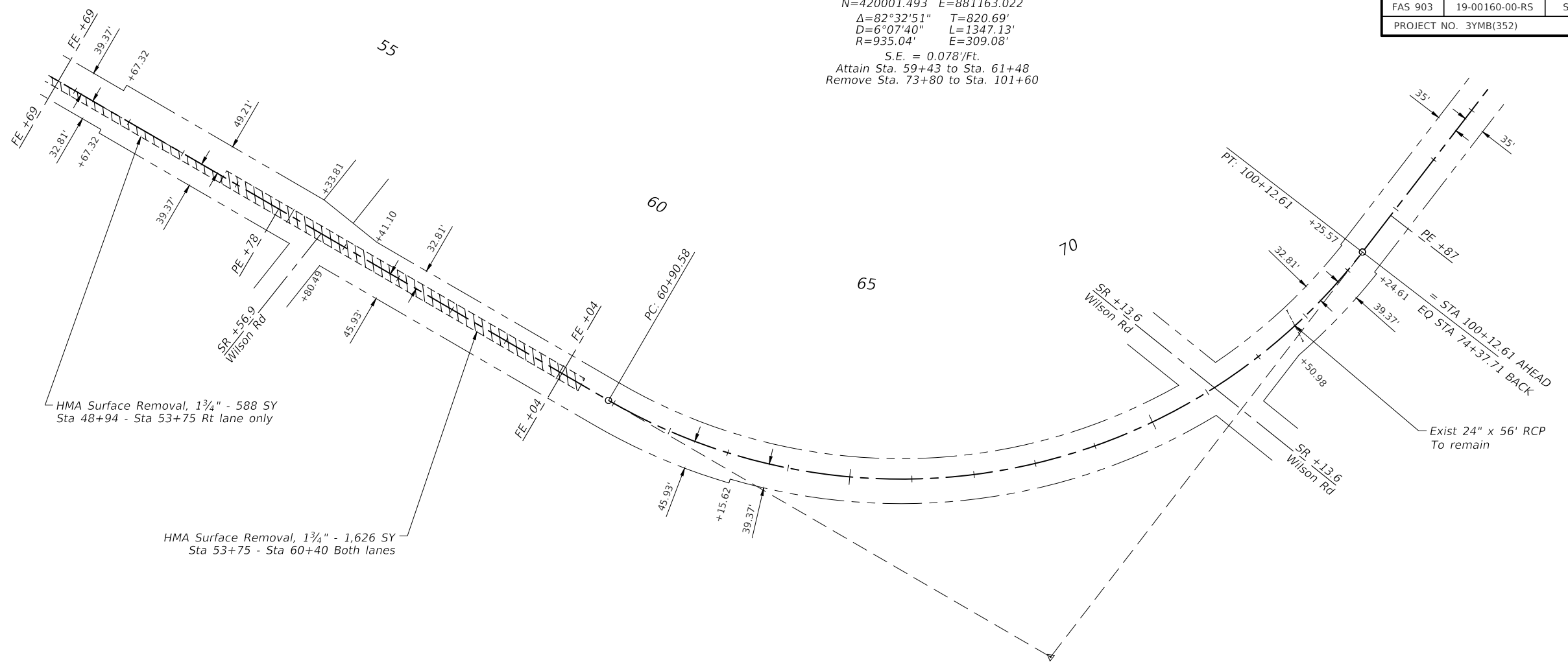

ROUTE	SECTION	COUNTY	TOTAL SHEETS	SHEET NO.
FAS 903	19-00160-00-RS	SALINE	14	11
PROJECT NO. 3YMB(352)			CONTRACT NO. 99661	

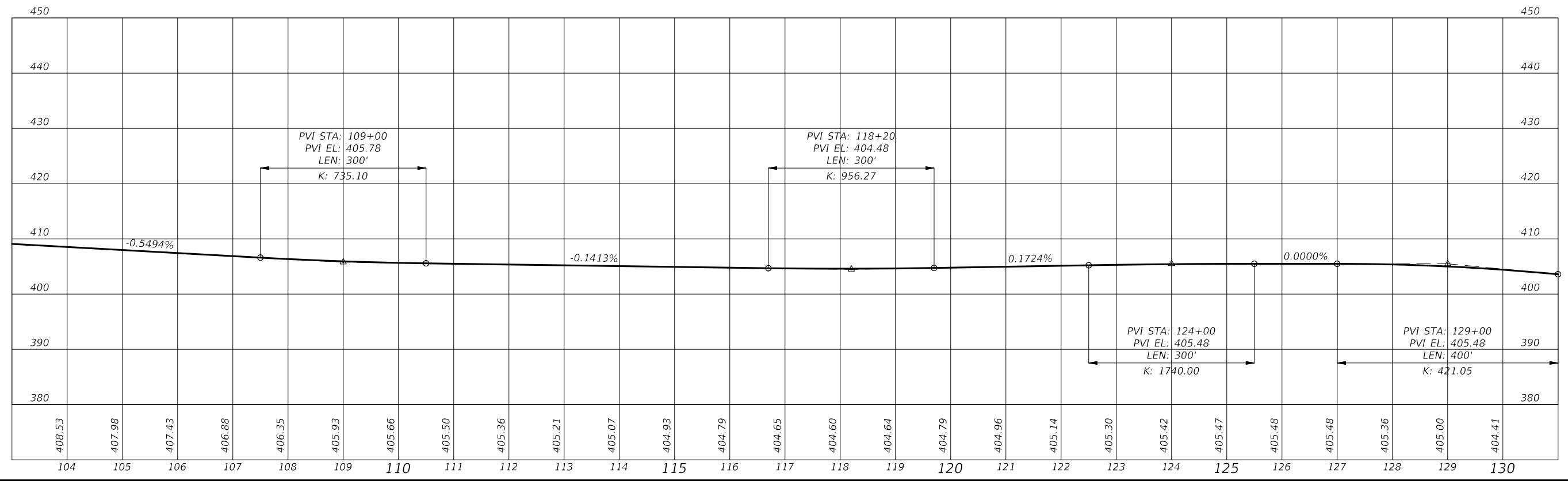
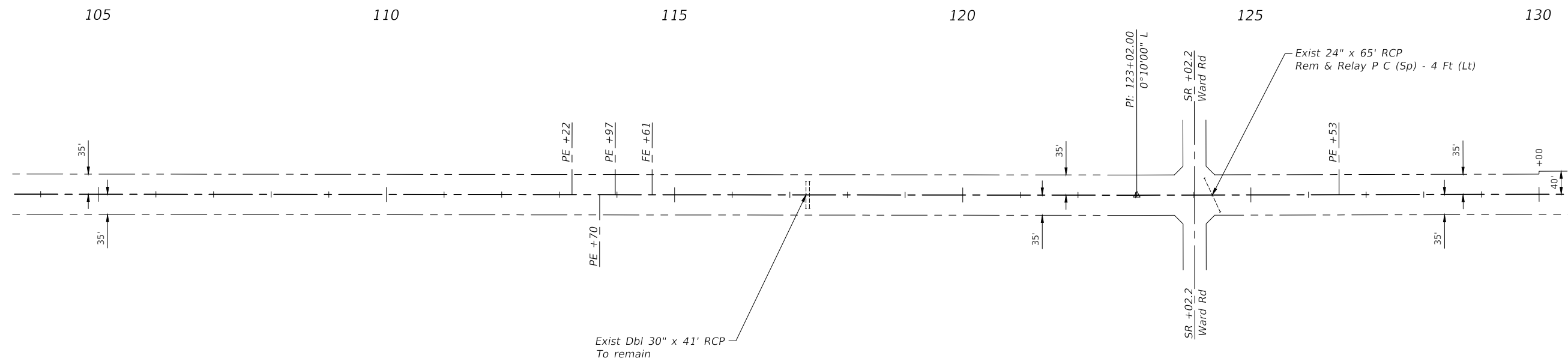

ROUTE	SECTION	COUNTY	TOTAL SHEETS	SHEET NO.
FAS 903	19-00160-00-RS	SALINE	14	12
PROJECT NO. 3YMB(352)			CONTRACT NO. 99661	

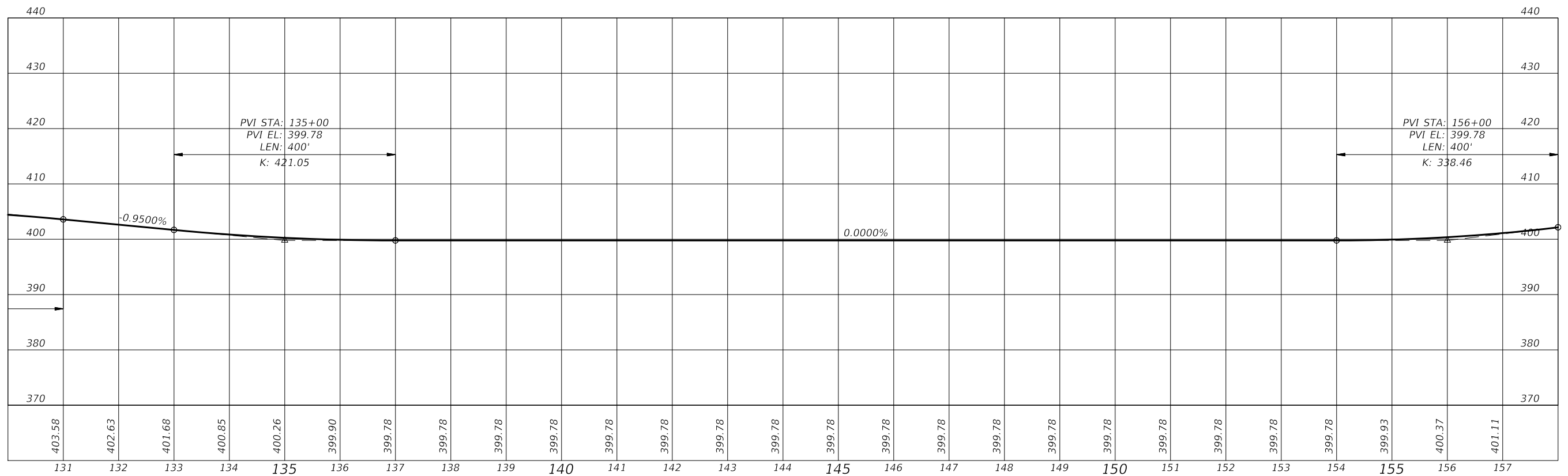
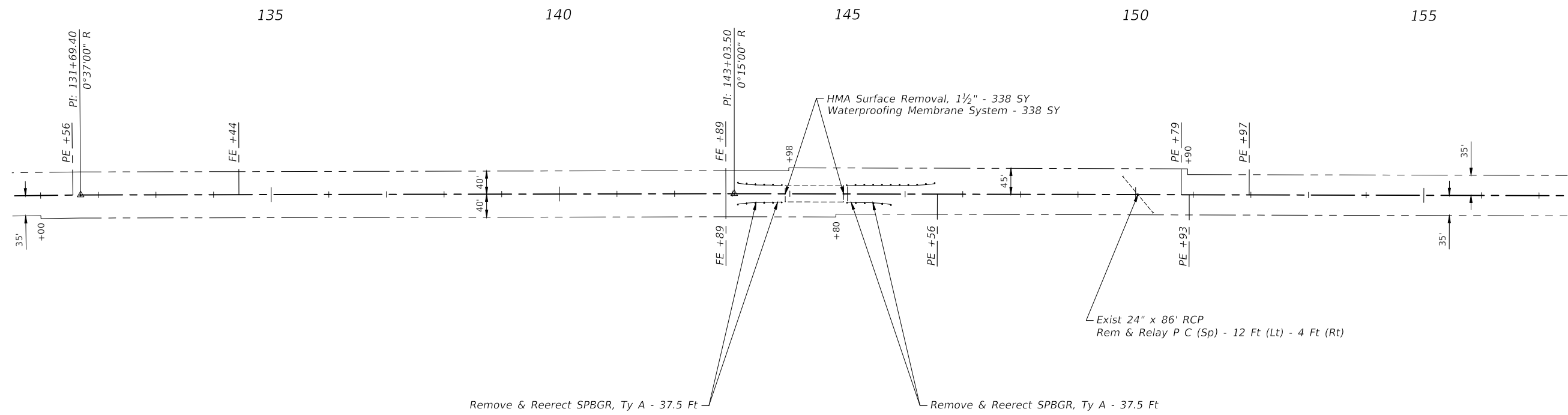

ROUTE	SECTION	COUNTY	TOTAL SHEETS	SHEET NO.
FAS 903	19-00160-00-RS	SALINE	14	13
PROJECT NO. 3YMB(352)			CONTRACT NO. 99661	

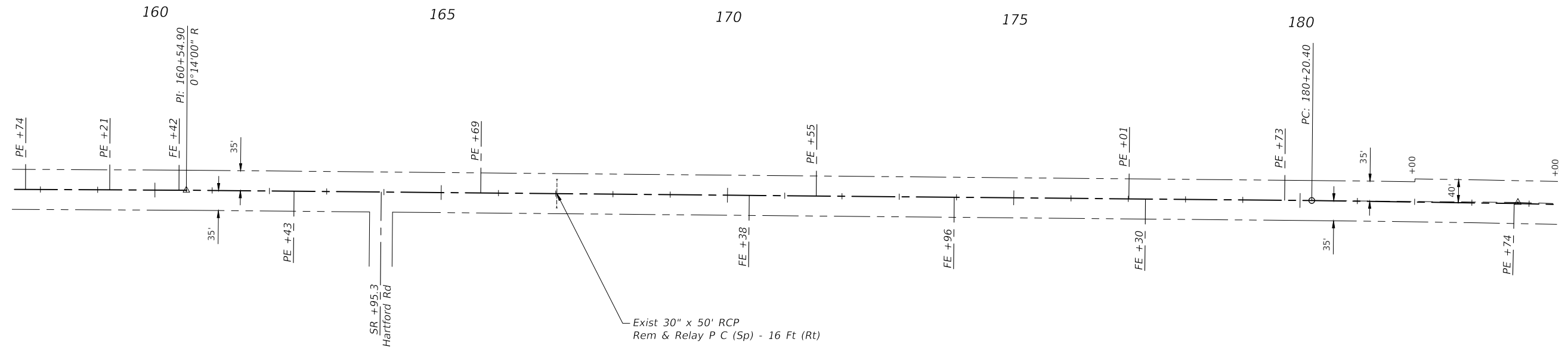

Exist 30" x 50' RCP
Rem & Relay P C (Sp) - 16 Ft (Rt)

CURVE DATA - PI STA=183+80.41
 N=420001.260 E=890351.271
 $\Delta=1^{\circ}12'00''$ T=360.01'
 $D=0^{\circ}10'00''$ L=719.99'
 R=34377.17' E=1.89'
 S.E. = Normal Crown

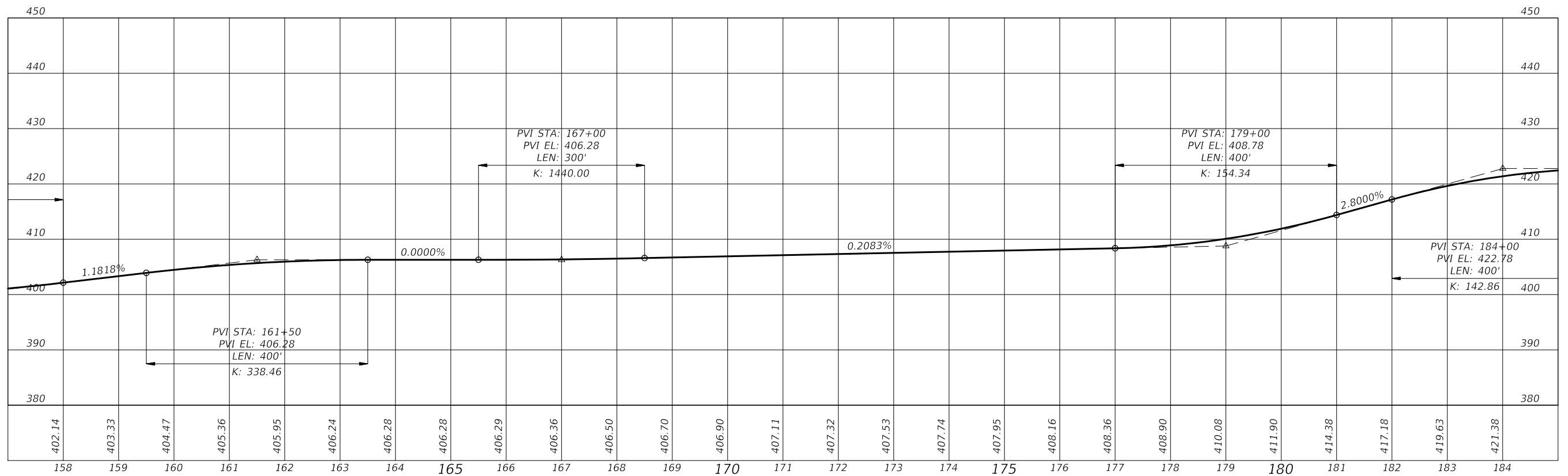

ROUTE	SECTION	COUNTY	TOTAL SHEETS	SHEET NO.
FAS 903	19-00160-00-RS	SALINE	14	14
PROJECT NO. 3YMB(352)			CONTRACT NO. 99661	

