

CONTROL POINTS

NUMBER	NORTHING	EASTING	ELEVATION
101	1893441.31	1088396.37	661.98
102	1893117.68	1088167.76	664.34
103	1892885.27	1088032.44	668.24
104	1893186.58	1087905.08	667.70
105	1892901.66	1087753.04	671.51
106	1892663.51	1087578.50	672.33
107	1892433.48	1087410.23	669.99
108	1892333.19	1087146.48	666.86
109	1892537.54	1086942.55	662.20
110	1892734.83	1086725.47	661.70
111	1892848.14	1086490.75	663.57
201	1893166.68	1086096.41	665.92
202	1893407.18	1086026.66	665.48
203	1893646.69	1085953.42	666.84
204	1892924.42	1086150.68	670.58
205	1892686.31	1086222.93	676.71

EX CURVE CL83-1 PI STA = 84+47.55 Δ = 02°39'30" (LT) D = 00°37'34" R = 9,151.55' T = 212.33' E = 2.46' PC STA = 82+35.22 PT STA = 86+59.81	EX CURVE CL83-2 PI STA = 88+21.01 Δ = 04°50'56" (LT) D = 01°30'17" R = 3,807.42' T = 161.20' E = 3.41' PC STA = 86+59.81 PT STA = 89+82.02	EX CURVE CL83-3 PI STA = 93+15.85 Δ = 02°23'08" (LT) D = 00°21'26" R = 16,034.06' T = 333.83' E = 3.47' PC STA = 89+82.02 PT STA = 96+49.58	EX CURVE CL83-4 PI STA = 98+24.80 Δ = 01°20'32" (RT) D = 00°22'59" R = 14,957.44' T = 175.22' E = 1.03' PC STA = 96+49.58 PT STA = 100+00.00	EX CURVE CL83-5 PI STA = 102+60.61 Δ = 00°11'04" (LT) D = 00°02'07" R = 161,800.00' T = 260.61' E = 0.21' PC STA = 100+00.00 PT STA = 105+21.22
--	--	---	--	---

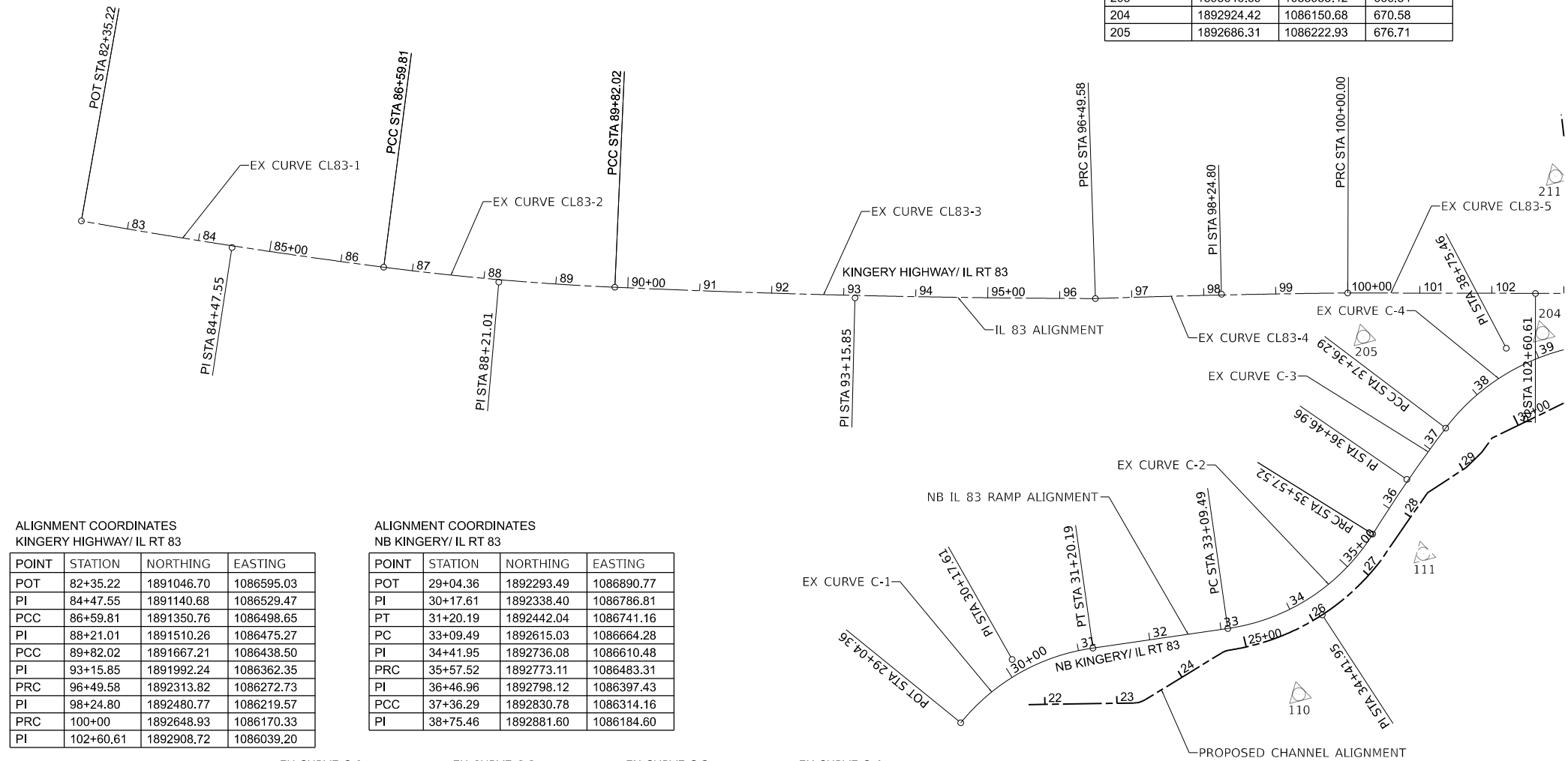

ALIGNMENT COORDINATES  
KINGERY HIGHWAY/ IL RT 83

POINT	STATION	NORTHING	EASTING
POT	82+35.22	1891046.70	1086595.03
PI	84+47.55	1891140.68	1086529.47
PCC	86+59.81	1891350.76	1086498.65
PI	88+21.01	1891510.26	1086475.27
PCC	89+82.02	1891667.21	1086438.50
PI	93+15.85	1891992.24	1086362.35
PRC	96+49.58	1892313.82	1086272.73
PI	98+24.80	1892480.77	1086219.57
PRC	100+00	1892648.93	1086170.33
PI	102+60.61	1892908.72	1086039.20

ALIGNMENT COORDINATES  
NB KINGERY/IL RT 83

POINT	STATION	NORTHING	EASTING
POT	29+04.36	1892293.49	1086890.77
PI	30+17.61	1892338.40	1086786.81
PT	31+20.19	1892442.04	1086741.16
PC	33+09.49	1892615.03	1086664.28
PI	34+41.95	1892736.08	1086610.48
PRC	35+57.52	1892773.11	1086483.31
PI	36+46.96	1892798.12	1086397.43
PCC	37+36.29	1892830.78	1086314.16
PI	38+75.46	1892881.60	1086184.60

EX CURVE C-1 PI STA = 30+17.61 Δ = 42°51'59" (RT) D = 19°51'41" R = 288.48' T = 113.25' E = 21.43' PC STA = 29+04.36 PT STA = 31+20.19	EX CURVE C-2 PI STA = 34+41.95 Δ = 49°48'13" (LT) D = 20°04'47" R = 285.34' T = 132.46' E = 29.25' PC STA = 33+09.49 PT STA = 35+57.52	EX CURVE C-3 PI STA = 36+46.96 Δ = 05°11'04" (RT) D = 02°54'00" R = 1,975.65' T = 89.45' E = 2.02' PC STA = 35+57.52 PT STA = 37+36.29	EX CURVE C-4 PI STA = 38+75.46 Δ = 50°07'45" (RT) D = 19°15'14" R = 297.58' T = 139.17' E = 30.94' PC STA = 37+36.29 PT STA = 39+96.65
--	--	--	--

MODEL: P1011 (10-11) 311 S. Wacker Drive, Suite 1950 Chicago, Illinois 60606 312-674-6560 www.bowmanconsulting.com  
 FILE NAME: P:\00000000 - IDOT\040058-01-002 (ENGLISH) - FTB-195-016 Phase II\Work\Engineering\W01 - IL83\311\311500 Drawings\502\_CADD\_Sheets\102\M69-shl-RTB.dgn



USER NAME = khejtmanek	DESIGNED - KH	REVISED -
PLOT SCALE = 0.1667' / in.	DRAWN - KM	REVISED -
PLOT DATE = 3/10/2021	CHECKED - AP	REVISED -
	DATE - 3/11/2021	REVISED -

STATE OF ILLINOIS  
DEPARTMENT OF TRANSPORTATION

ALIGNMENT, TIES, AND BENCHMARKS

SCALE: 1"=100' SHEET 1 OF 2 SHEETS STA. TO STA.

F.A.P. RTE.	SECTION	COUNTY	TOTAL SHEETS	SHEET NO.
344	2020-196-T	DUPAGE	122	19
CONTRACT NO. 62M69				
ILLINOIS FED. AID PROJECT				