

DATE	
BY	
SURVEYED	
PLOTTED	
TEMPLATE	
NOTE BOOK	
AREAS CHECKED	
NO.	

DATE	
BY	
SURVEYED	
PLOTTED	
TEMPLATE	
NOTE BOOK	
AREAS CHECKED	
NO.	

MODEL: 25+50.00 (Sheet)
 FILE NAME: P:\040058-01-002 (ENG) - FTB 195-016 Phase II Var VanEngineering\WO 1 - ILS\1138\500 Drawings\502_CADD Sheets\122\MS6-shx-5P-RChannel.dgn

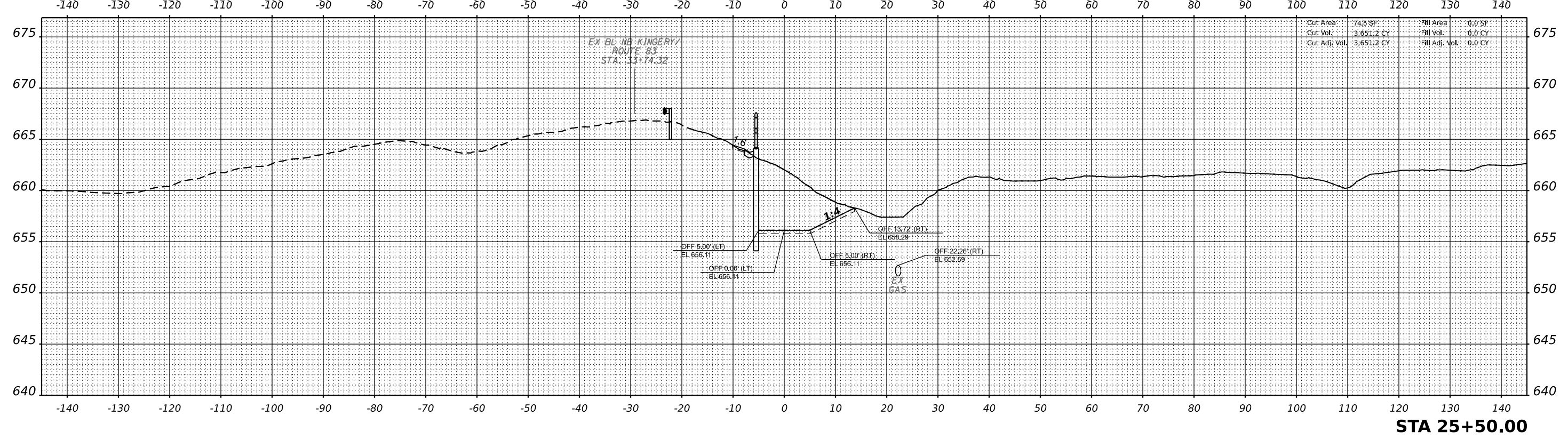
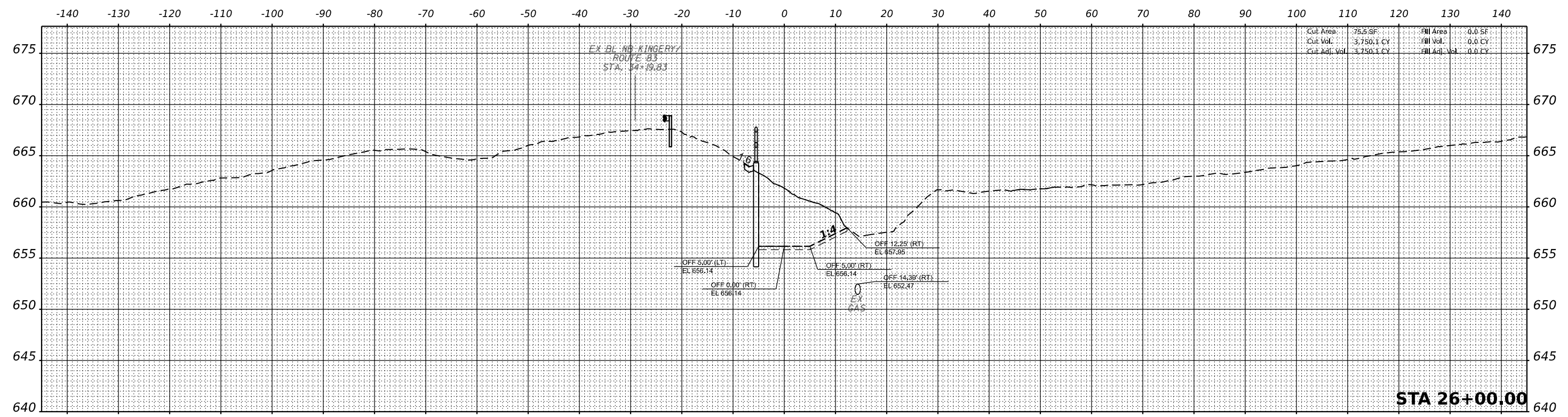

USER NAME = khejtmanek	DESIGNED - KH	REVISED -
DRAWN - KM	REVISOR -	
PLLOT SCALE = 0.1667' / in.	CHECKED - AP	REVISOR -
PLLOT DATE = 3/10/2021	DATE - 3/11/2021	REVISOR -

**STATE OF ILLINOIS
DEPARTMENT OF TRANSPORTATION**

CROSS SECTIONS PROPOSED CHANNEL		
SCALE: 1"=10'(H) 1"=5'(V)	SHEET 5 OF 17 SHEETS	STA. 25+50.00 TO 26+00.00

F.A.P. RTE. 344	SECTION 2020-196-T	COUNTY DUPAGE	TOTAL SHEETS 122	SHEET NO. 81
CONTRACT NO. 62M69				
ILLINOIS FED. AID PROJECT				