

STATE OF ILLINOIS
DEPARTMENT OF TRANSPORTATION
DIVISION OF HIGHWAYS

F.A.P. RTE.	SECTION	COUNTY	TOTAL SHEETS	SHEET NO.
320	138RS-2	MACON	12	1
		ILLINOIS	CONTRACT NO. 74462	



D-97-045-10

FOR INDEX OF SHEETS, SEE SHEET NO. 2

**PROPOSED
HIGHWAY PLANS**

F.A.P. ROUTE 320 (IL. RTE. 121)
SECTION 138RS-2
RESURFACING
PROJECT NHPP-TOKG(189)
MACON COUNTY

C-97-104-10

TRAFFIC INFORMATION
2019 ADT 16200

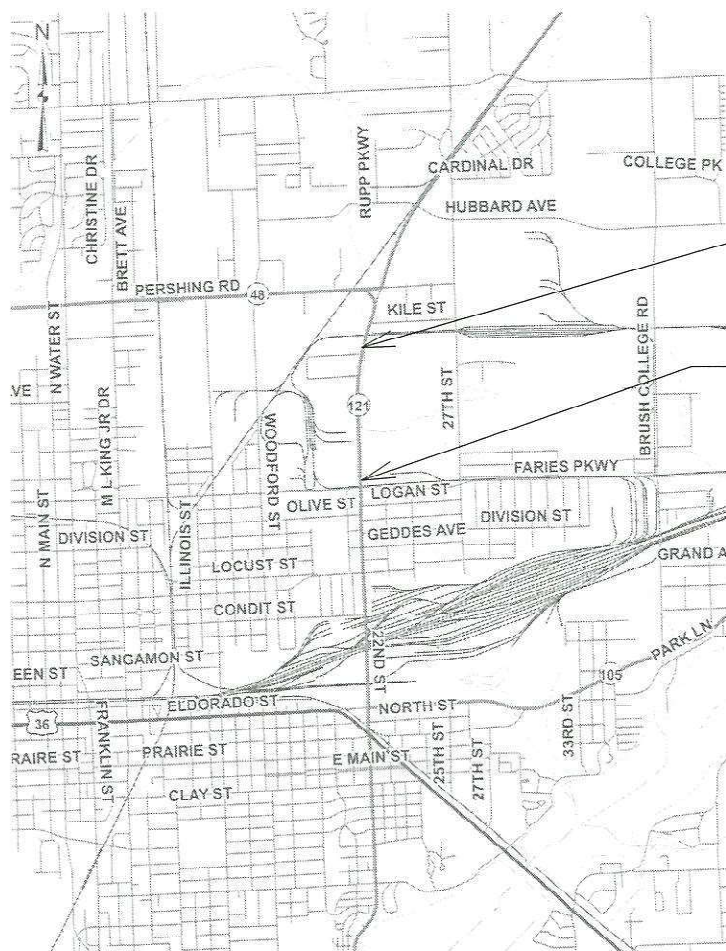
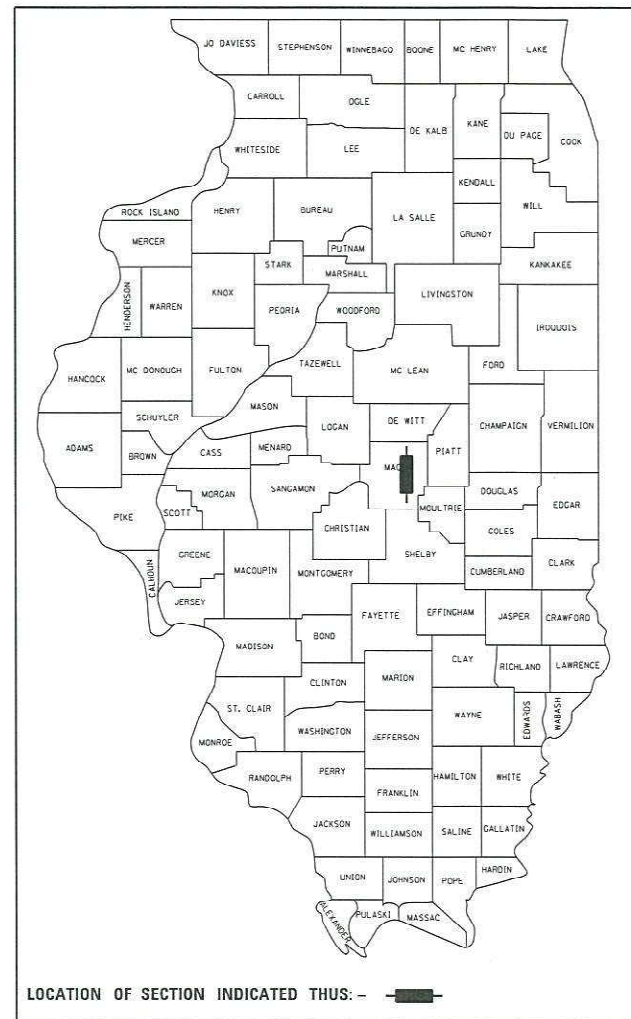

End Station
62+20
Start Station
25+00

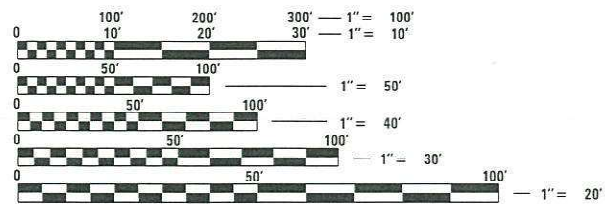

FULL SIZE PLANS HAVE BEEN PREPARED USING STANDARD ENGINEERING SCALES. REDUCED SIZED PLANS WILL NOT CONFORM TO STANDARD SCALES. IN MAKING MEASUREMENTS ON REDUCED PLANS, THE ABOVE SCALES MAY BE USED.

J.U.L.I.E.
JOINT UTILITY LOCATION INFORMATION FOR EXCAVATION
1-800-892-0123
OR 811

PROJECT ENGINEER: TOM RONAN
PROJECT MANAGER: ROSS RUHOLL
PHONE: (217)-342-8320
CONTRACT NO. 74462

GROSS LENGTH = 3696.0 FT. = 0.70 MILE
NET LENGTH = 3696.0 FT. = 0.70 MILE

STATE OF ILLINOIS
DEPARTMENT OF TRANSPORTATION
DIVISION OF HIGHWAYS

SUBMITTED March 22 21 20 21
John P. May
DEPUTY DIRECTOR OF HIGHWAYS, REGION ENGINEER

May 7, 2021 *Joe E. A. Etk*
ENGINEER OF DESIGN AND ENVIRONMENT

May 7, 2021 *James J. ...*
DIRECTOR OF HIGHWAYS PROJECT IMPLEMENTATION 13

**PRINTED BY THE AUTHORITY
OF THE STATE OF ILLINOIS**

80% FED
20% STATE
URBAN

80% FED
20% STATE
URBAN

SUMMARY OF QUANTITIES			TOTAL QUANTITIES	CONSTRUCTION TYPE CODE		
CODE NO	ITEM	UNIT		0005		
40600290	BITUMINOUS MATERIALS (TACK COAT)	POUND	16620	16620		
40600990	TEMPORARY RAMP	SO YD	203	203		
40603219	POLYMERIZED HOT-MIX ASPHALT BINDER COURSE, IL-9.5FG, N90	TON	2413	2413		
40604164	POLYMERIZED HOT-MIX ASPHALT SURFACE COURSE, IL-9.5, MIX "D", N90	TON	2758	2758		
40800050	INCIDENTAL HOT-MIX ASPHALT SURFACING	TON	134	134		
44000164	HOT-MIX ASPHALT SURFACE REMOVAL, 3 3/4"	SO YD	24622	24622		
44201411	CLASS C PATCHES, TYPE I, 15 INCH	SO YD	8	8		
44201415	CLASS C PATCHES, TYPE II, 15 INCH	SO YD	147	147		
44201419	CLASS C PATCHES, TYPE III, 15 INCH	SO YD	32	32		
44201421	CLASS C PATCHES, TYPE IV, 15 INCH	SO YD	20	20		
67000400	ENGINEER'S FIELD OFFICE, TYPE A	CAL MO	6	6		
67100100	MOBILIZATION	L SUM	1	1		

SUMMARY OF QUANTITIES			TOTAL QUANTITIES	CONSTRUCTION TYPE CODE		
CODE NO	ITEM	UNIT		0005		
70102625	TRAFFIC CONTROL AND PROTECTION, STANDARD 701606	L SUM	1	1		
70102632	TRAFFIC CONTROL AND PROTECTION, STANDARD 701602	L SUM	1	1		
70102635	TRAFFIC CONTROL AND PROTECTION, STANDARD 701701	L SUM	1	1		
70107025	CHANGEABLE MESSAGE SIGN	CAL DA	28	28		
70300100	SHORT-TERM PAVEMENT MARKING	FOOT	3744	3744		
70300150	SHORT TERM PAVEMENT MARKING REMOVAL	SO FT	510	510		
70300210	TEMPORARY PAVEMENT MARKING LETTERS AND SYMBOLS	- SQ FT	645.6	645.6		
70300220	TEMPORARY PAVEMENT MARKING LINE 4"	- FOOT	8474	8474		
70300240	TEMPORARY PAVEMENT MARKING - LINE 6"	FOOT	1660	1660		
70300260	TEMPORARY PAVEMENT MARKING - LINE 12"	FOOT	51	51		
70300280	TEMPORARY PAVEMENT MARKING LINE 24"	- FOOT	146	146		

MODEL: Default
 FILE NAME: p:\pub\amrnon.dwg
 PROJECT: 74462-CAD\Drawings\DOT Office\Drawings\74462-CAD\Drawings\74462-CAD.dwg

USER NAME = steffenmk	DESIGNED -	REVISED -
PLOT SCALE = 100,0000' / in.	DRAWN -	REVISED -
PLOT DATE = 4/2/2021	CHECKED -	REVISED -
	DATE -	REVISED -

**STATE OF ILLINOIS
DEPARTMENT OF TRANSPORTATION**

SCHEDULE OF QUANTITIES	
SCALE:	SHEET 1 OF 2 SHEETS STA. TO STA.

F.A.P. RTE. 320	SECTION 138RS-2	COUNTY MACON	TOTAL SHEETS 12	SHEET NO. 3
CONTRACT NO. 74462				
ILLINOIS FED. AID PROJECT				

80% FED
20% STATE
URBAN

80% FED
20% STATE
URBAN

SUMMARY OF QUANTITIES			TOTAL QUANTITIES	CONSTRUCTION TYPE CODE		
CODE NO	ITEM	UNIT		0005		
* 78000100	THERMOPLASTIC PAVEMENT MARKING - LETTERS AND SYMBOLS	SO FT	645.6	645.6		
* 78000200	THERMOPLASTIC PAVEMENT MARKING - LINE 4"	FOOT	8474	8474		
* 78000400	THERMOPLASTIC PAVEMENT MARKING - LINE 6"	FOOT	1660	1660		
* 78000600	THERMOPLASTIC PAVEMENT MARKING - LINE 12"	FOOT	51	51		
* 78000650	THERMOPLASTIC PAVEMENT MARKING - LINE 24"	FOOT	146	146		
* 78100100	RAISED REFLECTIVE PAVEMENT MARKER	EACH	196	196		
78300200	RAISED REFLECTIVE PAVEMENT MARKER REMOVAL	EACH	196	196		
X0326440	SURFACE REMOVAL, VARIABLE DEPTH (SPECIAL)	SO YD	911	911		
X4060995	TEMPORARY RAMP, SPECIAL	SO YD	1010	1010		
* X7830060	GROOVING FOR RECESSED PAVEMENT MARKING, LETTERS AND SYMBOLS	SO FT	645.6	645.6		
* X7830070	GROOVING FOR RECESSED PAVEMENT MARKING 5"	FOOT	8294	8294		
* X7830074	GROOVING FOR RECESSED PAVEMENT MARKING 7"	FOOT	1660	1660		

SUMMARY OF QUANTITIES			TOTAL QUANTITIES	CONSTRUCTION TYPE CODE		
CODE NO	ITEM	UNIT		0005		
* X7830078	GROOVING FOR RECESSED PAVEMENT MARKING 13"	FOOT	51	51		
* X7830090	GROOVING FOR RECESSED PAVEMENT MARKING 25"	FOOT	146	146		
Z0005010	HOT-MIX ASPHALT FOR PATCHING POTHOLES (COLD MIX)	TON	1	1		
Z0033700	LONGITUDINAL JOINT SEALANT	FOOT	14080	14080		
Z0049799	PROTECTING OR RESETTNG SURVEY MARKERS	EACH	3	3		

* SPECIALTY ITEM

MODEL: Default
FILE NAME: \\pwwww\lmmoon\dot\illinois\pww\DOT\Documents\DOT-Office\Drawings\7Pro\7462\7462\DOT\CAD\Drawings\7462-518-500.dwg

USER NAME = stefenmk	DESIGNED -	REVISED -
	DRAWN -	REVISED -
PLOT SCALE = 100,0000' / in.	CHECKED -	REVISED -
PLOT DATE = 4/2/2021	DATE -	REVISED -

**STATE OF ILLINOIS
DEPARTMENT OF TRANSPORTATION**

SCHEDULE OF QUANTITIES

SCALE: SHEET 2 OF 2 SHEETS STA. TO STA.

F.A.P. RTE.	SECTION	COUNTY	TOTAL SHEETS	SHEET NO.
320	138RS-2	MACON	12	4
CONTRACT NO. 74462				
ILLINOIS FED. AID PROJECT				

RESURFACING SCHEDULE

STATION TO STATION	LENGTH FOOT	AVERAGE PAVEMENT WIDTH FOOT	AREA SQ YD	BITUMINOUS MATERIALS (TACK COAT) POUND	TEMPORARY RAMP SQ YD	HOT-MIX ASPHALT BINDER COURSE TON	HOT-MIX ASPHALT SURFACE COURSE TON	INCIDENTAL HOT-MIX ASPHALT SURFACE TON	HOT-MIX ASPHALT SURFACE REMOVAL, 3 3/4" SQ YD	SURFACE REMOVAL, VARIABLE DEPTH SQ YD	TEMPORARY RAMP (SPECIAL) SQ YD	LONGITUDINAL JOINT SEALANT FOOT	PROTECTING AND RESETTING SURVEY MARKERS EACH
25+00.00 TO 27+00.00	200.0	52.0	1155.6	780.0	0.0	113.2	129.4	0.0	1155.6	0.0	0.0	0.0	1.0
27+00.00 TO 28+53.00	153.0	60.0	1020.0	688.5	0.0	100.0	114.2	0.0	1020.0	0.0	0.0	612.0	0.0
28+53.00 TO 29+53.00	100.0	60.0	666.7	450.0	0.0	65.3	74.7	0.0	666.7	0.0	43.3	400.0	0.0
29+53.00 TO 32+37.00	284.0	60.0	1893.3	1278.0	0.0	185.5	212.1	0.0	1893.3	0.0	32.7	1136.0	0.0
32+37.00 TO 33+34.00	97.0	60.0	646.7	436.5	0.0	63.4	72.4	0.0	646.7	0.0	94.0	388.0	0.0
33+34.00 TO 40+27.08	693.1	60.0	4620.5	3118.9	0.0	452.8	517.5	0.0	4620.5	0.0	70.7	2772.3	0.0
40+27.08 TO 41+68.05	141.0	660.0	10337.9	634.4	0.0	92.1	105.3	18.4	939.8	125.0	66.0	563.9	0.0
41+68.05 TO 42+13.85	45.8	60.0	305.3	206.1	0.0	29.9	34.2	0.0	305.3	0.0	0.0	183.2	0.0
42+13.85 TO 43+11.09	97.2	60.0	648.3	437.6	0.0	63.5	72.6	15.5	648.3	105.6	66.7	389.0	0.0
43+11.09 TO 52+60.66	949.6	60.0	6330.5	4273.1	0.0	620.4	709.0	53.0	6330.5	360.6	241.3	3798.3	2.0
52+60.66 TO 53+60.01	99.3	60.0	662.3	447.0	115.0	64.9	74.2	0.0	662.3	0.0	78.0	397.4	0.0
53+60.01 TO 55+26.01	166.0	60.0	1106.7	747.0	0.0	108.5	123.9	0.0	1106.7	0.0	60.0	664.0	0.0
55+26.01 TO 56+15.98	90.0	60.0	599.8	404.9	0.0	58.8	67.2	0.0	599.8	0.0	76.7	359.9	0.0
56+15.98 TO 58+67.01	251.0	60.0	1673.5	1129.6	0.0	164.0	187.4	0.0	1673.5	0.0	84.7	1004.1	0.0
58+67.01 TO 59+75.01	108.0	60.0	720.0	486.0	495.0	70.6	80.6	47.0	720.0	320.0	96.0	432.0	0.0
59+75.01 TO 62+20.00	245.0	60.0	1633.3	1102.5	0.0	160.1	182.9	0.0	1633.3	0.0	0.0	980.0	0.0
TOTALS	3720		34020.3	16619.9	203.0	2413.0	2757.6	133.9	24622.1	911.1	1010.0	14079.9	3.0

* TEMP RAMP & TEMP RAMP (SPECIAL) QUANTITIES REFLECT MULTIPLE APPLICATIONS FOR DIFFERENT LIFTS ACCORDING TO THE DROP OFF POLICY

PATCHING SCHEDULE

LOCATION	CLASS C PATCHING, TYPE 15 INCH	CLASS C PATCHING, TYPE II, 15 INCH	CLASS C PATCHING, TYPE III, 15 INCH	CLASS C PATCHING, TYPE IV, 15 INCH
	SQ YD	SQ YD	SQ YD	SQ YD
NB	2.7	45.3	16.0	0.0
SB	2.7	56.0	0.0	20.0
CENTER TURN LANE	2.7	45.3	16.0	0.0
TOTALS	8	147	32	20

PROTECT AND RESETTING SURVEY MARKERS

Pt. #	North	East	Station	Offset	PROPOSED	
					PROTECT OR RESET	QUANTITY
11019	1164528.206	817660.712	23+52	1.1' Lt	Replace Vault and Protect Steel Plate	1
11008	1166651.399	817630.362	44+79.3	0	Type I - Alum. Disk	1
11015	1167172.822	817650.933	49+98	5.2' Rt.	Replace Vault and Protect Steel Plate	1
TOTAL						3

PAVEMENT MARKING SCHEDULE

STATION TO STATION	LENGTH	SHORT-TERM PAVEMENT MARKING	SHORT-TERM PAVEMENT MARKING REMOVAL	TEMPORARY THERMOPLASTIC PAVEMENT MARKINGS -- LETTER AND SYMBOLS	TEMPORARY PAVEMENT MARKINGS-4"	TEMPORARY PAVEMENT MARKINGS-6"	TEMPORARY PAVEMENT MARKINGS-12"	TEMPORARY PAVEMENT MARKINGS-24"	THERMOPLASTIC PAVEMENT MARKINGS -- LETTER AND SYMBOLS	THERMOPLASTIC PAVEMENT MARKING - LINE 4"	THERMOPLASTIC PAVEMENT MARKING - LINE 6"	THERMOPLASTIC PAVEMENT MARKING - LINE 12"	THERMOPLASTIC PAVEMENT MARKING - LINE 24"	GROOVING FOR RECESSED PAVEMENT MARKINGS- LETTERS AND SYMBOLS	GROOVING FOR RECESSED PAVEMENT MARKINGS, 5"	GROOVING FOR RECESSED PAVEMENT MARKINGS, 7"	GROOVING FOR RECESSED PAVEMENT MARKINGS, 13"	GROOVING FOR RECESSED PAVEMENT MARKINGS, 25"	RAISED REFLECTIVE PAVEMENT MARKERS	RAISED REFLECTIVE PAVEMENT MARKER REMOVAL
	FOOT	FOOT	SQ FT	SQ FT	FOOT	FOOT	FOOT	FOOT	SQ FT	FOOT	FOOT	FOOT	FOOT	SQ FT	FOOT	FOOT	FOOT	FOOT	EACH	EACH
25+00.00 TO 27+00.00	200.0	240.0	30.0	0.0	800.0	100.0	51.0	0.0	0.0	800.0	100.0	51.0	0.0	0.0	800.0	100.0	51.0	0.0	12.0	12.0
27+00.00 TO 27+40.00	40.0	48.0	10.0	0.0	160.0	20.0	0.0	0.0	0.0	160.0	20.0	0.0	0.0	0.0	160.0	20.0	0.0	0.0	4.0	4.0
27+40.00 TO 28+53.00	113.0	144.0	20.0	31.2	339.0	60.0	0.0	0.0	31.2	339.0	60.0	0.0	0.0	31.2	339.0	60.0	0.0	0.0	8.0	8.0
28+53.00 TO 29+53.00	100.0	144.0	20.0	15.6	0.0	50.0	0.0	0.0	15.6	0.0	50.0	0.0	0.0	0.0	0.0	50.0	0.0	0.0	8.0	8.0
29+53.00 TO 32+37.00	284.0	0.0	40.0	46.8	708.0	140.0	0.0	37.0	46.8	708.0	140.0	0.0	37.0	62.4	708.0	140.0	0.0	37.0	16.0	16.0
32+37.00 TO 33+34.00	97.0	96.0	0.0	0.0	0.0	0.0	0.0	37.0	0.0	0.0	0.0	0.0	37.0	0.0	0.0	0.0	0.0	37.0	0.0	0.0
33+34.00 TO 40+27.08	693.1	816.0	100.0	124.8	1736.2	350.0	0.0	0.0	124.8	1736.2	350.0	0.0	0.0	124.8	1736.2	350.0	0.0	0.0	36.0	36.0
40+27.08 TO 41+68.05	141.0	192.0	20.0	31.2	351.9	70.0	0.0	0.0	31.2	351.9	70.0	0.0	0.0	31.2	351.9	70.0	0.0	0.0	8.0	8.0
41+68.05 TO 42+13.85	45.8	48.0	10.0	0.0	111.6	20.0	0.0	0.0	0.0	111.6	20.0	0.0	0.0	0.0	111.6	20.0	0.0	0.0	4.0	4.0
42+13.85 TO 43+11.09	97.2	96.0	20.0	31.2	244.5	50.0	0.0	0.0	31.2	244.5	50.0	0.0	0.0	31.2	244.5	50.0	0.0	0.0	8.0	8.0
43+11.09 TO 52+60.66	949.6	1152.0	130.0	124.8	2369.1	470.0	0.0	0.0	124.8	2369.1	470.0	0.0	0.0	124.8	2369.1	470.0	0.0	0.0	48.0	48.0
52+60.66 TO 53+60.01	99.3	0.0	0.0	0.0	0.0	0.0	0.0	0.0	0.0	0.0	0.0	0.0	0.0	0.0	0.0	0.0	0.0	0.0	0.0	0.0
53+60.01 TO 55+26.01	166.0	192.0	30.0	31.2	412.0	80.0	0.0	36.0	31.2	412.0	80.0	0.0	36.0	31.2	412.0	80.0	0.0	36.0	12.0	12.0
55+26.01 TO 56+15.98	90.0	0.0	0.0	0.0	0.0	0.0	0.0	36.0	0.0	0.0	0.0	0.0	36.0	0.0	0.0	0.0	0.0	36.0	0.0	0.0
56+15.98 TO 58+67.01	251.0	288.0	40.0	62.4	632.1	130.0	0.0	0.0	62.4	632.1	130.0	0.0	0.0	62.4	632.1	130.0	0.0	0.0	16.0	16.0
58+67.01 TO 59+75.01	108.0	0.0	0.0	0.0	0.0	0.0	0.0	0.0	0.0	0.0	0.0	0.0	0.0	0.0	0.0	0.0	0.0	0.0	0.0	0.0
59+75.01 TO 62+20.00	245.0	288.0	40.0	146.4	610.0	120.0	0.0	0.0	146.4	610.0	120.0	0.0	0.0	146.4	610.0	120.0	0.0	0.0	16.0	16.0
TOTALS	3720	3744	510	646	8474	1650	51	146	646	8474	1660	51	146	646	8474	1660	51	146	196	196.0

MODEL: Default
 FILE NAME: p:\pub\m\room\dot\illinois.gov\PIWDOT\Documents\IBOT_Office\Bldgct_7\Project\7462\CAD\Drawings\DOT_7462_Sched\7462_Sched.sch
 PROJECT: 7462, CAD\Drawings\DOT_7462_Sched\7462_Sched.sch

USER NAME = stefenmk	DESIGNED -	REVISED -
	DRAWN -	REVISED -
PLOT SCALE = 100,0000' / in.	CHECKED -	REVISED -
PLOT DATE = 4/2/2021	DATE -	REVISED -

**STATE OF ILLINOIS
DEPARTMENT OF TRANSPORTATION**

SCHEDULES

SCALE: SHEET 2 OF 2 SHEETS STA. TO STA.

F.A.P. RTE.	SECTION	COUNTY	TOTAL SHEETS	SHEET NO.
320	138RS-2	MACON	12	6
CONTRACT NO. 74462				
ILLINOIS FED. AID PROJECT				

TYPICAL CROSS SECTIONS

① STATION 25+00 TO STATION 27+00 ②

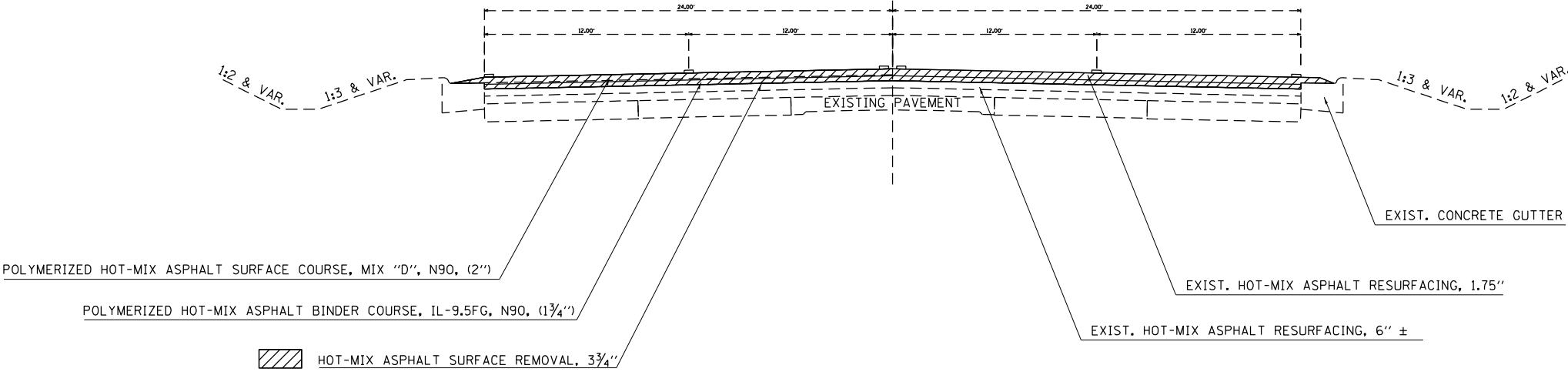

MODEL: Default
FILE NAME: p:\pub\lhammon.dwg
PROJECT: 74462-CA00Data\CAD\Projects\74462-CA00-1138RS-2.dwg

USER NAME = steffenmk	DESIGNED -	REVISED -
	DRAWN -	REVISED -
PLOT SCALE = 100,0000' / in.	CHECKED -	REVISED -
PLOT DATE = 4/2/2021	DATE -	REVISED -

STATE OF ILLINOIS
DEPARTMENT OF TRANSPORTATION

TYPICALS	
SCALE:	SHEET 1 OF 2 SHEETS STA. TO STA.

F.A.P. RTE.	SECTION	COUNTY	TOTAL SHEETS	SHEET NO.
320	138RS-2	MACON	12	7
CONTRACT NO. 74462				
ILLINOIS FED. AID PROJECT				

TYPICAL CROSS SECTIONS

② STATION 27+00.00 TO STATION 59+23.38 ③

④ STATION 59+77.12 TO STATION 61+65.00 ⑤

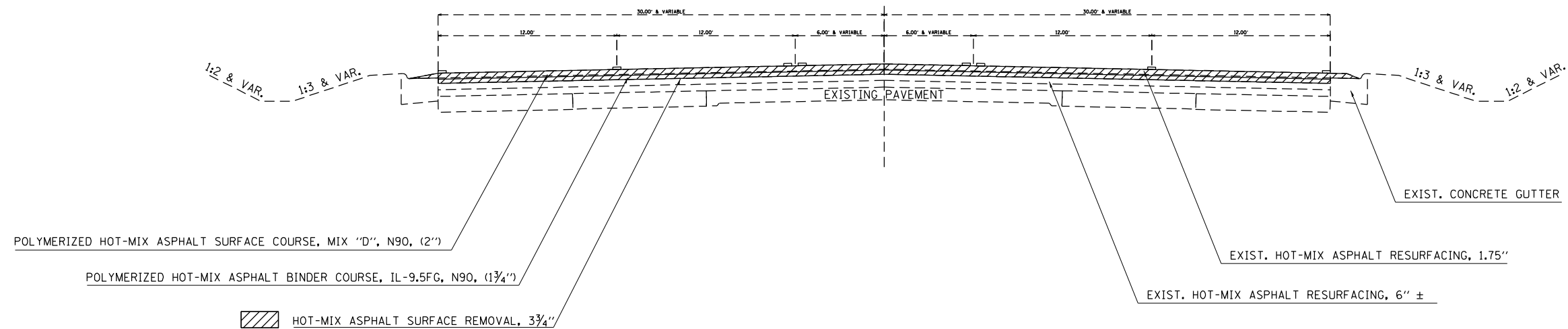

TYPICAL CROSS SECTIONS

③ STATION 59+23.38 TO STATION 59+77.12 ④

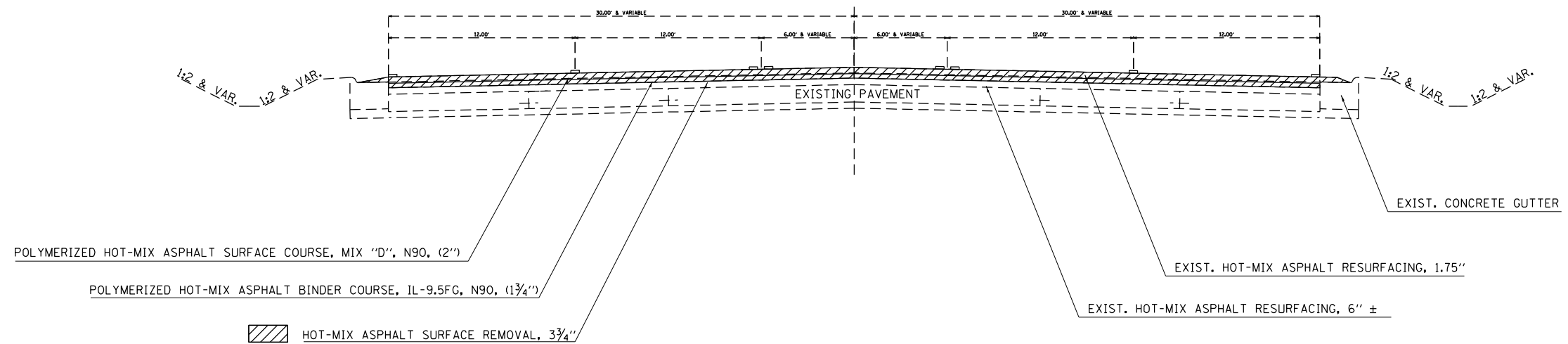

NOTE: NOT DRAWN TO SCALE

USER NAME = steffenmk	DESIGNED -	REVISED -
PLOT SCALE = 100,0000' / in.	DRAWN -	REVISED -
PLOT DATE = 4/2/2021	CHECKED -	REVISED -
	DATE -	REVISED -

**STATE OF ILLINOIS
DEPARTMENT OF TRANSPORTATION**

TYPICALS

SCALE: SHEET 2 OF 2 SHEETS STA. TO STA.

F.A.P. RTE.	SECTION	COUNTY	TOTAL SHEETS	SHEET NO.
320	138RS-2	MACON	12	8
CONTRACT NO. 74462				
ILLINOIS FED. AID PROJECT				

MODEL: Default
 FILE NAME: p:\pub\mroom.dwt\illinois.gov\PWDOT\Documents\DOT_Offices\District_7\Projects\74462\CADD\Drawings\74462-ctc\typical.dwg

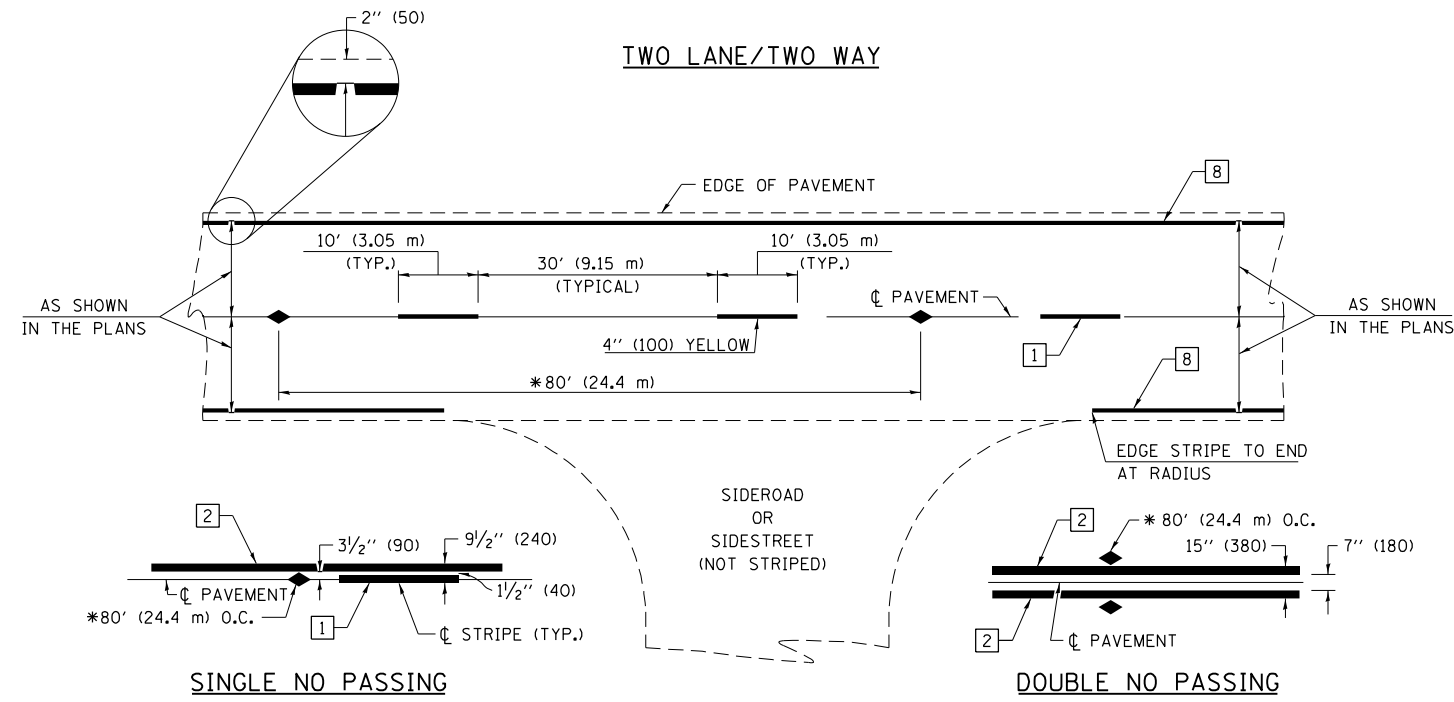

* REDUCE TO 40' (12.2 m) O.C. ON CURVES WITH POSTED OR ADVISORY SPEEDS OF 45 mph (70 km/h) OR LESS.

PAVEMENT MARKING LEGEND

- 1 4" (100) SKIP-DASH (YELLOW)
 - 2 4" (100) SOLID (YELLOW)
 - 3 12" (300) DIAGONAL (YELLOW)
 - 4 4" (100) DOUBLE YELLOW (NARROW)
 - 5 12" (300) SOLID WHITE
 - 6 RESERVED
 - 7 6" (150) SKIP-DASH (WHITE)
 - 8 4" (100) SOLID (WHITE)
 - 9 12" (300) DIAGONAL (WHITE)
 - 10 6" (150) SOLID (WHITE)
 - 11 24" (600) STOP BAR (WHITE)
 - 12 8" (200) SOLID (WHITE)
 - 13 4" (100) PARKING WHITE
-

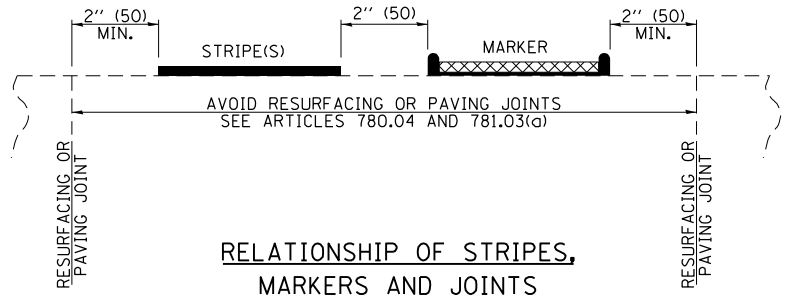

TYPICAL PAVEMENT MARKERS LEGEND

- ◆ TWO-WAY AMBER MARKER
- ▶ ONE-WAY AMBER MARKER
- ▷ ONE-WAY CRYSTAL MARKER

RAISED REFLECTIVE PAVEMENT MARKERS

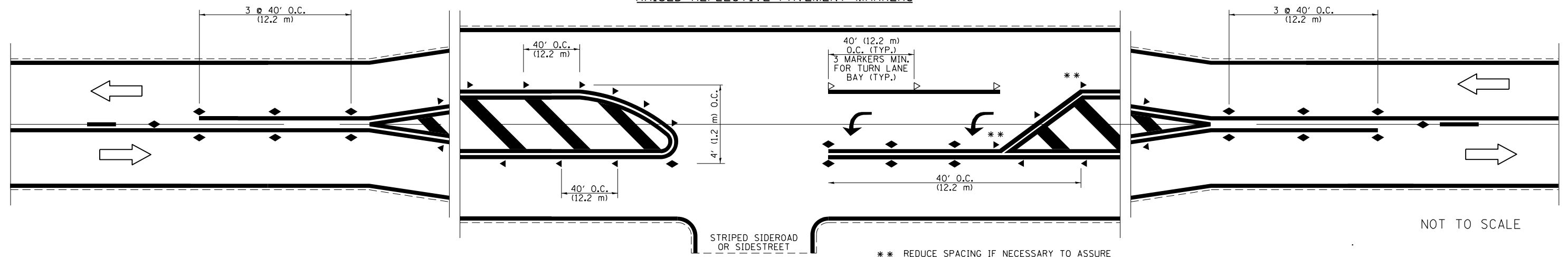

** REDUCE SPACING IF NECESSARY TO ASSURE MARKERS AT CORNER POINTS.

URBAN LEFT TURN

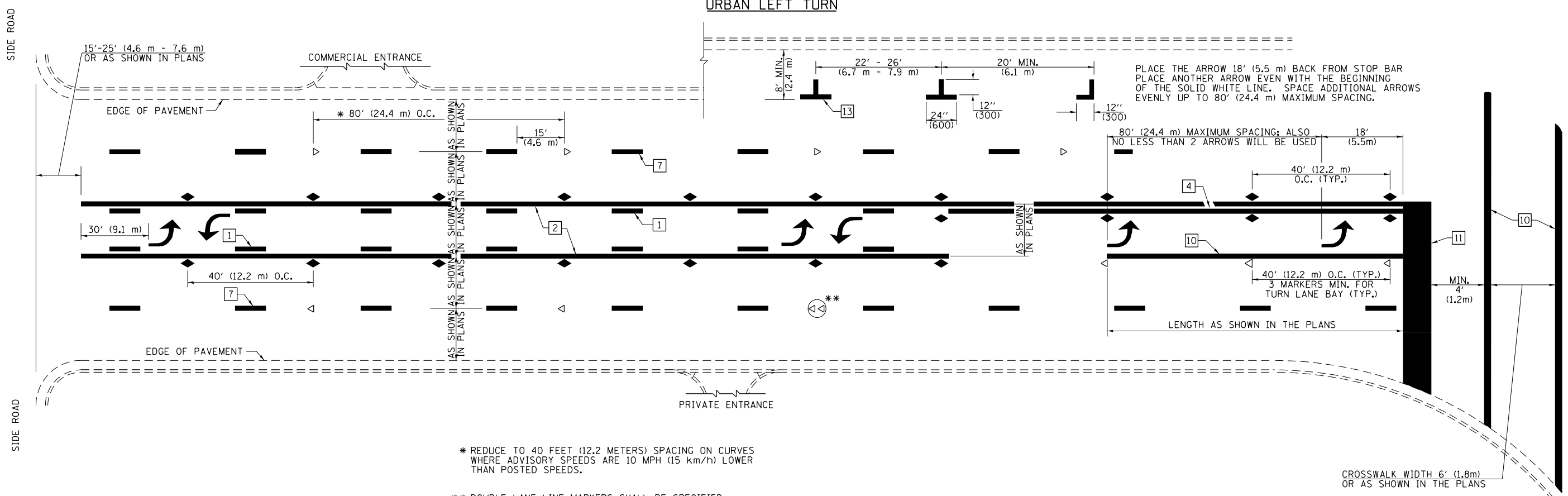

* REDUCE TO 40 FEET (12.2 METERS) SPACING ON CURVES WHERE ADVISORY SPEEDS ARE 10 MPH (15 km/h) LOWER THAN POSTED SPEEDS.

** DOUBLE LANE LINE MARKERS SHALL BE SPECIFIED AND SPACED AS SHOWN IN HIGHWAY STANDARD 781001 FOR MULTI-LANE DIVIDED AND UNDIVIDED HIGHWAYS.

PAVEMENT MARKING LEGEND

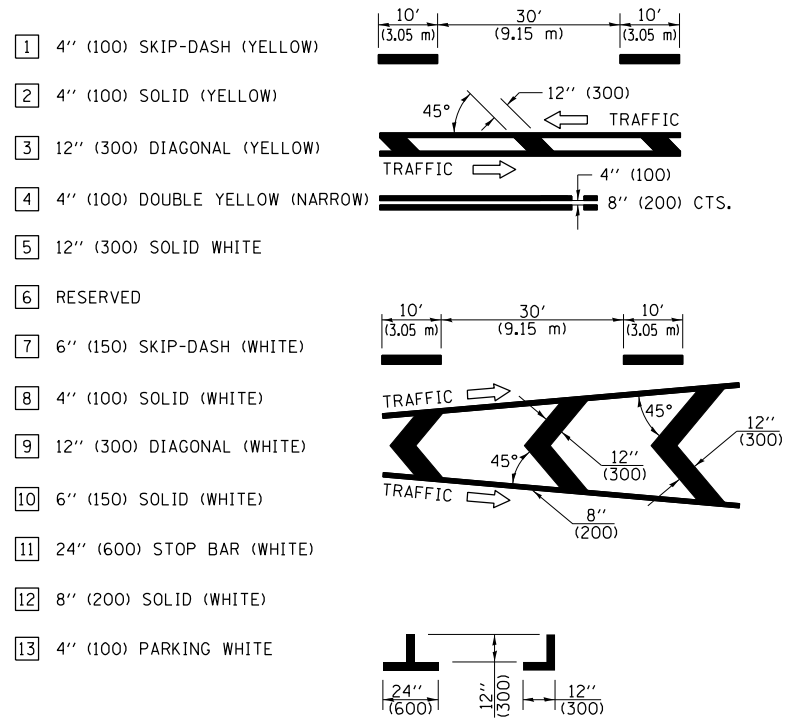

GENERAL NOTES

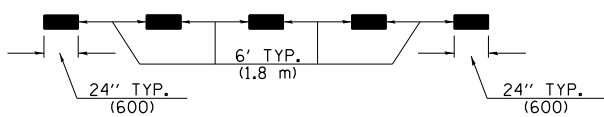
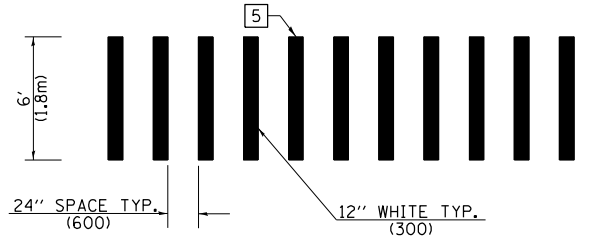
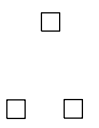

LANE LINE EXTENSIONS

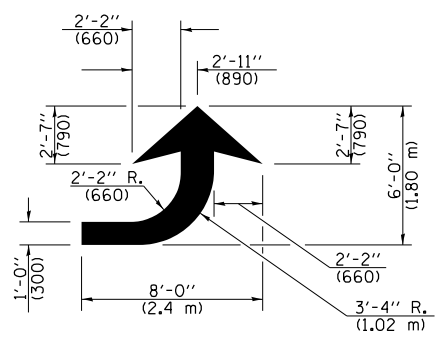

LEFT ARROW

REVERSE FOR RIGHT ARROW
AREA = 15.6 SQ. FT. (1.47 m²)
(WHITE)

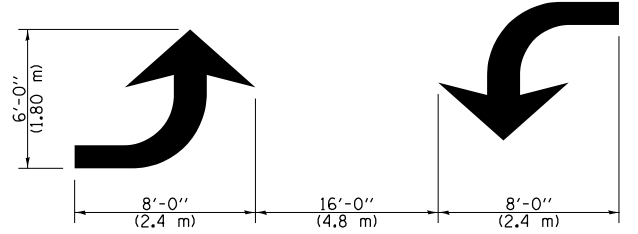

TYPICAL DOUBLE TURN ARROWS (WHITE)

NOT TO SCALE

FILE NAME =	USER NAME = steffenk	DESIGNED -	REVISED -	STATE OF ILLINOIS DEPARTMENT OF TRANSPORTATION	SCALE:	SHEET NO. 2 OF 4 SHEETS	STA.	TO STA.	DISTRICT 7 DETAIL NO. 7800001	
p:\planroom\dot.illinois.gov\PIWIDOT\Documents\IDOT Offices\District 7\Projects\74462\DRAWING\CADsheets\0774462-shd-details.dwg		CHECKED -	REVISED -		F.A.P. RTE.	SECTION	COUNTY	TOTAL SHEETS		SHEET NO.
PLOT SCALE = 5000.0000' / in.		DATE -	REVISED -		320	138R5-3	MACON	12		10
PLOT DATE = 4/2/2021		DATE -	REVISED -		CONTRACT NO. 74462					

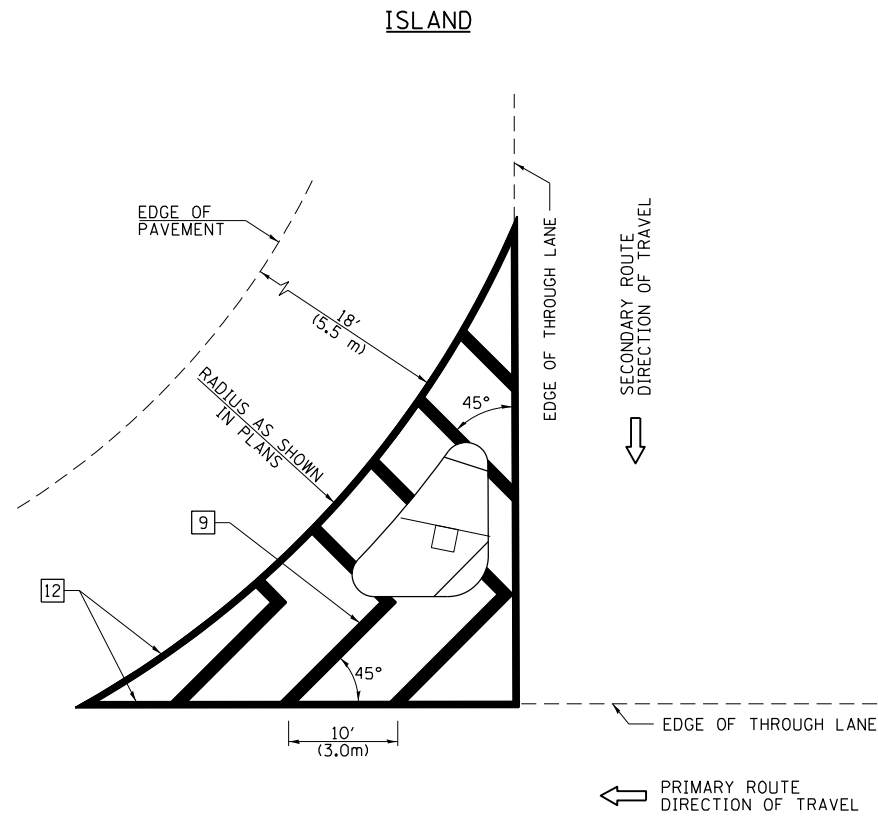

GENERAL NOTES

1. RAISED AND CORRUGATED MEDIANS SHALL BE OUTLINED WITH [2] IF PRESENT.
2. SOME OF THE INFORMATION INCLUDED WITH THIS DETAIL MAY NOT BE APPLICABLE TO THIS IMPROVEMENT.
3. PAVEMENT MARKINGS ARE TO BE EXTENDED THROUGH OMISSIONS WHEN APPLICABLE.
4. FINAL PAVEMENT MARKINGS SHALL BE IN PLACE PRIOR TO PLACING ANY RAISED REFLECTIVE PAVEMENT MARKERS.
5. THE FOLLOWING CRITERIA SHALL BE USED FOR SELECTING THE DIAGONAL PAVEMENT MARKING SPACING:

< 30 MPH (< 50 km/h)	15' (4.5 m)
30-45 MPH (50-75 km/h)	20' (6.0 m)
> 45 MPH (> 75 km/h)	30' (9.0 m)

PAVEMENT MARKING LEGEND

- [1] 4" (100) SKIP-DASH (YELLOW)
- [2] 4" (100) SOLID (YELLOW)
- [3] 12" (300) DIAGONAL (YELLOW)
- [4] 4" (100) DOUBLE YELLOW (NARROW)
- [5] 12" (300) SOLID WHITE
- [6] RESERVED
- [7] 6" (150) SKIP-DASH (WHITE)
- [8] 4" (100) SOLID (WHITE)
- [9] 12" (300) DIAGONAL (WHITE)
- [10] 6" (150) SOLID (WHITE)
- [11] 24" (600) STOP BAR (WHITE)
- [12] 8" (200) SOLID (WHITE)
- [13] 4" (100) PARKING WHITE

RURAL LEFT TURN STRIPING

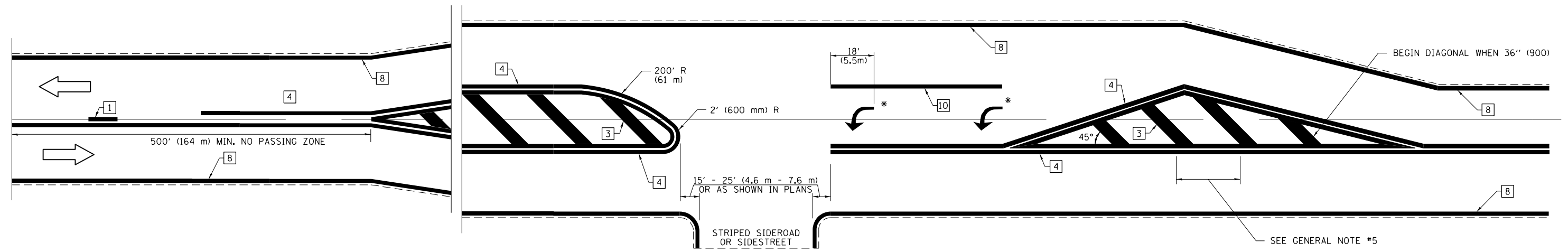

* PLACE AN ARROW 18' (5.5 m) BACK FROM STOP BAR. PLACE ANOTHER ARROW EVEN WITH THE BEGINNING OF THE SOLID WHITE LINE. SPACE ADDITIONAL ARROWS EVENLY UP TO 80' (24.4 m) MAXIMUM SPACING. USE MINIMUM OF 2 ARROWS.

NOT TO SCALE

DISTRICT 7 DETAIL NO. 7800001

FILE NAME =	USER NAME = steffenmk	DESIGNED -	REVISED -
pw:\planning\dot.illinois.gov\PIDOT\Documents\IDOT Offices\District 7\Projects\74462\DRAWN\CADsheets\0774462-sht-details.dgn		REVISOR -	REVISED -
	PLOT SCALE = 5000.0000 ' / in.	CHECKED -	REVISED -
	PLOT DATE = 4/2/2021	DATE -	REVISED -

**STATE OF ILLINOIS
DEPARTMENT OF TRANSPORTATION**

SCALE: SHEET NO. 3 OF 4 SHEETS STA. TO STA.

F.A.P. RTE.	SECTION	COUNTY	TOTAL SHEETS	SHEET NO.
320	138R5-3	MACON	12	11
CONTRACT NO. 74462				
ILLINOIS FED. AID PROJECT				

PAVEMENT MARKINGS AT RAILROAD-HIGHWAY GRADE CROSSING

PAVEMENT MARKING LEGEND

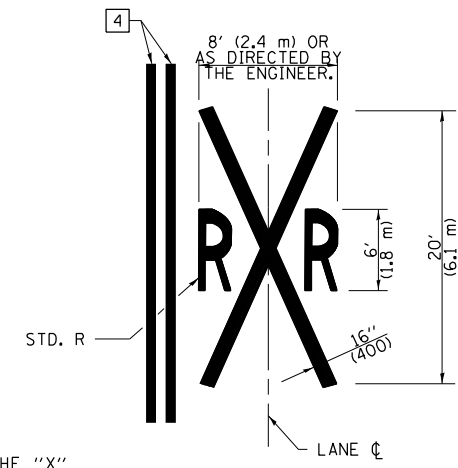
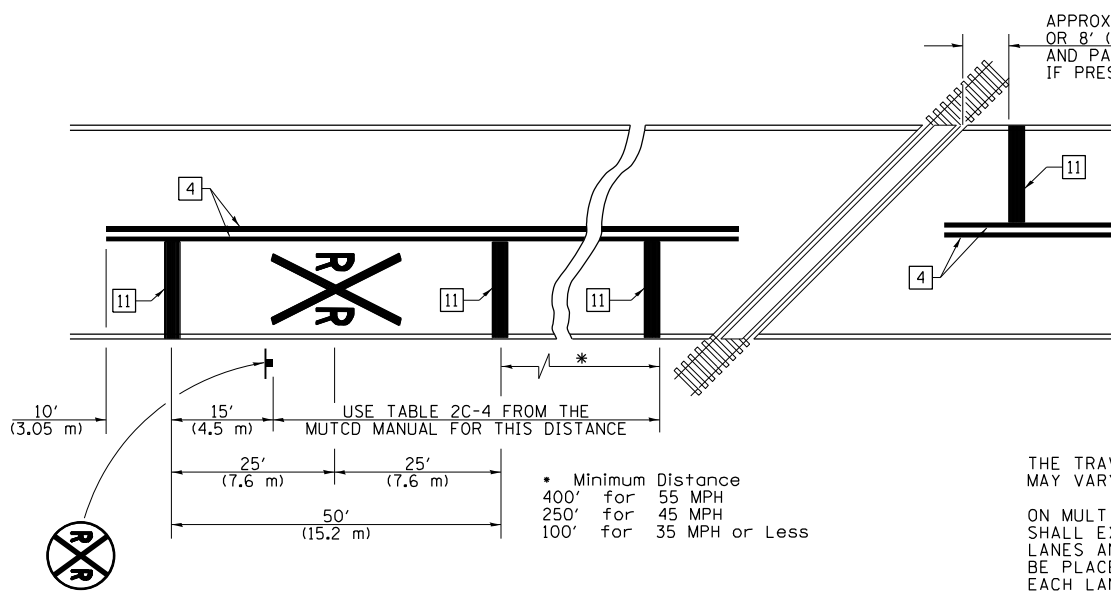

NOTES

THE TRAVERSE SPREAD OF THE "X" MAY VARY ACCORDING TO LANE WIDTH.

ON MULTI-LANE ROADS, THE STOP LINES SHALL EXTEND ACROSS ALL APPROACH LANES AND SEPARATE RXR SYMBOLS SHALL BE PLACED ADJACENT TO EACH OTHER IN EACH LANE.

WHEN THE PAVEMENT MARKING SYMBOL IS USED, A PORTION OF THE SYMBOL SHOULD BE LOCATED DIRECTLY ADJACENT TO THE ADVANCE WARNING SIGN (W10-1) AS PLACED BY TABLE II-1, CONDITION B OF THE MUTCD.

- 1 4" (100) SKIP-DASH (YELLOW)
- 2 4" (100) SOLID (YELLOW)
- 3 12" (300) DIAGONAL (YELLOW)
- 4 4" (100) DOUBLE YELLOW (NARROW)
- 5 12" (300) SOLID WHITE
- 6 RESERVED
- 7 6" (150) SKIP-DASH (WHITE)
- 8 4" (100) SOLID (WHITE)
- 9 12" (300) DIAGONAL (WHITE)
- 10 6" (150) SOLID (WHITE)
- 11 24" (600) STOP BAR (WHITE)
- 12 8" (200) SOLID (WHITE)
- 13 4" (100) PARKING WHITE

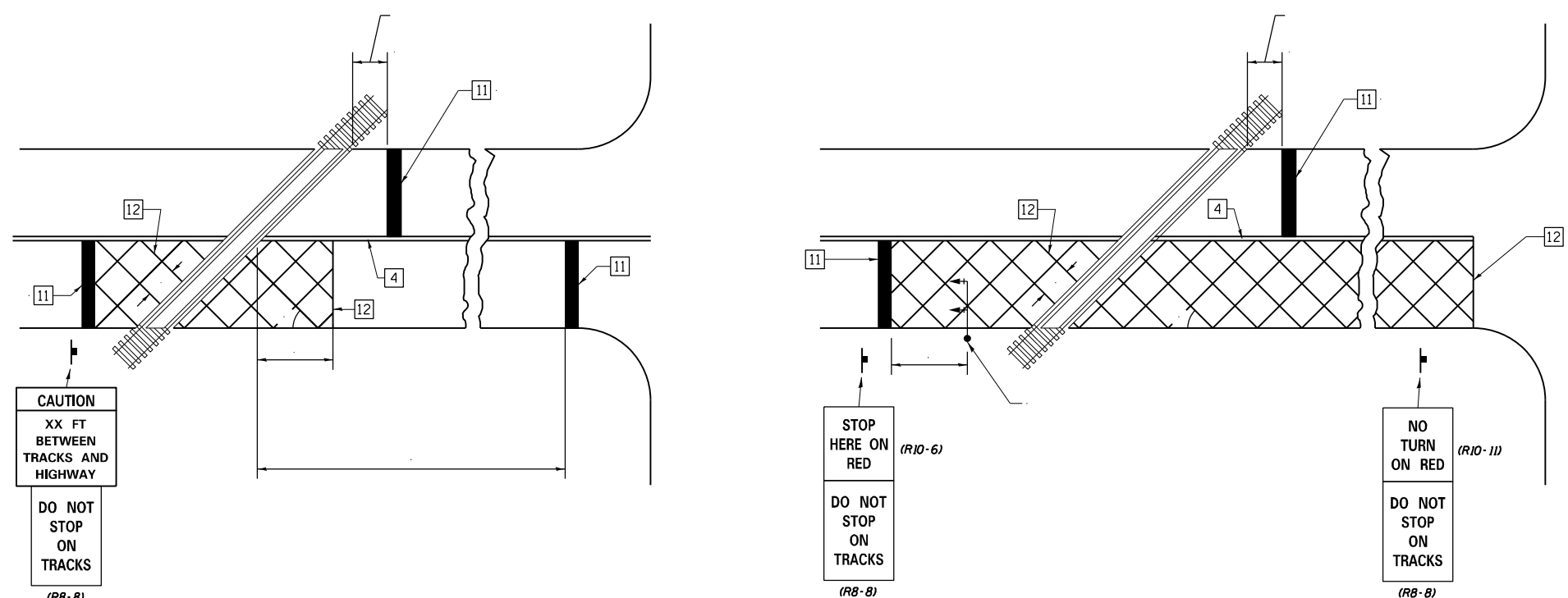
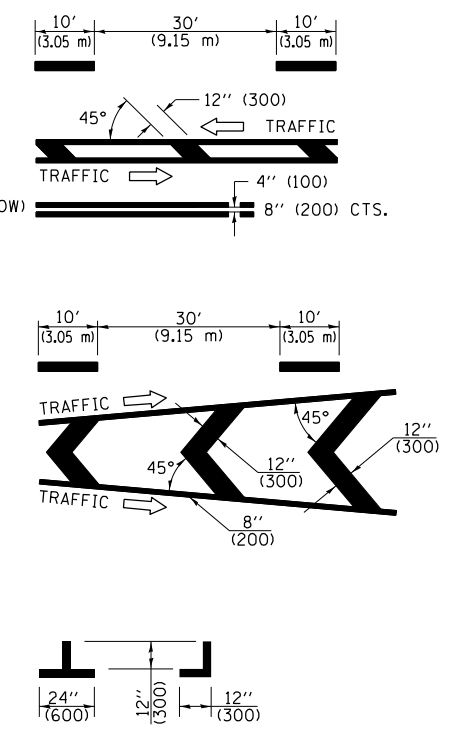

GENERAL NOTES

1. SUPPLEMENTAL PAVEMENT MARKINGS TO BE INSTALLED ONLY ON APPROACHES TO INTERSECTIONS CONTROLLED BY TRAFFIC SIGNALS WHICH ARE INTERCONNECTED WITH THE RAILROAD WARNING SIGNALS.
2. EXTEND PAVEMENT MARKINGS TO THE INTERSECTION ONLY WHERE NEAR-SIDE TRAFFIC SIGNALS ARE USED.

SUPPLEMENTAL PAVEMENT MARKING TREATMENT FOR RAILROAD-HIGHWAY GRADE CROSSING

NOT TO SCALE

FILE NAME =	USER NAME = steffenk	DESIGNED -	REVISED -
pw:\planroom.dot.illinois.gov\PIDOT\Documents\IDOT Offices\District 7\Projects\74462\DRAWN\CADsheets\0774462-sht-details.dgn		CHECKED -	REVISED -
	PLOT SCALE = 5000.0000' / in.	DATE -	REVISED -
	PLOT DATE = 4/2/2021		

STATE OF ILLINOIS
DEPARTMENT OF TRANSPORTATION

SCALE: SHEET NO. 4 OF 4 SHEETS STA. TO STA.

DISTRICT 7 DETAIL NO. 7800001				
F.A.P. RTE.	SECTION	COUNTY	TOTAL SHEETS	SHEET NO.
320	138R5-3	MACON	12	12
CONTRACT NO. 74462				
ILLINOIS FED. AID PROJECT				