

STATE OF ILLINOIS
DEPARTMENT OF TRANSPORTATION

FAI RTE.	SECTION	COUNTY	TOTAL SHEETS	SHEET NO.
70	D7 PATCHING 2021-6	FAYETTE	4	1
		ILLINOIS	CONTRACT NO. 74A53	

FOR INDEX OF SHEETS, SEE SHEET NO. 2

D-97-084-21

AADT(2018) = 1550

PROPOSED HIGHWAY PLANS

FAI ROUTE 70 (I-70)
SECTION D7 PATCHING 2021-6

PAVEMENT PATCHING
FAYETTE COUNTY

C-97-145-21

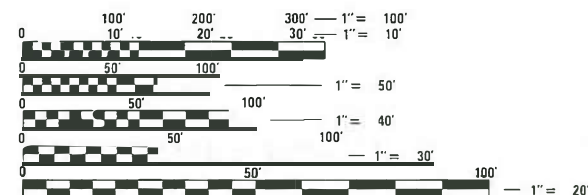
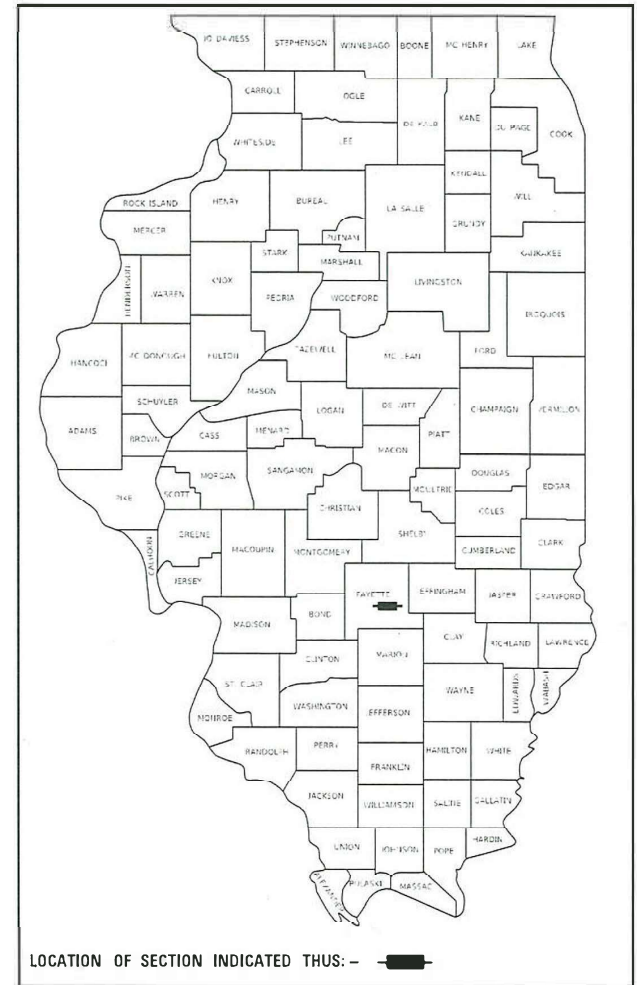

FULL SIZE PLANS HAVE BEEN PREPARED USING STANDARD ENGINEERING SCALES. REDUCED SIZED PLANS WILL NOT CONFORM TO STANDARD SCALES. IN MAKING MEASUREMENTS ON REDUCED PLANS, THE ABOVE SCALES MAY BE USED.

J.U.L.I.E.
JOINT UTILITY LOCATION INFORMATION FOR EXCAVATORS
1-800-892-0123
OR 811

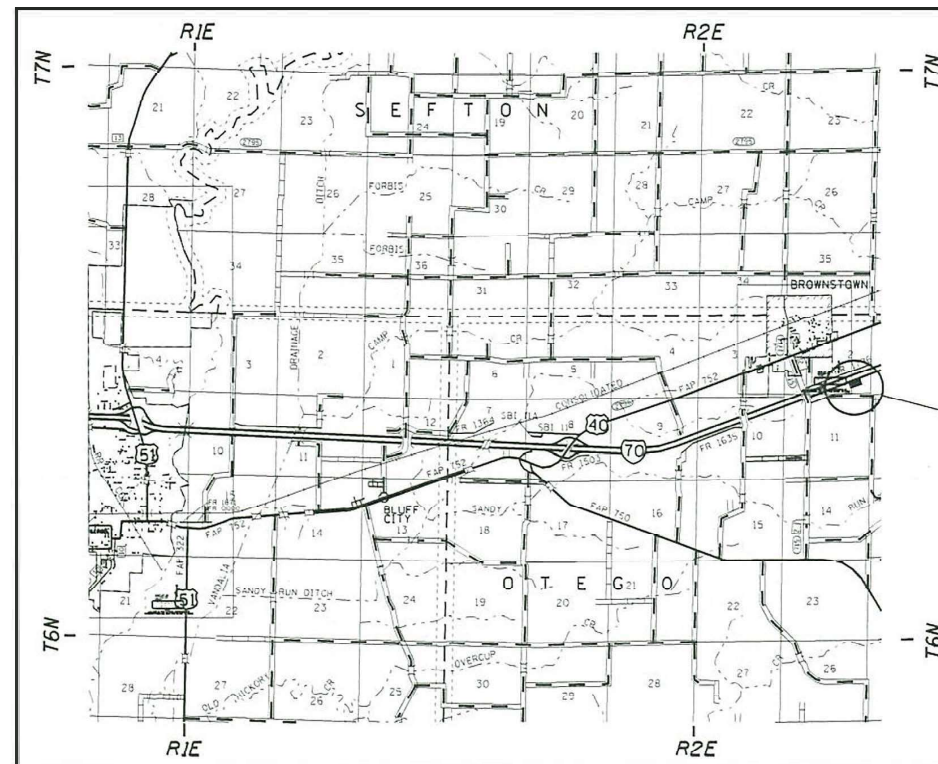

PROJECT LOCATION

GROSS LENGTH = 5596.8 FT. = 1.06 MILE
NET LENGTH = 5596.8 FT. = 1.06 MILE

PROJECT ENGINEER: JACQUELYN SEALS
PROJECT MANAGER: DEBRA BARRETT

CONTRACT NO. 74A53

STATE OF ILLINOIS
DEPARTMENT OF TRANSPORTATION

SUBMITTED March 14 20 21
Jeffrey P. Myer
REGIONAL ENGINEER

May 7, 2021 [Signature]
ENGINEER OF DESIGN AND ENVIRONMENT

May 7, 2021 [Signature]
DIRECTOR OF HIGHWAYS PROJECT IMPLEMENTATION 13

PRINTED BY THE AUTHORITY
OF THE STATE OF ILLINOIS

GENERAL NOTES

THIS PROJECT IS LOCATED AT THE BROWNSTOWN WEIGH STATION ALONG EASTBOUND 1-70 IN FAYETTE COUNTY. THE WORK INCLUDED IN SECTION D7 PATCHING 2021-6 CONSISTS OF PAVEMENT PATCHING, TRAFFIC CONTROL, AND ANY OTHER WORK NECESSARY TO COMPLETE THIS PROJECT.

THE PAVEMENT PATCHES ARE CLASS A & B, AND THE TYPE IS SPECIFIED ON THE PLANS.

THE ACTUAL LOCATIONS OF PAVEMENT PATCHING AND FINAL QUANTITIES SHALL BE DETERMINED BY THE ENGINEER IN THE FIELD.

PATCHING REINFORCEMENT NEEDS TO BE #5 REBAR.

THE RESIDENT ENGINEER SHALL CONTACT THE ILLINOIS STATE POLICE AT THE WEIGH STATION, PHONE NUMBER IS 618-427- 3708, TO INFORM THEM OF THE IMPENDING TEMPORARY CLOSURE OF THE WEIGH STATION.

INDEX OF SHEETS

SHEET NO.	ITEM
1	COVER SHEET
2	GENERAL NOTES, INDEX OF SHEETS & LIST OF STANDARDS
3	SUMMARY OF QUANTITIES
4	PATCHING SCHEDULES

THE FOLLOWING STANDARDS ARE A PART OF THESE PLANS AND ARE INCLUDED AFTER SHEET NO. 4:

STD. NO.	DESCRIPTION
000001-08	STANDARD SYMBOLS, ABBREVIATIONS AND PATTERNS
001001-02	AREAS OF REINFORCEMENT BARS
001006	DECIMAL OF AN INCH AND OF A FOOT
420001-09	PAVEMENT JOINTS
442001-04	CLASS A PATCHES
442101-09	CLASS B PATCHES
701101-05	OFF-ROAD OPERATIONS, MULTILANE, 15' (4.5M) TO 24" (600MM) FROM PAVEMENT EDGE
701451-05	RAMP CLOSURE, FREEWAY/EXPRESSWAY
701901-08	TRAFFIC CONTROL DEVICES
420701-03	PAVEMENT WELDED WIRE REINFORCEMENT

REV. - MS

MODEL: Default
FILE NAME: \\gis\arcswbem_data\illinois.gov\FWD\DOT\Documents\DOT\Projects\District 3\Projects\74A53\CAD\Sheet\074A53-ht-ctenote.dgn

USER NAME	* stefenmk	DESIGNED	-	REVISED	-
DRAWN	-	REVISED	-		
PLOT SCALE	100.0000' / 1"	CHECKED	-	REVISED	+
PLOT DATE	3/17/2021	DATE		REVISED	

**STATE OF ILLINOIS
DEPARTMENT OF TRANSPORTATION**

INDEX OF SHEETS & GENERAL NOTES

F.A. RTE.	SECTION	COUNTY	TOTAL SHEETS	SHEET NO.
10	D7 PATCHING 2021-6	FAYETTE	4	2
		CONTRACT NO. 74A53		

100% STATE

SUMMARY OF QUANTITIES			TOTAL QUANTITIES	CONSTRUCTION TYPE CODE		
CODE NO	ITEM	UNIT		0006		
44200050	WELDED WIRE REINFORCEMENT	SQ YD	1009.8	1009.8		
44200577	CLASS A PATCHES, TYPE II, 12 INCH	SQ YD	32.1	32.1		
44200581	CLASS A PATCHES, TYPE III, 12 INCH	SQ YD	17.8	17.8		
44201048	CLASS B PATCHES, TYPE IV, 16 INCH	SQ YD	1009.8	1009.8		
44201299	DOWEL BARS 1 1/2"	EACH	558	558		
44213000	PATCHING REINFORCEMENT	SQ YD	49.9	49.9		
44213200	SAW CUTS	FOOT	1519.5	1519.5		
44213204	TIE BARS 3/4"	EACH	188	188		
67100100	MOBILIZATION	L SUM	1	1		
70100820	TRAFFIC CONTROL AND PROTECTION, STANDARD	L SUM	1	1		
	701451					

SUMMARY OF QUANTITIES			TOTAL QUANTITIES	CONSTRUCTION TYPE CODE		
CODE NO	ITEM	UNIT				

MODEL Path: \\pblun00001\pblun00001\IllinoisDOT\Documents\BIDT_Offices\Bids\ref_7\Project\74A53\CADData\CAD\Sheet\074A53-dts-500.dgn
FILE NAME: \\pblun00001\pblun00001\IllinoisDOT\Documents\BIDT_Offices\Bids\ref_7\Project\74A53\CADData\CAD\Sheet\074A53-dts-500.dgn

USER NAME = steffenmk	DESIGNED -	REVISED -
PLOT SCALE = 100,0000 ' / in.	DRAWN -	REVISED -
PLOT DATE = 3/17/2021	CHECKED -	REVISED -
	DATE -	REVISED -

**STATE OF ILLINOIS
DEPARTMENT OF TRANSPORTATION**

SUMMARY OF QUANTITIES			
SCALE:	SHEET	OF	SHEETS
	STA.	TO	STA.

F.A.J. RTE.	SECTION	COUNTY	TOTAL SHEETS	SHEET NO.
70	D7 PATCHING 2021-6	FAYETTE	4	3
			CONTRACT NO. 74A53	
		ILLINOIS	FED. AID PROJECT	

Class A Patches									
Patch Number	Lane	Station	Length FT	Width FT	Plan Depth IN	44200577 Type 2, 12" SY	44200581 Type 3, 12" SY	44213000 Patch Rebar SY	44213200 Saw Cut FT
1	Scale	4+50	6.0	16.0	12.0	10.7		10.7	77.5
2	Scale	6+68	6.0	16.0	12.0	10.7		10.7	77.5
3	Scale	8+60	6.0	16.0	12.0	10.7		10.7	77.5
4	Scale	15+71	10.0	16.0	12.0		17.8	17.8	85.5
Total:						32.1	17.8	49.9	318.0

Class B Patches										
Patch Number	Lane	Station	Length FT	Width FT	Plan Depth IN	44201048 Type 4, 16" SY	44201299 Dowel Bars EACH	44213204 Tie Bars EACH	44200050 WWR SY	44213200 Saw Cut FT
5	Bypass	29+29	568.0	16.0	16.0	1009.8	558.0	188.0	1009.8	1201.5
Total:						1009.8	558.0	188.0	1009.8	1201.5

Note-Station 0+00 starts at bare concrete as you enter weigh station.

MODEL: Default
 FILE NAME: \\paulhammon.dot.illinois.gov\PIWDOT\Documents\DOT_Offices\District 7\Projects\7A53\CADD\DATA\CAD\patches\077A53-ah-schedule.dgn

USER NAME = steffenmk	DESIGNED -	REVISED -
	DRAWN -	REVISED -
PLOT SCALE = 100,0000 ' / in.	CHECKED -	REVISED -
PLOT DATE = 3/17/2021	DATE -	REVISED -

**STATE OF ILLINOIS
DEPARTMENT OF TRANSPORTATION**

SCHEDULE OF QUANTITIES

SCALE: SHEET OF SHEETS STA. TO STA.

F.A.J. RTE.	SECTION	COUNTY	TOTAL SHEETS	SHEET NO.
70	D7 PATCHING 2021-6	FAYETTE	4	4
			CONTRACT NO. 74A53	
			ILLINOIS FED. AID PROJECT	