

ELEVATION
NOT TO SCALE

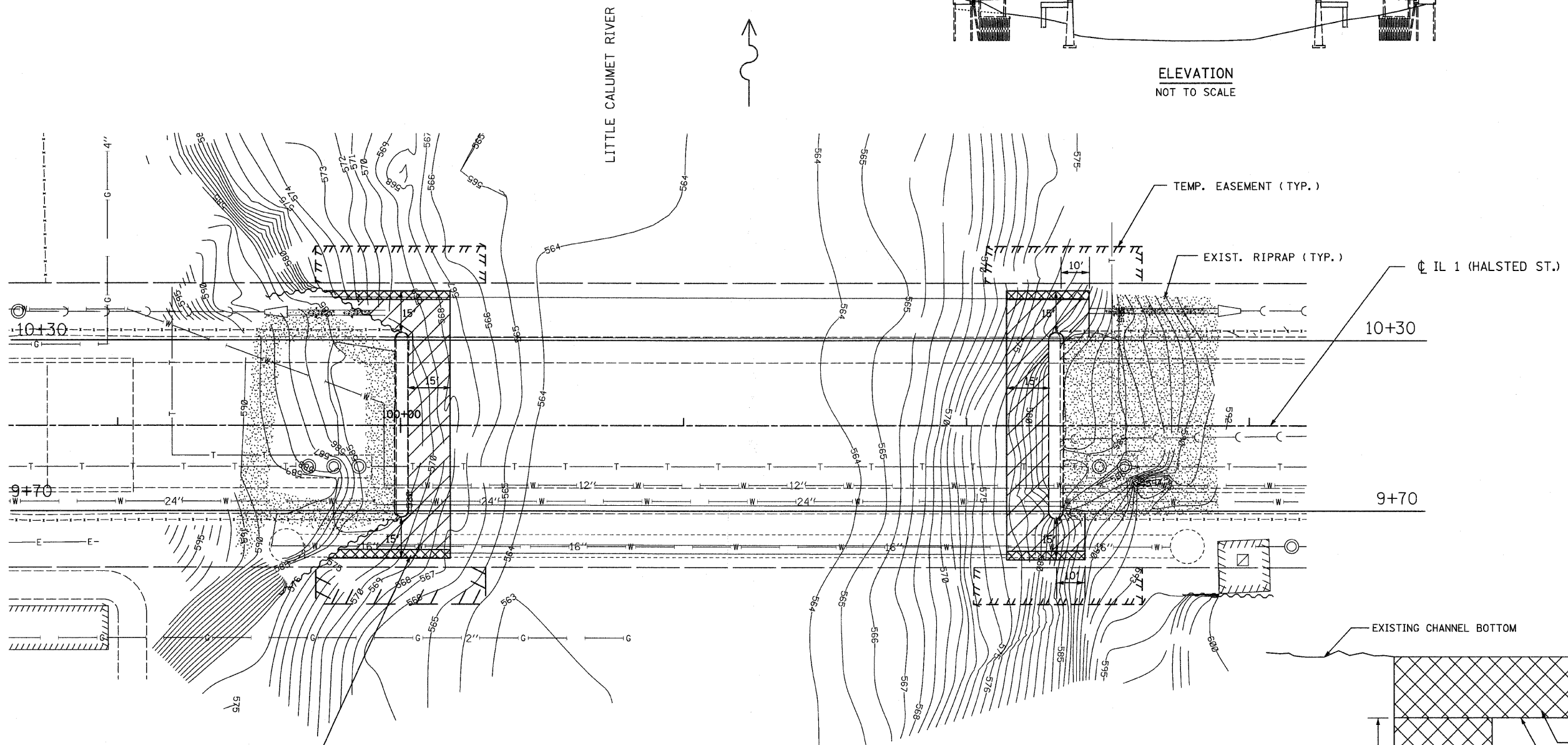

LITTLE CALUMET RIVER

TEMP. EASEMENT (TYP.)

EXIST. RIPRAP (TYP.)

CL IL 1 (HALSTED ST.)

GABION/SLOPE MATTRESS
PLACEMENT (SEE DETAIL)

PLAN
SCALE: 1" = 20'

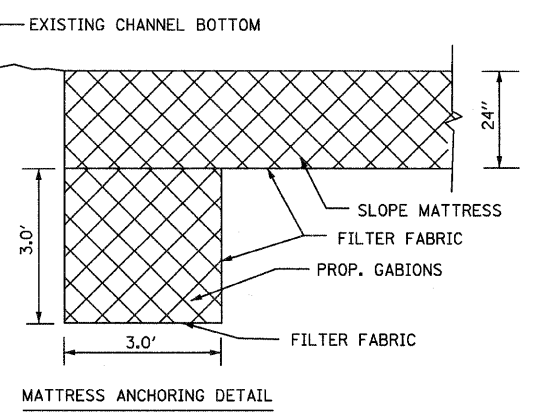

MATTRESS ANCHORING DETAIL

LEGEND

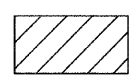
 SLOPE MATTRESS (2.0' THICK)

BM 1: FOUND R.R. SPIKE IN POWER POLE W---
WEST OF HALSTED ON ---ROAD TO MARINA
EL. = 591.72

NOTE:
1. FOR CROSS SECTIONS SEE SHEET NO. 24 & 25.
2. FOR PLAT OF HIGHWAYS SEE SHEET NO. 18.

FILE NAME = D168---sht-eros.dgn
PLOT DATE = 1/30/2009

CHRISTIAN-ROGE & ASSOCIATES, INC.
ENGINEERS-PLANNERS-SURVEYORS
211 WEST WACKER DRIVE
CHICAGO, ILLINOIS 60606
PHONE: (312)372-2023 FAX: (312)372-5274

DESIGNED - G.F.L.	REVISED -
DRAWN - B.K.	REVISED -
CHECKED - E.J.M.	REVISED -
DATE - JANUARY 2009	REVISED -

STATE OF ILLINOIS
DEPARTMENT OF TRANSPORTATION

EROSION AND SEDIMENT CONTROL PLAN
IL 1 (HALSTED STREET) OVER LITTLE CALUMET RIVER

SCALE: 1" = 20' SHEET NO. 2 OF 2 SHEETS STA. 99+00 TO STA. 103+00

F.A.P. RTE. VAR.	SECTION 2006-005 I	COUNTY COOK	TOTAL SHEETS 31	SHEET NO. 14
CONTRACT NO. 60B22				
FED. ROAD DIST. NO. 1 ILLINOIS FED. AID PROJECT				