

STATE OF ILLINOIS
DEPARTMENT OF TRANSPORTATION
DIVISION OF HIGHWAYS

PROPOSED HIGHWAY PLANS

FAP 337 (IL 22 - HALF DAY ROAD)
SECTION (19 & 20) LS-5
WO FAP 334 (US 12 - RAND ROAD) TO E/O QUENTIN ROAD
LANDSCAPING
LAKE COUNTY

C-91-130-09
PROJECT: NHF-0337(009)

ELA TOWNSHIP
SW 1/4, T 43 N, R 10 E

| F.A.P. RTE. | SECTION | COUNTY | TOTAL SHEETS | SHEET NO. |
|-----------------------|----------------|----------------|------------------|-----------|
| 337 | (19 & 20) LS-5 | LAKE | 17 | 1 |
| FED. ROAD DIST. NO. 1 | | ILLINOIS | FED. AID PROJECT | |
| D-91-130-99 | | CONTRACT 60F55 | | |

FOR INDEX OF SHEETS,
SEE SHEET NO. 2

PROJECT IS LOCATED
IN LAKE ZURICH

SCALE: 1:500

METRIC RATIOS

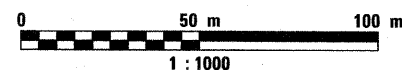
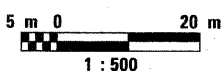
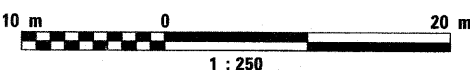
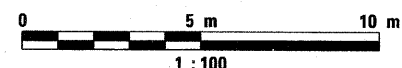
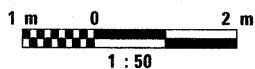

FULL SIZE PLANS HAVE BEEN PREPARED USING STANDARD
ENGINEERING SCALES, REDUCED SIZED PLANS WILL NOT
CONFORM TO STANDARD SCALES, IN MAKING MEASUREMENTS
ON REDUCED PLANS, THE ABOVE SCALES MAY BE USED.

J.U.L.I.E.
JOINT UTILITY LOCATION INFORMATION FOR EXCAVATION
1-800-892-0123

PROJECT BEGINS
STA. 7+600

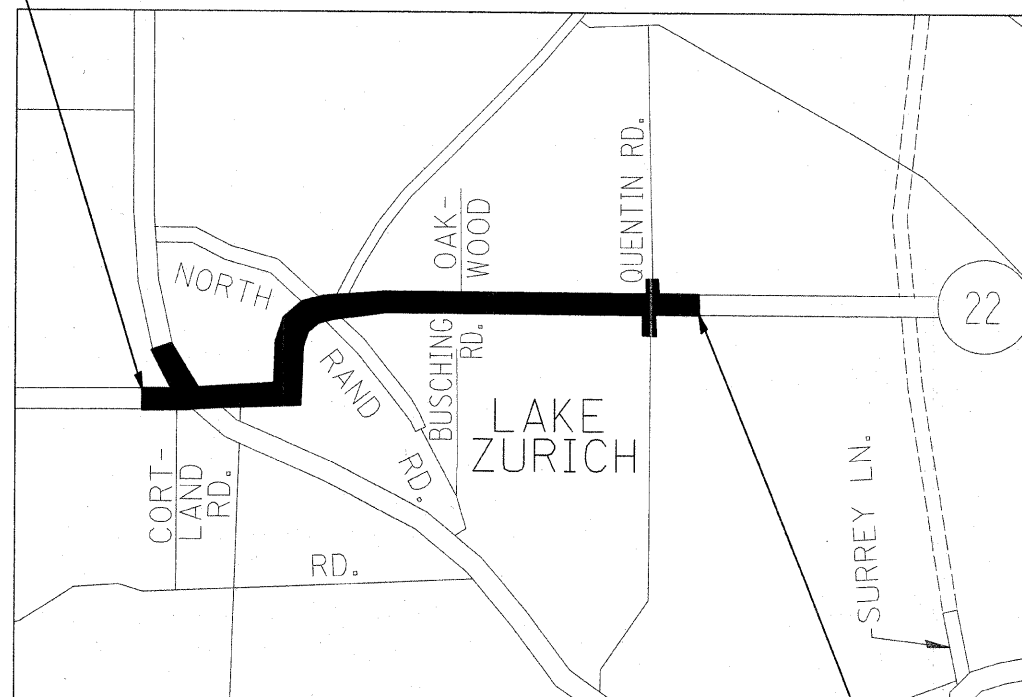

PROJECT LENGTH = 1.6 MILES

PROJECT ENDS
STA. 12+875

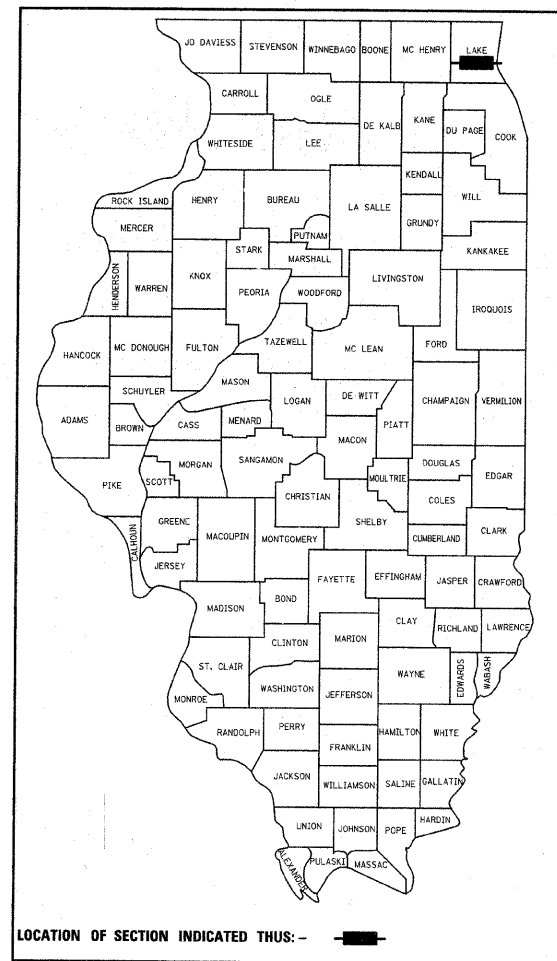

LOCATION OF SECTION INDICATED THUS: -

STATE OF ILLINOIS
DEPARTMENT OF TRANSPORTATION
DIVISION OF HIGHWAYS

SUBMITTED March 25, 20 09
Dave O'Neil
DEPUTY DIRECTOR OF HIGHWAYS, REGION ENGINEER
May 8, 20 09
Charles J. Ingersoll
ENGINEER OF DESIGN AND ENVIRONMENT
May 8, 20 09
Christine M. Reed
DIRECTOR OF HIGHWAYS, CHIEF ENGINEER

DISTRICT ONE BUREAU OF MAINTENANCE: J. STUMPNER
MAINTENANCE LANDSCAPE DESIGNER: R. WANNER /M. DEL ROSARIO (847) 705-4171

CONTRACT NO. 60F55

TRAFFIC DATA
US 12 (RAND RD) TO QUENTIN RD
2009 ADT = 14,200
POSTED SPEED LIMIT = 40 MPH

PRINTED BY THE AUTHORITY
OF THE STATE OF ILLINOIS