

TYPICAL ENTRANCE/EXIT RAMP COMBINATION PAVEMENT MARKINGS

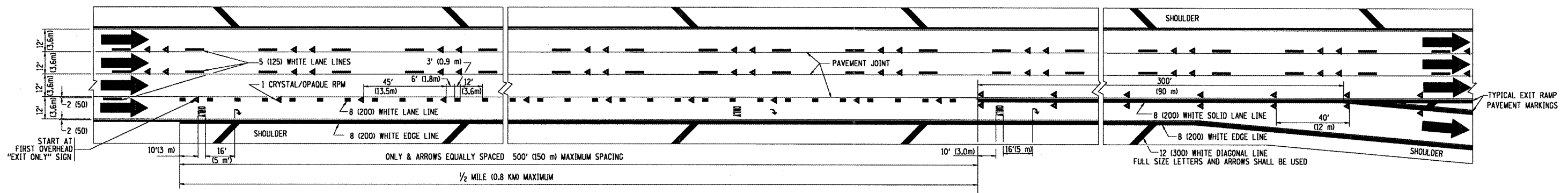

TYPICAL EXIT ONLY LANE PAVEMENT MARKINGS

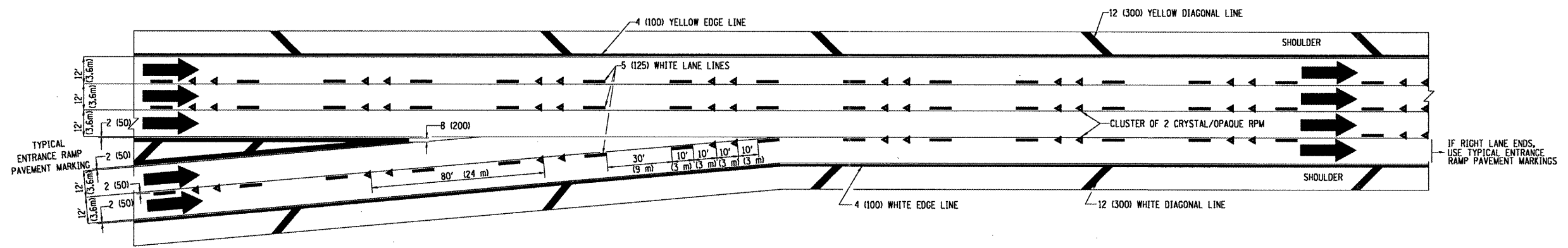

TYPICAL TWO LANE ENTRANCE RAMP PAVEMENT MARKINGS

FILE NAME =	USER NAME = wilgreendp	DESIGNED - D.W.S.	REVISED - A.H. 03-96	STATE OF ILLINOIS DEPARTMENT OF TRANSPORTATION	MULTI-LANE FREEWAY PAVEMENT MARKING DETAILS			F.A. RTE. = 290	SECTION = 2009-030 PP	COUNTY = Cook + Dup.	TOTAL SHEETS = 15	SHEET NO. = 14
α\pwork\pwork\wilgreendp\0125109\0125109.dgn		DRAWN -	REVISED - D.W.S. 07-96		SCALE: NONE	SHEET NO. 2 OF 2 SHEETS	STA. TO STA.	FED. ROAD DIST. NO. 1 ILLINOIS FED. AID PROJECT				
PLOT SCALE = 1/8" = 1' / IN.		CHECKED -	REVISED - J.A.F. 02-06		CONTRACT NO. 60629							
PLOT DATE = 3/14/2009		DATE - 01-90	REVISED - S.P.B. 01-07									