

PROFILE SURVEYED BY DATE
 NOTE BOOK NO. 10/10/09
 PROFILE NO. 10/10/09
 CHECKED BY DATE
 DATE 10/10/09
 CHECKED BY DATE
 DATE 10/10/09

CHRISTOPHER B. BURKE ENGINEERING LTD.
 9575 West Higgins Road, Suite 600
 Rosemont, Illinois 60018
 (847) 823-0500

N:\idct\980040\Task_FF-HH_IL_19_Safet\Tcoffra\T08_138\Westview.dgn

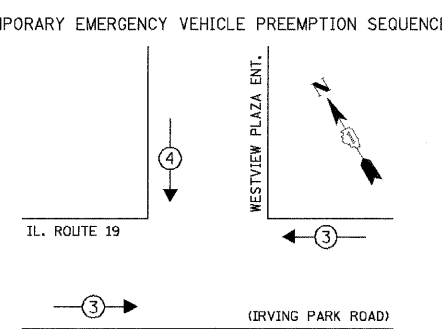
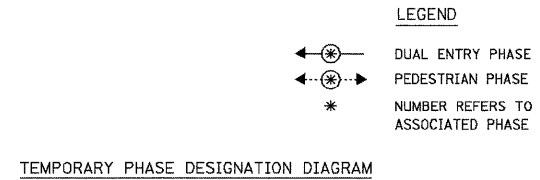
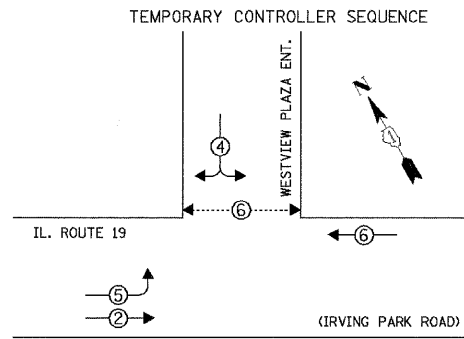

TEMPORARY EMERGENCY VEHICLE PREEMPTORS		
EMERGENCY VEHICLE PREEMPTOR	3	4
MOVEMENT	←	↓

LEGEND
 ← ⊕ → DUAL ENTRY PHASE
 ← ⊕ → PEDESTRIAN PHASE
 * NUMBER REFERS TO ASSOCIATED PHASE

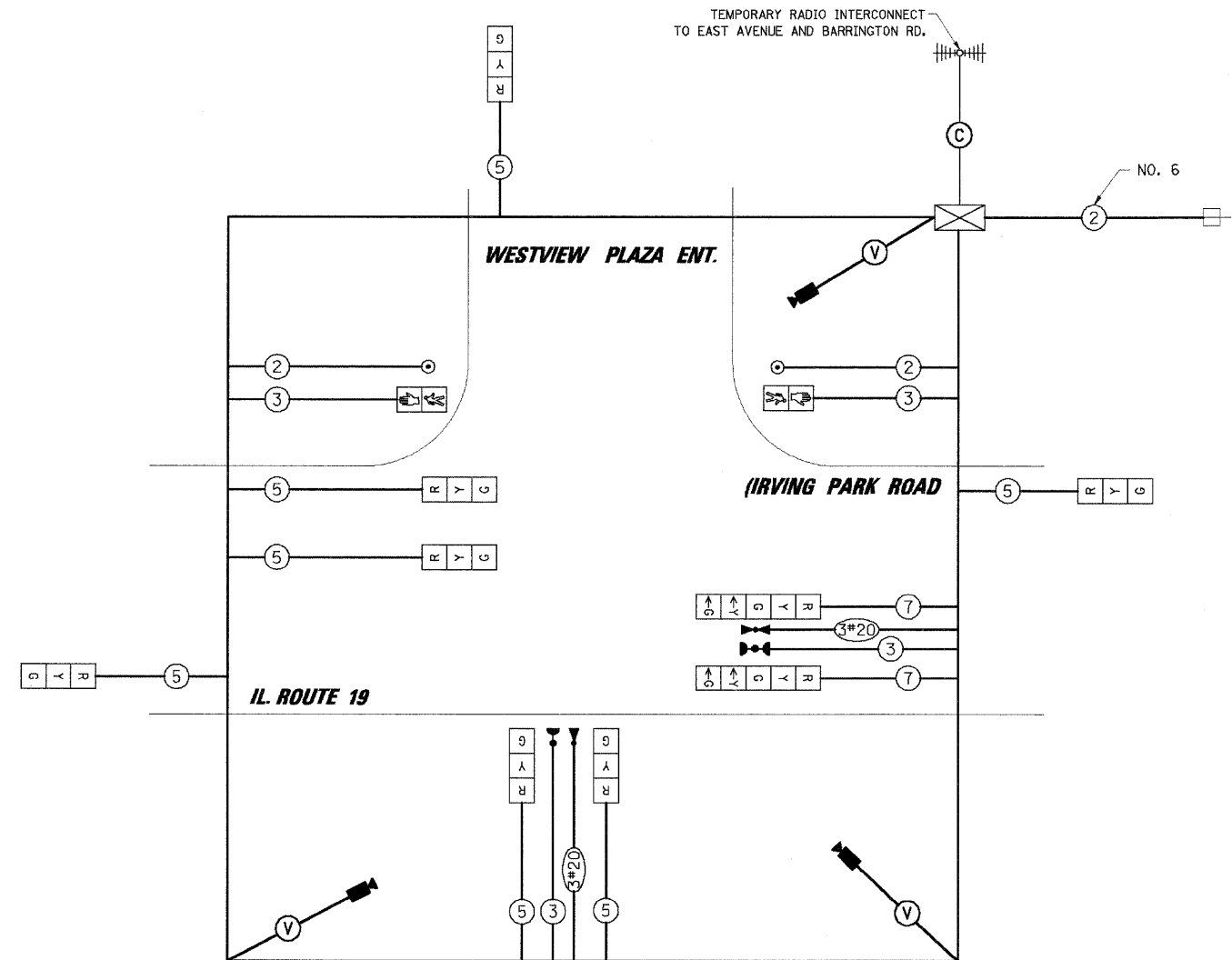

- TEMPORARY CABLE DIAGRAM LEGEND**
- ⊕ TEMPORARY TRAFFIC SIGNAL SECTION OR PEDESTRIAN SIGNAL SECTION 12" (300mm)
 - ⊞ TEMPORARY CONTROLLER CABINET
 - ⊞ TEMPORARY SERVICE INSTALLATION
 - ⑤ INDICATES NUMBER OF CONDUCTORS IN CABLE. ALL CONDUCTORS TO BE NUMBER 14 AWG WIRE UNLESS OTHERWISE NOTED.
 - ▶ EMERGENCY VEHICLE LIGHT DETECTOR
 - ▶ CONFIRMATION BEACON
 - VEHICLE DETECTOR, INDUCTION LOOP
 - ⊙ PEDESTRIAN PUSHBUTTON DETECTOR
 - ⊞ 12" (300mm) PEDESTRIAN SIGNAL SECTION
 - ▶ VIDEO DETECTION CAMERA
 - ⊞ VENDOR CABLE
 - ⊞ TEMPORARY RADIO INTERCONNECT
 - ⊞ COAXIAL CABLE

NOTE:
 THE TRAFFIC SIGNAL CONTROLLER EQUIPMENT FOR THIS PROJECT SHALL BE "ECONOLITE" TO MATCH THE EXISTING ADJACENT SYSTEM.

RESTORATION OF WORK AREA, RESTORATION OF THE TRAFFIC SIGNAL WORK AREA SHALL BE INCIDENTAL TO THE RELATED PAY ITEM SUCH AS FOUNDATION, CONDUIT, HANDHOLE, TRENCH AND BACKFILL, ETC., AND NO EXTRA COMPENSATION SHALL BE ALLOWED. ALL ROADWAY SURFACES SUCH AS SHOULDERS, MEDIANS, SIDEWALKS, PAVEMENT, ETC. SHALL BE REPLACED IN KIND. ALL DAMAGE TO MOWED LAWNS SHALL BE REPLACED WITH AN APPROVED SOD, AND ALL DAMAGE TO UNMOWED FIELDS SHALL BE SEEDING IN ACCORDANCE WITH STANDARD SPECIFICATIONS 252 AND 250 RESPECTIVELY.

I.D.O.T. TRAFFIC SIGNAL INSTALLATION ELECTRICAL SERVICE REQUIREMENTS					TOTAL WATTAGE
TYPE	NO. OF LAMPS	WATTAGE			
		XINCAND.	LED	X % OPERATION	
SIGNAL (RED)	9		17	0.50	76.50
(YELLOW)	9		25	0.25	56.25
(GREEN)	9		15	0.25	33.75
ARROW	4		12	0.10	4.80
PED. SIGNAL	2		25	1.00	50.00
CONTROLLER	1		100	1.00	100.00
ILLUM. SIGN	-		25	0.05	-
VIDEO SYSTEM	1	150	-	1.00	150.00
FLASHER					0.50
TOTAL =					471.30

FOUNDATION (DEPTH)	FT. (m)	CABLE SLACK	FT. (m)	VERTICAL	FT. (m)
TYPE A - POST	4 (1.2)	HANDHOLE	6.5 (2.0)	ALL FOUNDATIONS	3.5 (1.0)
C - CONTROLLER W/ UPS	4 (1.2)	DOUBLE HANDHOLE	13 (4.0)	MAST ARM (L) POLE	20'-H-2'=(6m+L-0.6m)=
D - CONTROLLER	4 (1.2)	SIGNAL POST	2 (1.0)	BRACKET MOUNTED	13 (4.0)
E - M. ARM POLE		CONTROLLER CAB.	1 (0.5)	PED. PUSHBUTTON	6 (1.8)
30" (750mm)	15 (4.6)	FIBER OPTIC	13 (4.0)	ELECTRIC SERVICE	13.5 (4.1)
36" (900mm)	15 (4.6)	ELECTRIC SERVICE	1 (0.5)	SERVICE TO GROUND	13.5 (4.1)
42" (1050mm)	25 (7.6)	GROUND CABLE	1 (0.5)	POST MOUNTED	6 (1.8)

ILLINOIS DEPARTMENT OF TRANSPORTATION
 DIVISION OF HIGHWAY/DISTRICT 1
 201 WEST CENTER COURT/SCHAUMBURG, ILLINOIS 60196-1096
 ENERGY SUPPLY: CONTACT: MARTY RUBIN
 PHONE: (847) 608-2400
 COMPANY: COMED

FILE NAME =	USER NAME = FPAIONE	DESIGNED - ABR	REVISED -
...Tcoffra\T08_138\Westview.dgn		DRAWN - FPB / FCP	REVISED -
		CHECKED - MJT	REVISED -
		DATE -	REVISED -

STATE OF ILLINOIS
DEPARTMENT OF TRANSPORTATION

TEMPORARY CABLE PLAN, TEMPORARY PHASE DESIGNATION DIAGRAM AND TEMPORARY EMERGENCY VEHICLE PREEMPTION SEQUENCE
IL ROUTE 19 (IRVING PARK ROAD) AND WESTVIEW PLAZA ENTRANCE

F.A.U. RTE.	SECTION	COUNTY	TOTAL SHEETS	SHEET NO.
1321	2009-034 TS	COOK	45	6
CONTRACT NO. 60G39				
SCALE: N.T.S.		SHEET NO. OF SHEETS		STA. TO STA.
FED. ROAD DIST. NO.		ILLINOIS FED. AID PROJECT		