

THE FOLLOWING ITEMS SHALL BE REMOVED BY THE CONTRACTOR AND SHALL BE DISPOSED OF BY THEM OUTSIDE THE RIGHT-OF-WAY AT THEIR EXPENSE. THE SALVAGE VALUE OF THE REMOVED EQUIPMENT SHALL BE REFLECTED IN THE CONTRACT BID PRICE.

- 1 EACH CONTROLLER
- 5 EACH SIGNAL HEAD, 1-FACE, 3-SECTION
- 2 EACH SIGNAL HEAD, 1-FACE, 5-SECTION
- 1 EACH SIGNAL HEAD, 2-FACE, 3-SECTION
- 2 EACH TRAFFIC SIGNAL BACKPLATE
- 3 EACH TRAFFIC SIGNAL POST
- 2 EACH COMBINATION MAST ARM ASSEMBLY AND POLE
- 1 EACH SERVICE INSTALLATION

NOTE:
RELOCATE EXISTING MAST ARM MOUNTED SIGNS TO NEW MAST ARM.

SIGN "A"



R10-11B
30"x 30"

SIGN "B"



R1-1
30"x 30"

(HORIZONTAL FOLDING SIGN WITH "DRIVE CAREFULLY" MESSAGE ON BACK WHEN FOLDED)

DETAIL "B"

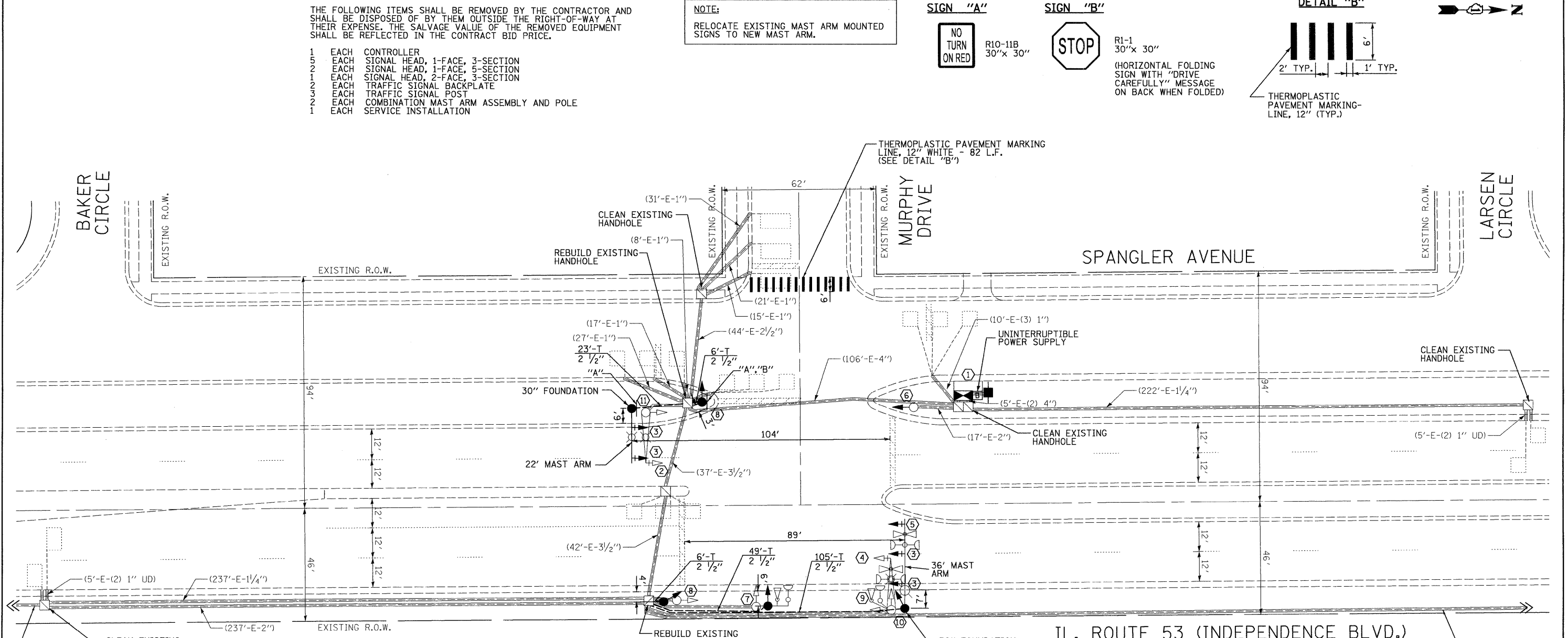
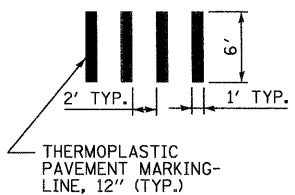

- REMOVAL AND INSTALLATION NOTES:**
- 1) REMOVE EXISTING CONTROLLER. INSTALL NEW FULL-ACTUATED CONTROLLER IN EXISTING CABINET. INSTALL 4 FT CONCRETE MAINTENANCE PAD (SEE DETAIL "A" THIS SHEET). INSTALL UPS.
 - 2) REMOVE EXISTING SIGNAL HEAD, 1-FACE 3-SECTION, MAST ARM MOUNTED.
 - 3) INSTALL NEW SIGNAL HEAD, LED, 1-FACE 3-SECTION, MAST ARM MOUNTED.
 - 4) REMOVE EXISTING SIGNAL HEAD, 1-FACE 5-SECTION, MAST ARM MOUNTED.
 - 5) INSTALL NEW SIGNAL HEAD, LED, 1-FACE 5-SECTION, MAST ARM MOUNTED.
 - 6) REMOVE EXISTING SIGNAL HEAD, 1-FACE 5-SECTION, BRACKET MOUNTED. INSTALL NEW SIGNAL HEAD, LED, 1-FACE 5-SECTION, BRACKET MOUNTED.
 - 7) REMOVE EXISTING SIGNAL HEAD, 1-FACE 3-SECTION, BRACKET MOUNTED. REMOVE EXISTING TRAFFIC SIGNAL POST AND EXISTING CONCRETE FOUNDATION. INSTALL NEW TRAFFIC SIGNAL POST, 18 FT ON NEW FOUNDATION AT PROPOSED LOCATION AS SHOWN IN PLAN. INSTALL NEW SIGNAL HEAD, LED, 1-FACE 3-SECTION, BRACKET MOUNTED.
 - 8) REMOVE EXISTING SIGNAL HEAD, 1-FACE 3-SECTION, BRACKET MOUNTED. REMOVE EXISTING TRAFFIC SIGNAL POST AND EXISTING CONCRETE FOUNDATION. INSTALL NEW TRAFFIC SIGNAL POST, 14 FT ON NEW FOUNDATION AT PROPOSED LOCATION AS SHOWN IN PLAN. INSTALL NEW SIGNAL HEAD, LED, 1-FACE 3-SECTION, BRACKET MOUNTED.
 - 9) REMOVE AND REINSTALL EXISTING EMERGENCY VEHICLE PREEMPTION LIGHT DETECTOR AND CONFIRMATION BEACON ON 18 FT TRAFFIC SIGNAL POST AS SHOWN IN PLAN.
 - 10) REMOVE EXISTING SIGNAL HEAD, 2-FACE, 3-SECTION, BRACKET MOUNTED. REMOVE AND REINSTALL EXISTING EMERGENCY VEHICLE PREEMPTION LIGHT DETECTOR AND CONFIRMATION BEACON ON NEW MAST ARM. REMOVE AND REINSTALL EXISTING LUMINAIRE ON NEW COMBINATION POLE. REMOVE EXISTING COMBINATION POLE. REMOVE EXISTING CONCRETE FOUNDATION. INSTALL NEW STEEL COMBINATION MAST ARM ASSEMBLY AND POLE, 36 FT ON NEW FOUNDATION AT PROPOSED LOCATION AS SHOWN IN PLAN. INSTALL NEW SIGNAL HEAD, LED, 1-FACE, 3-SECTION, BRACKET MOUNTED.
 - 11) REMOVE EXISTING SIGNAL HEAD, 1-FACE 3-SECTION, BRACKET MOUNTED. REMOVE AND REINSTALL EXISTING LUMINAIRE ON NEW COMBINATION POLE. REMOVE EXISTING COMBINATION POLE. REMOVE EXISTING CONCRETE FOUNDATION. INSTALL NEW STEEL COMBINATION MAST ARM ASSEMBLY AND POLE, 22 FT ON NEW FOUNDATION AT PROPOSED LOCATION AS SHOWN IN PLAN.

DETAIL "A"

N.T.S.

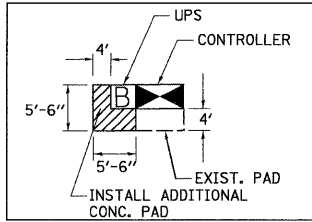

- 1) 5" THICK CONCRETE PAD SHALL BE POURED NEXT TO NEW CONTROLLER AND/OR UPS TO PROVIDE EASY MAINTENANCE ACCESS.
 - 2) MAINTENANCE PAD SHALL EXTEND TO THE EDGE OF EXISTING CONTROLLER FOUNDATION.
 - 3) COST OF PAD SHALL BE INCLUDED IN THE PRICE OF THE UNINTERRUPTIBLE POWER SUPPLY PAY ITEM.
- NOTE:**
THE WORK SHOWN IN DETAIL "A" SHALL BE INCLUDED IN THE COST FOR THE U.P.S. EQUIPMENT.

NOTE:
THE TRAFFIC SIGNAL CONTROL EQUIPMENT FOR THIS PROJECT SHALL BE "ECONOLITE" TO MATCH THE EXISTING ADJACENT SYSTEM.

NOTE:
CONTRACTOR SHALL REINSTALL "EVP" EQUIPMENT WHERE SHOWN TO NEW MAST ARM OR TRAFFIC SIGNAL POST AND CONTROLLER. THIS WORK SHALL BE INCLUDED IN COST FOR "FULL-ACTUATED CONTROLLER IN EXISTING CABINET, SPECIAL".

NOTE:
THE CONTRACTOR SHALL BE REQUIRED TO MAINTAIN THE OPERATION OF THE TRAFFIC SIGNALS DURING THE ENTIRE PROJECT.

TRAFFIC SIGNAL LEGEND

PROPOSED	EXISTING	PROPOSED	EXISTING
CONTROLLER	[Symbol]	CONFIRMATION BEACON	[Symbol]
SERVICE INSTALLATION	[Symbol]	SIGNAL HEAD OPTICALLY PROGRAMMED	[Symbol]
SIGNAL HEAD	[Symbol]	CONDUIT SPLICE	[Symbol]
SIGNAL HEAD WITH BACKPLATE	[Symbol]	WOOD POLE	[Symbol]
SIGNAL HEAD, PEDESTRIAN	[Symbol]	RACEWAY FOR MAGNETIC DETECTOR, TYPE I OR TYPE II	[Symbol]
SIGNAL POST	[Symbol]	VEHICLE DETECTOR, NON COMPENSATED MAGNETIC TYPE	[Symbol]
STEEL MAST ARM ASSEMBLY AND POLE	[Symbol]	RAILROAD CONTROL CABINET	[Symbol]
MAST ARM ASSEMBLY AND POLE, ALUMINUM	[Symbol]	TELEPHONE CONNECTION	[Symbol]
STEEL COMBINATION MAST ARM ASSEMBLY AND POLE WITH LUMINAIRE	[Symbol]	ILLUMINATED SIGN "NO LEFT TURN"	[Symbol]
UNIT DUCT	[Symbol]	ILLUMINATED SIGN "NO RIGHT TURN"	[Symbol]
COMMON TRENCH	[Symbol]	UNINTERRUPTIBLE POWER SUPPLY	[Symbol]
HANDHOLE	[Symbol]		
HEAVY DUTY HANDHOLE	[Symbol]		
DOUBLE HANDHOLE	[Symbol]		
G.S. CONDUIT IN TRENCH (T) OR PUSHED (P)	[Symbol]		
PEDESTRIAN PUSH-BUTTON DETECTOR	[Symbol]		
DETECTOR LOOP, TYPE I	[Symbol]		
CAST IRON JUNCTION BOX	[Symbol]		
EMERGENCY VEHICLE SYSTEM DETECTOR	[Symbol]		

FILE NAME =	USER NAME = RDS	DESIGNED - KK	REVISED -
\\MICROST\352072\ RT53 @ MURPHY SIG.DGN		DRAWN - RDS	REVISED -
	PLOT SCALE = 1"=20'	CHECKED - BPT	REVISED -
	PLOT DATE = 03-18-09	DATE - 03-18-09	REVISED -

**STATE OF ILLINOIS
DEPARTMENT OF TRANSPORTATION**

**TRAFFIC SIGNAL MODIFICATION PLAN
IL. ROUTE 53 (INDEPENDENCE BLVD.) AT MURPHY DRIVE**

SCALE: N.T.S. SHEET NO. OF SHEETS STA. TO STA.

PREPARED BY:
CEMCON, Ltd.
Consulting Engineers, Land Surveyors & Planners
2280 White Oak Circle, Suite 100
Aurora, Illinois 60504-9675
Ph: 630.862.2100 Fax: 630.862.2199
E-Mail: codd@cemcon.com Website: www.cemcon.com

F.A.P. RTE.	SECTION	COUNTY	TOTAL SHEETS	SHEET NO.
	2009-039 TS	WILL	20	13
FED. ROAD DIST. NO. ILLINOIS FED. AID PROJECT			CONTRACT NO. 60G44	