

**TYPICAL ENTRANCE/EXIT RAMP COMBINATION PAVEMENT MARKINGS**

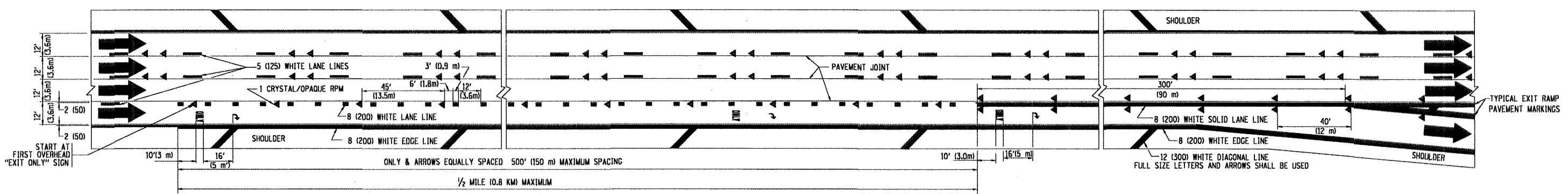

**TYPICAL EXIT ONLY LANE PAVEMENT MARKINGS**

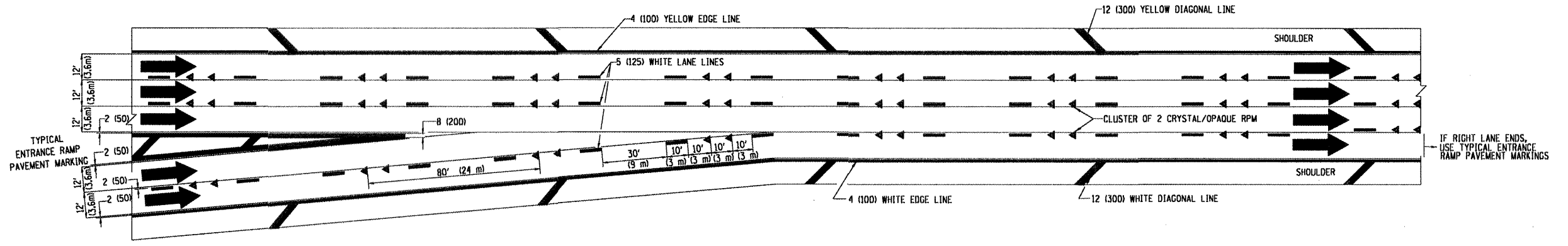

**TYPICAL TWO LANE ENTRANCE RAMP PAVEMENT MARKINGS**

FILE NAME =	USER NAME = wjgreendp	DESIGNED - D.W.S.	REVISED - A.H. 03-96	<b>STATE OF ILLINOIS DEPARTMENT OF TRANSPORTATION</b>	<b>MULTI-LANE FREEWAY PAVEMENT MARKING DETAILS</b>		F.A. RTE.	SECTION	COUNTY	TOTAL SHEETS	SHEET NO.	
PLT SCALE = 1/8" = 1' / IN.	DRAWN -	CHECKED - J.A.F. 02-06	REVISED - D.W.S. 07-96		SCALE: NONE	SHEET NO. 2 OF 2 SHEETS	STA.	TO STA.	VAR 2009-043PP	COOK	10	9
PLT DATE = 3/31/2009	DATE - 01-90	REVISED - S.P.B. 01-07							TC-12	CONTRACT NO. 60055		
									FED. ROAD DIST. NO. 1	ILLINOIS	FED. AID PROJECT	