

MATCH LINE STA. 128+00  
SEE SHEET 6

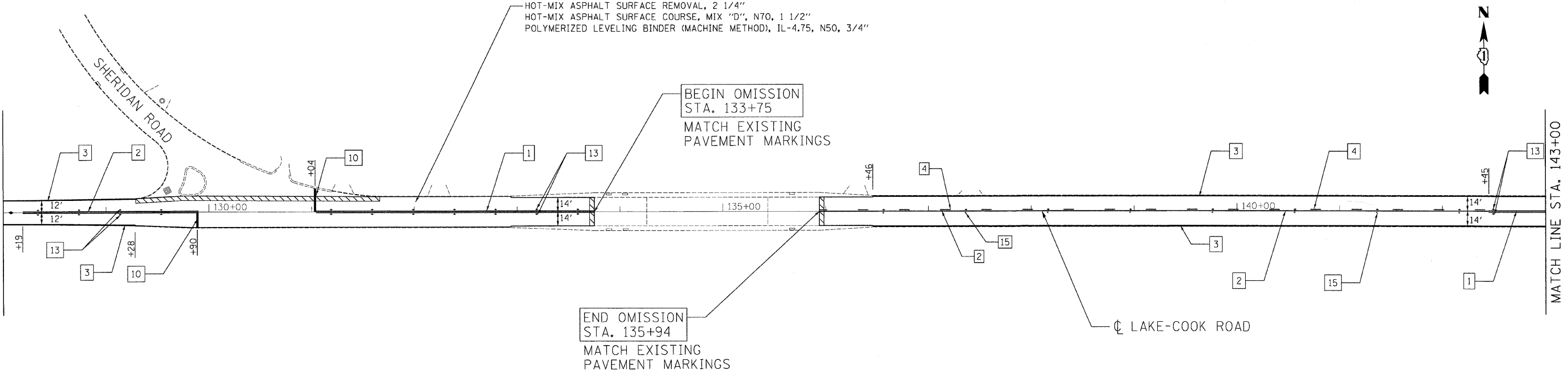

HOT-MIX ASPHALT SURFACE REMOVAL - BUTT JOINT  
TEMPORARY RAMP

HOT-MIX ASPHALT SURFACE REMOVAL, 2 1/4"  
HOT-MIX ASPHALT SURFACE COURSE, MIX "D", N70, 1 1/2"  
POLYMERIZED LEVELING BINDER (MACHINE METHOD), IL-4.75, N50, 3/4"

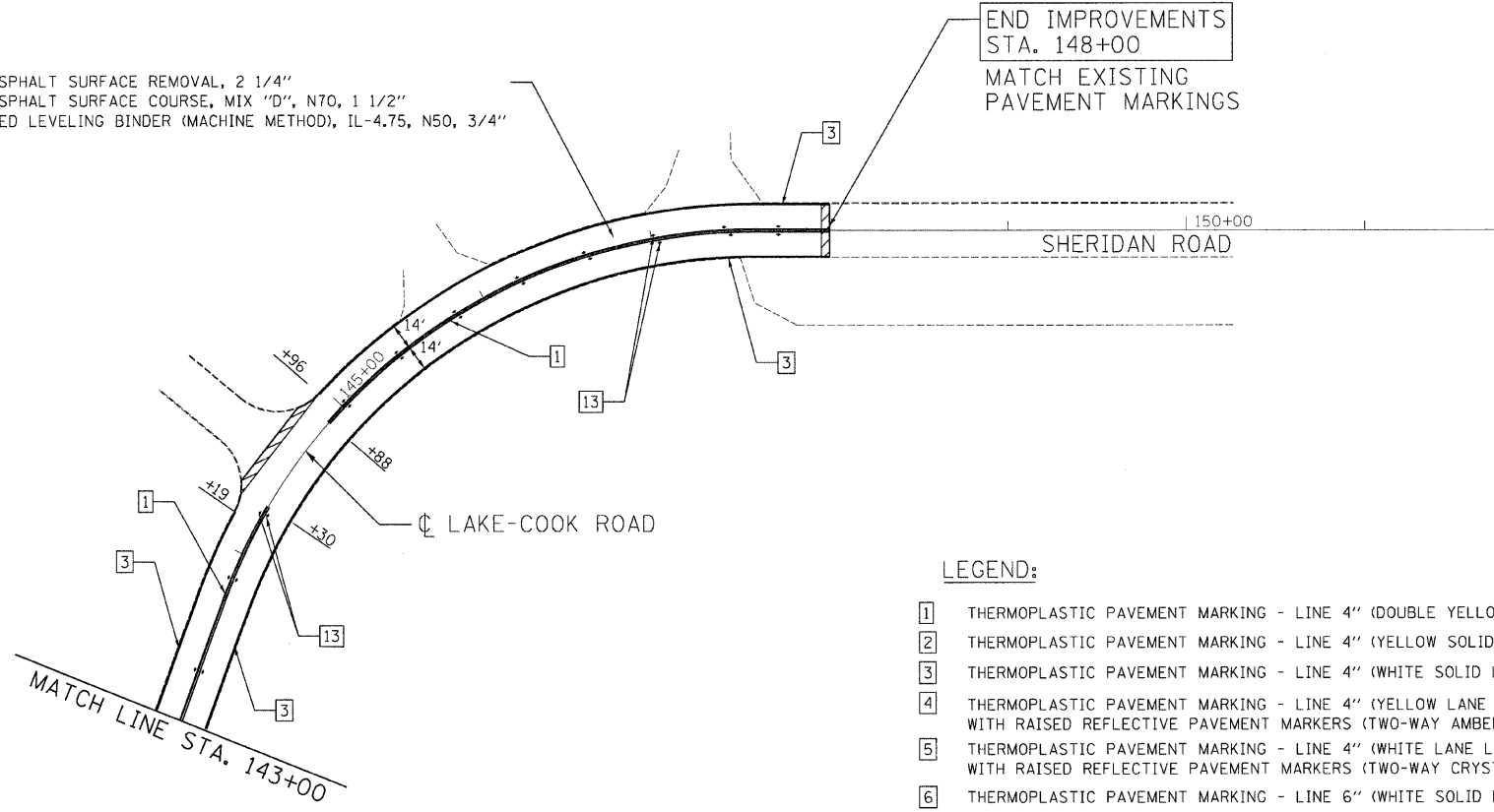

**LEGEND:**

- |   |  |
|---|--|
| <ul style="list-style-type: none"> <li>1 THERMOPLASTIC PAVEMENT MARKING - LINE 4" (DOUBLE YELLOW SOLID LINE 11" C-C)</li> <li>2 THERMOPLASTIC PAVEMENT MARKING - LINE 4" (YELLOW SOLID LINE)</li> <li>3 THERMOPLASTIC PAVEMENT MARKING - LINE 4" (WHITE SOLID LINE)</li> <li>4 THERMOPLASTIC PAVEMENT MARKING - LINE 4" (YELLOW LANE LINE - 10' DASH, 30' SKIP) WITH RAISED REFLECTIVE PAVEMENT MARKERS (TWO-WAY AMBER MARKER) (80' C-C)</li> <li>5 THERMOPLASTIC PAVEMENT MARKING - LINE 4" (WHITE LANE LINE - 10' DASH, 30' SKIP) WITH RAISED REFLECTIVE PAVEMENT MARKERS (TWO-WAY CRYSTAL MARKER) (80' C-C)</li> <li>6 THERMOPLASTIC PAVEMENT MARKING - LINE 6" (WHITE SOLID LINE)</li> <li>7 THERMOPLASTIC PAVEMENT MARKING - LINE 6" (WHITE LANE LINE - 2' DASH, 6' SKIP)</li> </ul> | <ul style="list-style-type: none"> <li>8 THERMOPLASTIC PAVEMENT MARKING - LINE 12" (WHITE LINE)</li> <li>9 THERMOPLASTIC PAVEMENT MARKING - LINE 12" (YELLOW DIAGONAL LINE)</li> <li>10 THERMOPLASTIC PAVEMENT MARKING - LINE 24" (WHITE STOP LINE)</li> <li>11 THERMOPLASTIC PAVEMENT MARKING - LETTERS AND SYMBOLS (TYP.)</li> <li>12 RAISED REFLECTIVE PAVEMENT MARKERS (ONE-WAY AMBER MARKER) (40' C-C)</li> <li>13 RAISED REFLECTIVE PAVEMENT MARKERS (TWO-WAY AMBER MARKER) (40' C-C)</li> <li>14 RAISED REFLECTIVE PAVEMENT MARKERS (ONE-WAY CRYSTAL MARKER) (40' C-C)</li> <li>15 RAISED REFLECTIVE PAVEMENT MARKERS (ONE-WAY AMBER MARKER) (80' C-C)</li> </ul> |
|---|--|

FILE NAME = n:\p\03368\3368\15\design\proposals\3368\15-Prop02.dgn

**Ciorba Group, Inc.**  
CONSULTING ENGINEERS  
5507 North Cumberland Avenue, Suite 402  
Chicago, Illinois 60658  
Tel. 773.775.4009 Fax 773.775.4014

USER NAME = alen	DESIGNED - MBT	REVISED -
DRAWN - AL	CHECKED - WBL	DATE - 4/16/2009
PLOT SCALE = 50.0000' / 1"		
PLOT DATE = 4/16/2009		

**STATE OF ILLINOIS  
DEPARTMENT OF TRANSPORTATION**

**LAKE-COOK ROAD /SHERIDAN ROAD  
GREEN BAY ROAD TO SHERIDAN ROAD (EAST JUNCTION)  
PROPOSED ROADWAY AND PAVEMENT MARKING PLAN**

SCALE: 1"=50' SHEET NO. 6 OF 19 SHEETS STA. 128+00 TO STA. 151+75

F.A.U. RTE.	SECTION	COUNTY	TOTAL SHEETS	SHEET NO.
3726	(112 & 112X) RS-7	LAKE/COOK	19	6
CONTRACT NO. 60H03				
FED. ROAD DIST. NO. 1 ILLINOIS/FED. AID PROJECT				