

QUANTITY  
 4 (100) LINE = 64.1 ft. (19.7 m)  
 21.1 sq. ft. (1.97 sq. m)

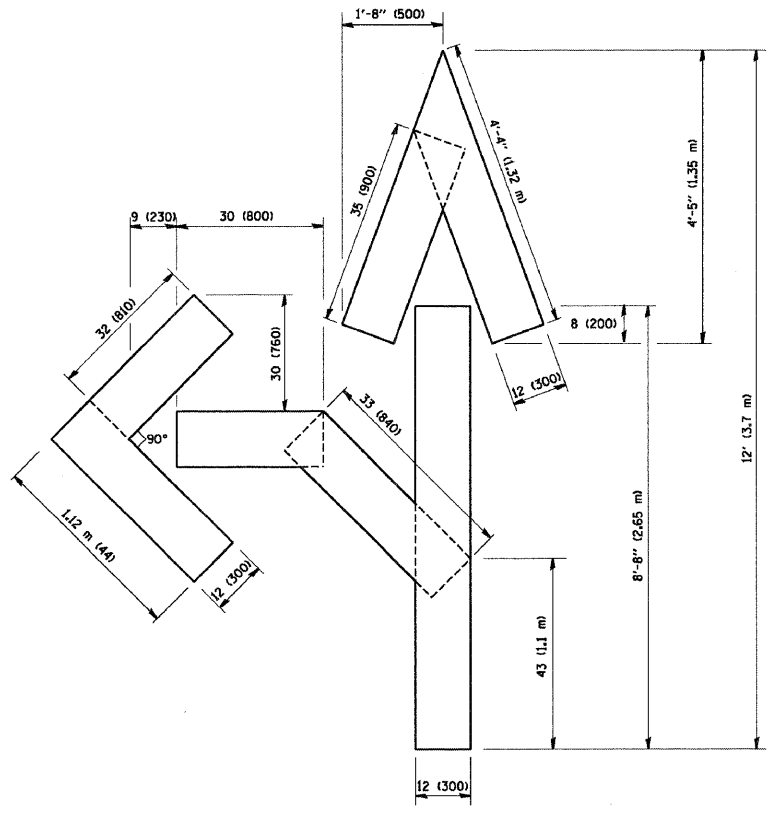

QUANTITY  
 4 (100) LINE = 82.5 ft. (25.3 m)  
 27.5 sq. ft. (2.53 sq. m)

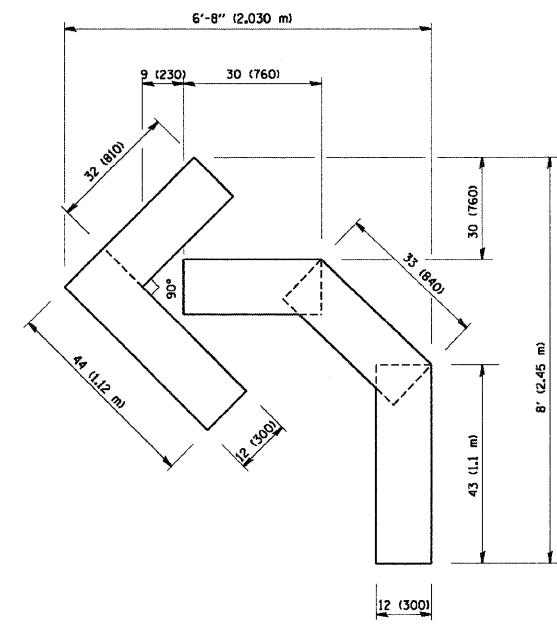

QUANTITY  
 4 (100) LINE = 45.5 ft. (13.9 m)  
 15.2 sq. ft. (1.39 sq. m)

All dimensions are in inches (millimeters) unless otherwise shown.

### PAVEMENT MARKING LETTERS AND SYMBOLS FOR TRAFFIC STAGING

FILE NAME =	USER NAME = #USER#	DESIGNED -	REVISED -	<b>STATE OF ILLINOIS DEPARTMENT OF TRANSPORTATION</b>	<b>DISTRICT ONE DETAIL SHEETS</b>			F.A.P. RTE.	SECTION	COUNTY	TOTAL SHEETS	SHEET NO.
#FILEL#		DRAWN -	REVISED -		<b>IL ROUTE 47 FROM IL ROUTE 176 TO IL ROUTE 120</b>			326	105 RS-9	McHENRY	37	32
		CHECKED -	REVISED -		SCALE: NONE    SHEET NO. 32 OF 37 SHEETS    STA. 8+85 TO STA. 256+29			<b>D-91-603-09</b>		<b>CONTRACT NO. 60H33</b>		
		DATE - 4/2009	REVISED -		FED. ROAD DIST. NO.    ILLINOIS FED. AID PROJECT							