

PROFILE SURVEYED BY DATE
 GRADES CHECKED
 NOTE BOOK NO. NOTED
 STRUCTURE NOTATIONS CIP/ID

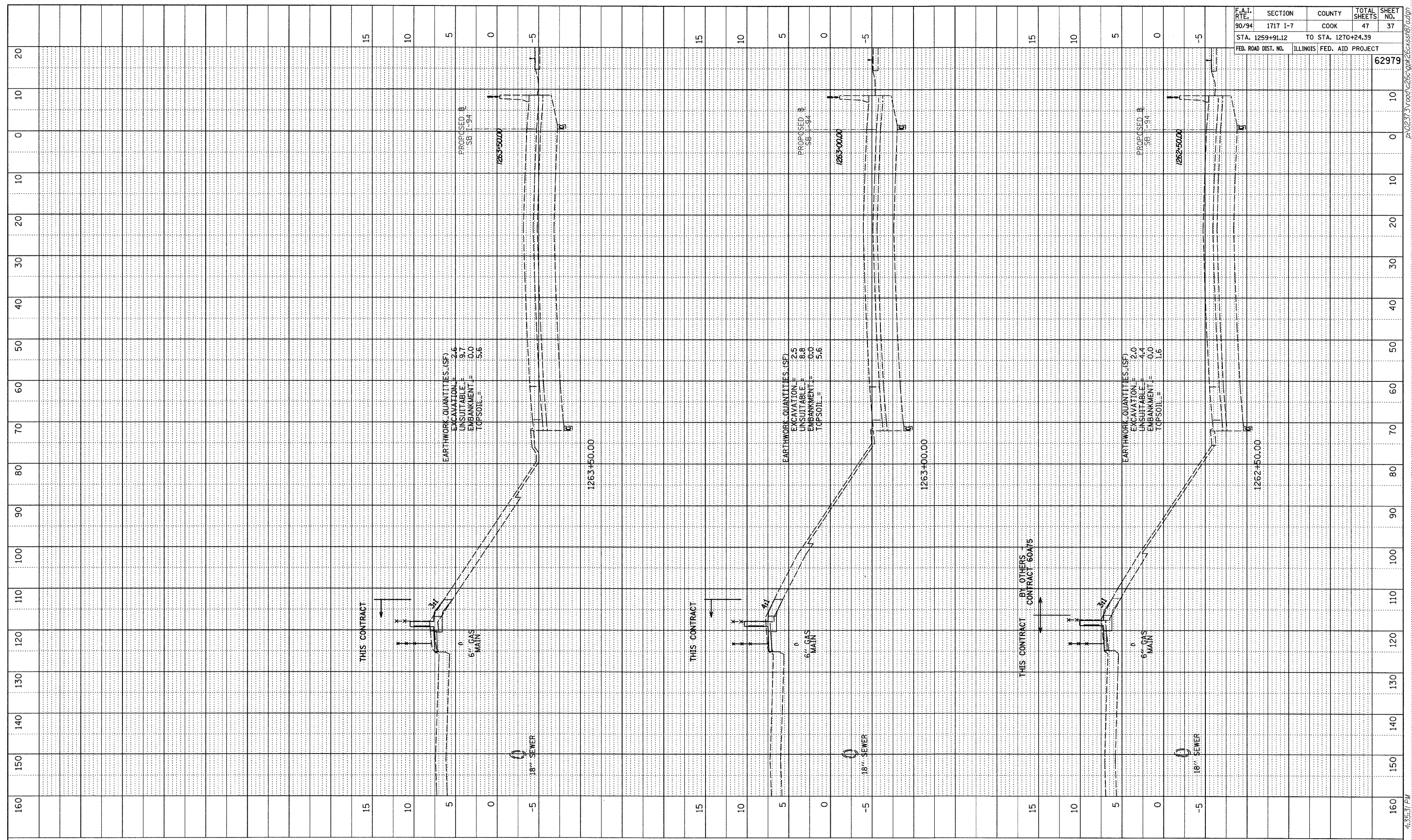

F.A.I. RTE.	SECTION	COUNTY	TOTAL SHEETS	SHEET NO.
90/94	1717 I-7	COOK	47	37
STA. 1259+91.12		TO STA. 1270+24.39		
FED. ROAD DIST. NO.	ILLINOIS FED. AID PROJECT			
				62979

TYLIN INTERNATIONAL

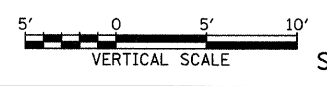
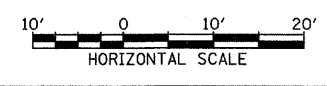

SB I-94 (DAN RYAN EXPRESSWAY)
 STA. 1262+50.00 TO STA. 1263+50.00

10/16/2008 4:35:31 PM P:\02373\road\c66a\pk26\cassh7.dwg