

PROFILE	SUBMITTED	BY	DATE
NOTE BOOK	DESIGNED		
NO.	CHECKED		
	DRAWN		
	STRUCTURE		
	NOTATIONS		
	CRD		

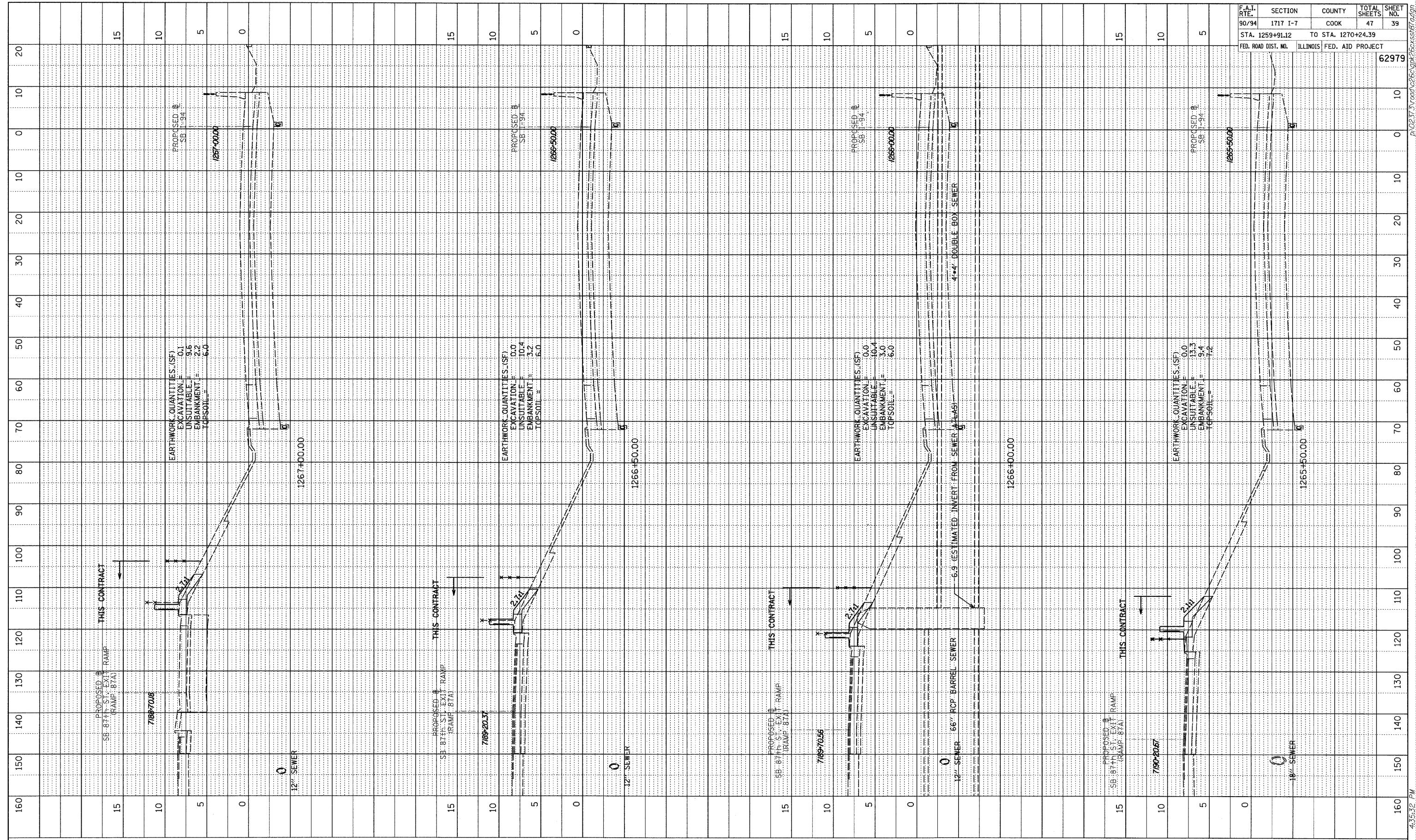

F.A.I. RTE.	SECTION	COUNTY	TOTAL SHEETS	SHEET NO.
90/94	1717 I-7	COOK	47	39
STA. 1259+91.12		TO STA. 1270+24.39		
FED. ROAD DIST. NO.	ILLINOIS	FED. AID PROJECT		
			62979	

TYLIN INTERNATIONAL

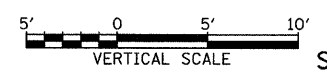
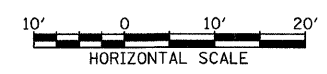

SB I-94 (DAN RYAN EXPRESSWAY)  
 STA. 1265+50.00 TO STA. 1267+00.00

10/16/2008 4:35:32 PM