

F.A.I. RTE.	SECTION	COUNTY	TOTAL SHEETS	SHEET NO.
90/94		COOK	31	17
STA. 22+00		TO STA. 511+50		
FED. ROAD DIST. NO. 1 ILLINOIS FED. AID PROJECT				
(1919.15 & 2021-922 PT1) I				62985

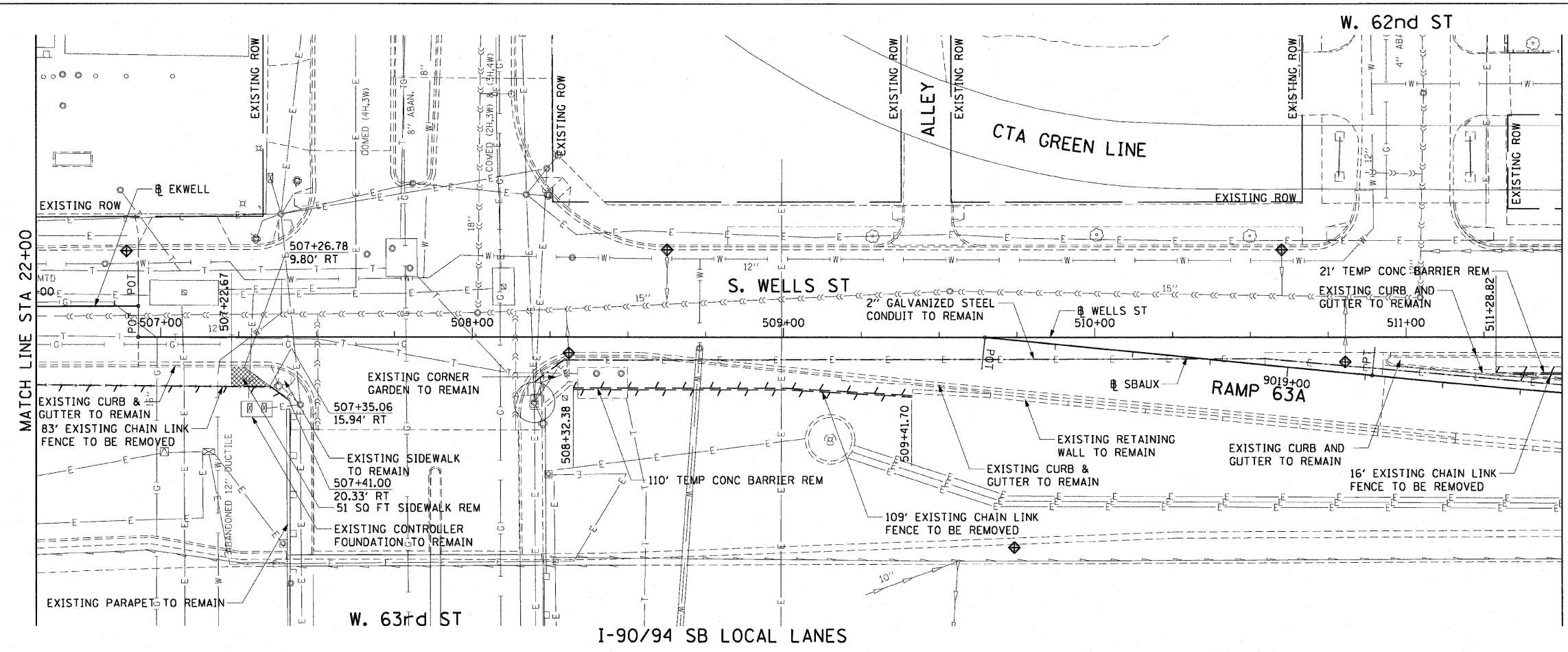

- LEGEND:**
- AREA REMOVALS
 - LINEAR REMOVALS
 - SIDEWALK REMOVAL
 - INLET FILTER

EXISTING CONDITIONS AND REMOVAL

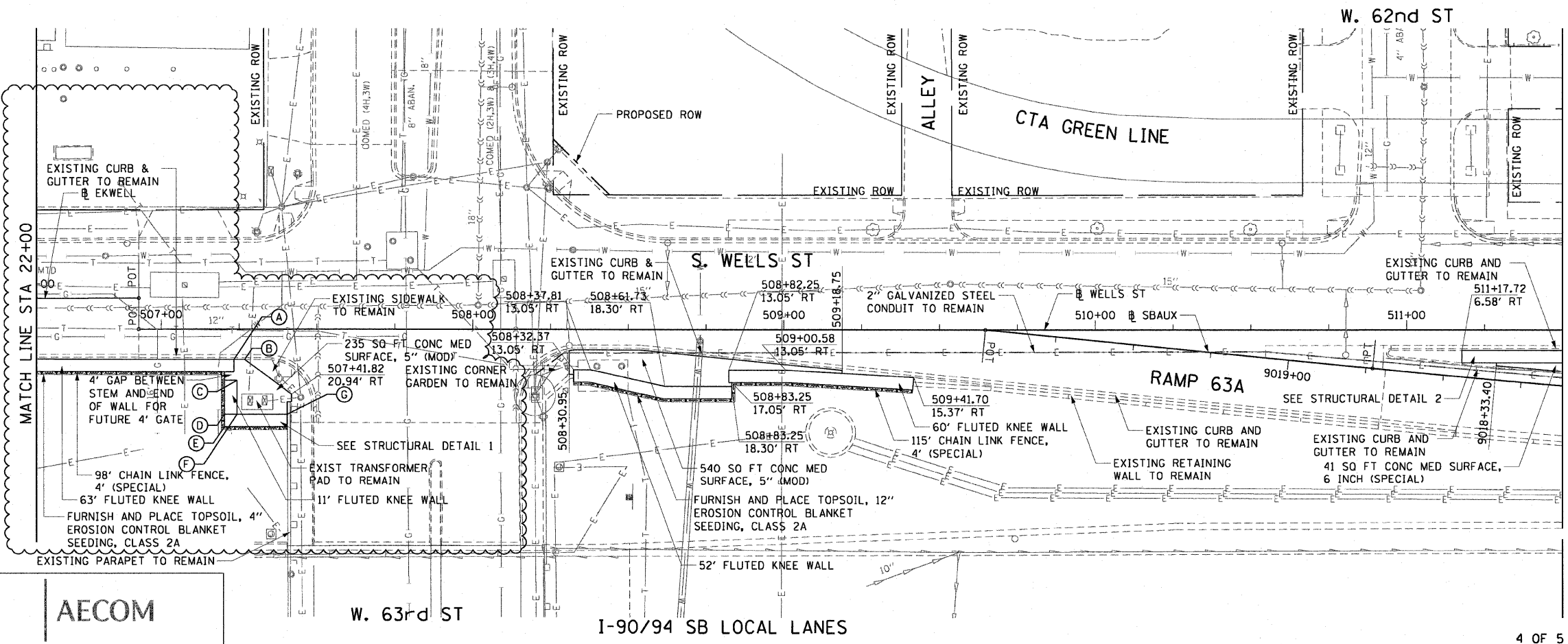

PROPOSED IMPROVEMENTS

- NOTES:**
1. SEE STRUCTURAL DETAILS FOR FLUTED KNEE WALL DETAILS.
 2. ALL POINT CALLOUTS ARE TAKEN AT THE EDGE OF THE KNEE WALL BASE.
 3. SEE ROADWAY DETAILS FOR CONCRETE MEDIAN DETAILS.
 4. SEE TABLE BELOW FOR POINT CALLOUT INFORMATION.

POINT CALLOUT INFORMATION

PT	STATION	OFFSET
(A)	204+23.30	9.80' RT
(B)	507+26.78	9.80' RT
(C)	507+24.30	16.55' RT
(D)	507+20.30	27.44' RT
(E)	507+20.30	31.44' RT
(F)	507+24.30	27.44' RT
(G)	507+40.43	27.44' RT

REVISIONS	
NAME	DATE
KNEEWALL CHANGE	5/19/09

ILLINOIS DEPARTMENT OF TRANSPORTATION
 F.A.I. 90/94 (DAN RYAN EXPRESSWAY)
 63RD ST TO 59TH ST (NB AND SB KNEE WALLS)
**EXISTING AND PROPOSED ROADWAY PLANS
 WELLS STREET**

SCALE: 1"=20'
 DATE: JANUARY 14, 2009
 DRAWN BY: NJH
 CHECKED BY: RMG

AECOM

5/19/2009 8:56:17 AM I:\40466\GWIN\28-knee-wall-Fence\STA\cont\ct 28\pp28004.dwg