

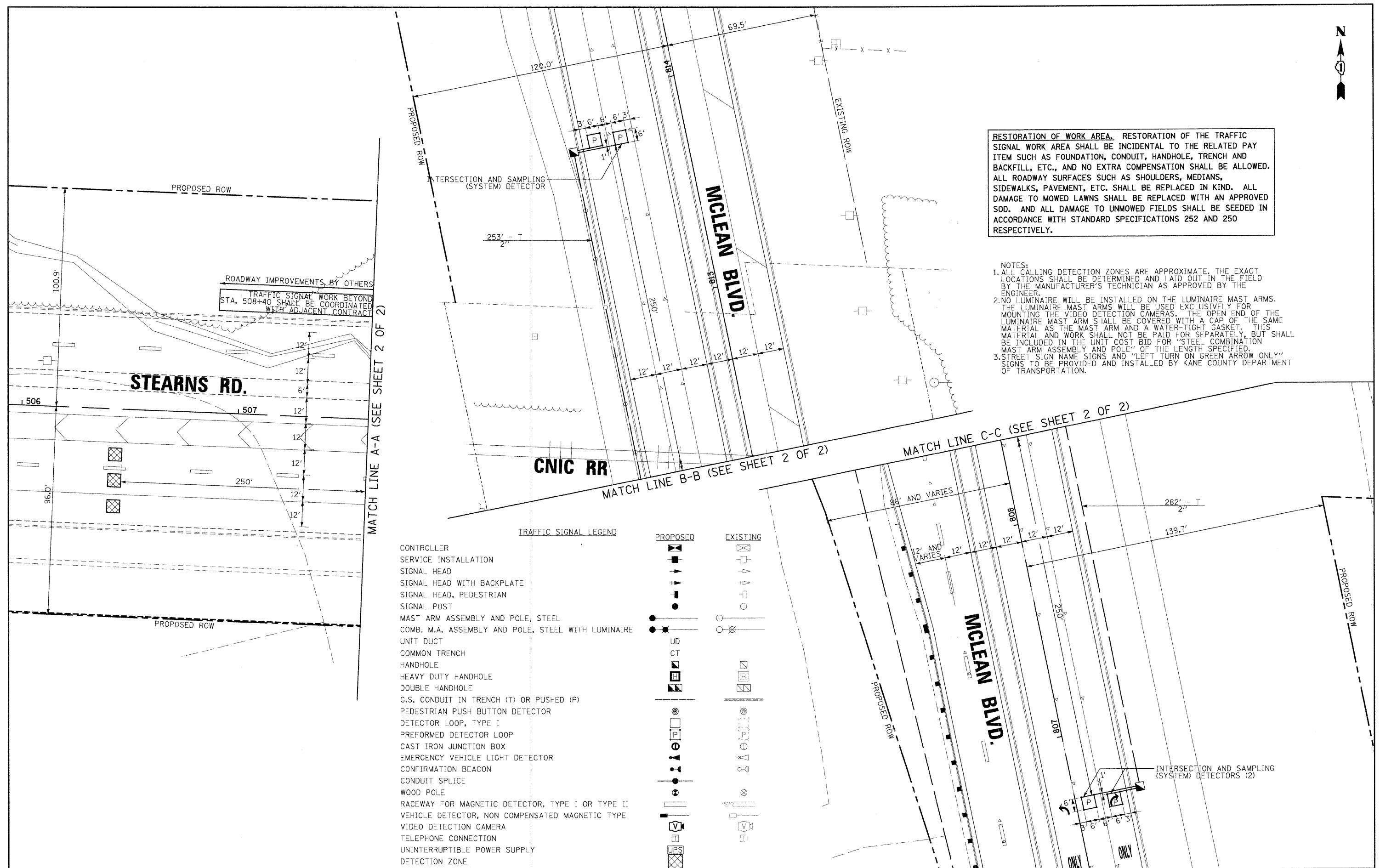

RESTORATION OF WORK AREA. RESTORATION OF THE TRAFFIC SIGNAL WORK AREA SHALL BE INCIDENTAL TO THE RELATED PAY ITEM SUCH AS FOUNDATION, CONDUIT, HANDHOLE, TRENCH AND BACKFILL, ETC., AND NO EXTRA COMPENSATION SHALL BE ALLOWED. ALL ROADWAY SURFACES SUCH AS SHOULDERS, MEDIANS, SIDEWALKS, PAVEMENT, ETC. SHALL BE REPLACED IN KIND. ALL DAMAGE TO MOWED LAWNS SHALL BE REPLACED WITH AN APPROVED SOD. AND ALL DAMAGE TO UNMOWED FIELDS SHALL BE SEED IN ACCORDANCE WITH STANDARD SPECIFICATIONS 252 AND 250 RESPECTIVELY.

- NOTES:**
1. ALL CALLING DETECTION ZONES ARE APPROXIMATE. THE EXACT LOCATIONS SHALL BE DETERMINED AND LAID OUT IN THE FIELD BY THE MANUFACTURER'S TECHNICIAN AS APPROVED BY THE ENGINEER.
 2. NO LUMINAIRE WILL BE INSTALLED ON THE LUMINAIRE MAST ARMS. THE LUMINAIRE MAST ARMS WILL BE USED EXCLUSIVELY FOR MOUNTING THE VIDEO DETECTION CAMERAS. THE OPEN END OF THE LUMINAIRE MAST ARM SHALL BE COVERED WITH A CAP OF THE SAME MATERIAL AS THE MAST ARM AND A WATER-TIGHT GASKET. THIS MATERIAL AND WORK SHALL NOT BE PAID FOR SEPARATELY, BUT SHALL BE INCLUDED IN THE UNIT COST BID FOR "STEEL COMBINATION MAST ARM ASSEMBLY AND POLE" OF THE LENGTH SPECIFIED.
 3. STREET SIGN NAME SIGNS AND "LEFT TURN ON GREEN ARROW ONLY" SIGNS TO BE PROVIDED AND INSTALLED BY KANE COUNTY DEPARTMENT OF TRANSPORTATION.



TRAFFIC SIGNAL LEGEND

	PROPOSED	EXISTING
CONTROLLER	[Symbol]	[Symbol]
SERVICE INSTALLATION	[Symbol]	[Symbol]
SIGNAL HEAD	[Symbol]	[Symbol]
SIGNAL HEAD WITH BACKPLATE	[Symbol]	[Symbol]
SIGNAL HEAD, PEDESTRIAN	[Symbol]	[Symbol]
SIGNAL POST	[Symbol]	[Symbol]
MAST ARM ASSEMBLY AND POLE, STEEL	[Symbol]	[Symbol]
COMB. M.A. ASSEMBLY AND POLE, STEEL WITH LUMINAIRE	[Symbol]	[Symbol]
UNIT DUCT	[Symbol]	[Symbol]
COMMON TRENCH	[Symbol]	[Symbol]
HANDHOLE	[Symbol]	[Symbol]
HEAVY DUTY HANDHOLE	[Symbol]	[Symbol]
DOUBLE HANDHOLE	[Symbol]	[Symbol]
G.S. CONDUIT IN TRENCH (T) OR PUSHED (P)	[Symbol]	[Symbol]
PEDESTRIAN PUSH BUTTON DETECTOR	[Symbol]	[Symbol]
DETECTOR LOOP, TYPE I	[Symbol]	[Symbol]
PREFORMED DETECTOR LOOP	[Symbol]	[Symbol]
CAST IRON JUNCTION BOX	[Symbol]	[Symbol]
EMERGENCY VEHICLE LIGHT DETECTOR	[Symbol]	[Symbol]
CONFIRMATION BEACON	[Symbol]	[Symbol]
CONDUIT SPLICE	[Symbol]	[Symbol]
WOOD POLE	[Symbol]	[Symbol]
RACEWAY FOR MAGNETIC DETECTOR, TYPE I OR TYPE II	[Symbol]	[Symbol]
VEHICLE DETECTOR, NON COMPENSATED MAGNETIC TYPE	[Symbol]	[Symbol]
VIDEO DETECTION CAMERA	[Symbol]	[Symbol]
TELEPHONE CONNECTION	[Symbol]	[Symbol]
UNINTERRUPTIBLE POWER SUPPLY	[Symbol]	[Symbol]
DETECTION ZONE	[Symbol]	[Symbol]

FILE NAME = I:\Dgn\Civil\Sheet\td006.dgn	USER NAME = tthornton	DESIGNED - MJT	REVISED -	KANE COUNTY DIVISION OF TRANSPORTATION	NEW STEARNS ROAD - STAGE 2 TRAFFIC SIGNAL PLAN - STEARNS RDMCLEAN BLVD	F.A.P RTE. 361	SECTION 06-00214-10-BR	COUNTY KANE	TOTAL SHEETS 219	SHEET NO. 72		
PLOT SCALE = 1:20	CHECKED - TMT	REVISED -	SCALE: 1" = 20'			SHEET NO. 2 OF 2 SHEETS	STA. TO STA.	CONTRACT NO. 63073				
PLOT DATE = 3/29/2009	DATE - 3/27/09	REVISED -	FED. ROAD DIST. NO. 1 ILLINOIS FED. AID PROJECT									