

DATE	
BY	
FINAL SURVEY	SURVEYED
NOTE BOOK	PLOTTED
AREAS CHECKED	TEMPLATE
	AREAS
	CHECKED

DATE	
BY	
ORIGINAL SURVEY	SURVEYED
NOTE BOOK	PLOTTED
AREAS CHECKED	TEMPLATE
	AREAS
	CHECKED

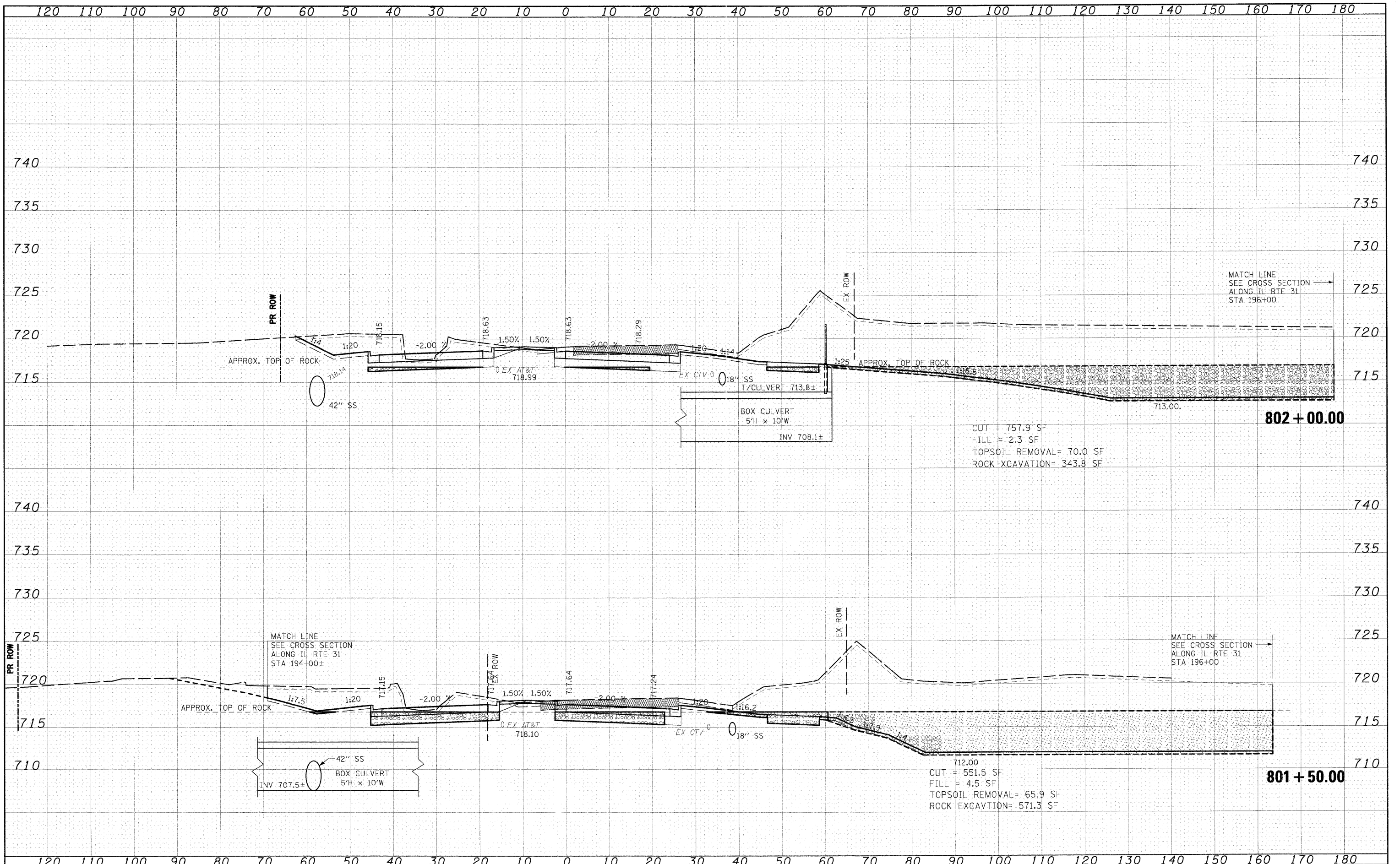

FILE NAME = J:\dgn\Civil\Sheet\ss201.dgn	USER NAME = JFiguera	DESIGNED - JWM	REVISER -	KANE COUNTY DEPARTMENT OF TRANSPORTATION	MCLEAN CROSS SECTIONS	F.A.P. RTE. 361	SECTION 06-00214-10-BR	COUNTY KANE	TOTAL SHEETS 219	SHEET NO. 199
PLOT SCALE = 1:100	CHECKED - MJT	REVISER -	SCALE: 1"=10'H; 1"=5'V SHEET NO. OF 17 SHEETS STA. 801+50.00 TO STA. 802+00.00			FED. ROAD DIST. NO. 1 ILLINOIS FED. AID PROJECT	CONTRACT NO. 63073			
PLOT DATE = 3/30/2009	DATE - 3/27/09	REVISER -								