

DATE	
BY	
SURVEYED	
PLOTTED	
TEMPLATE	
NOTIC BOOK	
AREAS CHECKED	

DATE	
BY	
SURVEYED	
PLOTTED	
TEMPLATE	
NOTIC BOOK	
AREAS CHECKED	

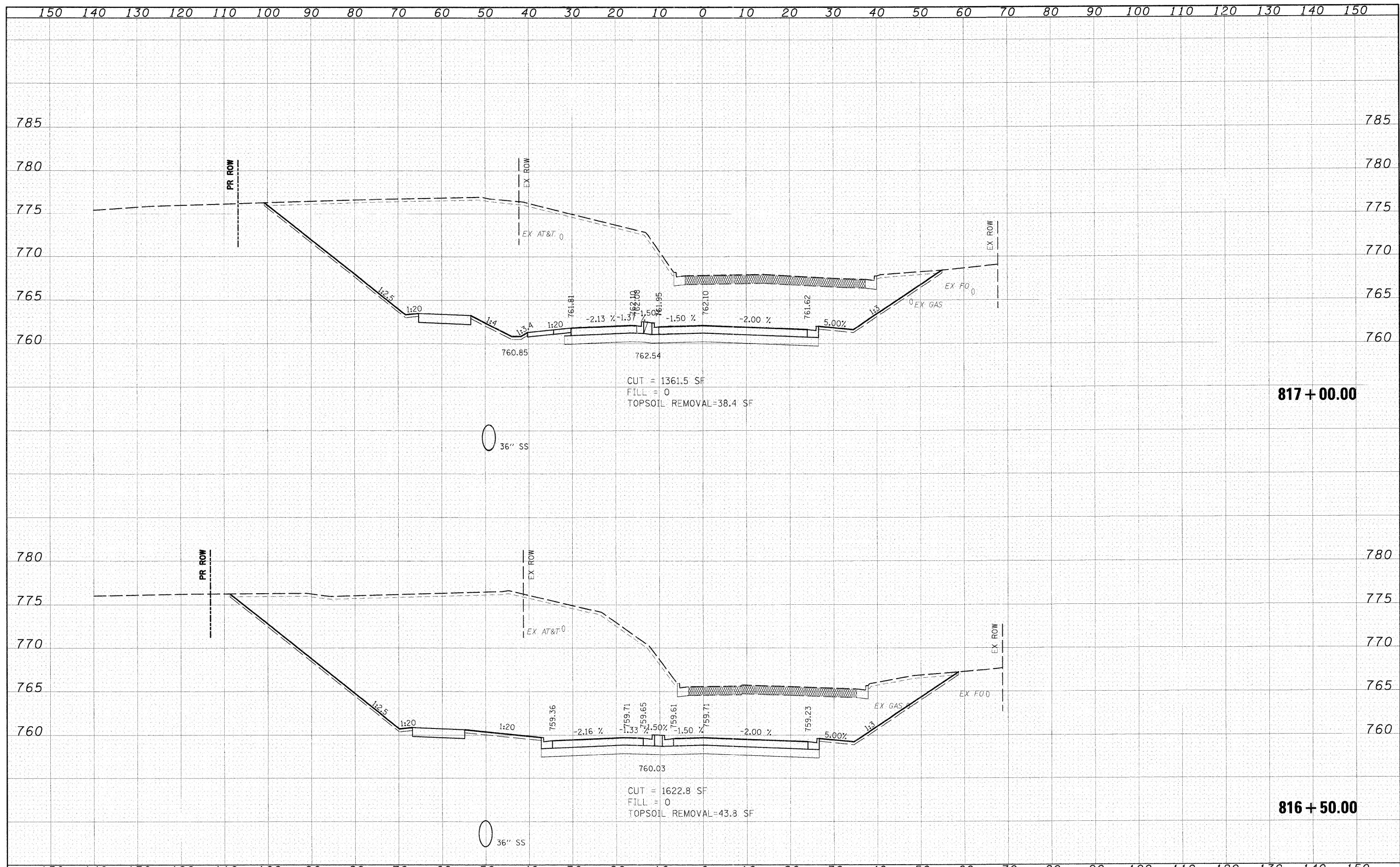

FILE NAME = i:\Dgn\Civil\Sheet\ks001.dgn	USPR NAME = JFiguera	DESIGNED - JWM	REVISED -	<b>KANE COUNTY DEPARTMENT OF TRANSPORTATION</b>	<b>MCLEAN CROSS SECTIONS</b>	F.A.P. RTE. 361	SECTION 06-00214-10-BR	COUNTY KANE	TOTAL SHEETS 219	SHEET NO. 214	
PLOT SCALE = 1:10	PLotted DATE = 3/30/2009	DRAWN - JWM	REVISED -			SCALE: 1"=10'H; 1"=5'V SHEET NO. OF 17 SHEETS	STA. 816+50.00 TO STA. 817+00.00	CONTRACT NO. 63073		FED. ROAD DIST. NO. 1 ILLINOIS FED. AID PROJECT	
DATE - 3/27/09		CHECKED - MJT	REVISED -								
		DATE -	REVISED -								