

DATE	
BY	
FINAL SURVEY	SUPPLIED
NOTE BOOK	PLOTTED
NO.	TEMPLATE
	AREAS
	CHECKED

DATE	
BY	
ORIGINAL SURVEY	SUPPLIED
NOTE BOOK	PLOTTED
NO.	TEMPLATE
	AREAS
	CHECKED

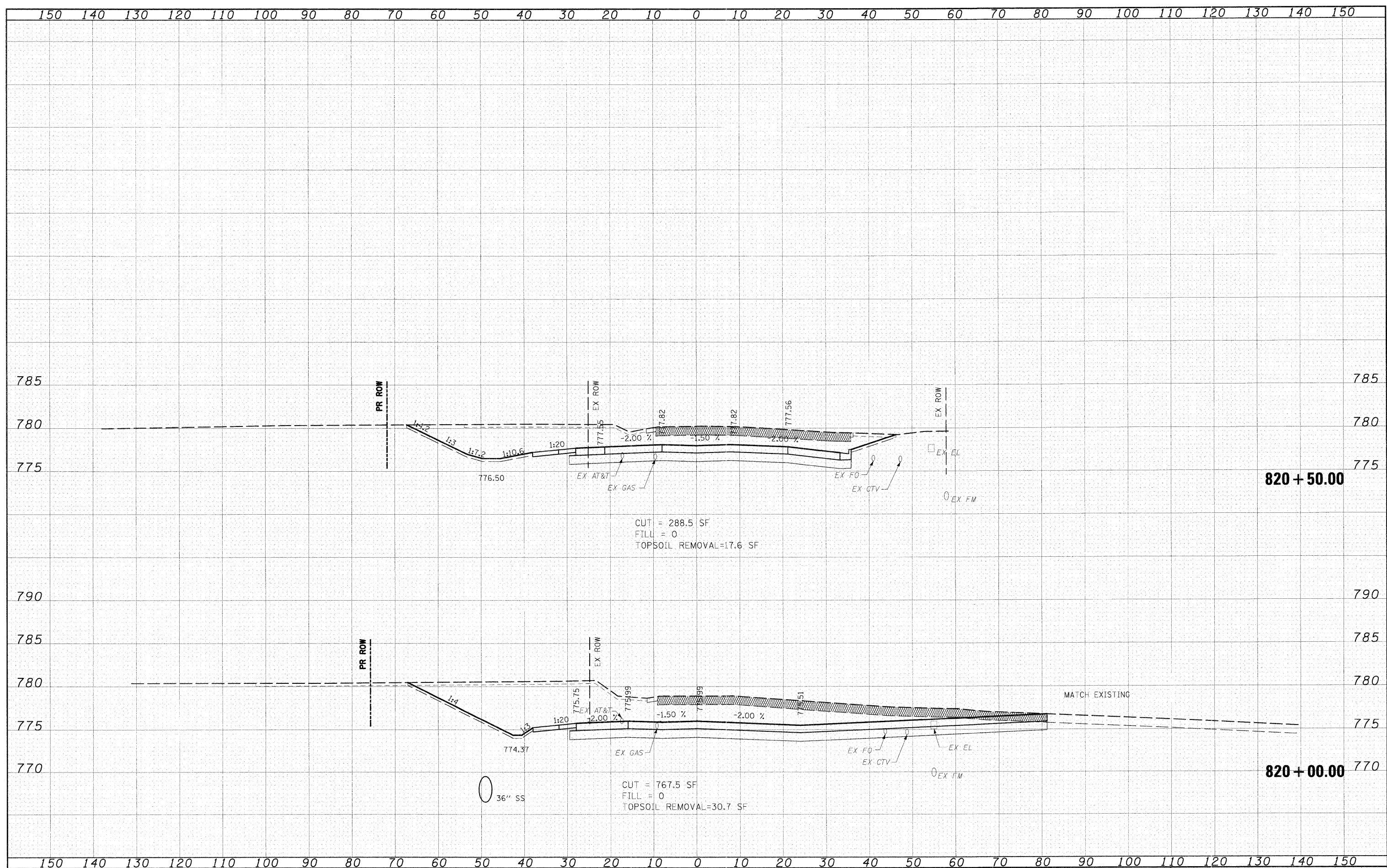

CUT = 288.5 SF
 FILL = 0
 TOPSOIL REMOVAL=17.6 SF

CUT = 767.5 SF
 FILL = 0
 TOPSOIL REMOVAL=30.7 SF

FILE NAME = I:\Dgn\Civil\Sheet\xs021.dgn

USER NAME = Jfiguera
 PLOT SCALE = 1:100
 PLOT DATE = 3/30/2009

DESIGNED - JWM
 DRAWN - JWM
 CHECKED - MJT
 DATE - 3/27/09

REVISED -
 REVISED -
 REVISED -
 REVISED -

**KANE COUNTY
 DEPARTMENT OF TRANSPORTATION**

MCLEAN CROSS SECTIONS
 SCALE: 1"=10'H; 1"=5'V SHEET NO. OF 17 SHEETS STA. 820+00.00 TO STA. 820+50.00

F.A.P. RTE.	SECTION	COUNTY	TOTAL SHEETS	SHEET NO.
361	06-00214-10-BR	KANE	219	217
CONTRACT NO. 63073			FED. ROAD DIST. NO. 1 ILLINOIS FED. AID PROJECT	