

EXISTING FLOODPLAIN BOUNDARY

**POND D**  
 NWL = 737.2'  
 100 YR 24 HR HWL = 743.05'  
 100 YR 24 HR VOLUME = 1.21 acft

**POND E**  
 NWL = 744.00  
 100 YR 24 HR HWL = 746.30'  
 100 YR 24 HR VOLUME = 0.296 acft

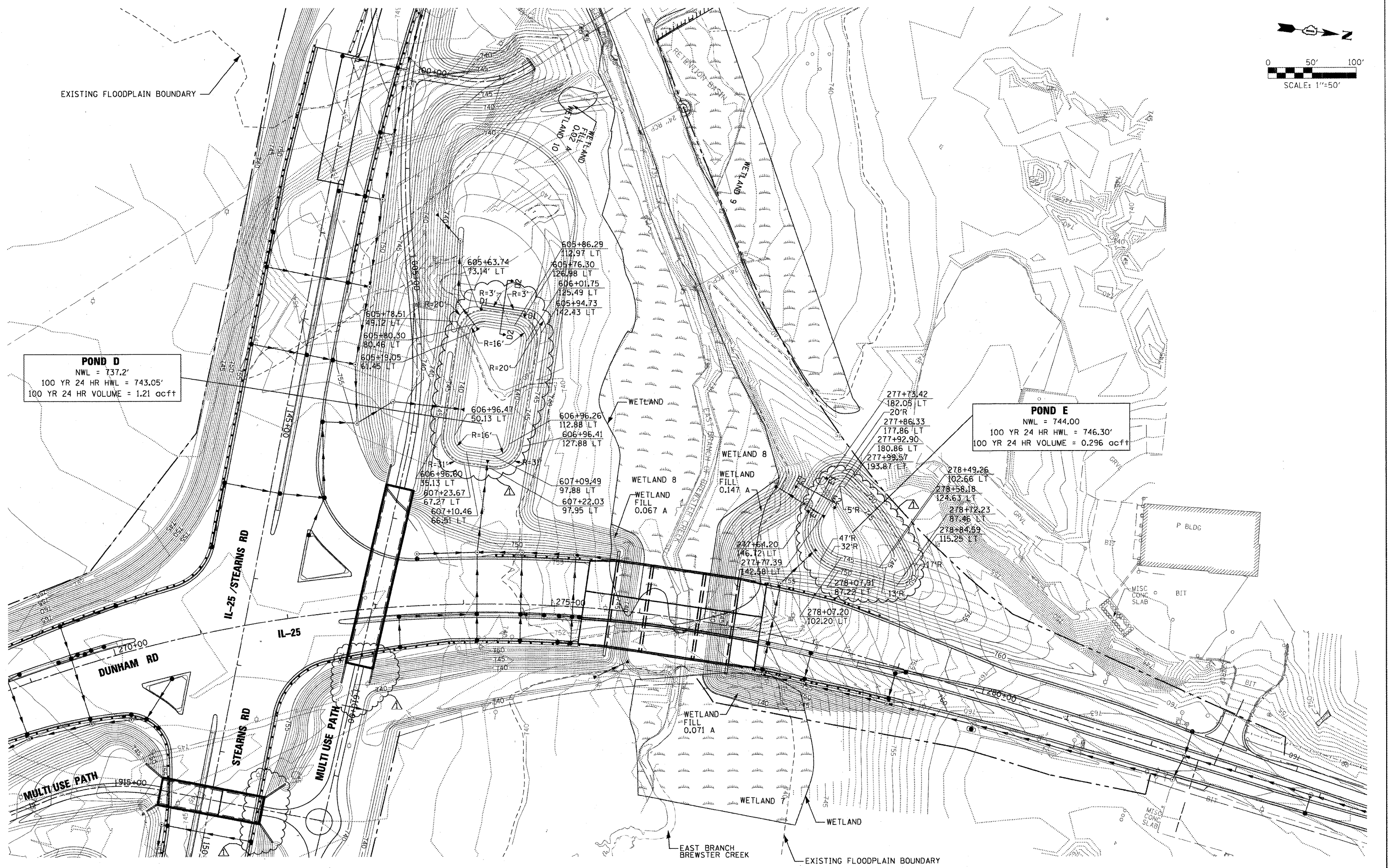

FILE NAME = #FILES#	USER NAME = #USER#	DESIGNED - TJR	REVISED -  ADDENDUM 6/5/09	<b>KANE COUNTY DIVISION OF TRANSPORTATION</b>	<b>DRAINAGE AND UTILITY DETENTION POND D / DETENTION POND E</b>	F.A. RTE. 361	SECTION 06-00214-15-BR	COUNTY KANE/DUPAGE	TOTAL SHEETS 545	SHEET NO. 174
	PLOT SCALE = #SCALE#	CHECKED - JNR	REVISED -			SCALE: SHEET NO. OF SHEETS STA. TO STA.	FED. ROAD DIST. NO.	ILLINOIS FED. AID PROJECT	CONTRACT NO. 63074	
PLOT DATE = #DATE#	DATE - 3/31/09	REVISED -	REVISED -							