

STATE OF ILLINOIS
DEPARTMENT OF TRANSPORTATION

ROUTE NO.	SECTION	COUNTY	TOTAL SHEETS	SHEET NO.	SHEET SA- 5 OF 14 SHEETS
-	-	KANE	545	292	
FED. ROAD DIST. NO. 7		ILLINOIS	FED. ROAD PROJECT		

Contract #63074

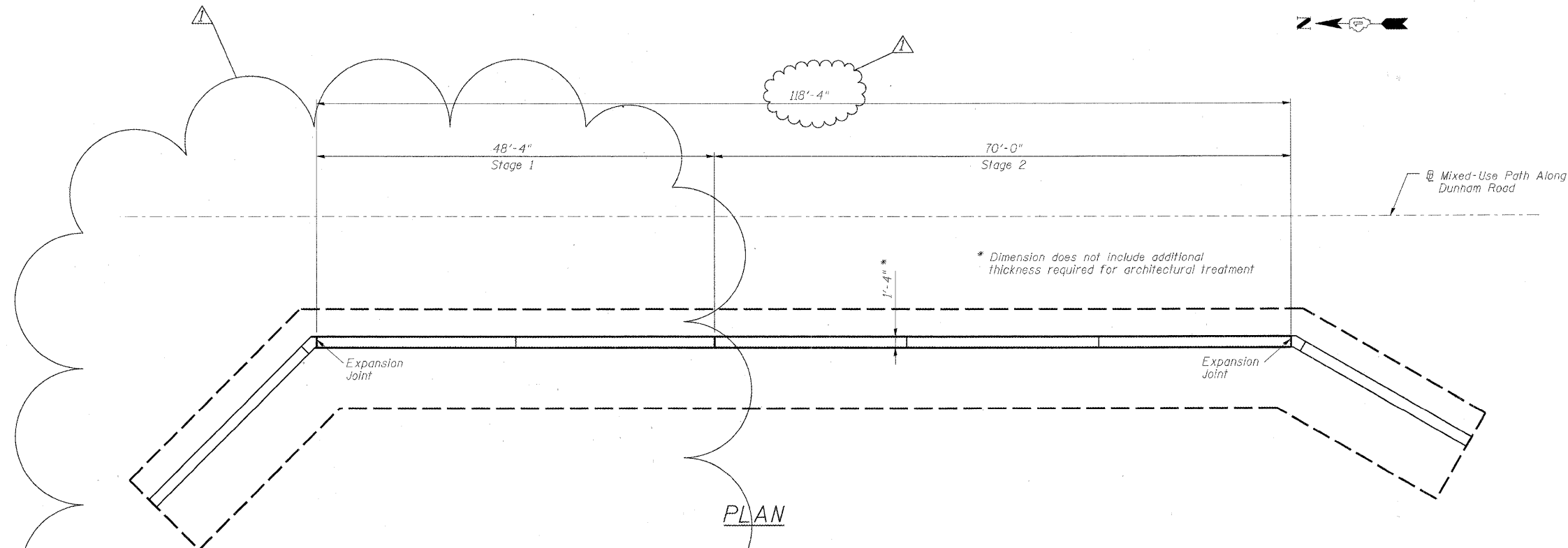

PLAN

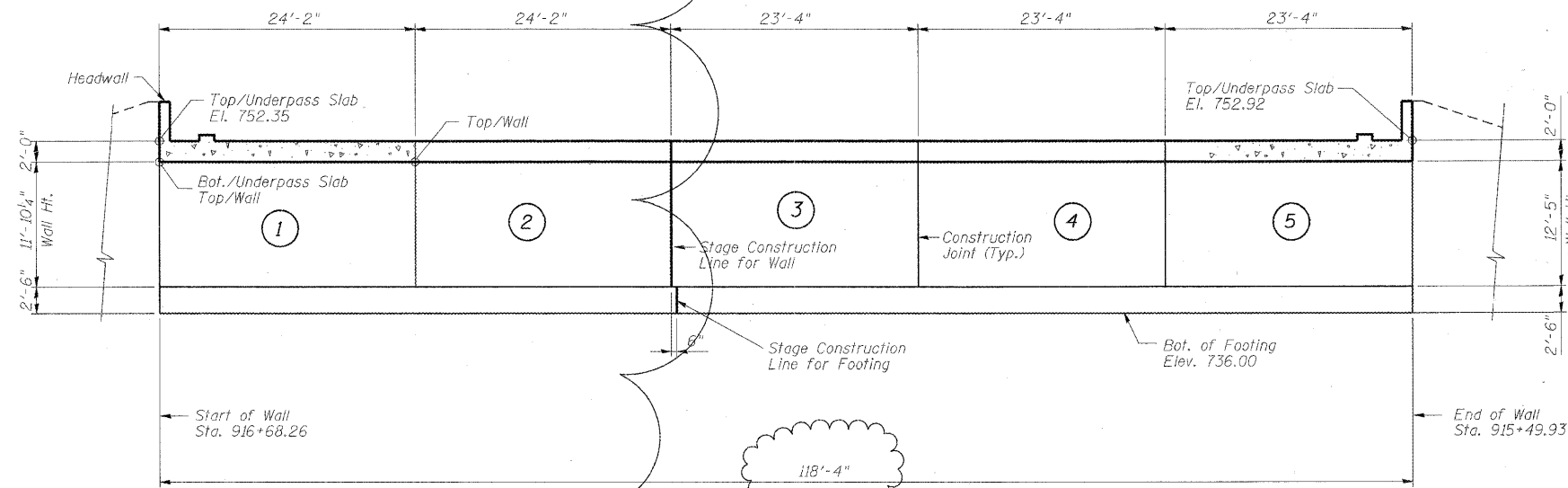

ELEVATION

TOP/WALL ELEVATIONS

Location	Station	Elevation
Start of Wall	915+68.26	750.35
Between Panels 1 & 2	915+44.10	750.45
Stage Construction Joint	915+19.93	750.57
Between Panels 3 & 4	915+96.60	750.69
Between Panels 4 & 5	915+73.27	750.80
End of Wall	915+49.93	750.92

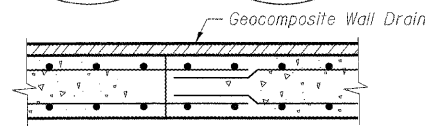

CONSTRUCTION JOINT

NOTES:

- Stations and offsets are measured with respect to Mixed-Use Path along IL 25/Dunham Road
- For reinforcement details of West Wall Panels see sheet SA-7.

DESIGNED	AAY
CHECKED	AJK
DRAWN	VH
CHECKED	HMA/DMC

▲ Addendum #1 - 6/5/09

benesch
alfred benesch & company
Engineers • Surveyors • Planners
205 North Michigan Avenue, Suite 2400
Chicago, Illinois 60601
312-965-0450
Job # 3944

**PLAN & ELEVATION WEST WALL
MULTI-USE PATH UNDER
IL 25/STEARNS ROAD
F.A.P. 360 - SEC. 06-00214-15-BR
KANE COUNTY
STATION 916+09.93
STRUCTURE NO. 045-3173**