

STATE OF ILLINOIS  
DEPARTMENT OF TRANSPORTATION

ROUTE NO.	SECTION	COUNTY	TOTAL SHEETS	SHEET NO.	SHEET 5A-7
-	-	KANE	545	294	OF 14 SHEETS
FED. ROAD DIST. NO. 7	ILLINOIS	FED. AID PROJECT			

Contract #63074

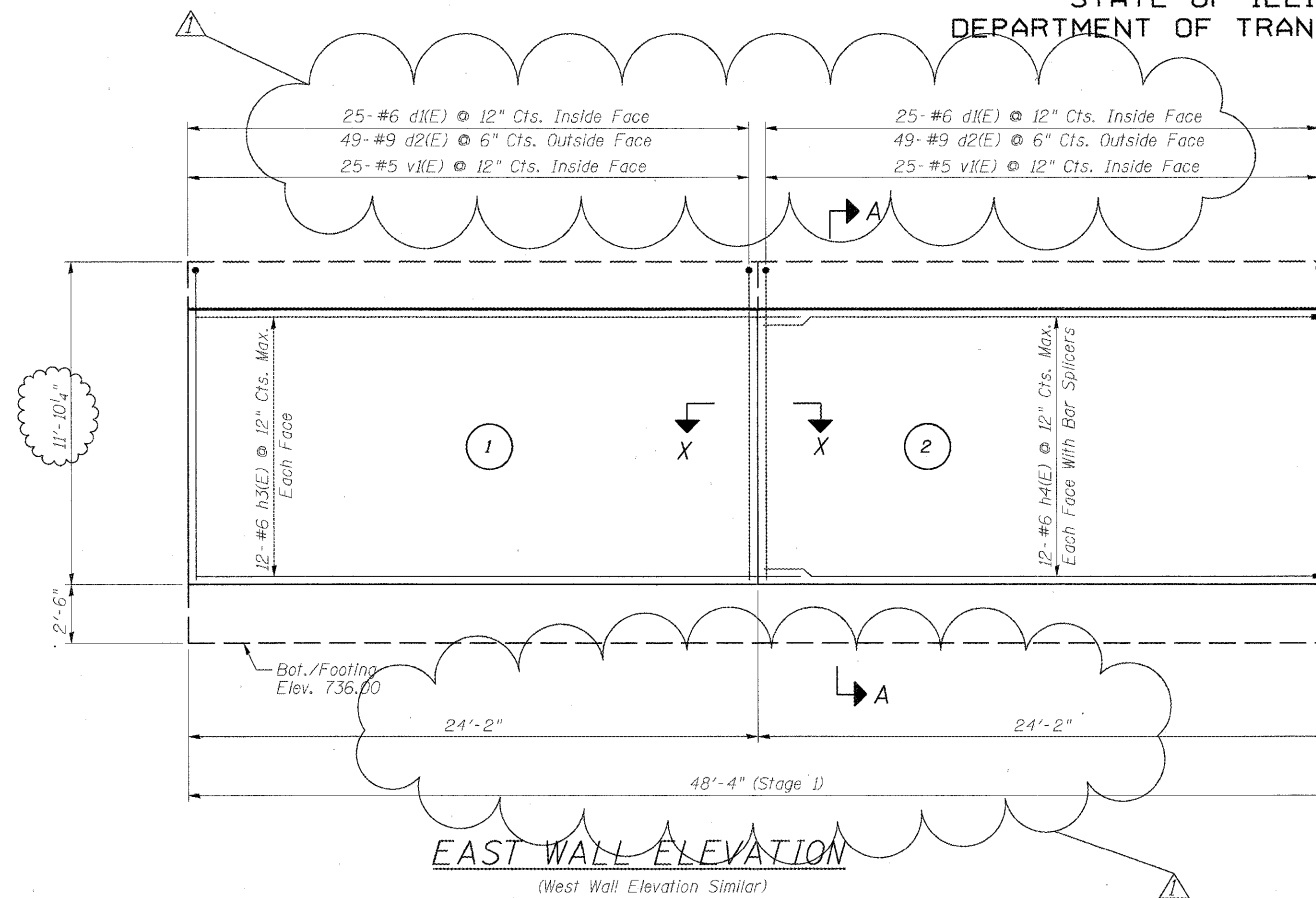

**EAST WALL ELEVATION**  
(West Wall Elevation Similar)

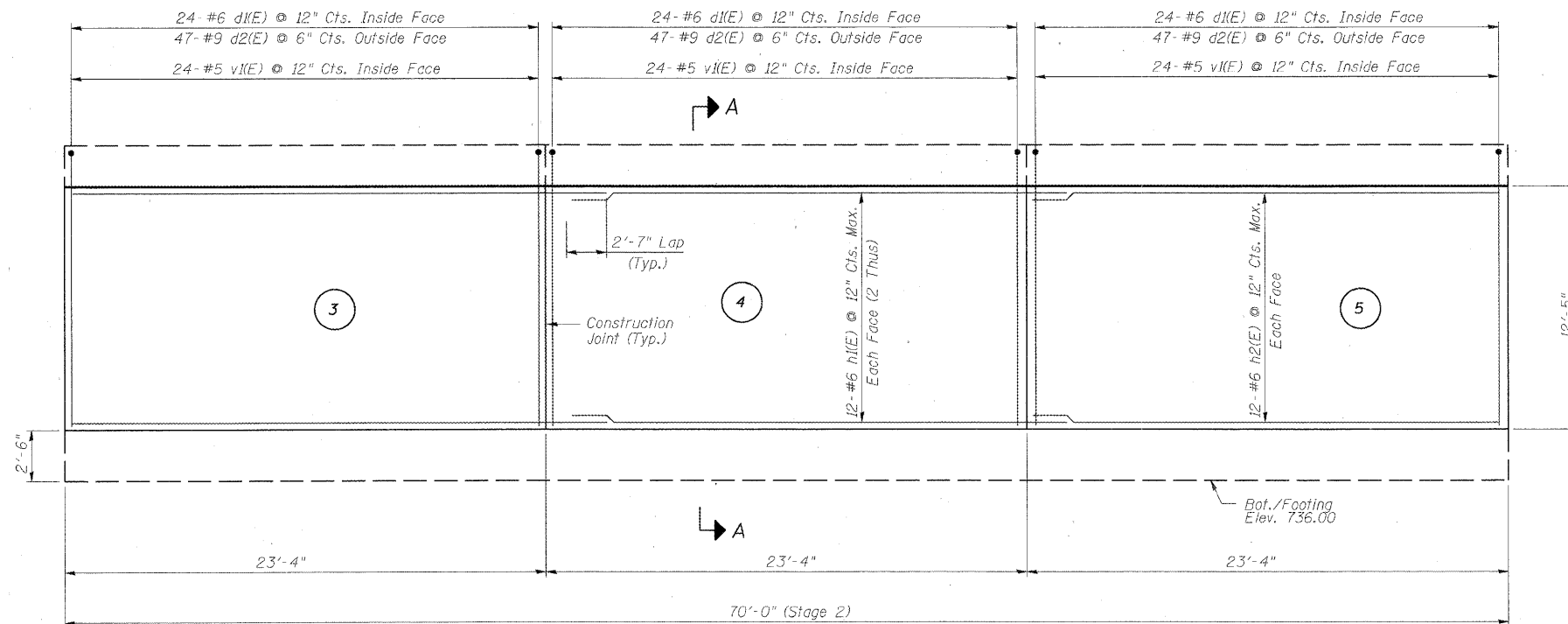

**EAST WALL ELEVATION**  
(West Wall Elevation Similar)

DESIGNED	AAY
CHECKED	AJK
DRAWN	VH
CHECKED	HMA/DMC

▲ Addendum #1 - 6/5/09

**BILL OF MATERIAL**

(Stage 1 Construction - East & West Walls)

Bar	No.	Size	Length	Shape	
d1(E)	100	#6	7'-0"	┌	
d2(E)	196	#9	18'-6"	┌	
h3(E)	48	#6	26'-9"	—	
h4(E)	48	#6	24'-0"	—	
v1(E)	100	#5	11'-6"	—	
Concrete Structures				Cu. Yd.	57.1
Reinforcement Bars, Epoxy Coated				Pound	18,240
Bar Splicers				Each	48

**BILL OF MATERIAL**

(Stage 2 Construction - East & West Walls)

Bar	No.	Size	Length	Shape	
d1(E)	144	#6	7'-0"	┌	
d2(E)	282	#9	18'-6"	┌	
h1(E)	96	#6	25'-11"	—	
h2(E)	48	#6	23'-0"	—	
v1(E)	144	#5	11'-6"	—	
Concrete Structures				Cu. Yd.	84.7
Reinforcement Bars, Epoxy Coated				Pound	26,380

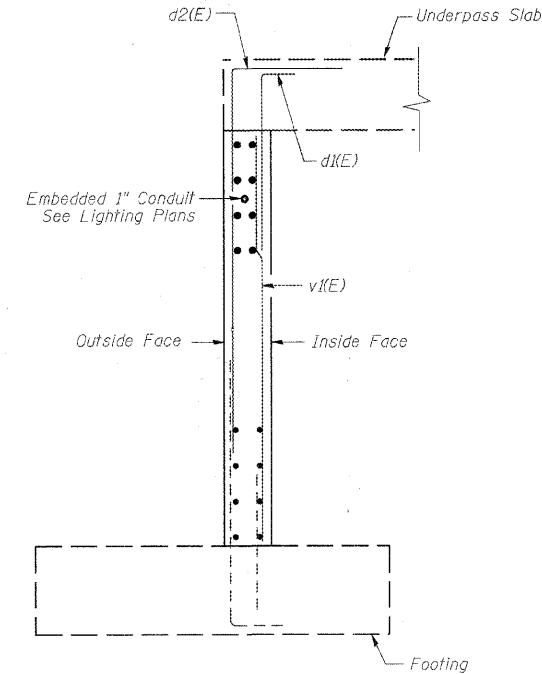

**SECTION A-A**

**Notes:**

1. Stations and offsets are measured with respect to Mixed-Use Path along IL 25/Dunham Road.
2. (1) Denotes panel number.
3. For Section X-X see sheet SA-5.

**BARS d1(E) & d2(E)**

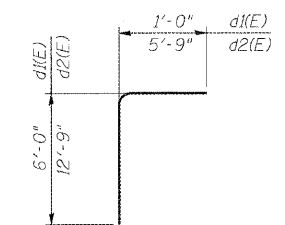

**WALL REINFORCEMENT**  
**MULTI-USE PATH UNDER**  
**IL 25/STEARNS ROAD**  
**F.A.P. 360 - SEC. 06-00214-15-BR**  
**KANE COUNTY**  
**STATION 916+09.93**  
**STRUCTURE NO. 045-3173**

**benesch**  
alfred benesch & company  
Engineers • Surveyors • Planners  
205 North Michigan Avenue, Suite 2400  
Chicago, Illinois 60601  
312-565-0450  
Job # 3944