

THIS LOCATION IS CURRENTLY PART OF A CITY OF AURORA RESURFACING PROJECT. THIS LOCATION IS ALSO CURRENTLY PART OF CITY OF AURORA TRAFFIC SIGNAL PROJECT. COORDINATION WITH THOSE CONTRACTS WILL BE REQUIRED.

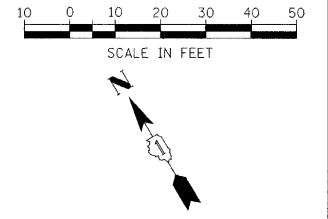

DATE	
BY	
REVISIONS	
NO.	
DATE	
BY	
REVISIONS	
NO.	
DATE	
BY	
REVISIONS	
NO.	

DATE	
BY	
REVISIONS	
NO.	
DATE	
BY	
REVISIONS	
NO.	
DATE	
BY	
REVISIONS	
NO.	

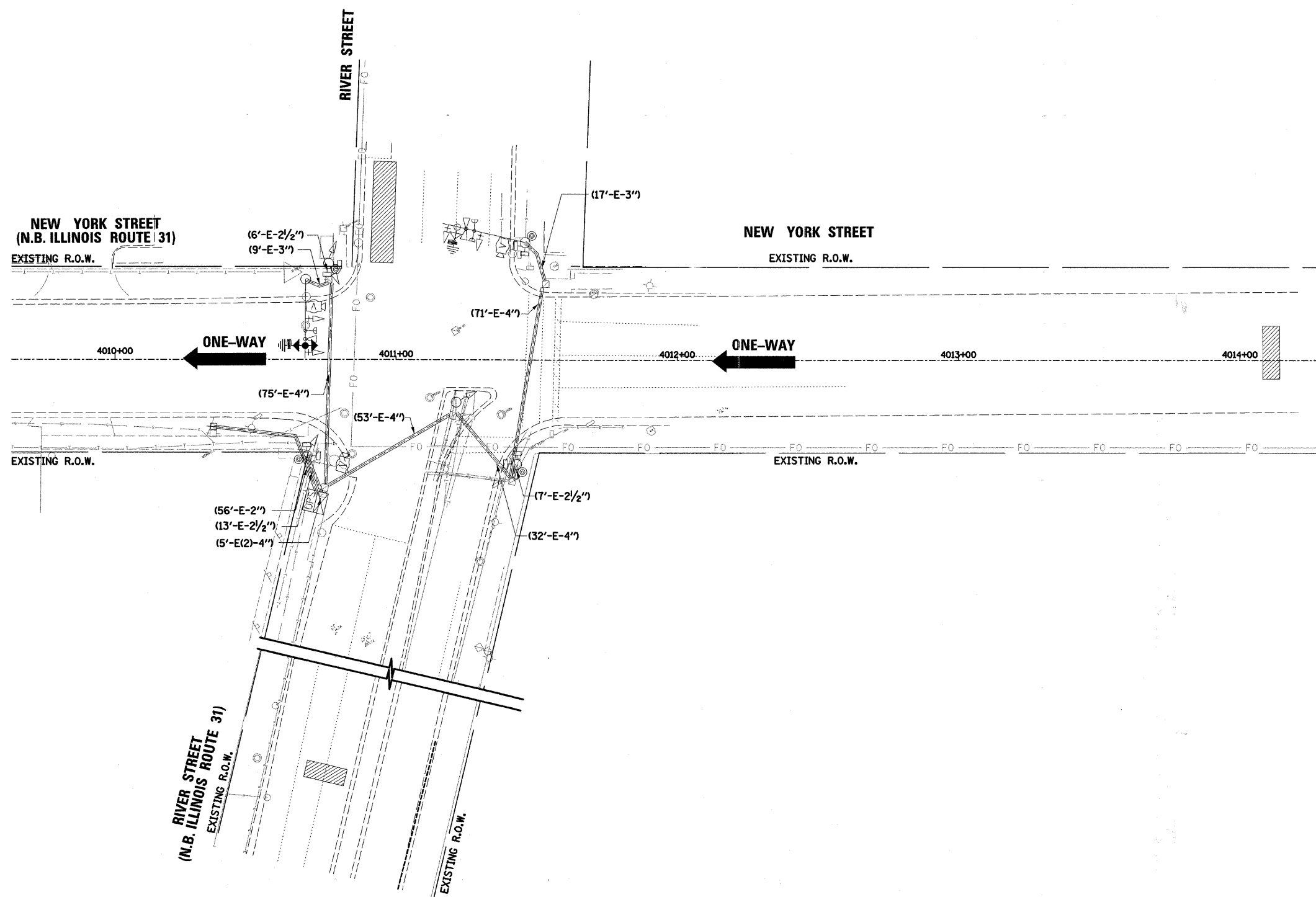

NOTE:  
THE WIRELESS ANTENNA SHALL BE MOUNTED ON THE WESTBOUND MAST ARM, 3' NORTH OF THE OUTER 3-SECTION SIGNAL HEAD OR AS DIRECTED BY THE ENGINEER (SEE MOUNTING DETAIL).

TRAFFIC SIGNAL LEGEND		
	PROPOSED	EXISTING
CONTROLLER		
SERVICE INSTALLATION		
SIGNAL HEAD		
SIGNAL HEAD WITH BACKPLATE		
SIGNAL HEAD, PEDESTRIAN		
SIGNAL POST		
MAST ARM ASSEMBLY AND POLE, STEEL		
MAST ARM ASSEMBLY AND POLE, ALUMINUM		
COMBINATION MAST ARM ASSEMBLY AND POLE, STEEL WITH LUMINAIRE		
UNIT DUCT	UD	
COMMON TRENCH	CT	
HANDHOLE		
HEAVY DUTY HANDHOLE		
DOUBLE HANDHOLE		
G.S. CONDUIT IN TRENCH (T) OR PUSHED (P)		
PEDESTRIAN PUSHBUTTON DETECTOR		
DETECTOR LOOP		
CAST IRON JUNCTION BOX		
EMERGENCY VEHICLE LIGHT DETECTOR		
CONFIRMATION BEACON		
SIGNAL HEAD OPTICALLY PROGRAMMED		
CONDUIT SPLICE		
WOOD POLE		
RACEWAY FOR MAGNETIC DETECTOR, TYPE I OR TYPE II		
VEHICLE DETECTOR, NON COMPENSATED MAGNETIC TYPE		
RAILROAD CONTROL CABINET		
TELEPHONE CONNECTION		
ILLUMINATED SIGN "NO LEFT TURN"		
ILLUMINATED SIGN "NO RIGHT TURN"		
UNINTERRUPTABLE POWER SUPPLY	UPS	
WIRELESS ANTENNA		
VIDEO DETECTION CAMERA		
VIDEO DETECTION AREA		
PAN/TILT/ZOOM CAMERA		

FILE NAME =	USER NAME = .USER.	DESIGNED -	REVISED -	<b>STATE OF ILLINOIS DEPARTMENT OF TRANSPORTATION</b>	<b>TRAFFIC SIGNAL MODIFICATION PLAN RIVER STREET (IL ROUTE 31)</b>	F.A. RTE.	SECTION	COUNTY	TOTAL SHEETS	SHEET NO.
yr\jobs\smith\2007\070690 auro - traffic	signals\070690.04 auro new york st. traffic	DRAWN by BAH	REVISED			07-00267-00-TL	KANE	48	13	
	PLOT SCALE = #SCALE#	CHECKED APS	REVISED			CONTRACT NO. 63152				
	PLOT DATE = 4/15/2009	DATE	REVISED			SCALE:	SHEET NO. OF SHEETS	STA. TO STA.	FED. ROAD DIST. NO. ILLINOIS FED. AID PROJECT	