

PLAN	SURVEYED	DATE
	PLOTTED	
	CHECKED	
	BY	
	NO. OF WAY CHECKED	
	CADD FILE NAME	
	NO.	

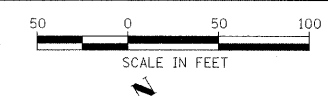

PROFILE	SURVEYED	DATE
	PLOTTED	
	CHECKED	
	BY	
	NO. OF WAY CHECKED	
	STRUCTURE NOTATION'S CRKD	
	NO.	

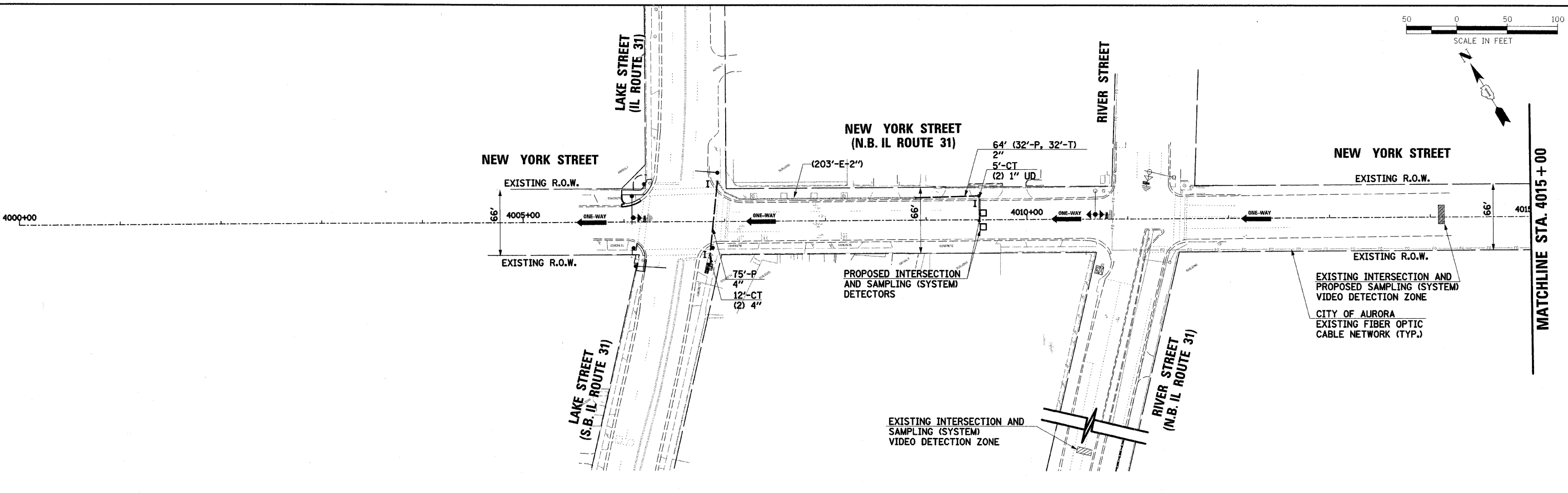
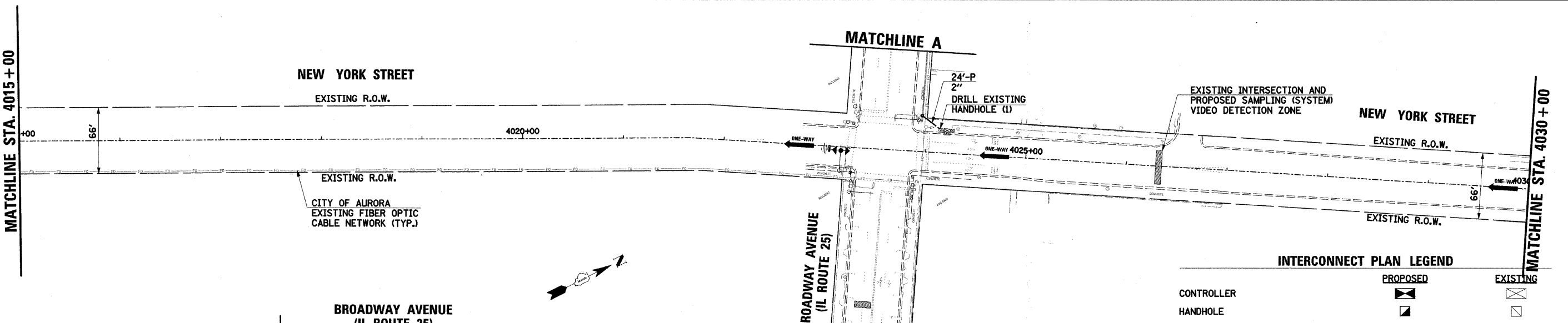

**INTERCONNECT PLAN LEGEND**

	PROPOSED	EXISTING
CONTROLLER		
HANDHOLE		
DOUBLE HANDHOLE		
HEAVY-DUTY HANDHOLE		
G.S. CONDUIT IN TRENCH (T) OR PUSHED (P)		
DETECTOR LOOP		
UNIT DUCT		
SYSTEM		
INTERSECTION		
MAST ARM ASSEMBLY AND POLE, STEEL		
WIRELESS ANTENNA		
VIDEO DETECTION ZONE		

THE TRAFFIC SIGNAL CONTROL EQUIPMENT FOR THIS PROJECT SHALL BE "ECONOLITE" TO MATCH THE EXISTING ADJACENT SYSTEM.

NOTE: THE PROPOSED TERMINAL SERVER AND ETHERNET SWITCH SHALL BE INSTALLED WITHIN THE EXISTING TRAFFIC SIGNAL CONTROLLER CABINET AT BROADWAY AVENUE (SEE SPECIAL PROVISIONS).

**RESTORATION OF WORK AREA:**  
RESTORATION OF THE TRAFFIC SIGNAL WORK AREA SHALL BE INCIDENTAL TO THE RELATED PAY ITEM SUCH AS FOUNDATION, CONDUIT, HANDHOLE, TRENCH AND BACKFILL, ETC., AND NO EXTRA COMPENSATION SHALL BE ALLOWED. ALL ROADWAY SURFACES SUCH AS SHOULDERS, MEDIANS, SIDEWALKS, PAVEMENT, ETC. SHALL BE REPLACED IN KIND. ALL DAMAGE TO MOWED LAWNS SHALL BE REPLACED WITH AN APPROVED SOD, AND ALL DAMAGE TO UNMOWED FIELDS SHALL BE SEED IN ACCORDANCE WITH STANDARD SPECIFICATIONS 252 AND 250 RESPECTIVELY.

FILE NAME = g:\jobs\smith\2007\070690 auro - traffic	USER NAME = USER	DESIGNED -	REVISED -
signals\070690.04 auro new york st.traffic	DRAWN by BAH	CHECKED APS	REVISED -
		DATE -	REVISED -

STATE OF ILLINOIS  
DEPARTMENT OF TRANSPORTATION

INTERCONNECT PLAN  
(SHEET 1 OF 4)

SCALE:	SHEET NO.	OF SHEETS	STA.	TO STA.
--------	-----------	-----------	------	---------

F.A. RTE.	SECTION	COUNTY	TOTAL SHEETS	SHEET NO.
	07-00267-00-TL	KANE	48	37
CONTRACT NO.			63152	
FED. ROAD DIST. NO. [ILLINOIS] FED. AID PROJECT				