

F.A. RTE.	SECTION	COUNTY	TOTAL SHEETS	SHEET NO.
	06-00069-00-BT	COOK	24	7
STA. 10+00		TO STA. 22+00		
FED. ROAD DIST. NO.	ILLINOIS	FED. AID PROJECT		

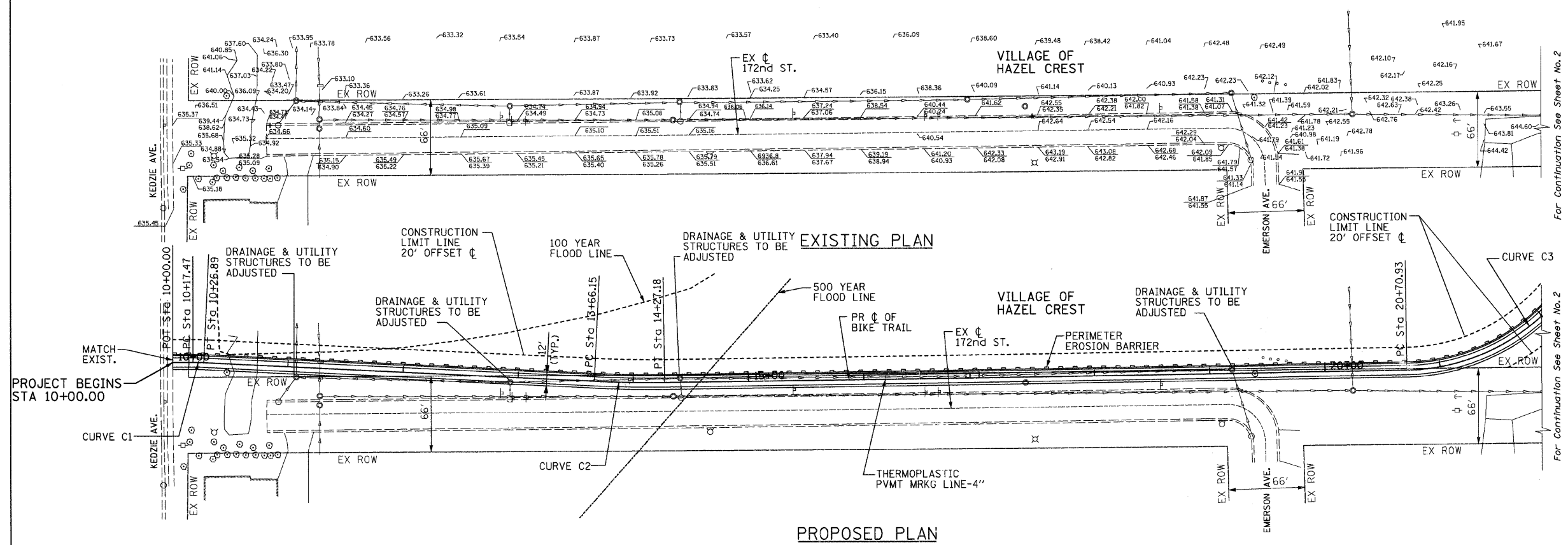

PROP. CURVE C1  
 PI STA. = 10+22.18  
 $\Delta = 2^\circ 42' 00''$  (RT)  
 $D = 28^\circ 38' 52''$   
 $R = 200.00'$   
 $T = 4.71'$   
 $L = 9.42'$   
 $E = 0.06'$   
 $e =$   
 $T.R. =$   
 $S.E. RUN =$   
 $P.C. STA. = 10+17.47$   
 $P.T. STA. = 10+26.89$

PROP. CURVE C2  
 PI STA. = 13+96.68  
 $\Delta = 3^\circ 29' 48''$  (LT)  
 $D = 5^\circ 43' 46''$   
 $R = 1,000.00'$   
 $T = 30.52'$   
 $L = 61.03'$   
 $E = 0.47'$   
 $e =$   
 $T.R. =$   
 $S.E. RUN =$   
 $P.C. STA. = 13+66.15$   
 $P.T. STA. = 14+27.18$

PROP. CURVE C3  
 PI STA. = 22+46.91  
 $\Delta = 89^\circ 59' 41''$  (LT)  
 $D = 32^\circ 33' 16''$   
 $R = 176.00'$   
 $T = 175.98'$   
 $L = 276.44'$   
 $E = 72.89'$   
 $e =$   
 $T.R. =$   
 $S.E. RUN =$   
 $P.C. STA. = 20+70.93$   
 $P.T. STA. = 23+47.37$

CIVIL / STRUCTURAL ENGINEERS

GLOBETROTTERS INTERNATIONAL.  
300 SOUTH WACKER DRIVE, SUITE 200  
CHICAGO, IL. 60606

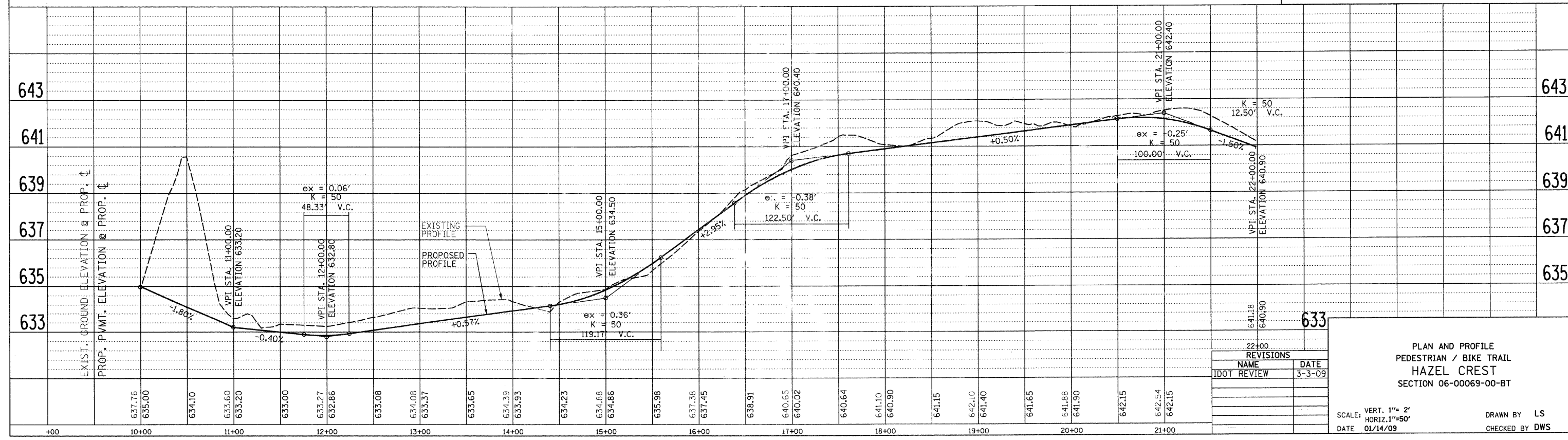

REVISIONS	
NAME	DATE
IDOT REVIEW	3-3-09

PLAN AND PROFILE  
 PEDESTRIAN / BIKE TRAIL  
 HAZEL CREST  
 SECTION 06-00069-00-BT

SCALE: VERT. 1"= 2'  
 HORIZ. 1"=50'  
 DATE 01/14/09

DRAWN BY LS  
 CHECKED BY DWS