

F.A. RTE.	SECTION	COUNTY	TOTAL SHEETS	SHEET NO.
06-0069-00-BT		COOK	24	8
STA. 22+00		TO STA. 31+00		
FED. ROAD DIST. NO.		ILLINOIS FED. AID PROJECT		

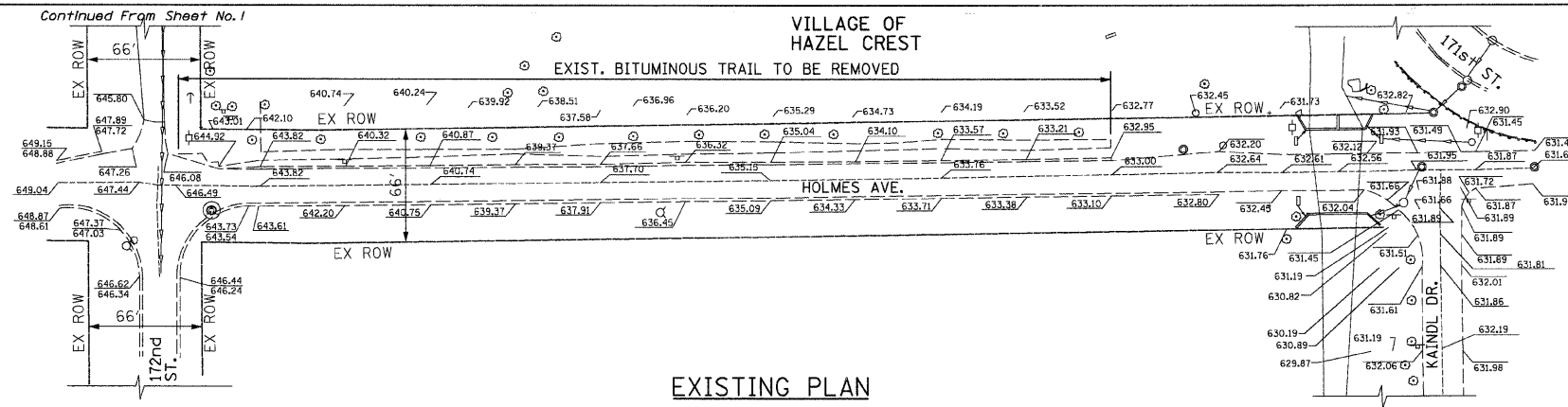

PROP. CURVE C3 PI STA. = 22+46.91 $\Delta = 89^\circ 59' 41''$ (LT) $D = 32^\circ 33' 16''$ $R = 176.00'$ $T = 175.98'$ $L = 276.44'$ $E = 72.89'$ $e = \text{---}$ $T.R. = \text{---}$ $S.E. RUN = \text{---}$ $P.C. STA. = 20+70.93$ $P.T. STA. = 23+47.37$	PROP. CURVE C4 PI STA. = 27+94.69 $\Delta = 90^\circ 47' 32''$ (RT) $D = 636^\circ 37' 11''$ $R = 9.00'$ $T = 9.13'$ $L = 14.26'$ $E = 3.82'$ $e = \text{---}$ $T.R. = \text{---}$ $S.E. RUN = \text{---}$ $P.C. STA. = 27+85.57$ $P.T. STA. = 27+99.83$	PROP. CURVE C5 PI STA. = 28+43.23 $\Delta = 91^\circ 13' 25''$ (LT) $D = 358^\circ 05' 55''$ $R = 16.00'$ $T = 16.35'$ $L = 25.47'$ $E = 6.87'$ $e = \text{---}$ $T.R. = \text{---}$ $S.E. RUN = \text{---}$ $P.C. STA. = 28+26.88$ $P.T. STA. = 28+52.36$
--	---	---

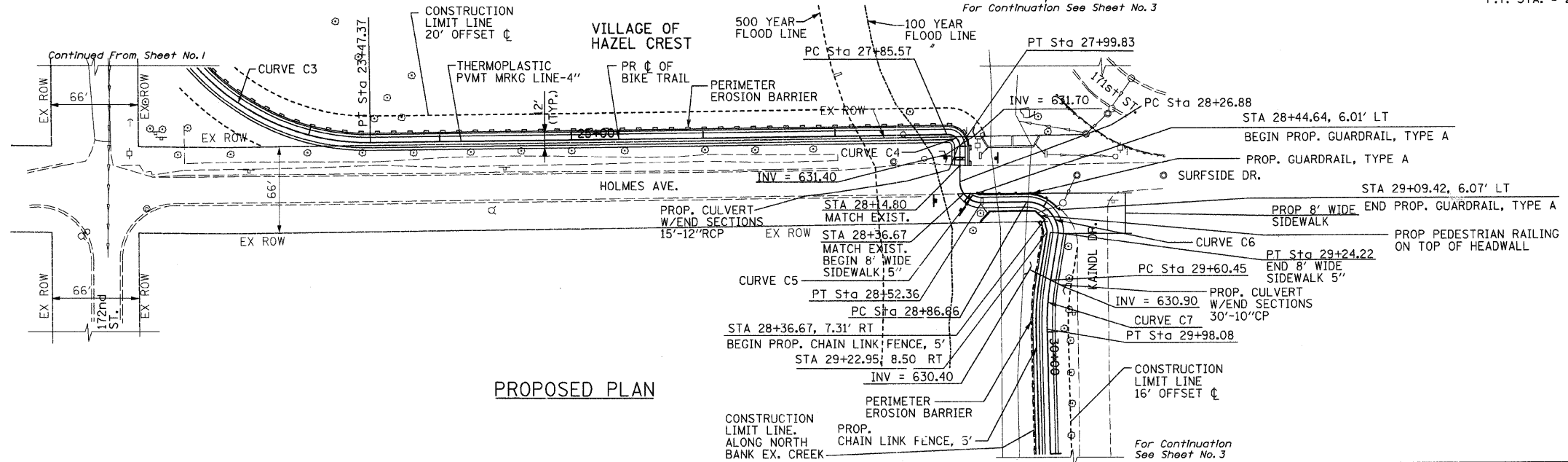

PROP. CURVE C6 PI STA. = 29+10.52 $\Delta = 89^\circ 39' 39''$ (RT) $D = 238^\circ 43' 57''$ $R = 24.00'$ $T = 23.86'$ $L = 37.56'$ $E = 9.84'$ $e = \text{---}$ $T.R. = \text{---}$ $S.E. RUN = \text{---}$ $P.C. STA. = 28+86.66$ $P.T. STA. = 29+24.22$	PROP. CURVE C7 PI STA. = 29+79.32 $\Delta = 10^\circ 46' 52''$ (LT) $D = 28^\circ 38' 52''$ $R = 200.00'$ $T = 18.87'$ $L = 37.63'$ $E = 0.89'$ $e = \text{---}$ $T.R. = \text{---}$ $S.E. RUN = \text{---}$ $P.C. STA. = 29+60.45$ $P.T. STA. = 29+98.08$
---	---

NOTE:
SEE SHT.-12 FOR DETAILS

CIVIL / STRUCTURAL ENGINEERS

GLOBETROTTERS INTERNATIONAL.
300 SOUTH WACKER DRIVE, SUITE 200
CHICAGO, IL. 60606

642

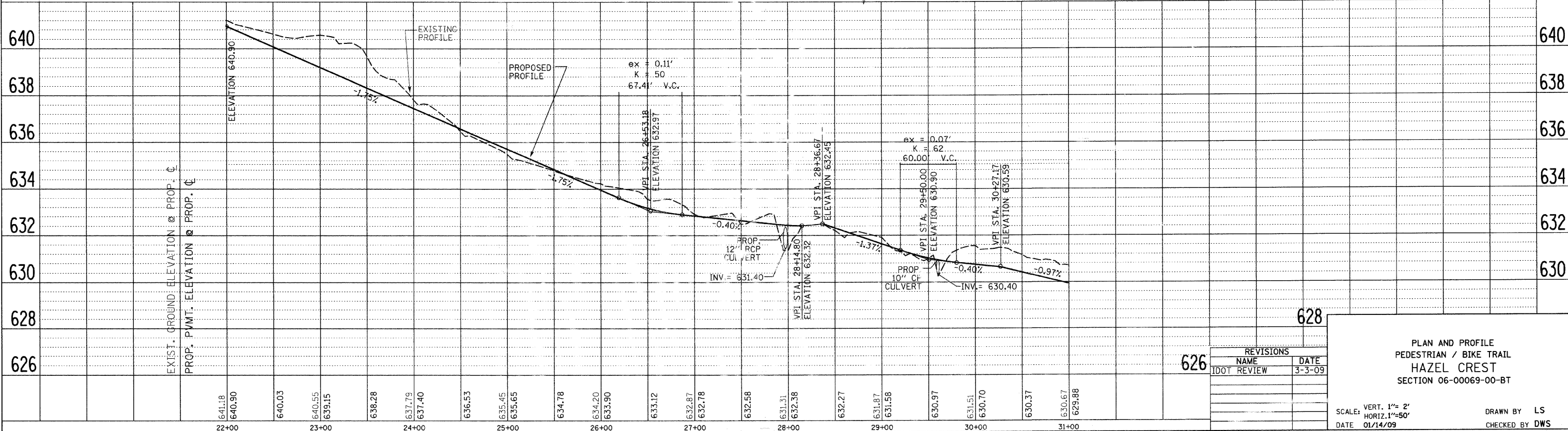

626

628

REVISIONS	
NAME	DATE
IDOT REVIEW	3-3-09

PLAN AND PROFILE
PEDESTRIAN / BIKE TRAIL
HAZEL CREST
SECTION 06-0069-00-BT

SCALE: VERT. 1"= 2'
HORIZ. 1"=50'
DATE 01/14/09

DRAWN BY LS
CHECKED BY DWS