

|                     |                |        |              |           |
|---------------------|----------------|--------|--------------|-----------|
| F.A. RTE.           | SECTION        | COUNTY | TOTAL SHEETS | SHEET NO. |
|                     | 06-00069-00-BT | COOK   | 24           | 12        |
| STA.                | TO STA.        |        |              |           |
| FED. ROAD DIST. NO. | ILLINOIS       |        |              |           |

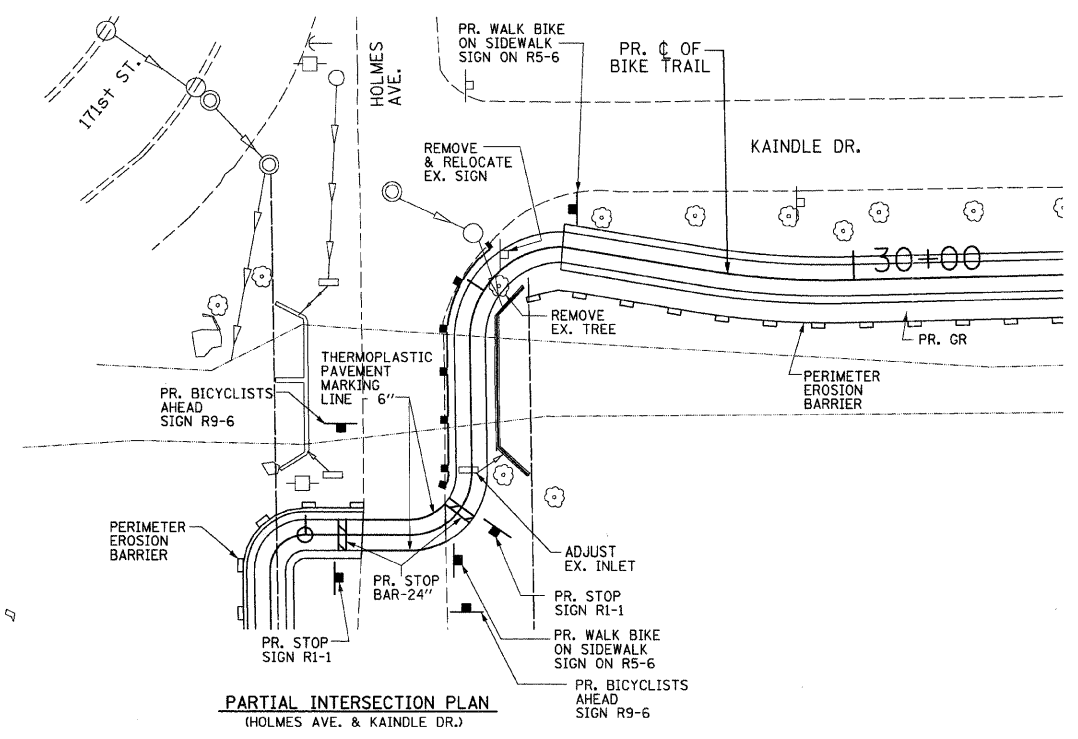

**PARTIAL INTERSECTION PLAN**  
(HOLMES AVE. & KAINDE DR.)

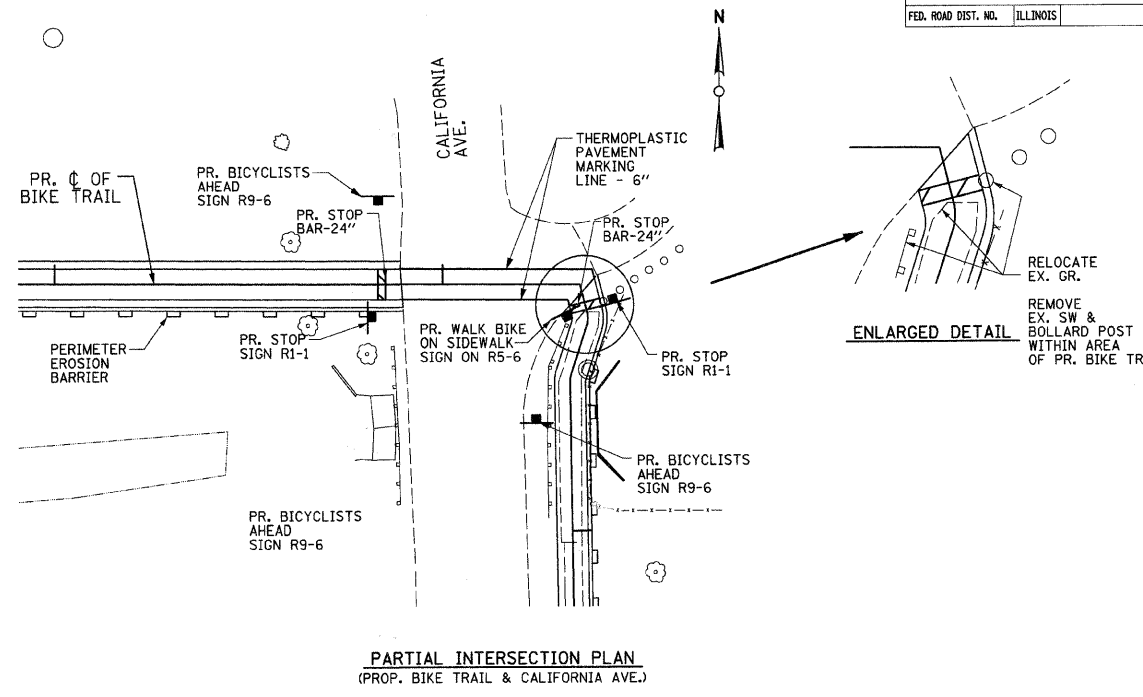

**PARTIAL INTERSECTION PLAN**  
(PROP. BIKE TRAIL & CALIFORNIA AVE.)

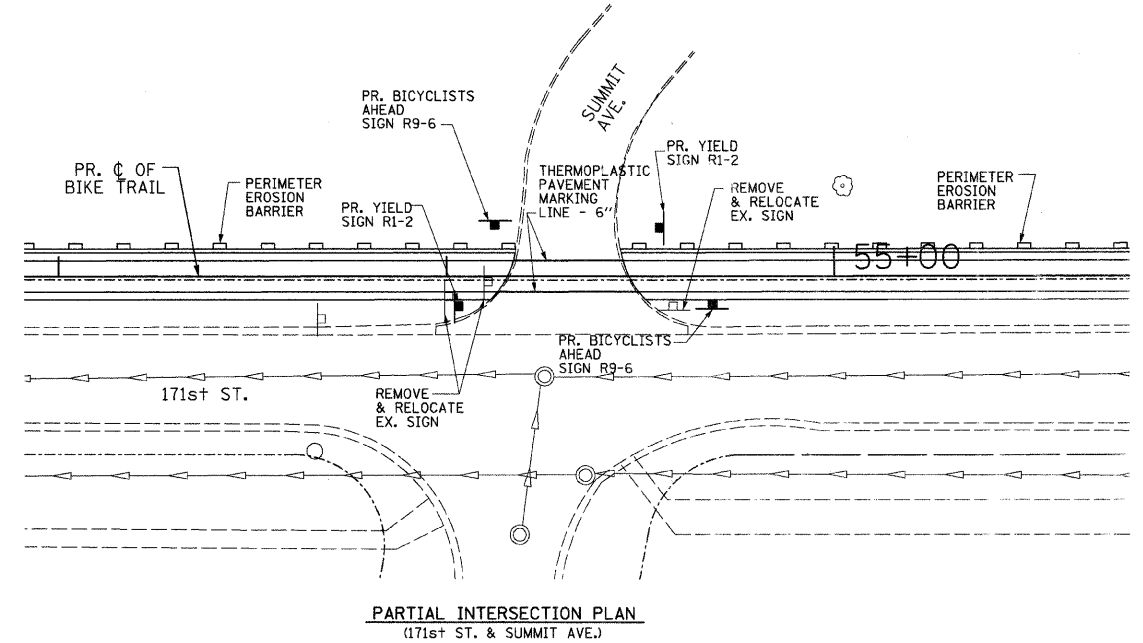

**PARTIAL INTERSECTION PLAN**  
(171st ST. & SUMMIT AVE.)

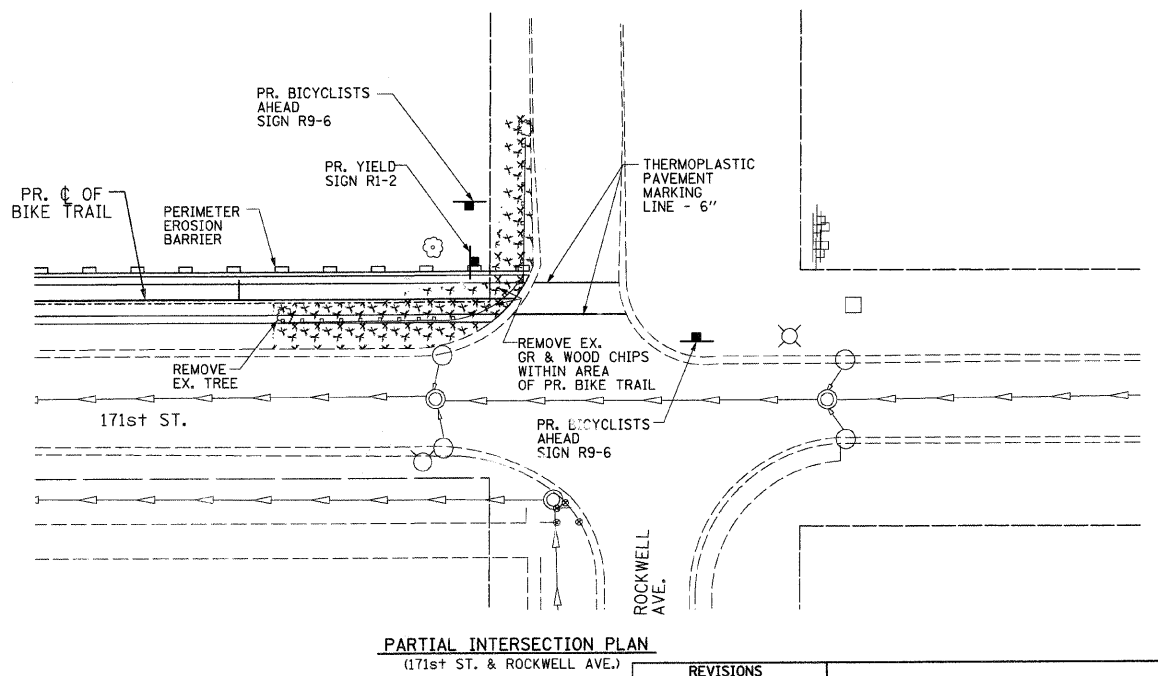

**PARTIAL INTERSECTION PLAN**  
(171st ST. & ROCKWELL AVE.)

P:\cod\msv8\pen\_tables\dot.tbl Color - Monochrome  
 tds600-raster on fs10.plt

CIVIL / STRUCTURAL ENGINEERS  
  
**GLOBETROTTERS INTERNATIONAL.**  
 300 SOUTH WACKER DRIVE, SUITE 200  
 CHICAGO, IL. 60606

| REVISIONS   |        |
|-------------|--------|
| NAME        | DATE   |
| IDOT REVIEW | 3-3-09 |
|             |        |
|             |        |
|             |        |
|             |        |
|             |        |
|             |        |
|             |        |

**REMOVAL ITEMS, PROPOSED SIGNS & PAVEMENT MARKINGS**  
 PEDESTRIAN / BIKE TRAIL  
 HAZEL CREST, IL  
 SECTION NO. 06-00069-00-BT

SCALE: VERT. N/A  
 HORIZ. 1"=20'  
 DATE 01/14/09

DRAWN BY L.S.  
 CHECKED BY D.W.S.

P:\proj\06069\05726\003\C\Sheet\12\_Rem Items\_Pr Sign\_Pr Pmnt Mkg\_C0L.dgn  
 3/2/2009  
 3:32:02 PM