

F.A.P. RTE.	SECTION	COUNTY	TOTAL SHEETS	SHEET NO.
309	(17R)B	WHITESIDE	376	1

*376+2=378
*378+4=382

D-92-139-05

PROJECT ENGINEER: REBECCA MARRUFFO

SQUAD LEADER: HEATH JORDAN 815-284-5355

STATE OF ILLINOIS
DEPARTMENT OF TRANSPORTATION
DIVISION OF HIGHWAYS

**PROPOSED
HIGHWAY PLANS**
FAP ROUTE 309 (US 30)
SECTION (17R)B
PROJECT NHF-BRF-0309(011)
WHITESIDE COUNTY
C-92-079-08

SEE SHEET 2 FOR INDEX OF SHEETS AND STANDARDS



LOCATION OF SECTION INDICATED THUS: - [thick black line] -

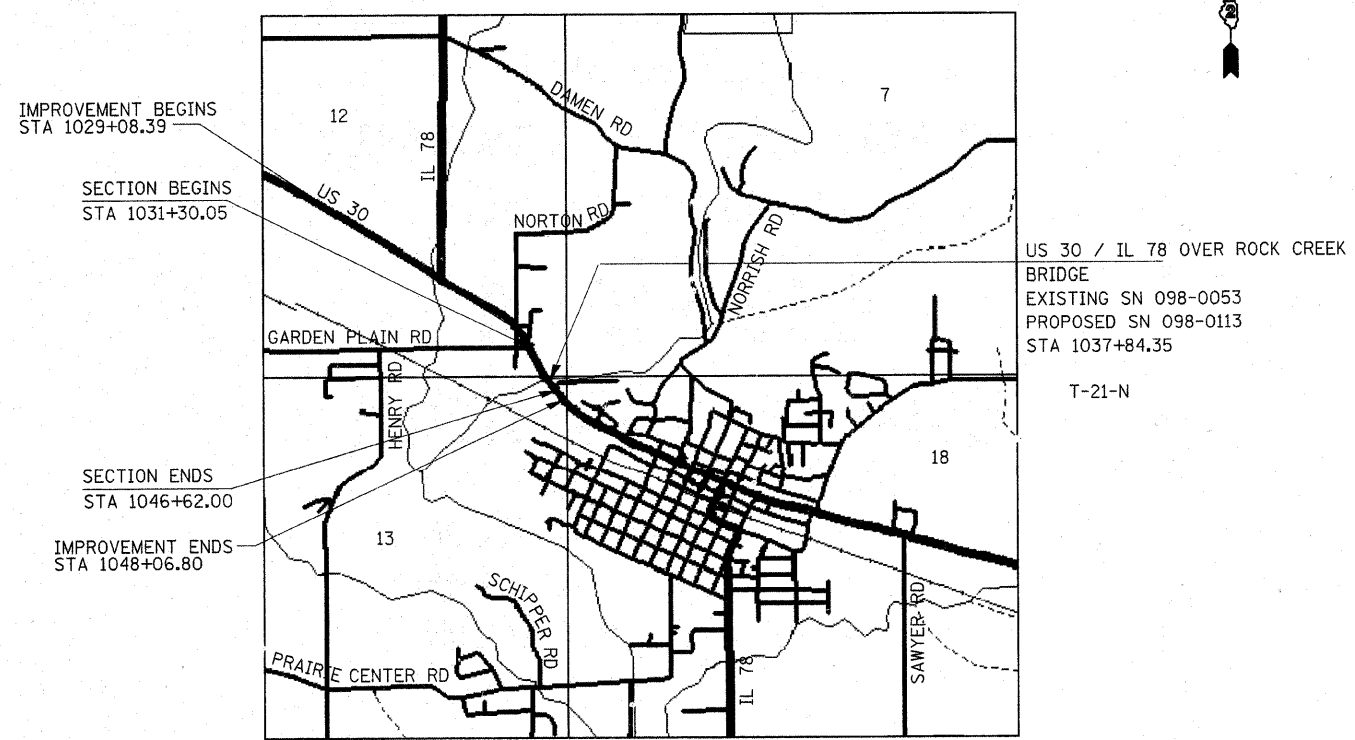

R-4-E R-5-E

T-21-N

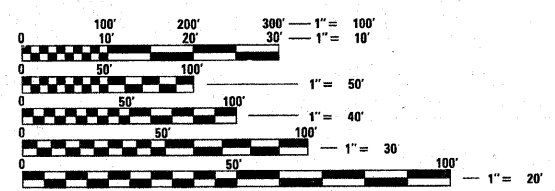

NET LENGTH OF PROJECT = 1532 FT = 0.29 MILES
GROSS LENGTH OF PROJECT = 1532 FT = 0.29 MILES

UNION GROVE TOWNSHIP, SECTIONS 12, 13

J.U.L.I.E.
JOINT UTILITY LOCATION INFORMATION FOR EXCAVATION
1-800-892-0123

CONTRACT NO. 64B74

STATE OF ILLINOIS
DEPARTMENT OF TRANSPORTATION
DIVISION OF HIGHWAYS

SUBMITTED 3/16 2009

Henry F. Ryan
DEPUTY DIRECTOR OF HIGHWAYS, REGION ENGINEER

May 8, 2009
Charles G. Ingersoll
ENGINEER OF DESIGN AND ENVIRONMENT

May 8, 2009
Christine M. Reed
DIRECTOR OF HIGHWAYS, CHIEF ENGINEER

PRINTED BY THE AUTHORITY OF THE STATE OF ILLINOIS