

F.A.P. RTE.	SECTION	COUNTY	TOTAL SHEETS	SHEET NO.
310	60-15VB-1&2	MADISON	144	14
STA.	TO STA.			
FED. ROAD DIST. NO.	ILLINOIS	FED. AID PROJECT		
CONTRACT NO. 71423A				

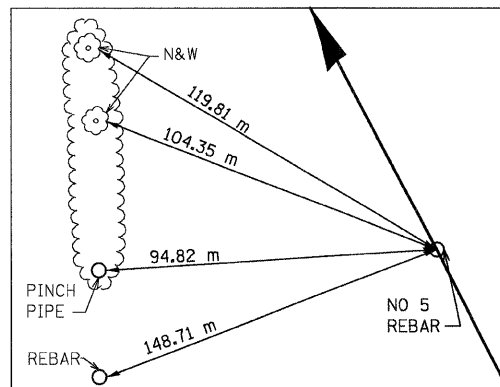

RAMP 'E' PC STA 0+000.000

N 255,345.1831 E 698,296.7091

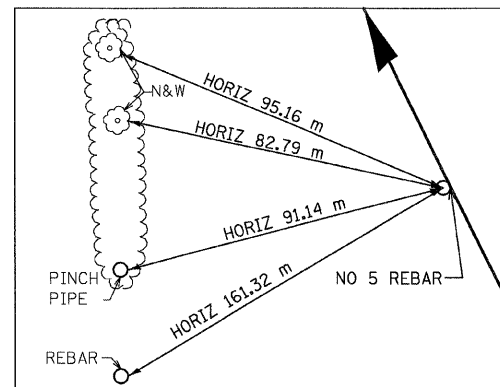

RAMP 'E' PI STA 0+027.227

N 255,369.1972 E 698,283.8793

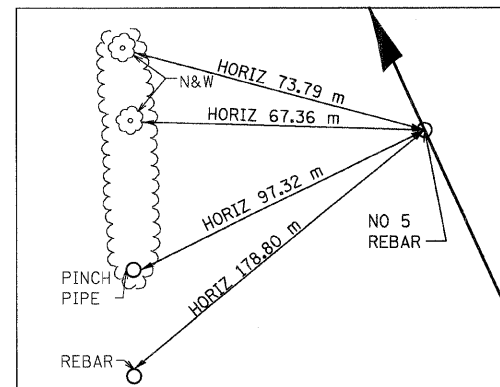

RAMP 'E' PT STA 0+054.429

N 255,394.0784 E 698,272.8245

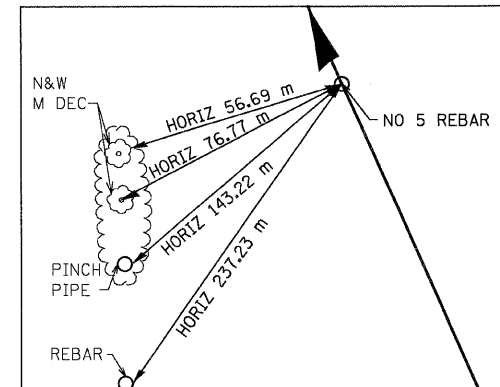

RAMP 'E' PC STA 0+130.213

N 255,463.3338 E 698,242.0541

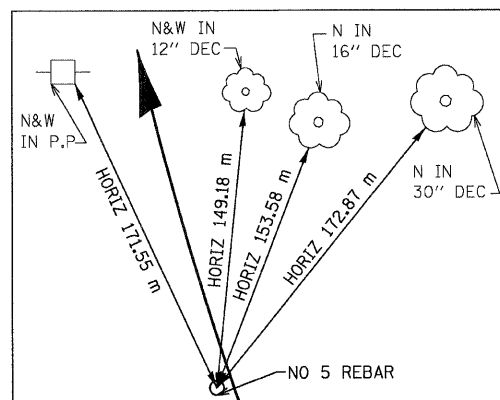

RAMP 'E' PI STA 0+154.487

N 255,485.5169 E 698,232.1980

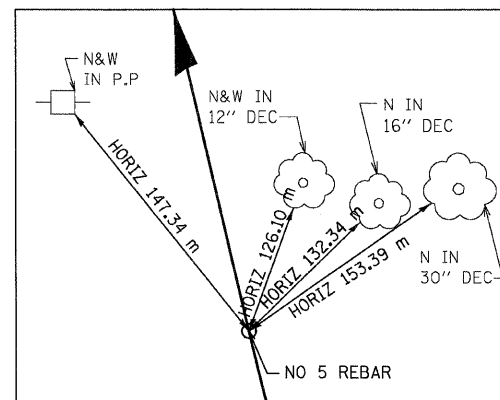

RAMP 'E' PT STA 0+178.615

N 255,509.1612 E 698,226.7044

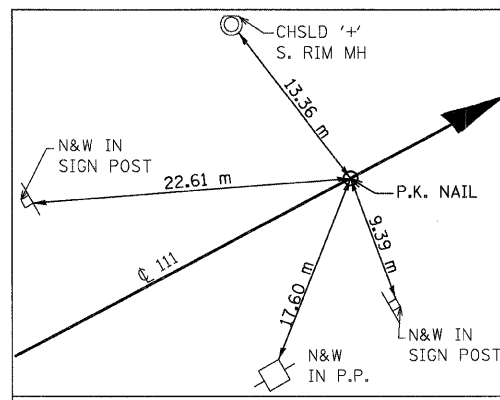

RAMP 'E' POT STA 0+417.387

N 255,741.7385 E 698,172.6663

NOTES:

- 1) DIMENSIONS LABELED "HORIZ" ARE HORIZONTAL PULLS.
- 2) DIMENSIONS NOT LABELED "HORIZ" ARE DIRECT PULLS.



(TYP ALL TIES THIS DWG)

REVISIONS		ILLINOIS DEPARTMENT OF TRANSPORTATION HORIZONTAL CONTROL TIES FAP 310 (IL 255) SECTION 60-15VB-1&2 MADISON COUNTY DRAWN BY CES CHECKED BY
NAME	DATE	
		DATE