

PLAN	DATE
DESIGNED	
CHECKED	
PLOTTED	
NOTED	
NO.	

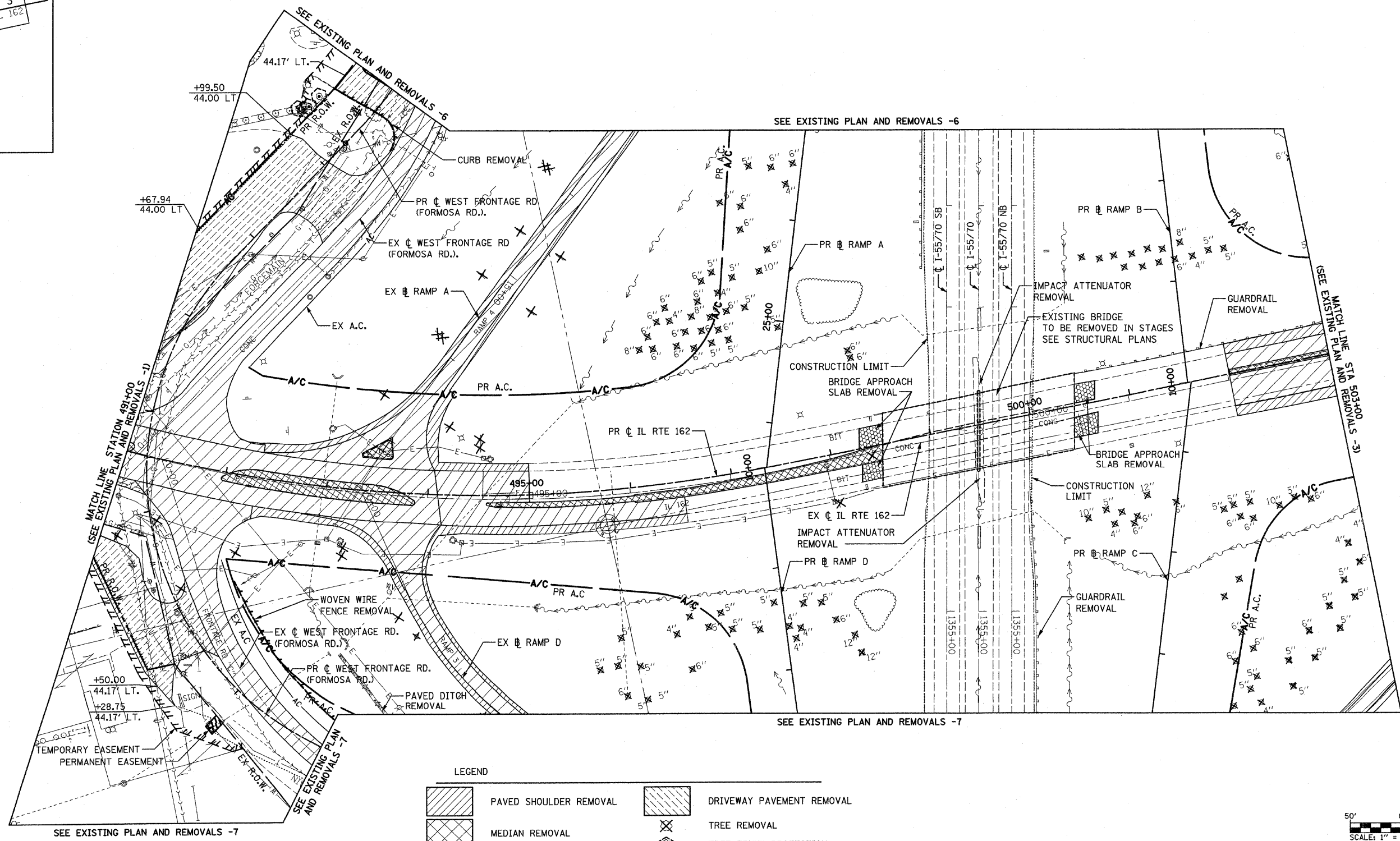

LEGEND

	PAVED SHOULDER REMOVAL		DRIVEWAY PAVEMENT REMOVAL
	MEDIAN REMOVAL		TREE REMOVAL
	PAVEMENT REMOVAL		TREE TRUNK PROTECTION
	HOT-MIX ASPHALT SURFACE REMOVAL		ITEM TO BE REMOVED
	BRIDGE APPROACH SLAB REMOVAL		DELINEATOR REMOVAL
			TRAFFIC SIGN REMOVAL

- NOTES:
- SEE DRAINAGE PLAN SHEETS FOR EXISTING PIPE, CULVERTS AND STRUCTURE REMOVALS.
 - DRIVEWAY STATION OFFSETS ARE MEASURED FROM THE PROPOSED CENTERLINE.

REVISIONS	
NAME	DATE

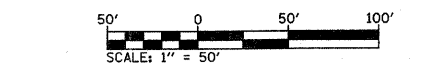

ILLINOIS DEPARTMENT OF TRANSPORTATION
EXISTING PLAN AND REMOVALS -2

FAI ROUTE 70
 SECTION 60-10K-1, 60-10HB
 MADISON COUNTY

DRAWN BY: GRH
 PLOT DATE: *DATE-TIME*

DWM-SPEC
 *REF- 236crml.dgn
 *REF- 236g1p.dgn
 *REF- 236cc01.dgn
 *REF- 236cc02.dgn
 *REF- 236cc03.dgn
 *REF- 236cc04.dgn
 *REF- 236cc05.dgn
 *REF- 236cc06.dgn
 *REF- 236cc07.dgn
 *REF- 236cc08.dgn
 *REF- 236cc09.dgn
 *REF- 236cc10.dgn
 *REF- 236cc11.dgn
 *REF- 236cc12.dgn
 *REF- 236cc13.dgn
 *REF- 236cc14.dgn
 *REF- 236cc15.dgn
 *REF- 236cc16.dgn
 *REF- 236cc17.dgn
 *REF- 236cc18.dgn
 *REF- 236cc19.dgn
 *REF- 236cc20.dgn
 *REF- 236cc21.dgn
 *REF- 236cc22.dgn
 *REF- 236cc23.dgn
 *REF- 236cc24.dgn
 *REF- 236cc25.dgn
 *REF- 236cc26.dgn
 *REF- 236cc27.dgn
 *REF- 236cc28.dgn
 *REF- 236cc29.dgn
 *REF- 236cc30.dgn
 *REF- 236cc31.dgn
 *REF- 236cc32.dgn
 *REF- 236cc33.dgn
 *REF- 236cc34.dgn
 *REF- 236cc35.dgn
 *REF- 236cc36.dgn
 *REF- 236cc37.dgn
 *REF- 236cc38.dgn
 *REF- 236cc39.dgn
 *REF- 236cc40.dgn
 *REF- 236cc41.dgn
 *REF- 236cc42.dgn
 *REF- 236cc43.dgn
 *REF- 236cc44.dgn
 *REF- 236cc45.dgn
 *REF- 236cc46.dgn
 *REF- 236cc47.dgn
 *REF- 236cc48.dgn
 *REF- 236cc49.dgn
 *REF- 236cc50.dgn
 *REF- 236cc51.dgn
 *REF- 236cc52.dgn
 *REF- 236cc53.dgn
 *REF- 236cc54.dgn
 *REF- 236cc55.dgn
 *REF- 236cc56.dgn
 *REF- 236cc57.dgn
 *REF- 236cc58.dgn
 *REF- 236cc59.dgn
 *REF- 236cc60.dgn
 *REF- 236cc61.dgn
 *REF- 236cc62.dgn
 *REF- 236cc63.dgn
 *REF- 236cc64.dgn
 *REF- 236cc65.dgn
 *REF- 236cc66.dgn
 *REF- 236cc67.dgn
 *REF- 236cc68.dgn
 *REF- 236cc69.dgn
 *REF- 236cc70.dgn
 *REF- 236cc71.dgn
 *REF- 236cc72.dgn
 *REF- 236cc73.dgn
 *REF- 236cc74.dgn
 *REF- 236cc75.dgn
 *REF- 236cc76.dgn
 *REF- 236cc77.dgn
 *REF- 236cc78.dgn
 *REF- 236cc79.dgn
 *REF- 236cc80.dgn
 *REF- 236cc81.dgn
 *REF- 236cc82.dgn
 *REF- 236cc83.dgn
 *REF- 236cc84.dgn
 *REF- 236cc85.dgn
 *REF- 236cc86.dgn
 *REF- 236cc87.dgn
 *REF- 236cc88.dgn
 *REF- 236cc89.dgn
 *REF- 236cc90.dgn
 *REF- 236cc91.dgn
 *REF- 236cc92.dgn
 *REF- 236cc93.dgn
 *REF- 236cc94.dgn
 *REF- 236cc95.dgn
 *REF- 236cc96.dgn
 *REF- 236cc97.dgn
 *REF- 236cc98.dgn
 *REF- 236cc99.dgn
 *REF- 236cc100.dgn