

FAH ROUTE	SECTION	COUNTY	TOTAL SHEETS	SHEET NO
70	*	MADISON	420	58
STA. 10+00		TO STA. 14+00		
CONTRACT NO.: 76709				
• 60-10K-1, 60-10HB				

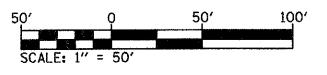

PLAN	SURVEYED	DATE
	PLOTTED	BY
	NOTED	
	REVISIONS	
	NO. OF WAY CHECKED	
	PAID FILE NAME	

PROFILE	SURVEYED	DATE
	PLOTTED	BY
	NOTED	
	REVISIONS	
	NO. OF WAY CHECKED	
	PAID FILE NAME	

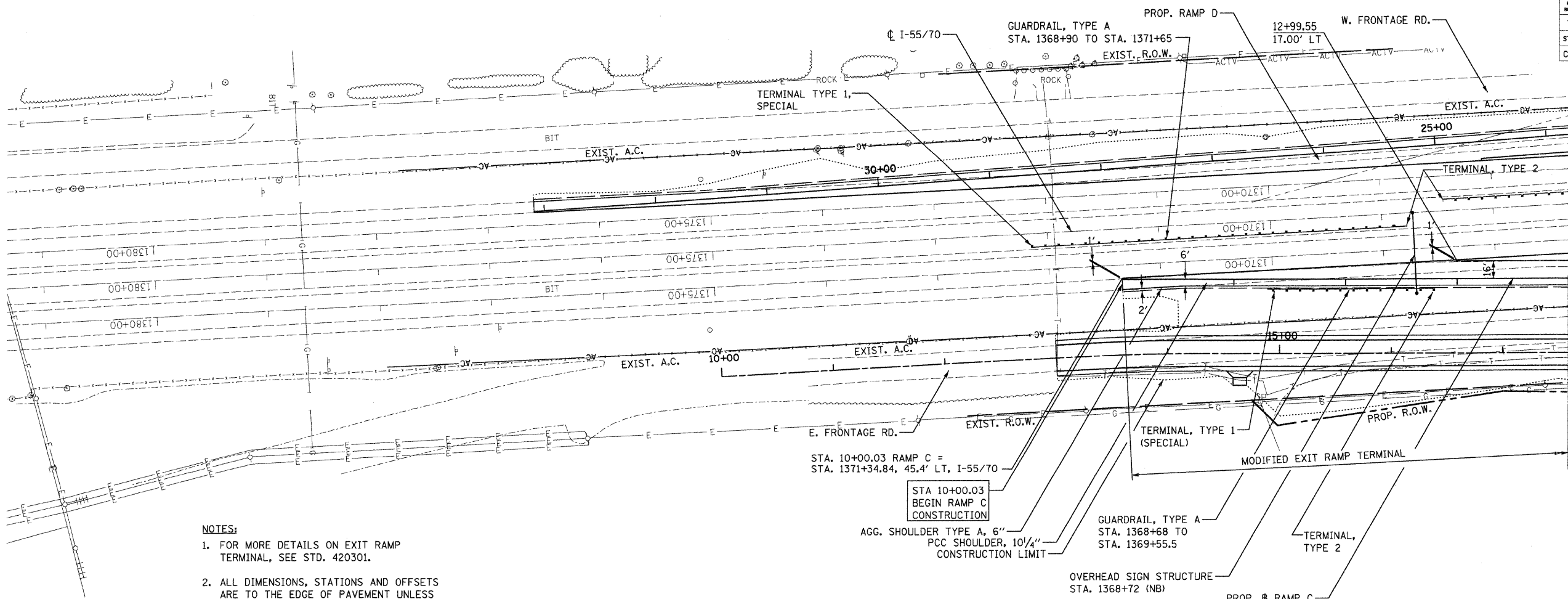

- NOTES:**
- FOR MORE DETAILS ON EXIT RAMP TERMINAL, SEE STD. 420301.
  - ALL DIMENSIONS, STATIONS AND OFFSETS ARE TO THE EDGE OF PAVEMENT UNLESS OTHERWISE NOTED.

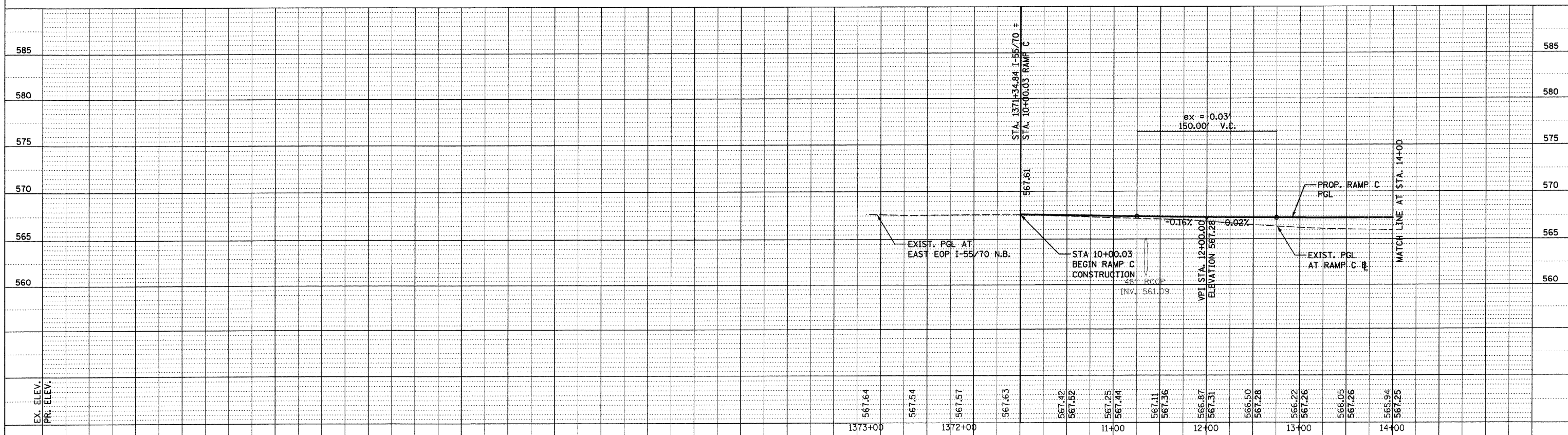

PROPOSED PLAN & PROFILE - 13  
RAMP C

DATE-TIME  
DGN-SPEC  
REF: 236e0100.dgn  
REF: 236e0010.dgn  
REF: 236e0010.dgn  
REF: 236e0010.dgn  
REF: 236e0010.dgn