

FAI ROUTE	SECTION	COUNTY	TOTAL SHEETS	SHEET NO
70	*	MADISON	420	97
STA. 494+00		TO STA. 518+00		
CONTRACT NO.: 76709				
• 60-10K-1, 60-10HB				

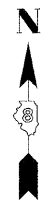

PLAN	SURVEYED	DATE
	BY	
	NOTED	
	CHECKED	
	DATE	
	NO.	

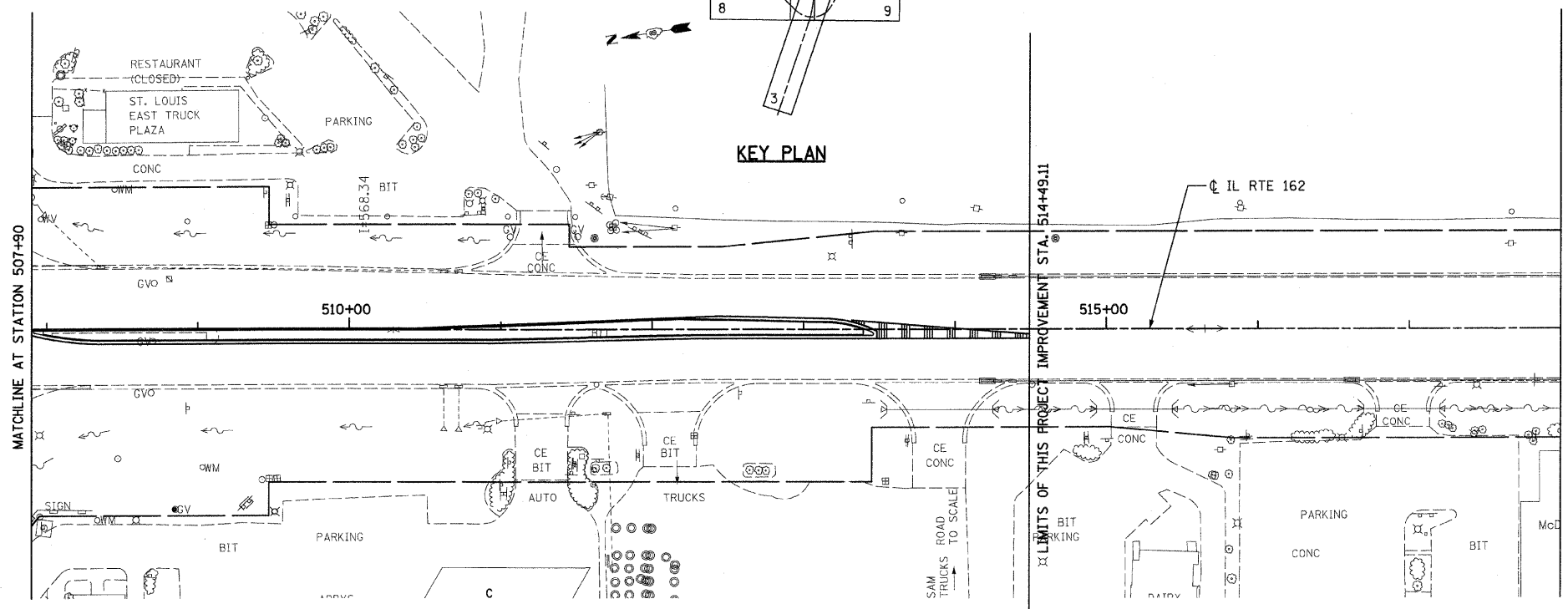
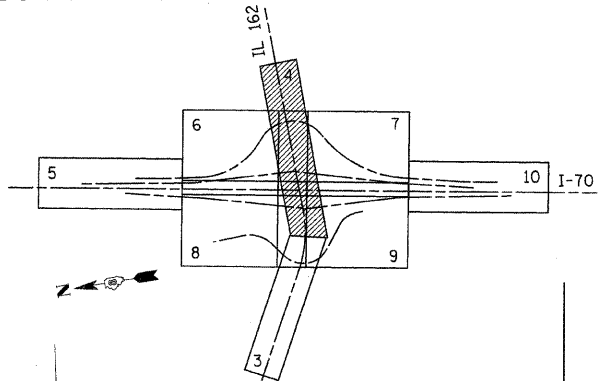
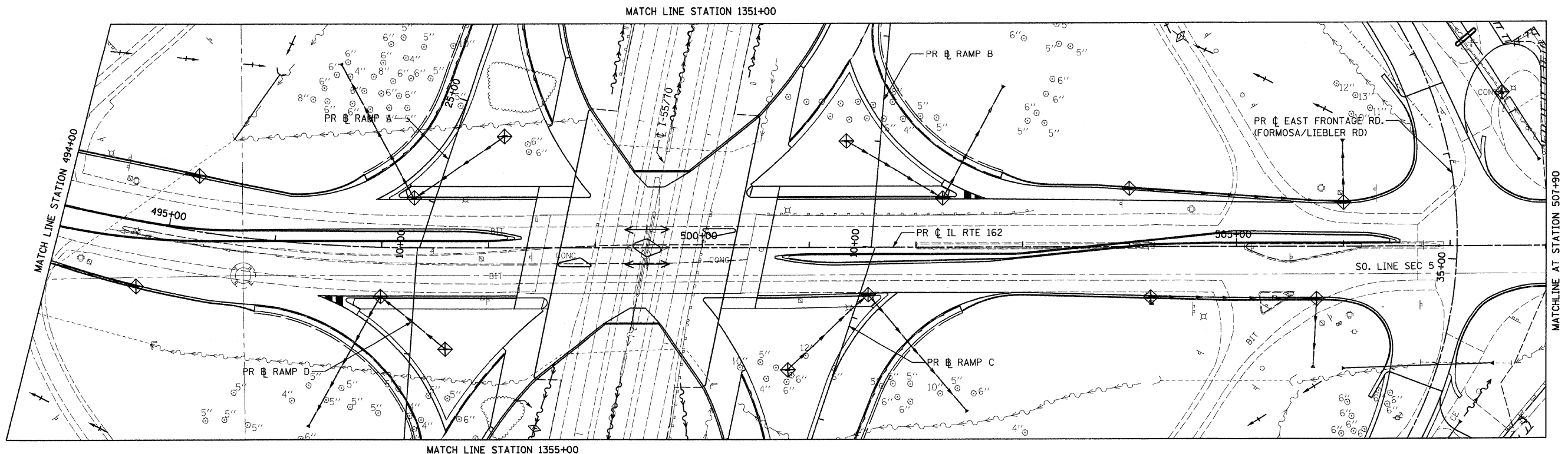

LEGEND

	TEMPORARY DITCH CHECK
	EROSION CONTROL BLANKET
	PERIMETER EROSION BARRIER
	INLET AND PIPE PROTECTION

- NOTES:**
- FOR DRAINAGE INFORMATION, SEE DRAINAGE PLANS.
 - PERIMETER EROSION BARRIER IS LOCATED ON TEMPORARY EASEMENT/PERMANENT EASEMENT/R.O.W. LINE, AS SHOWN ON THE PLANS.
 - FOR PERMANENT EROSION CONTROL INFORMATION, SEE SEEDING PLANS.
 - FOR EROSION CONTROL DURING STAGED CONSTRUCTION, SEE EROSION CONTROL AND TEMPORARY DRAINAGE PLAN.

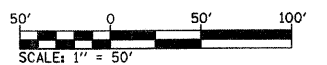

ILLINOIS DEPARTMENT OF TRANSPORTATION
STORM WATER POLLUTION PREVENTION PLAN - 4

FAI ROUTE 70
 SECTION 60-10K-1, 60-10HB
 MADISON COUNTY

REVISIONS	
NAME	DATE

DRAWN BY: GRH

PLOT DATE: *DATE-TIME*

DATE-TIME
 DGN-5PEC
 DGN-5P01.dgn
 REF- 236c01.dgn
 REF- 236c01.dgn
 REF- 236c01.dgn
 REF- 236c01.dgn
 REF- 236c01.dgn