

| FAI ROUTE | SECTION | COUNTY | TOTAL SHEETS | SHEET NO |
|--------------------|---------|---------------------|--------------|----------|
| 70 | * | MADISON | 420 | 100 |
| STA. 1353+15.77 | | TO STA. 1365+00 | | |
| CONTRACT NO. 76709 | | • 60-10K-1, 60-10HB | | |

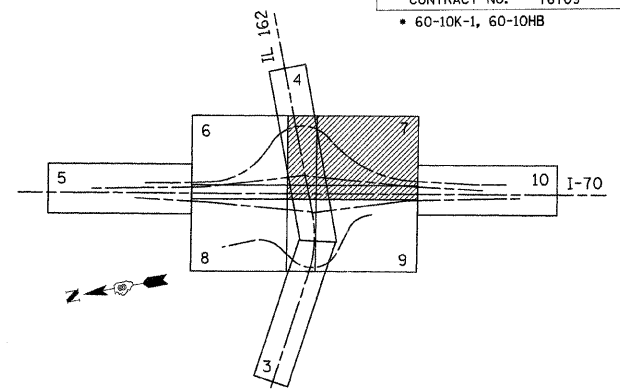

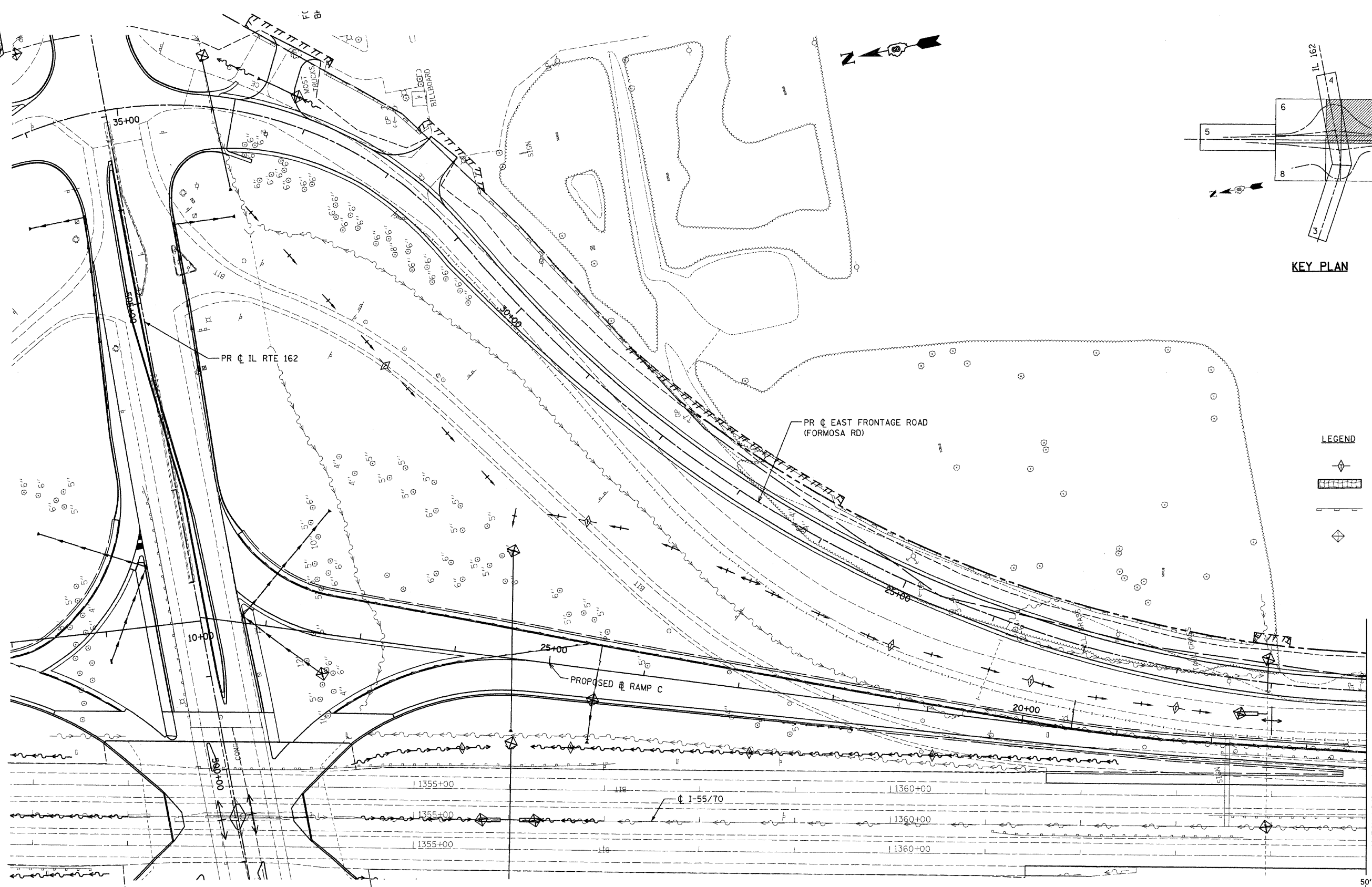



KEY PLAN

| | | |
|------|--------------------|------|
| PLAN | SURVEYED | DATE |
| | PLOTTED | BY |
| | NOTE BOOK NO. | |
| | RT. OF WAY CHECKED | |
| | CADD FILE NAME | |



LEGEND

-  TEMPORARY DITCH CHECK
-  EROSION CONTROL BLANKET
-  PERIMETER EROSION BARRIER
-  INLET AND PIPE PROTECTION

MATCH LINE STATION 1365+00

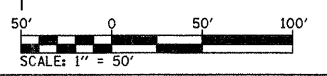

- NOTES:**
- FOR DRAINAGE INFORMATION, SEE DRAINAGE PLANS.
 - PERIMETER EROSION BARRIER IS LOCATED ON TEMPORARY EASEMENT/PERMANENT EASEMENT/R.O.W. LINE, AS SHOWN ON THE PLANS.
 - FOR PERMANENT EROSION CONTROL INFORMATION, SEE SEEDING PLANS.
 - FOR EROSION CONTROL DURING STAGED CONSTRUCTION, SEE EROSION CONTROL AND TEMPORARY DRAINAGE PLAN.

| REVISIONS | |
|-----------|------|
| NAME | DATE |
| | |
| | |
| | |
| | |

ILLINOIS DEPARTMENT OF TRANSPORTATION
STORM WATER POLLUTION PREVENTION PLAN - 7
 FAI ROUTE 70
 SECTION 60-10K-1, 60-10HB
 MADISON COUNTY

DRAWN BY: GRH
 PLOT DATE: *DATE-TIME*

DATE-TIME
 DGN-SPEC
 *REF- 236ct001.dgn
 *REF- 236ct002.dgn
 *REF- 236ct003.dgn
 *REF- 236ct004.dgn
 *REF- 236ct005.dgn
 *REF- 236ct006.dgn
 *REF- 236ct007.dgn
 *REF- 236ct008.dgn
 *REF- 236ct009.dgn
 *REF- 236ct010.dgn