

| FAI ROUTE | SECTION | COUNTY | TOTAL SHEETS | SHEET NO |
|---------------------|---------|----------------|--------------|----------|
| 70 | | MADISON | 420 | 130 |
| STA. 494+00 | | TO STA. 499+80 | | |
| CONTRACT NO.: 76709 | | | | |
| • 60-10K-1, 60-10HB | | | | |

NOTES:

- FOR BRIDGE APPROACH PAVEMENT INFO SEE BRIDGE APPROACH PAVEMENT DETAILS.
- ALL DIMENSIONS, STATIONS, AND OFFSETS ARE TO THE EDGE OF PAVEMENT UNLESS OTHERWISE NOTED.
- FOR MORE INFORMATION ON CONCRETE MEDIAN SEE INTERSECTION LAYOUT DETAILS - 2.
- FOR MORE BRIDGE INFO SEE STRUCTURAL SHEETS.

| | | |
|-----------|-----------|------|
| PLAN | SURVEYED | DATE |
| NOTE BOOK | ALIGNED | |
| NO. | CHECKED | |
| | BY | |
| | FILE NAME | |

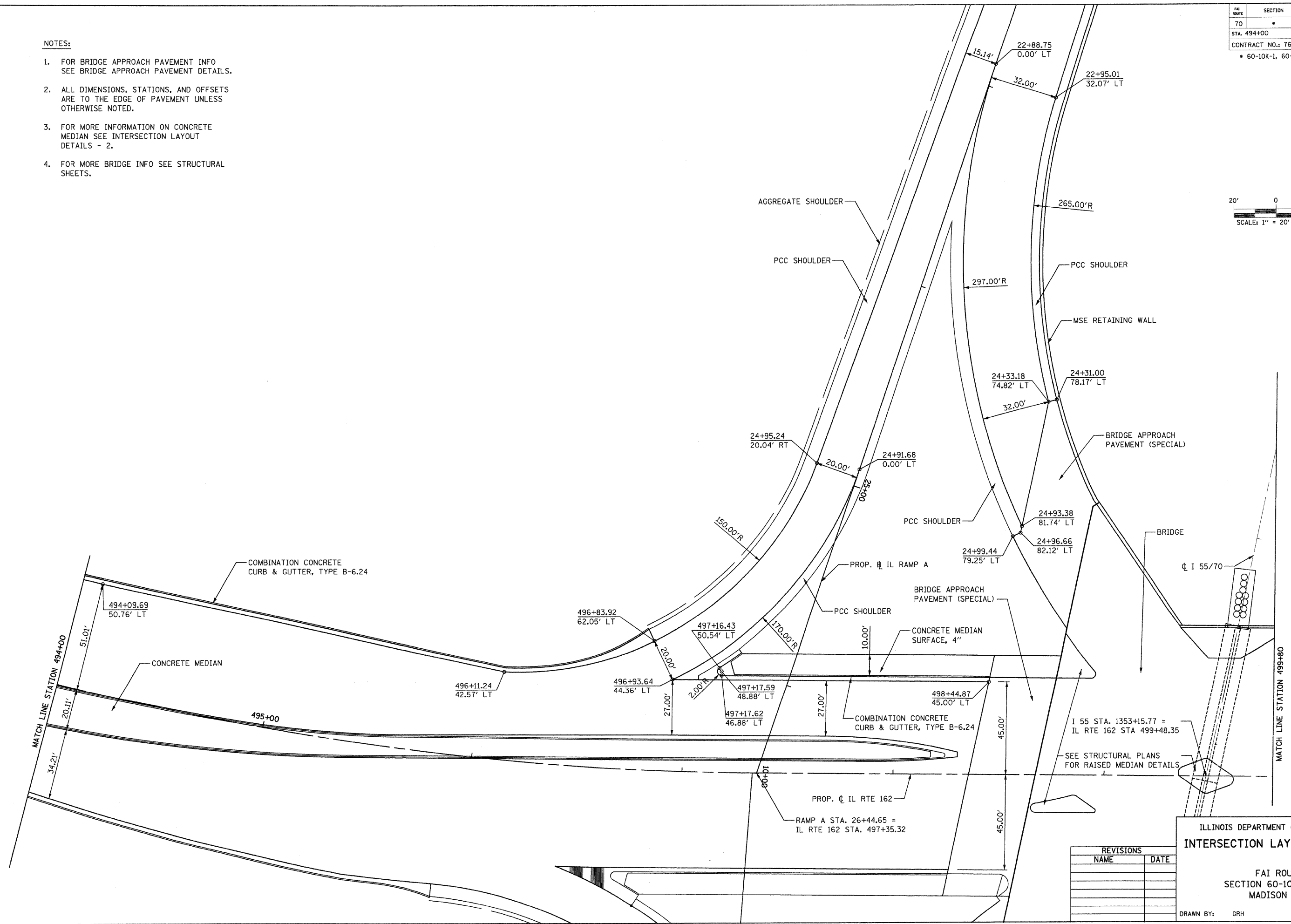
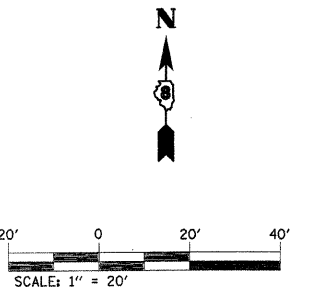

| REVISIONS | |
|-----------|------|
| NAME | DATE |
| | |
| | |
| | |
| | |
| | |

ILLINOIS DEPARTMENT OF TRANSPORTATION
INTERSECTION LAYOUT DETAILS - 4
 FAI ROUTE 70
 SECTION 60-10K-1, 60-10HB
 MADISON COUNTY
 DRAWN BY: GRH
 PLOT DATE: *DATE-TIME*

SCALE: 1" = 20'
 REF: 236C010.450
 REF: 236C010.450