

FAI ROUTE	SECTION	COUNTY	TOTAL SHEETS	SHEET NO
70		MADISON	420	134
STA. 494+00		TO STA. 499+80		
CONTRACT NO.: 76709				
• 60-10K-1, 60-10HB				

PLAN	SURVEYED	DATE
NOTE BOOK	ALIGNED	
NO.	RT. OF WAY CHECKED	
	NO.	
	ADD. FILE NAME	

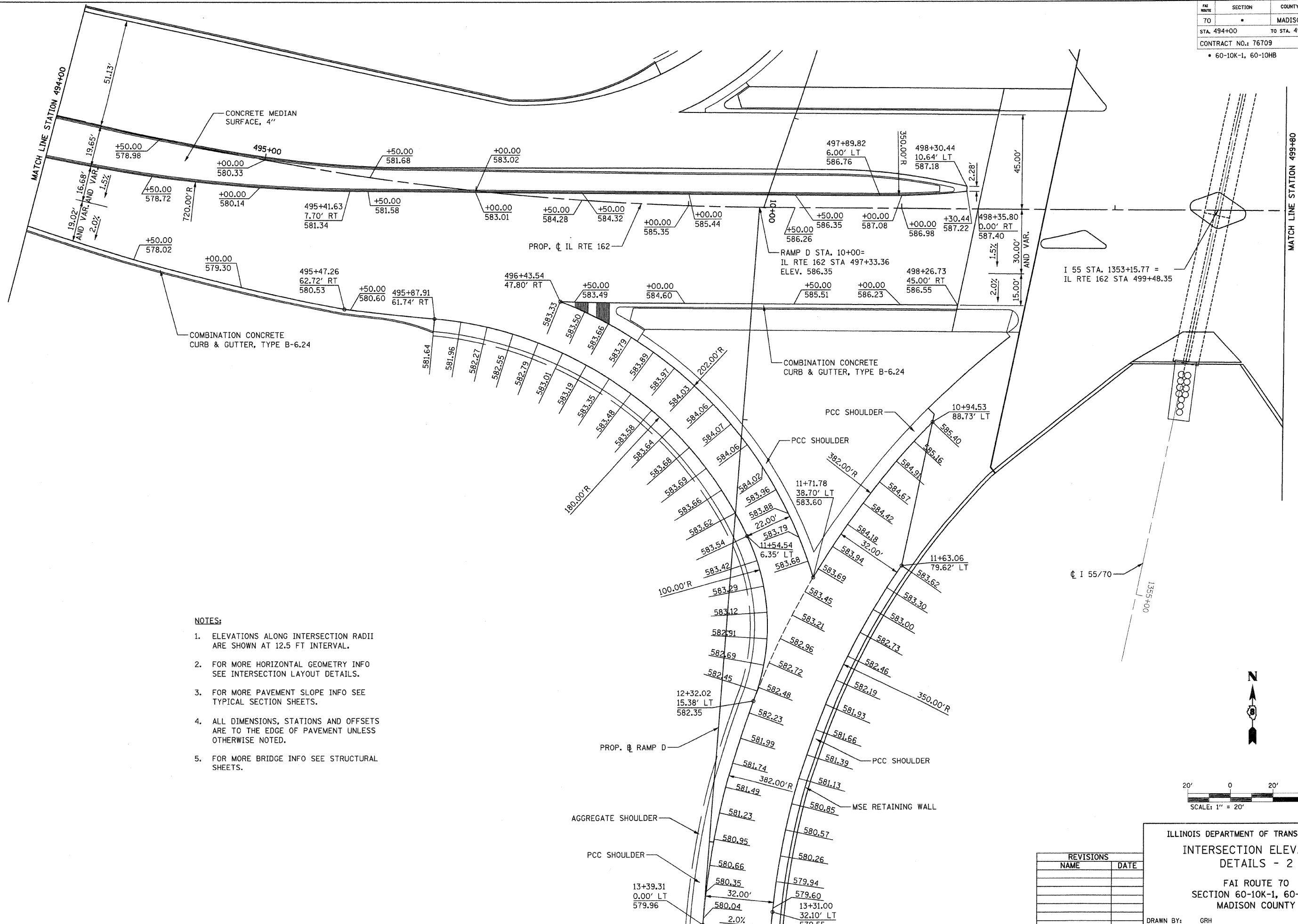

- NOTES:**
1. ELEVATIONS ALONG INTERSECTION RADII ARE SHOWN AT 12.5 FT INTERVAL.
  2. FOR MORE HORIZONTAL GEOMETRY INFO SEE INTERSECTION LAYOUT DETAILS.
  3. FOR MORE PAVEMENT SLOPE INFO SEE TYPICAL SECTION SHEETS.
  4. ALL DIMENSIONS, STATIONS AND OFFSETS ARE TO THE EDGE OF PAVEMENT UNLESS OTHERWISE NOTED.
  5. FOR MORE BRIDGE INFO SEE STRUCTURAL SHEETS.

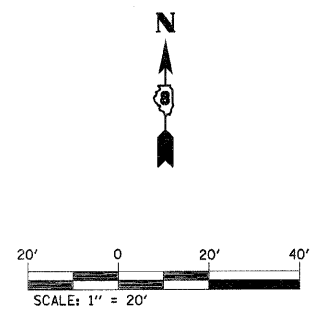

REVISIONS	
NAME	DATE

ILLINOIS DEPARTMENT OF TRANSPORTATION  
**INTERSECTION ELEVATION  
 DETAILS - 2**  
 FAI ROUTE 70  
 SECTION 60-10K-1, 60-10HB  
 MADISON COUNTY  
 DRAWN BY: GRH  
 PLOT DATE: \*DATE-TIME\*

DATE-TIME: \*  
 REF: 236ccu20L.dgn  
 REF: 236ccu20.dgn