

SECTION	COUNTY	TOTAL SHEETS	SHEET NO.
60-10 (K-1,HB)	MADISON	420	181
CONTRACT NO.: 76709			

NOTES:  
 1. ALL UNIT DUCT ON THIS SHEET SHALL BE 4" (2" x 4" XLP, 1" x 4" XLP, 1.0P) UNLESS NOTED OTHERWISE.

LEGEND  
 TBR - TO BE REMOVED  
 REMOVE POLE  
 REMOVE AND SALVAGE LUMINAIRE  
 REMOVE FOUNDATION

DATE	BY	REVISION

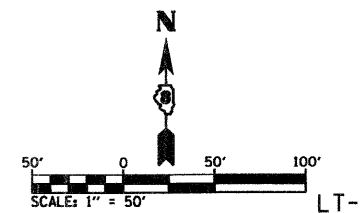
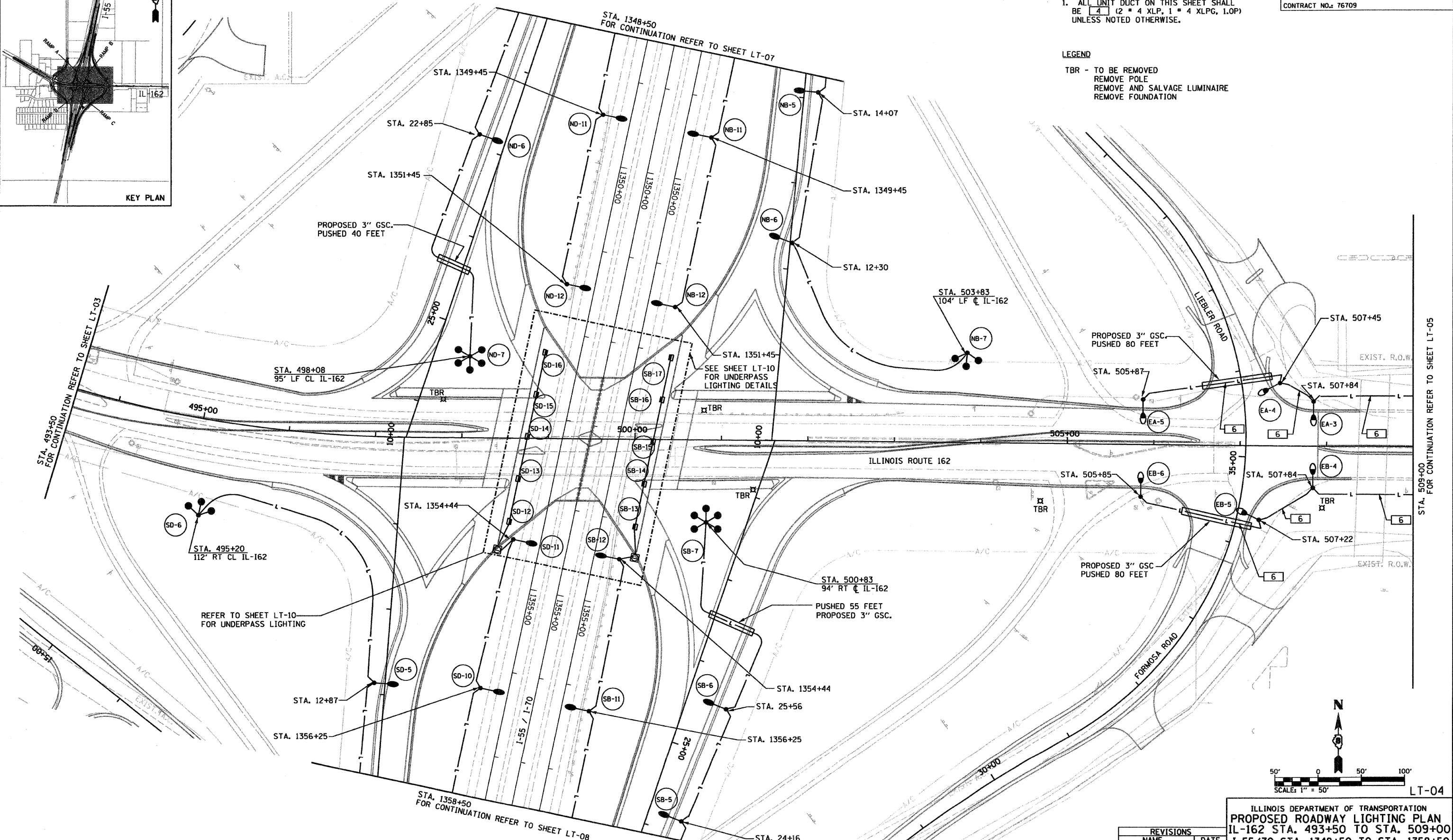
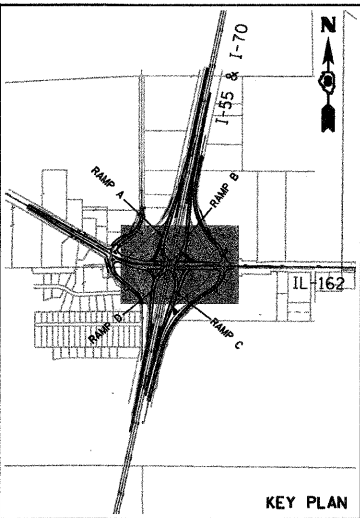

REVISIONS	
NAME	DATE

ILLINOIS DEPARTMENT OF TRANSPORTATION  
**PROPOSED ROADWAY LIGHTING PLAN**  
 IL-162 STA. 493+50 TO STA. 509+00  
 I-55/70 STA. 1348+50 TO STA. 1358+50  
 FAI ROUTE 70  
 SECTION 60-10K-1, 60-10HB  
 MADISON COUNTY

DRAWN BY: RPJ CHECKED BY: A. OSHANA, P.E.

XXXXXXX - IDOT IL 162 over I-55.70 revisions  
 236-LT-04.dgn  
 1/28/2009  
 10:23:37 PM  
 Robert Swanson