

F.A.I. RTE.	SECTION	COUNTY	TOTAL SHEETS	SHEET NO.
TO 60-10K-1,60-10HB	MADISON	420	255	
STA.	TO STA.			
FED. ROAD DIST. NO.	ILLINOIS	FED. AID PROJECT		

CONTRACT NO. 76709

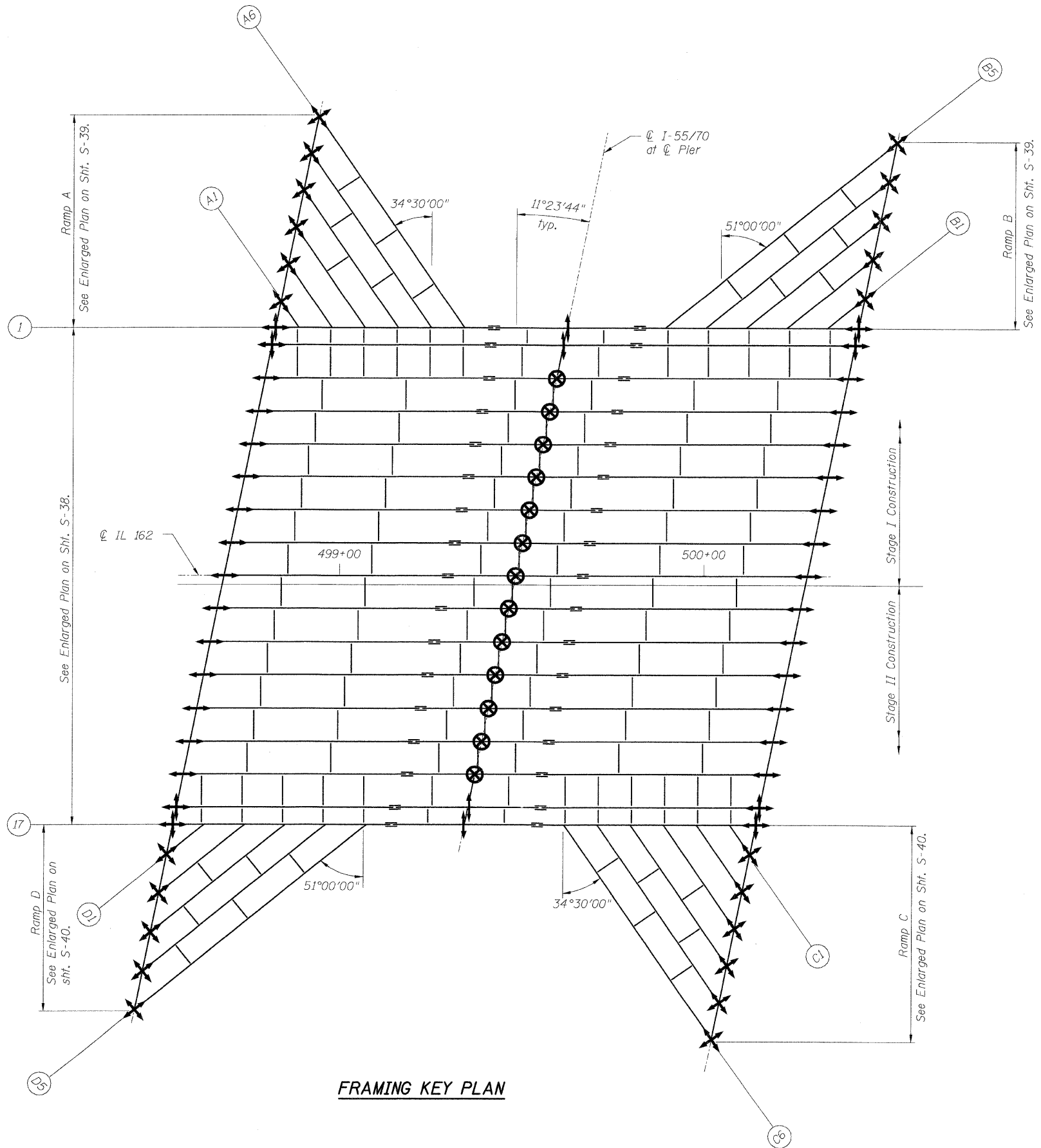

FRAMING KEY PLAN

LEGEND:

- Guided Bearing ↔ Direction of Movement
- ✱ Non-Guided Bearing ✱ Direction of Movement
- ⊗ Fixed Bearing

SHT. S-37 OF S-68

STV Incorporated
 Engineers/Architects/Planners/Construction Managers
 200 W. Monroe Street, Suite 1650
 Chicago, IL 60606-4015
 312/553-9655, FAX 312/553-0661

REVISIONS	
NAME	DATE

ILLINOIS DEPARTMENT OF TRANSPORTATION
 IL ROUTE 162 OVER I-55/70 IN TROY
 F.A.I ROUTE 70 SECTION 60-10K-1, 60-10HB
 MADISON COUNTY STATION 499+48.35
 STRUCTURE NO. 060-0338

FRAMING KEY PLAN

DESIGNED: BTO DRAWN: BTO
 CHECKED: AWB CHECKED: JAN
 DATE: 03/06