

**BENCH MARK**

CP#35, Iron Pin w/Cap, Sta. 502+30.81, 37.37' Rt. El. 582.812

**EXISTING STRUCTURE**

Bridge S.N. 060-0139 was built in 1956 as U. S. Route 40 Bypass over F. A. Route 190 (U. S. Route 66). It was widened and the deck reconstructed in 1978. The four span structure was built on concrete piles at the abutments and timber piles at the piers. The back to back abutment length is 194'-0" and the deck is 75'-2" out to out.

During construction of the new structure, staged construction will be utilized to maintain one lane of traffic in each direction.

No salvage.

**DESIGN STRESSES**

**FIELD UNITS**

$f'_c = 3,500$  psi (concrete)  
 $f_y = 60,000$  psi (reinforcement)

**PRECAST UNIT**

$f'_c = 4,500$  psi (precast panels)

**DESIGN SPECIFICATION**

2002 AASHTO Std. Spec, 17th edition

**NOTE**

Wall is built in Conjunction with New Bridge, S.N. 060-0338.

STATION 18+50  
BUILT 200 BY  
STATE OF ILLINOIS  
F.A.I. RT. 70  
SEC. 60-10K-1, 60-10HB  
LOADING HS20  
STR. NO. 060-W004

**NAME PLATE**

See Std. 515001

NOTE: For Name Plate Location, see Sht. R-04

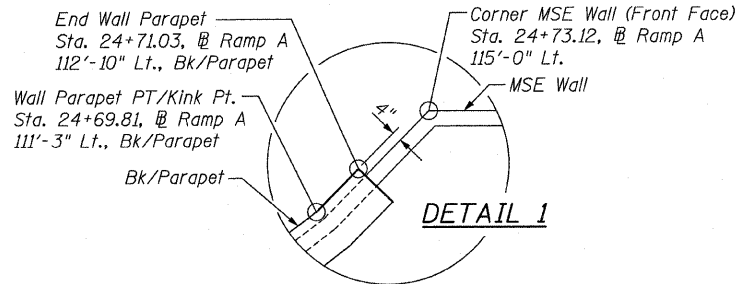

F.A.I. RTE.	SECTION	COUNTY	TOTAL SHEETS	SHEET NO.
70		MADISON	420	287
STA.	TO STA.			
FED. ROAD DIST. NO.	ILLINOIS	FED. AID PROJECT		
60-10K-1, 60-10HB	CONTRACT NO. 76709			

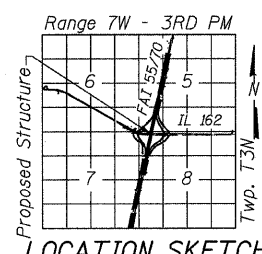
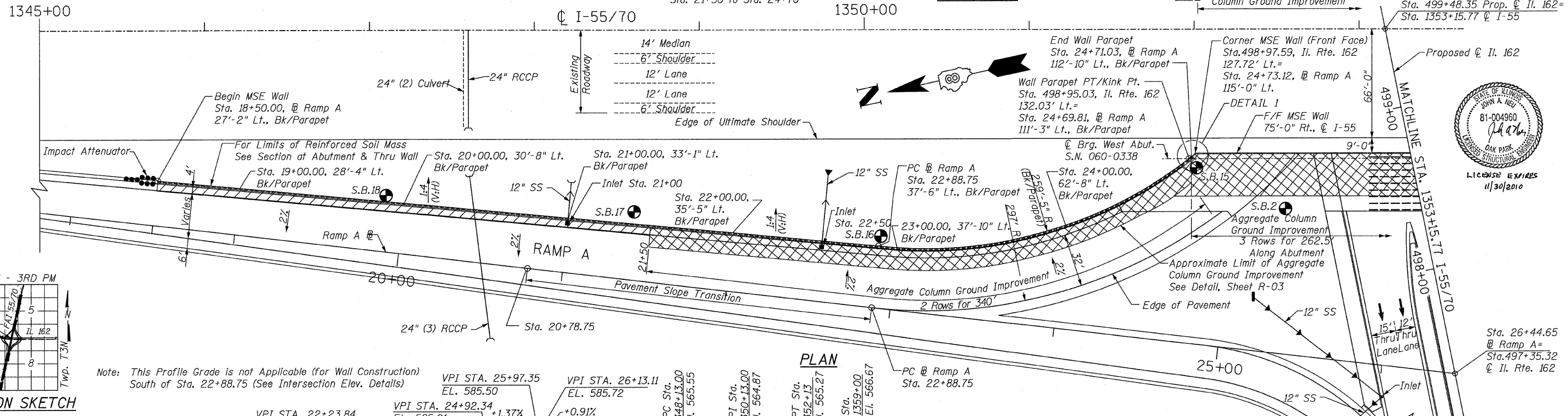
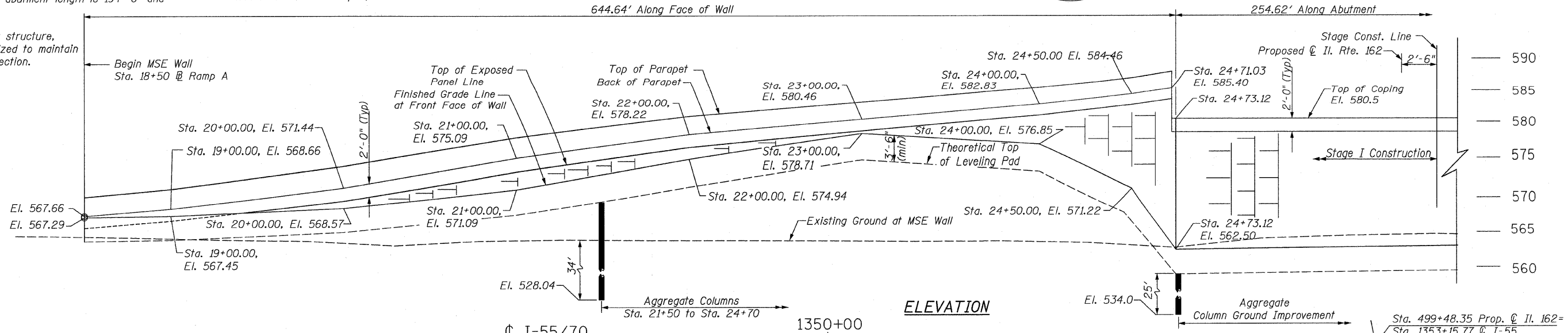

Note: This Profile Grade is not Applicable (for Wall Construction) South of Sta. 22+88.75 (See Intersection Elev. Details)

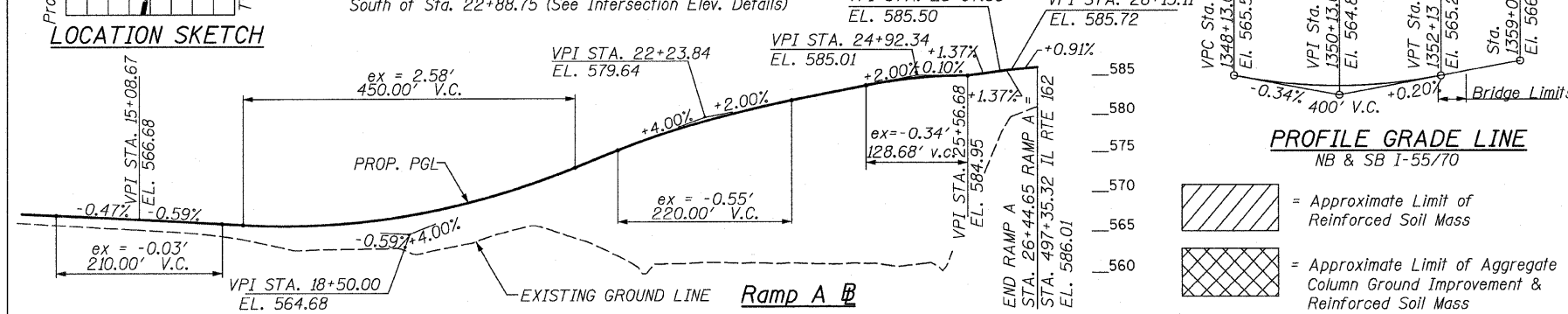

- = Approximate Limit of Reinforced Soil Mass
- = Approximate Limit of Aggregate Column Ground Improvement & Reinforced Soil Mass

**APPROVED**  
FOR STRUCTURAL ADEQUACY ONLY

*Ralph E. Anderson*  
ENGINEER OF BRIDGES AND STRUCTURES

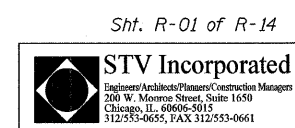

REVISIONS	
NAME	DATE

ILLINOIS DEPARTMENT OF TRANSPORTATION  
IL ROUTE 162 OVER I-55/70 IN TROY  
F.A.I. ROUTE 70 SECTION 60-10K-1, 60-10HB  
MADISON COUNTY STA. 18+50 TO STA. 17+00  
STRUCTURE NO. 060-W004  
GENERAL PLAN I  
DATE: 05/2006  
DRAWN: AWH  
CHECKED: JAN