

SUGGESTED STAGE II CONSTRUCTION SEQUENCE

1. ERECT STAGE II TRAFFIC CONTROL.
2. REMOVE EXISTING PAVED SHOULDERS AT LOCATIONS SHOWN ON SHEETS 16,17 & 18.
3. CONSTRUCT P.C.C. BASE COURSE 8" & HOT MIX ASPHALT SHOULDERS 8" AS SHOWN ON SHEET 19, 20 & 21 AND ON ROADWAY PLAN SHEETS 29 - 33.

MATCH LINE - STA. 244 + 50.00

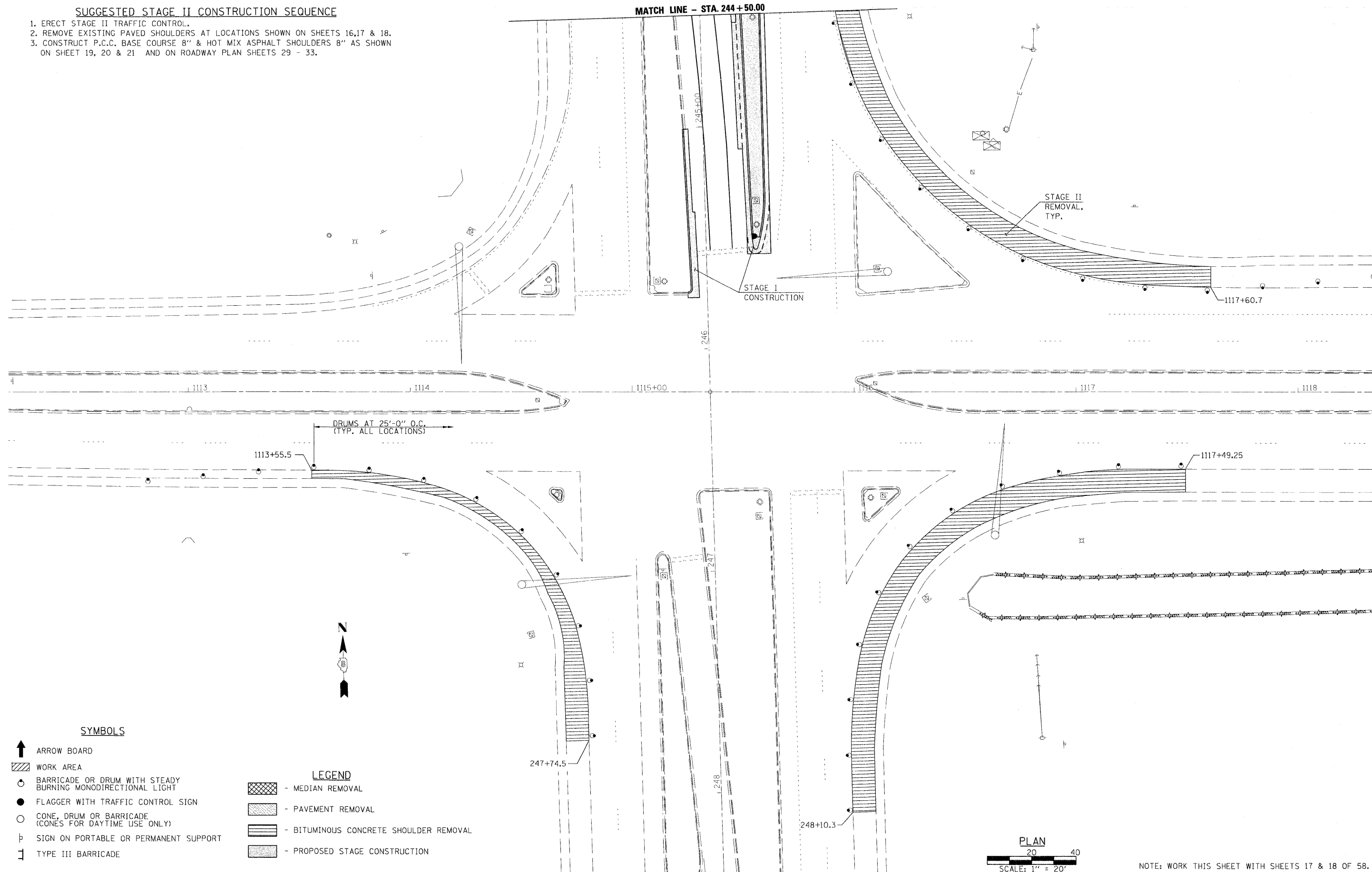

DRUMS AT 25'-0" O.C.
(TYP. ALL LOCATIONS)

SYMBOLS

- ↑ ARROW BOARD
- ▨ WORK AREA
- BARRICADE OR DRUM WITH STEADY BURNING MONODIRECTIONAL LIGHT
- FLAGGER WITH TRAFFIC CONTROL SIGN
- CONE, DRUM OR BARRICADE (CONES FOR DAYTIME USE ONLY)
- ⊥ SIGN ON PORTABLE OR PERMANENT SUPPORT
- ⌌ TYPE III BARRICADE

LEGEND

- ▨ - MEDIAN REMOVAL
- ▨ - PAVEMENT REMOVAL
- ▨ - BITUMINOUS CONCRETE SHOULDER REMOVAL
- ▨ - PROPOSED STAGE CONSTRUCTION

FILE NAME =	USER NAME = #USER#	DESIGNED -	REVISD -
#FILE#		DRAWN -	REVISD -
	PLOT SCALE = #SCALE#	CHECKED -	REVISD -
	PLOT DATE = #DATE#	DATE -	REVISD -



Allen Henderson & Associates, Inc.
Civil and Structural Engineers Springfield, IL
62703 Phone: (217)544-8033 IL Design Firm
No. 184-001907

STAGE II TRAFFIC CONTROL		
SCALE: 1" = 20'	SHEET NO. 16 OF 58 SHEETS	STA. _____ TO STA. _____

F.A.P. RTE.	SECTION	COUNTY	TOTAL SHEETS	SHEET NO.
674	410-1-N	ST. CLAIR	58	16
FED. ROAD DIST. NO. _____ ILLINOIS FED. AID PROJECT			CONTRACT NO. 76C63	

NOTE: WORK THIS SHEET WITH SHEETS 17 & 18 OF 58.