

MATCH LINE - STA. 1244 + 50.00

MATCH LINE - STA. 1112 + 00.00

MATCH LINE - STA. 1118 + 00.00

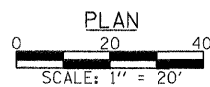
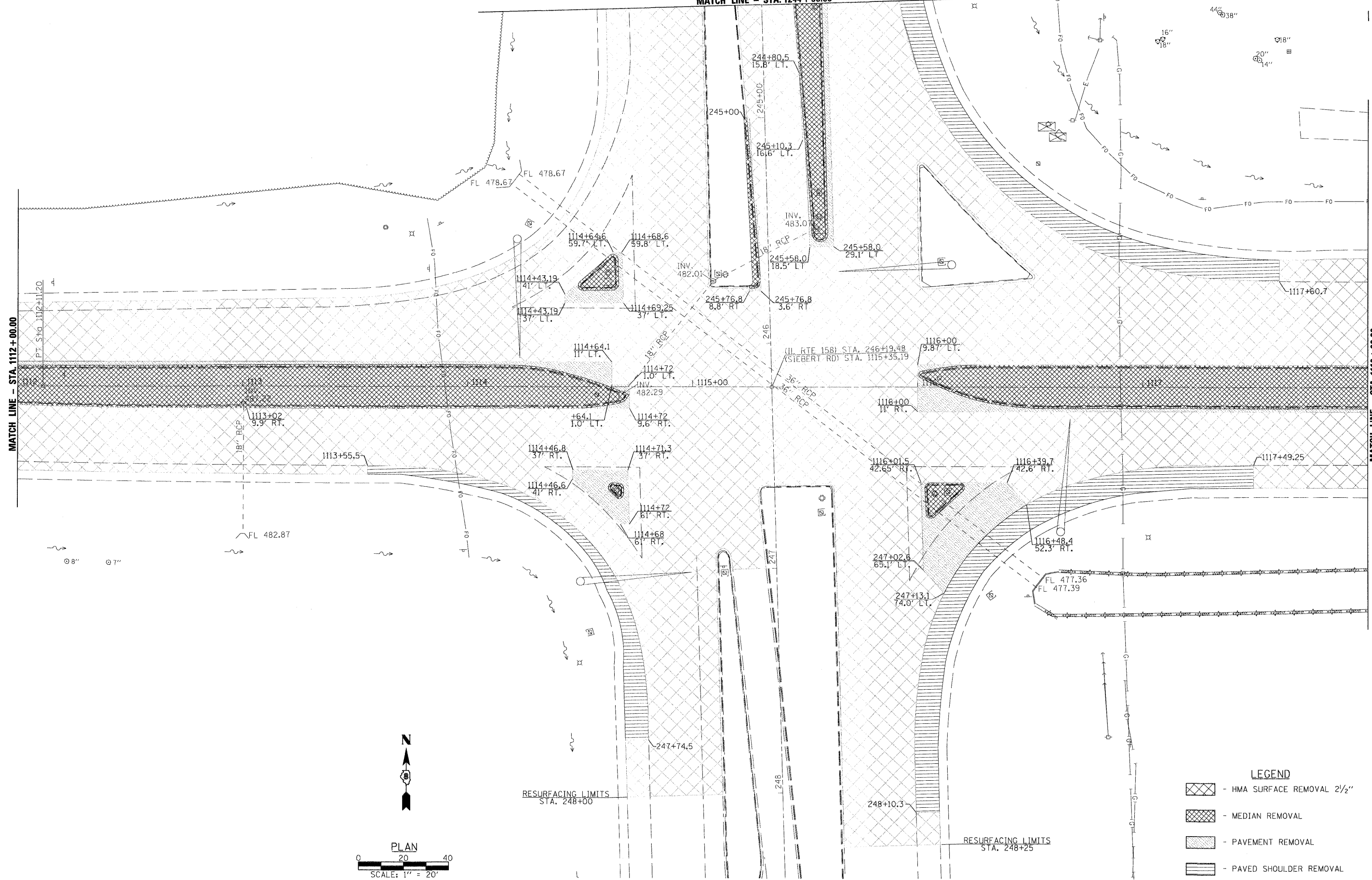

LEGEND

- HMA SURFACE REMOVAL 2 1/2"
- MEDIAN REMOVAL
- PAVEMENT REMOVAL
- PAVED SHOULDER REMOVAL

FILE NAME =
#FILE#

USER NAME = #USER#
DRAWN -
PLOT SCALE = #SCALE#
PLOT DATE = #DATE#

DESIGNED -
CHECKED -
DATE -

REVISED -
REVISED -
REVISED -
REVISED -



Allen Henderson & Associates, Inc.
Civil and Structural Engineers Springfield, IL.
62703 Phone: (217)544-8033 IL Design Firm
No. 184-001907

REMOVAL PLAN
SCALE: 1" = 20' SHEET NO. 25 OF 58 SHEETS STA. TO STA.

| | | | | |
|-----------------------------------------------|--------------------|---------------------|--------------------|-----------------|
| F.A.P. RTE. 674 | SECTION 410-1-N | COUNTY ST. CLAIR | TOTAL SHEETS 58 | SHEET NO. 25 |
| FED. ROAD DIST. NO. ILLINOIS FED. AID PROJECT | | | | |