

EXIST. CURVE158-1
 PI STA. =235+43.10
 Δ =15° 22' 58" (LT)
 D =1° 00' 00"
 R =5,729.58'
 T =773.79'
 L =1,538.28'
 E =52.01'
 e = -----
 T.R. = -----
 S.E. RUN = -----
 P.C. STA. =227+69.31
 P.T. STA. =243+07.59

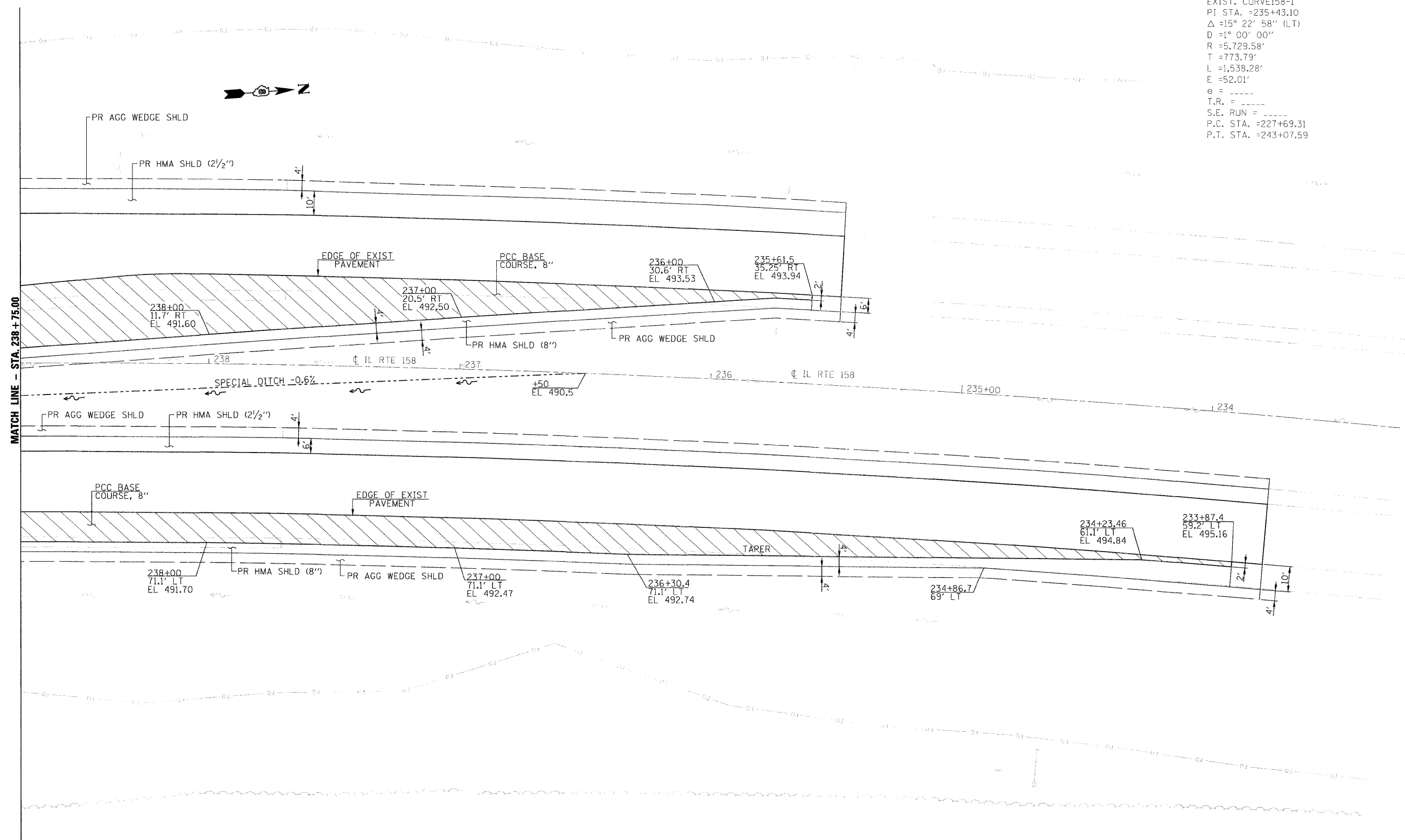

MATCH LINE - STA. 238+75.00

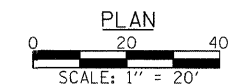

FILE NAME = #FILE#	USER NAME = #USER#	DESIGNED -	REVISED -	Allen Henderson & Associates, Inc. Civil and Structural Engineers Springfield, IL. 62703 Phone: (217)544-8033 IL Design Firm No. 184-001907	ROADWAY PLAN			F.A.P. RTE. 674	SECTION 410-1-N	COUNTY ST. CLAIR	TOTAL SHEETS 58	SHEET NO. 33
PLOT SCALE = #SCALE#		CHECKED -	REVISED -		SCALE: 1" = 20'	SHEET NO. 33 OF 58 SHEETS	STA.	TO STA.	CONTRACT NO. 76C63			
PLOT DATE = #DATE#		DATE -	REVISED -		FED. ROAD DIST. NO. ILLINOIS FED. AID PROJECT							