

MATCH LINE - STA. 1244 + 50.00

MATCH LINE - STA. 1112 + 00.00

MATCH LINE - STA. 1118 + 00.00

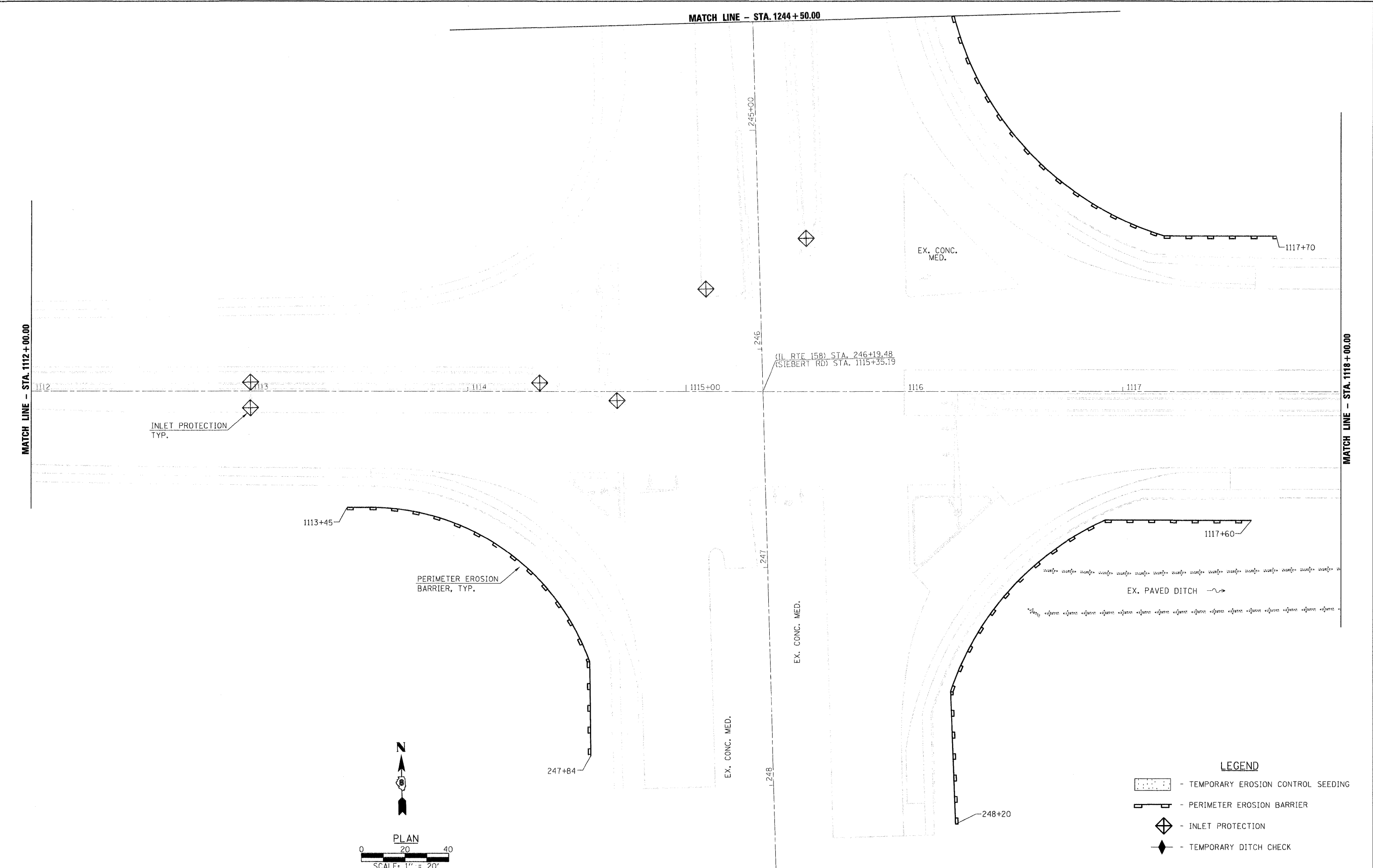

INLET PROTECTION
TYP.

PERIMETER EROSION
BARRIER, TYP.

EX. CONC.
MED.

(IL RTE 158) STA. 246+19.48
(SIEBERT RD) STA. 1115+35.19

EX. PAVED DITCH

EX. CONC. MED.

EX. CONC. MED.

LEGEND

- TEMPORARY EROSION CONTROL SEEDING
- PERIMETER EROSION BARRIER
- INLET PROTECTION
- TEMPORARY DITCH CHECK

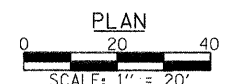

FILE NAME = #FILE#	USER NAME = #USER#	DESIGNED -	REVISED -	Allen Henderson & Associates, Inc. Civil and Structural Engineers Springfield, IL 62708 Phone: (217)544-8033 IL Design Firm No. 184-001907	EROSION PLAN			F.A.P. RTE.	SECTION	COUNTY	TOTAL SHEETS	SHEET NO.
	PLOT SCALE = #SCALE#	CHECKED -	REVISED -					674	410-1-N	ST. CLAIR	58	43
	PLOT DATE = #DATE#	DATE -	REVISED -		SCALE: 1" = 20'	SHEET NO. 43 OF 58 SHEETS	STA.	TO STA.	CONTRACT NO. 76C63			
								FED. ROAD DIST. NO. ILLINOIS FED. AID PROJECT				