

* The Concrete Abutment Backwall Above The Existing Stone Abutment Shall Be Cast After The Timber And Steel Stringers Have Been Set In-Place. Field Verify Dimension To Match Top Of Timber Deck.

** Provide 3mm Elastomeric Neoprene Leveling Pad According To The Material Properties Of Art. 1052.02 Of The IDOT Standard Specifications (Typ.). This Item Of Work Shall Not Be Paid For Separately But Shall Be Included With The Cost Of Concrete Structures.

CONCRETE SEAT DETAILS NOT TO SCALE

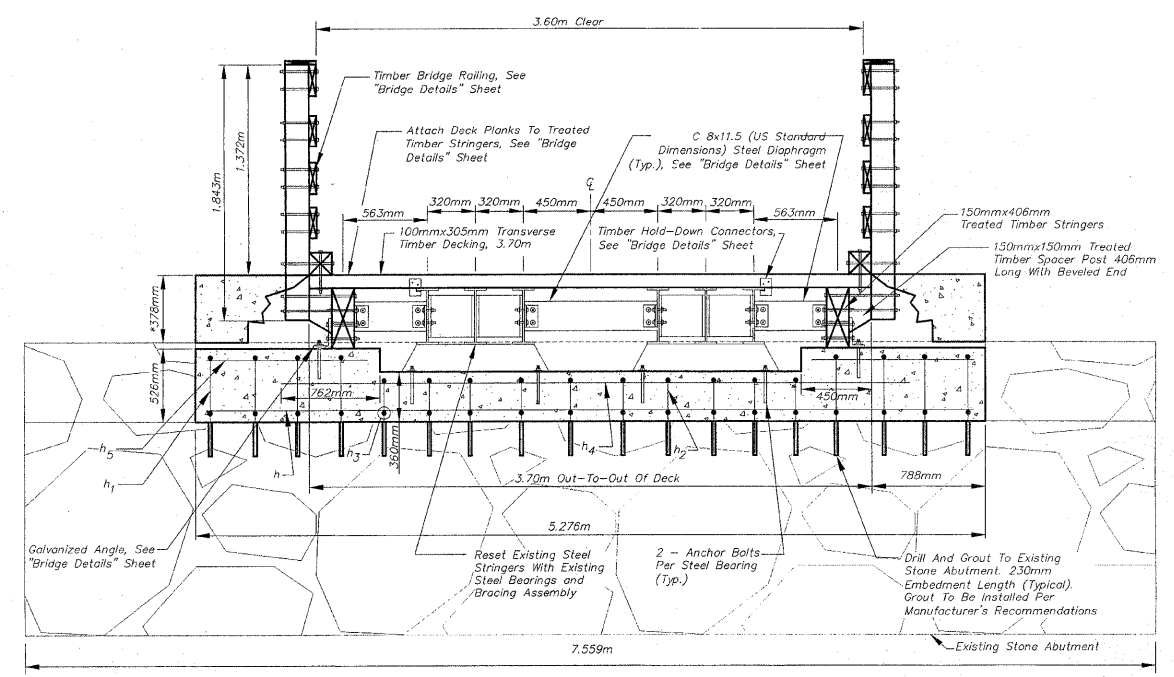

BILL OF MATERIAL FOR BOTH ABUTMENTS

Bar	No.	Size	Length	Shape
h	14	#16	5.124m	—
h ₁	32	#13	0.679m	—
h ₂	40	#13	0.513m	—
h ₃	72	#13	0.729m	—
h ₄	6	#16	4.324m	—
h ₅	12	#16	1.086m	—
h ₆	72	#13	0.531m	—
h ₇	36	#13	1.014m	□
Reinforcement Bars		kg	342	
Concrete Structures		CM	3.99	
Drill and Grout Bars		EA	216	
Anchor Bolts, M20		Each	12	

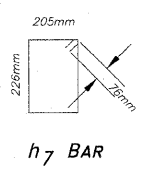

BRIDGE DETAILS OVER A TRIBUTARY DITCH TO PECATONICA RIVER SECTION 94-00267-00-BT WINNEBAGO COUNTY STATION 36+407.39

REVISIONS		
NO.	ITEM	DATE
2	IDOT Review Comments and Internal Review	1/28/2009

PLOTTING SCALE:	1 : 1
DRAWN BY:	PLH/JRC/CDS
CHECKED BY:	
DATE:	DECEMBER, 2008

McClure
Engineering Associates, Inc.
7282 Argus Drive
Rockford, Illinois 61107-5837
(815) 398-2332 FAX (815) 398-2496
Design Firm License: Illinois 184-000816
Copyright 2009 By McClure Engineering Associates, Inc.

BRIDGE NO. 126 STA. 36+407.39
PECATONICA PRAIRIE PATH Contract 85443
WINNEBAGO COUNTY HIGHWAY DEPARTMENT SECTION 94-00267-00-BT
FILE NAME: G:\surveys\PECPATH\1ST RELEASE\98-037 b126.dwg JOB NUMBER: 04-28-98-037

D:\surveys\PECPATH\1ST RELEASE\98-037 b126.dwg, #2, B 126, 3/4/2009 12:43:09 PM, 1:1, REK