

**CAUTION
OVERHEAD
WIRES**

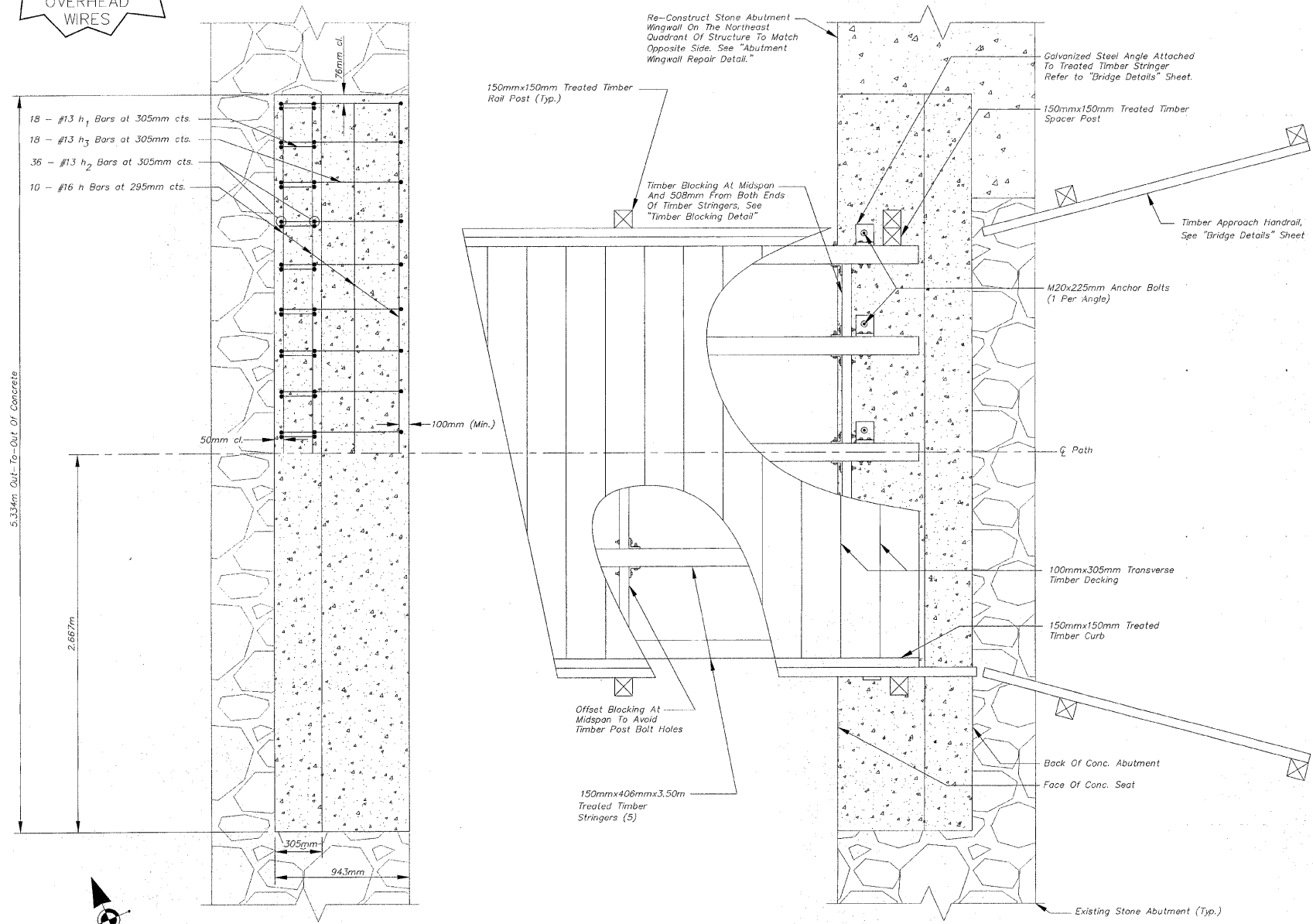

PLAN NOT TO SCALE

**BILL OF MATERIAL
FOR BOTH ABUTMENTS**

Bar	No.	Size	Length	Shape
h	20	#16	5.182m	—
h ₁	36	#13	0.815m	□
h ₂	72	#13	0.816m	□
h ₃	36	#13	1.125m	□
Reinforcement Bars		kg	290	
Concrete Structures		CM	3.38	
Drill and Grout Bars		Each	108	
Anchor Bolts, M20		Each	10	

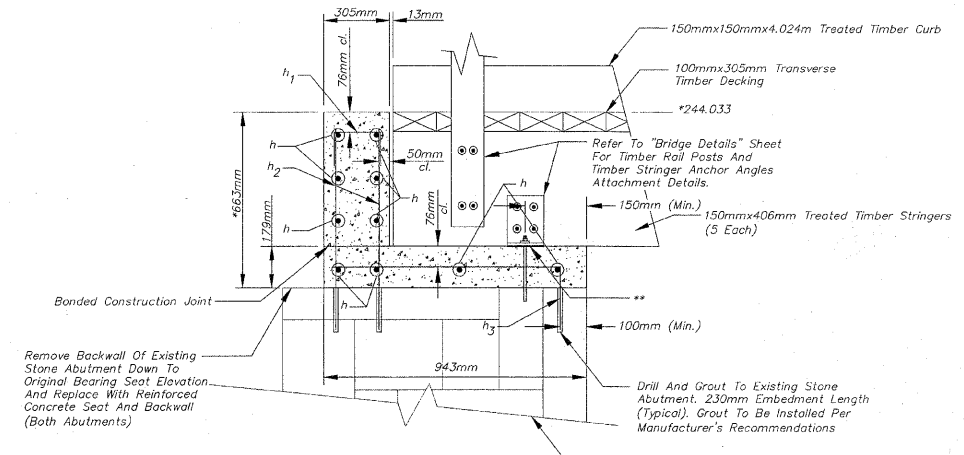
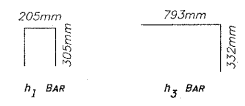

CONCRETE SEAT DETAIL NOT TO SCALE

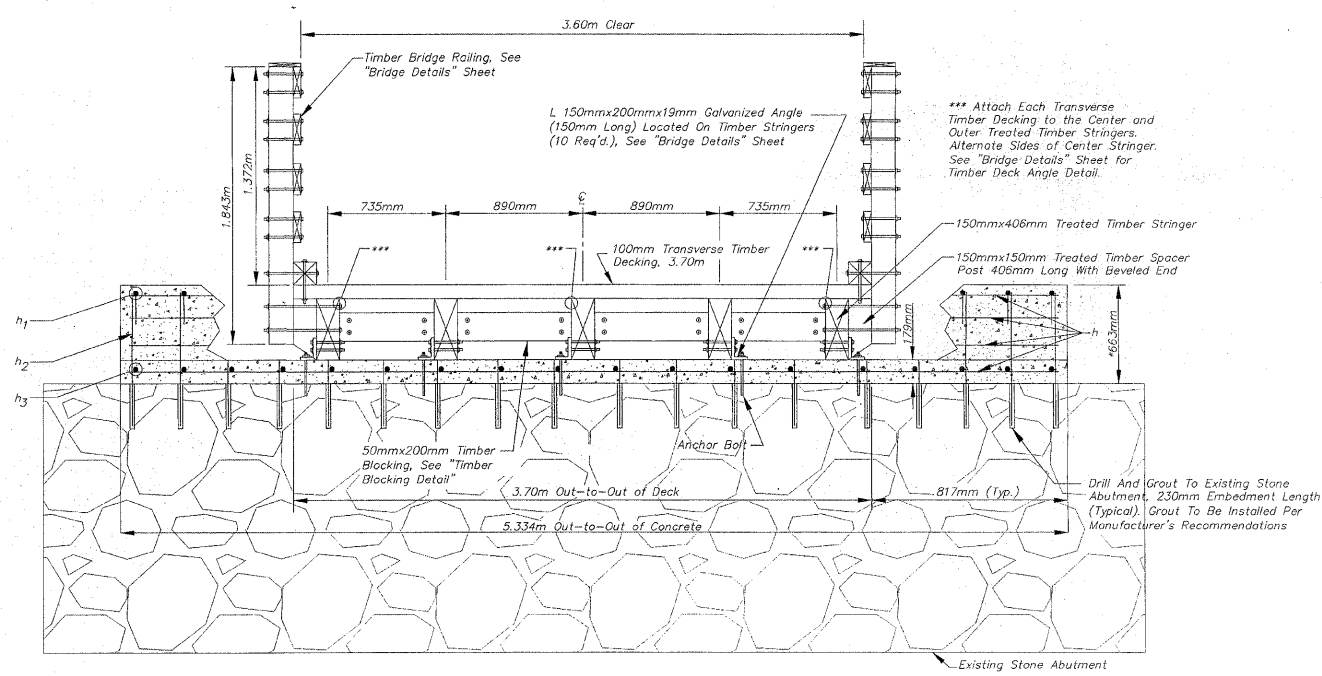

SECTION THRU DECK NOT TO SCALE

**BRIDGE DETAILS
OVER A TRIBUTARY DITCH
TO THE KEITH CREEK
SECTION 94-00267-00-BT
WINNEBAGO COUNTY
STATION 46+724.37**

FOR INFORMATION ONLY

REVISIONS		
NO.	ITEM	DATE
2	IDOT Review Comments and Internal Review	1/28/2009

PLOTTING SCALE: 1 : 1
DRAWN BY: PLH/JRC/CDS
CHECKED BY:
DATE: DECEMBER, 2008

McClure
Engineering Associates, Inc.
7282 Argus Drive Rockford, Illinois 61107-5837
(815) 398-2332 FAX (815) 398-2496
Design Firm License: Illinois 184-000815
Copyright 2009 By McClure Engineering Associates, Inc.

BRIDGE NO. 130 STA. 46+724.37
PECATONICA PRAIRIE PATH Contract 85443
WINNEBAGO COUNTY HIGHWAY DEPARTMENT SECTION 94-00267-00-BT
FILE NAME: G:\surveys\PECPATH\1ST RELEASE\98-037 b129-130.dwg JOB NUMBER: 04-28-98-037

SHEET NO.
**94
OF
98**

G:\surveys\PECPATH\1ST RELEASE\98-037 b129-130.dwg, #2 B 130, 3/4/2009 12:49:04 PM, 1:1:02623, REK